



## 3232-3246 EAST MICHIGAN AVENUE JACKSON, MI 49202

### PROPERTY HIGHLIGHTS:

- Drive-thru endcap unit available
- Brand new retail development | Join AT&T, Great Clips, & Wild Bills
- 1,200 SF to 3,600 SF retail spaces available
- Excellent building visibility and frontage on Michigan Avenue
- Large monument signage facing Michigan Avenue
- Second highest traffic counts in Jackson County
- Very strong demographics and traffic counts
- Lease Rate: \$21.00-\$23.00/SF + NNN (Est. \$5 PSF)

The information provided herein along with any attachment(s) was obtained from sources believed to be reliable, however, Friedman Real Estate makes no guarantees, warranties, or representations as to the completeness or accuracy of such information and legal counsel is advised. All information provided is subject to verification and no liability for reliance on such information or errors or omissions is assumed. The presentation of this property is submitted subject to errors, omissions, change of price or conditions, prior sale or lease, or withdrawal without notice. Copyright © 2021 Friedman Real Estate. All rights reserved.

### FOR MORE INFORMATION PLEASE CONTACT:



**JAMES LAHOOD**  
james.lahood@freg.com

**248.324.2000**

**eCODE 528**

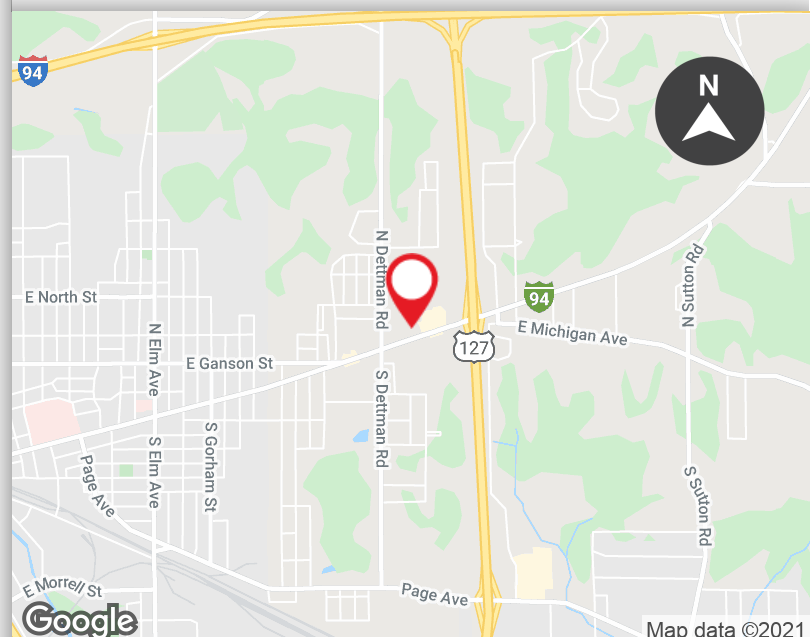

# 3232-3246 EAST MICHIGAN AVENUE LOCATION OVERVIEW

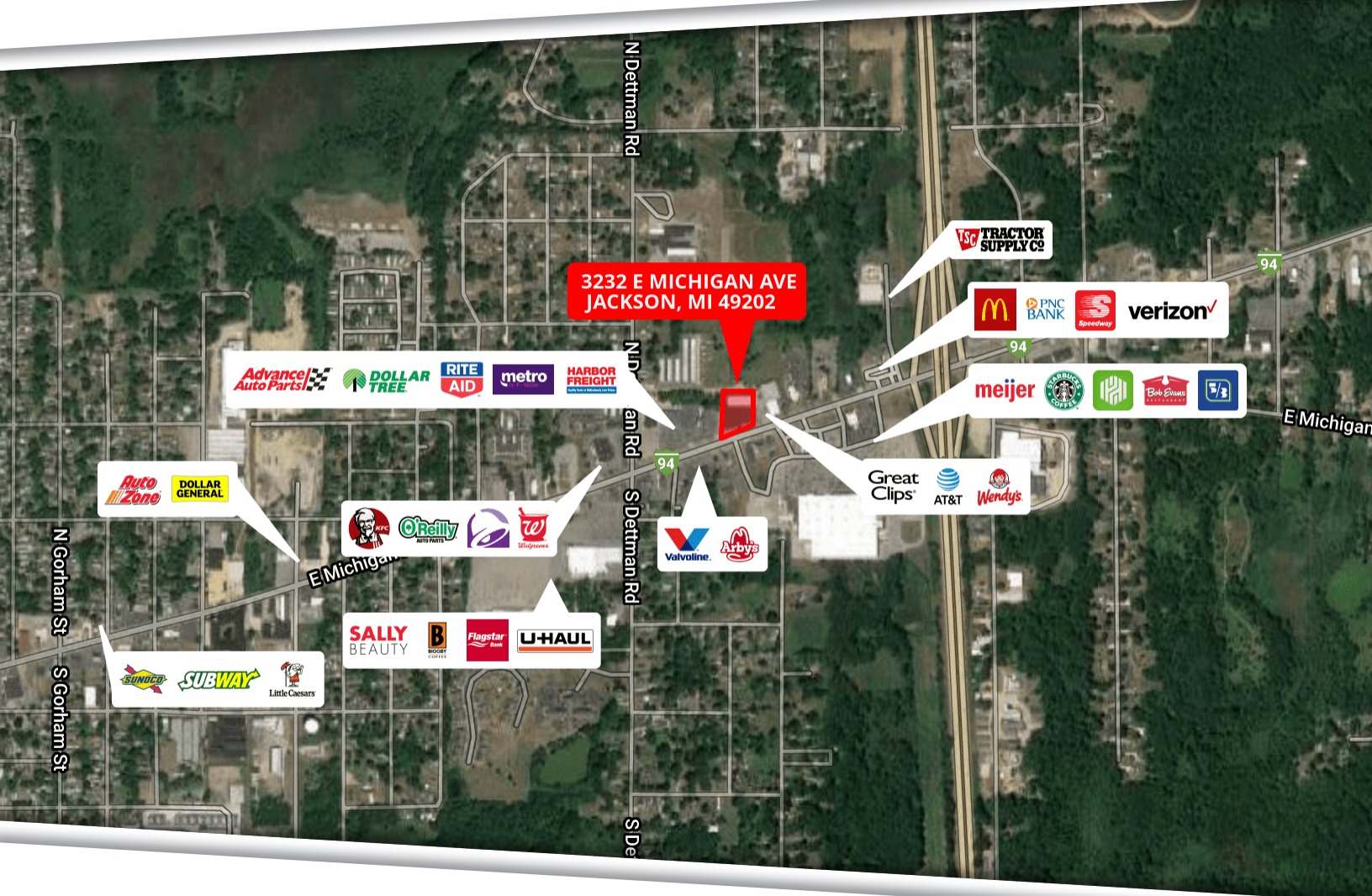

## TRAFFIC COUNTS

INTERSECTION	CARS
US Highway 127 and I-94 Bus LP N	28
United States Highway 127 and E Michigan Ave N	25
E Michigan Ave and United States Highway 127 E	20
I-94 Bus LP and US Highway 127 E	16

## DEMOGRAPHICS

	1 MILE	5 MILES	10 MILES
Total Population	1,804	80,386	150,568
Total Households	471	28,762	56,862
Average HH Income	\$44,894	\$42,651	\$52,786

**3232-3246 EAST MICHIGAN AVENUE**  
**PROPERTY SITE PLAN**

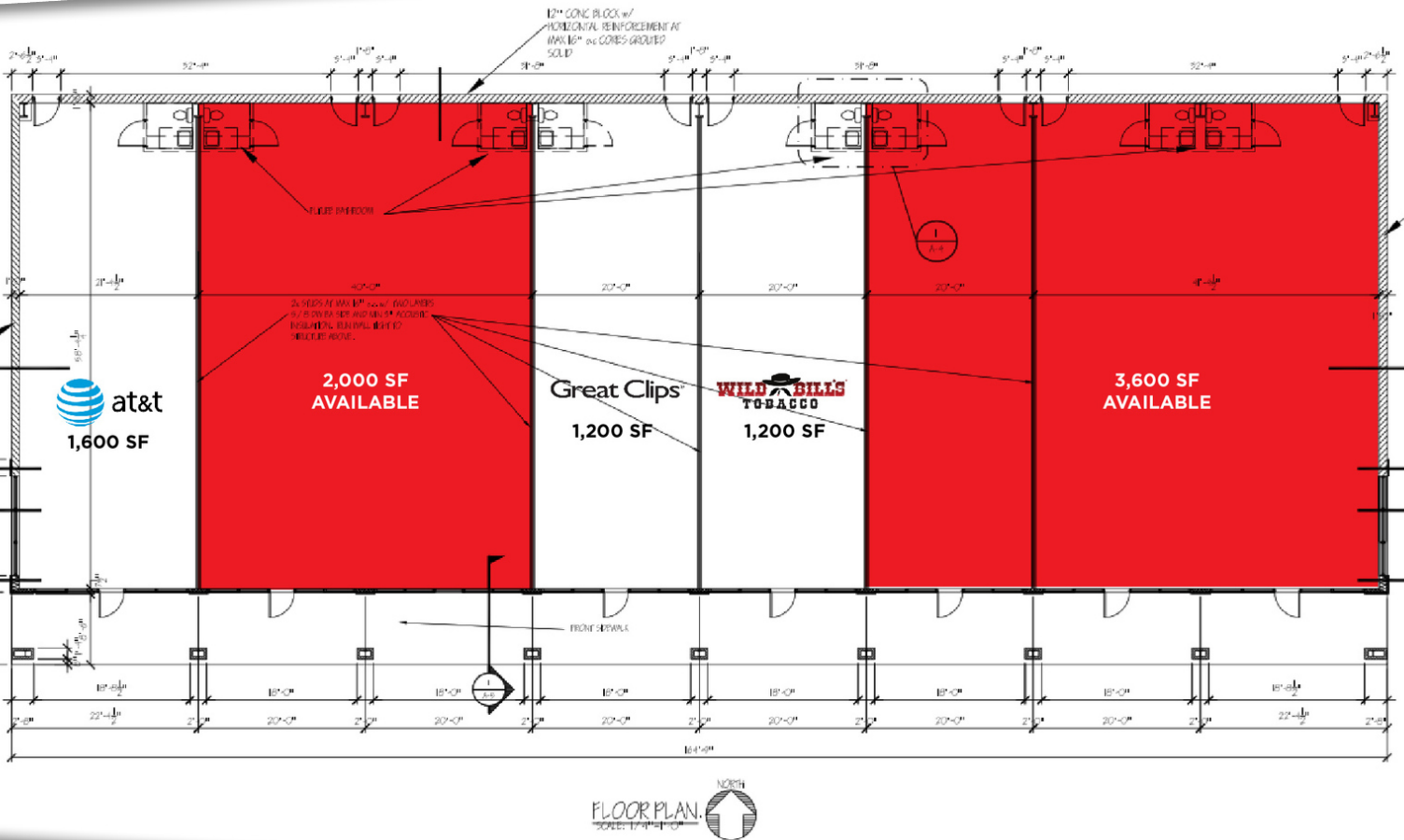

FOR MORE INFORMATION **PLEASE CONTACT:**



**JAMES LAHOOD**  
james.lahood@freg.com