

# FOR SALE/LEASE

## THE COURTYARD OFFICE PARK



**28200-28336 FRANKLIN ROAD**  
**SOUTHFIELD, MI 48034**

### PROPERTY HIGHLIGHTS:

- Suites from 2,632 to 6,645 SF of medical or general office space available
- Dynamic "Class A" location due to its centralized proximity within the metro Detroit area
- Immediate access to all major medical centers, convention venues, educational facilities, lodging, dining and transportation
- Excellent linkages by way of I-96/I-696/M-5/M-10, Northwestern Hwy and Telegraph Rd
- Abundant parking at a ratio of 4.52 per 1,000 SF of rentable area
- Ownership option
- Individual buildings for sale

The information provided herein along with any attachment(s) was obtained from sources believed to be reliable, however, Friedman Real Estate makes no guarantees, warranties, or representations as to the completeness or accuracy of such information and legal counsel is advised. All information provided is subject to verification and no liability for reliance on such information or errors or omissions is assumed. The presentation of this property is submitted subject to errors, omissions, change of price or conditions, prior sale or lease, or withdrawal without notice. Copyright © 2021 Friedman Real Estate. All rights reserved.

FOR MORE INFORMATION PLEASE CONTACT:



**ROBERT MOON**  
[robert.moon@freg.com](mailto:robert.moon@freg.com)

**248.324.2000**

**eCODE 509**

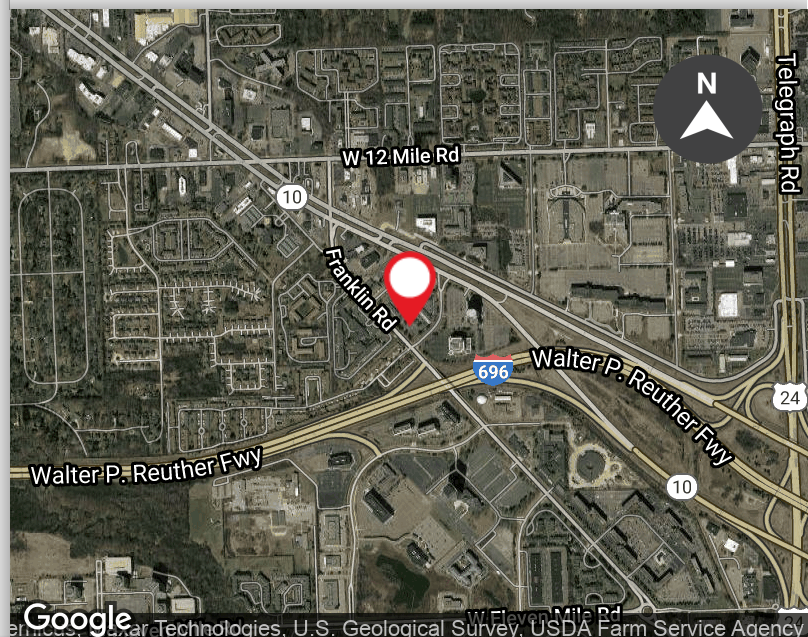

# THE COURTYARD OFFICE PARK PROPERTY FLOOR PLAN

PLAN HAS NOT BEEN  
FIELD VERIFIED

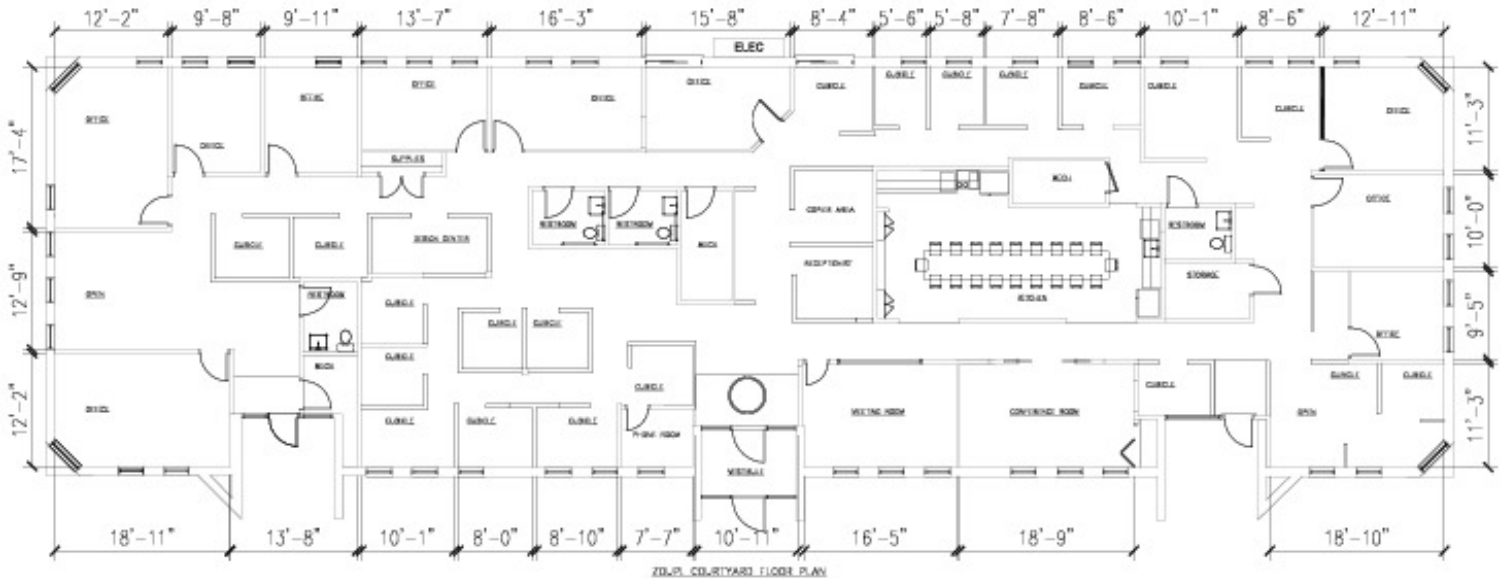

File: 28290-Bldg9\_Courtyard.dwg  
Date: Feb 27 2020  
Time: 16:54:44

SCALE:  
1/16"=1'-0"