

FOR LEASE

NEW RETAIL DEVELOPMENT - CHESTERFIELD



GRATIOT AVENUE AND CARRIAGE WAY CHESTERFIELD, MI 48051

PROPERTY HIGHLIGHTS:

- Brand new retail development at 23 Mile Road & Gratiot Ave
- Join Leo's Coney Island
- 1,000 SF to 50,000 SF available
- Multiple build-to-suit and drive-thru options available
- Located in the heart of Chesterfield's growth boom
- Surrounded by brand new commercial and residential developments
- Very strong traffic counts and retail demographics in the immediate area
- Easy access to both I-94 and M-59
- Lease Rates: Contact Broker

The information provided herein along with any attachment(s) was obtained from sources believed to be reliable, however, Friedman Real Estate makes no guarantees, warranties, or representations as to the completeness or accuracy of such information and legal counsel is advised. All information provided is subject to verification and no liability for reliance on such information or errors or omissions is assumed. The presentation of this property is submitted subject to errors, omissions, change of price or conditions, prior sale or lease, or withdrawal without notice. Copyright © 2021 Friedman Real Estate. All rights reserved.

FOR MORE INFORMATION PLEASE CONTACT:



JAMES LAHOOD
james.lahood@freg.com



STEVEN SILVERMAN
steven.silverman@freg.com

248.324.2000

eCODE 161



NEW RETAIL DEVELOPMENT - CHESTERFIELD

LOCATION OVERVIEW



TRAFFIC COUNTS

INTERSECTION	CARS PER DAY
Gratiot Ave & Carriage Way Dr SW	20,573
Gratiot Ave & 23 Mile Road SW	11,678
23 Mile Road & Gratiot Ave W	30,586
23 Mile Road & Metzen E	30,400

DEMOGRAPHICS

	3 MILES	5 MILES	10 MILES
Total Population	38,638	70,454	251,402
Total Households	14,265	25,148	95,086
Average HH Income	\$74,646	\$75,764	\$72,072

NEW RETAIL DEVELOPMENT - CHESTERFIELD

SITE PLAN

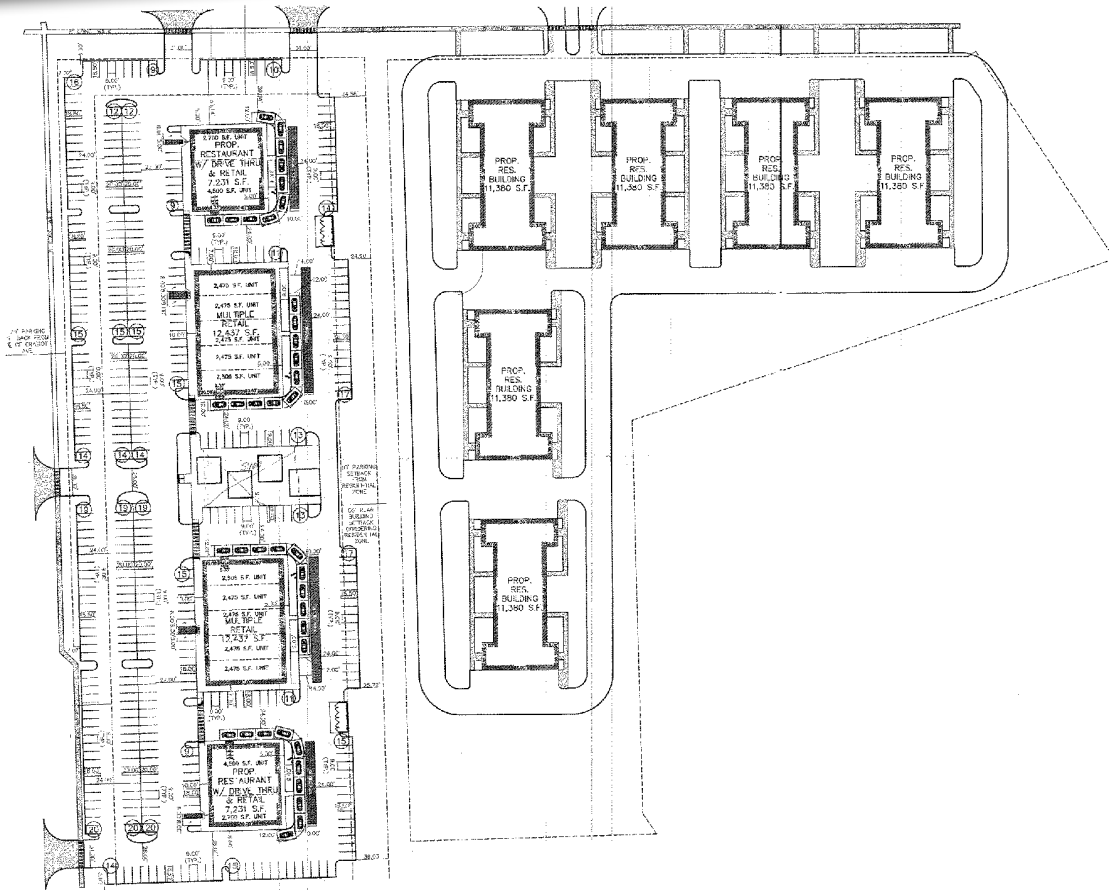

FOR MORE INFORMATION PLEASE CONTACT:



JAMES LAHOOD
james.lahood@freg.com



STEVEN SILVERMAN
steven.silverman@freg.com