

FOR SALE

2407 NW 28TH AVENUE, PORTLAND, OR 97210



Apex Real Estate Partners
412 NW Couch St #201, Portland, OR 97209
503.595.2840 / www.apexcre.com

Miles von Bergen, Director
503.595.2847
Miles@apexcre.com



GREAT OPPORTUNITY TO OWN IN NORTHWEST



FOR SALE

- Total Building: ± 48,175 SF
 - Building 1: ± 18,197 SF shell
 - Building 2: ± 24,078 shell (*includes ± 10,000 SF canopy*)
 - Building 3: ± 5,900 SF shell
 - Total Site: ± 1.33 AC
 - Loading: Multiple grade level doors
 - Zoning: IHk-Heavy Industrial with Prime Industrial overlay
 - Highlights: Great makerspace, showroom and warehouse
Exposed timber beams
Excellent visibility in a superior Guilds Lake location
- Sale Price: \$4,769,325 (\$99.00 PSF)



AERIAL OVERVIEW

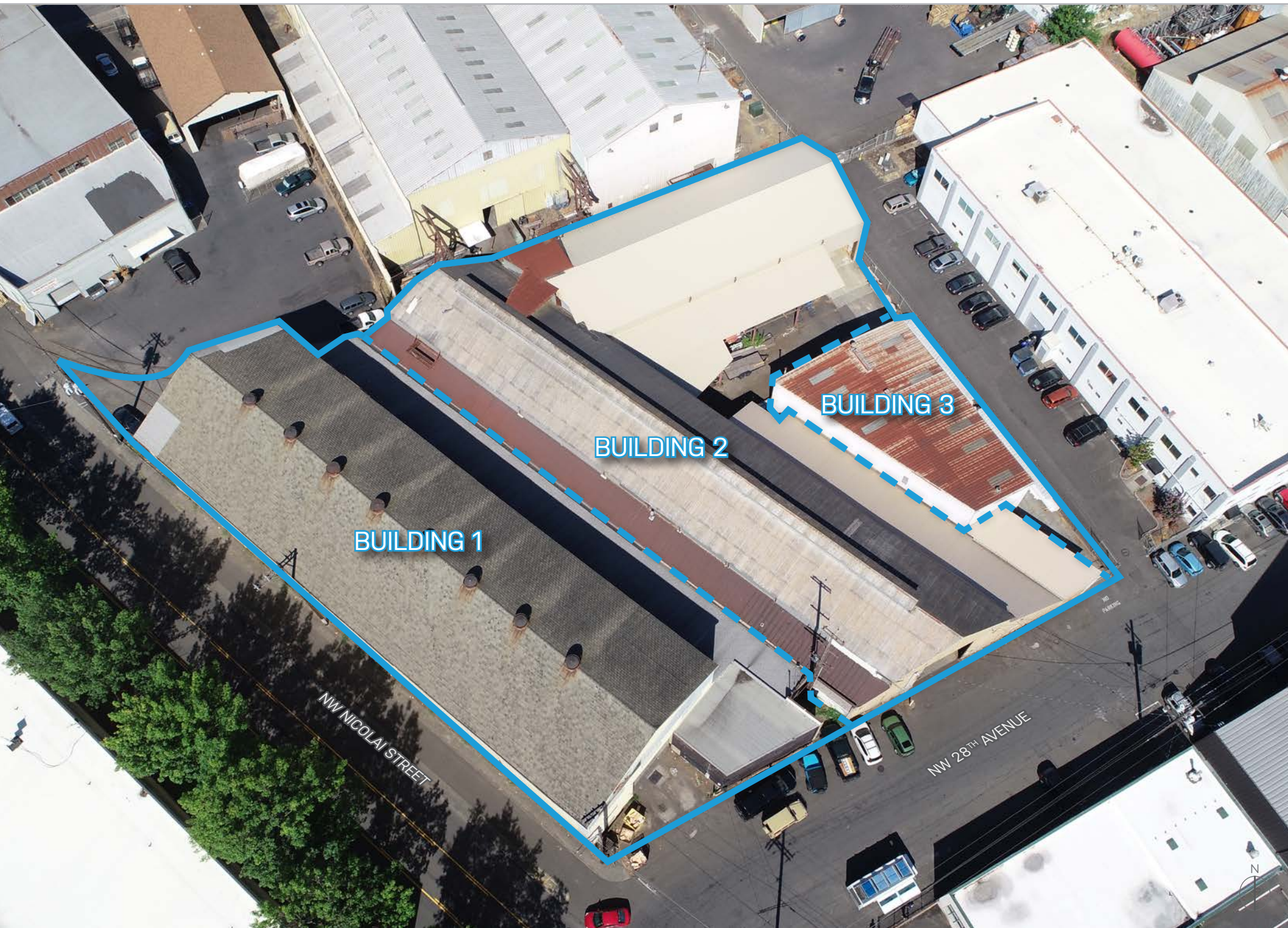

BUILDING 1

BUILDING 2

BUILDING 3

NW NICOLAI STREET

NW 28TH AVENUE



EXCELLENT VISIBILITY IN A SUPERIOR GUILDS LAKE LOCATION



No warranty or representation, express or implied, is made as to the accuracy of the information contained herein, and same is submitted subject to errors, omissions, change of price, rental or other conditions, withdrawal without notice, and to any special listing condition imposed by our principals.