

# WORLD PARK UNION CENTRE 9245

9245-9251 Meridian Way, West Chester, OH 45069



## PROPERTY HIGHLIGHTS

- 316,800-square-foot, cross-dock facility
- 30' clear height
- 40' x 44' column bay spacing
- 2 dock doors
- ESFR sprinkler system
- Convenient access to I-75 and I-275
- Located in West Chester Township
- 0% local earnings tax
- Numerous amenities nearby

## PROPERTY LOCATION



### LOCAL MARKET CONTACTS

**John Gartner** | 513.562.2207 | john.gartner@colliers.com

**Ben Struewing** | 614.932.6020 | ben.struewing@dukerealty.com



# WORLD PARK UNION CENTRE 9245

9245-9251 Meridian Way, West Chester, OH 45069

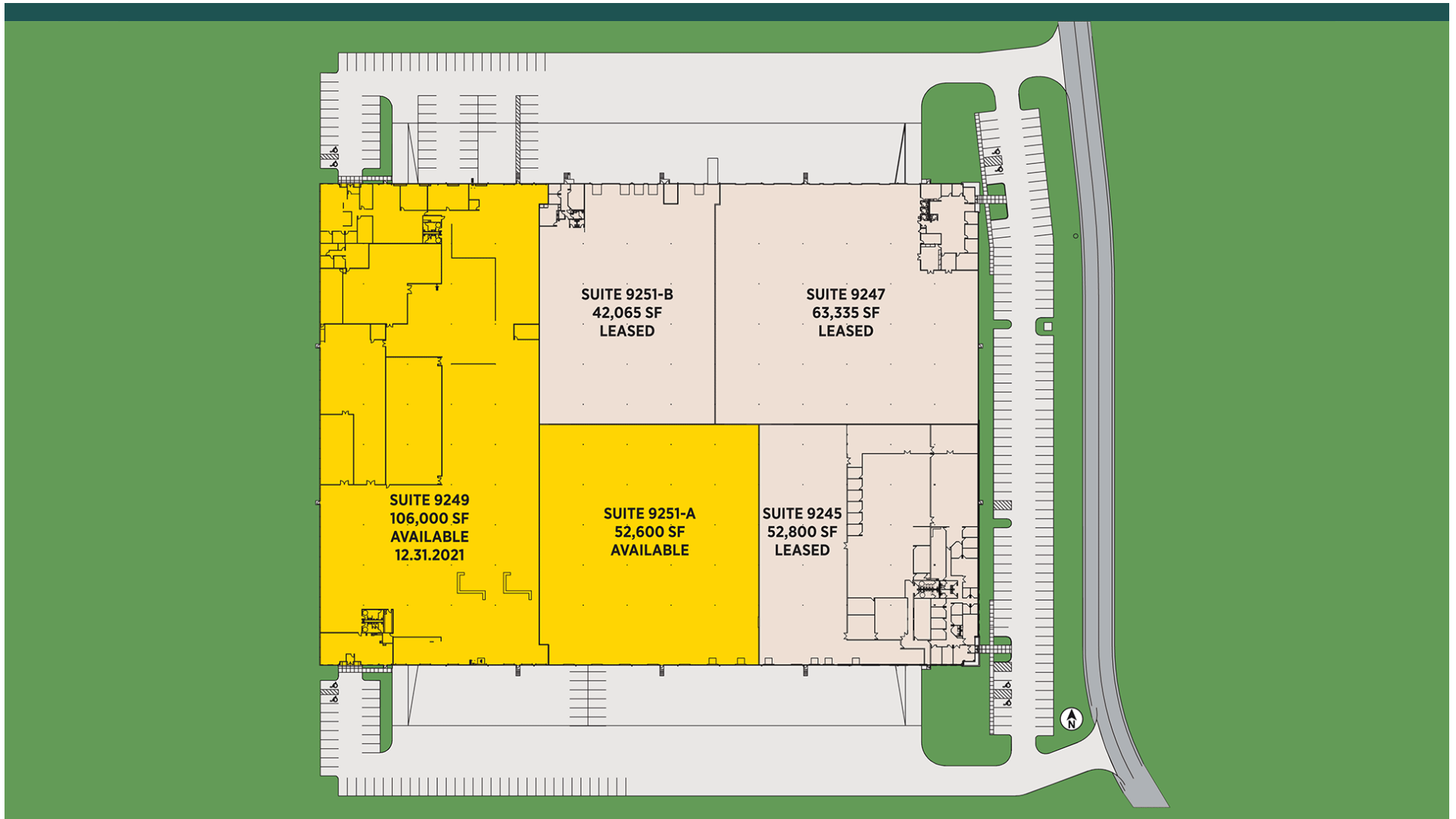

## LOCAL MARKET CONTACTS

John Gartner | 513.562.2207 | john.gartner@colliers.com

Ben Struewing | 614.932.6020 | ben.struewing@dukerealty.com



# WORLD PARK UNION CENTRE 9245

9245-9251 Meridian Way, West Chester, OH 45069

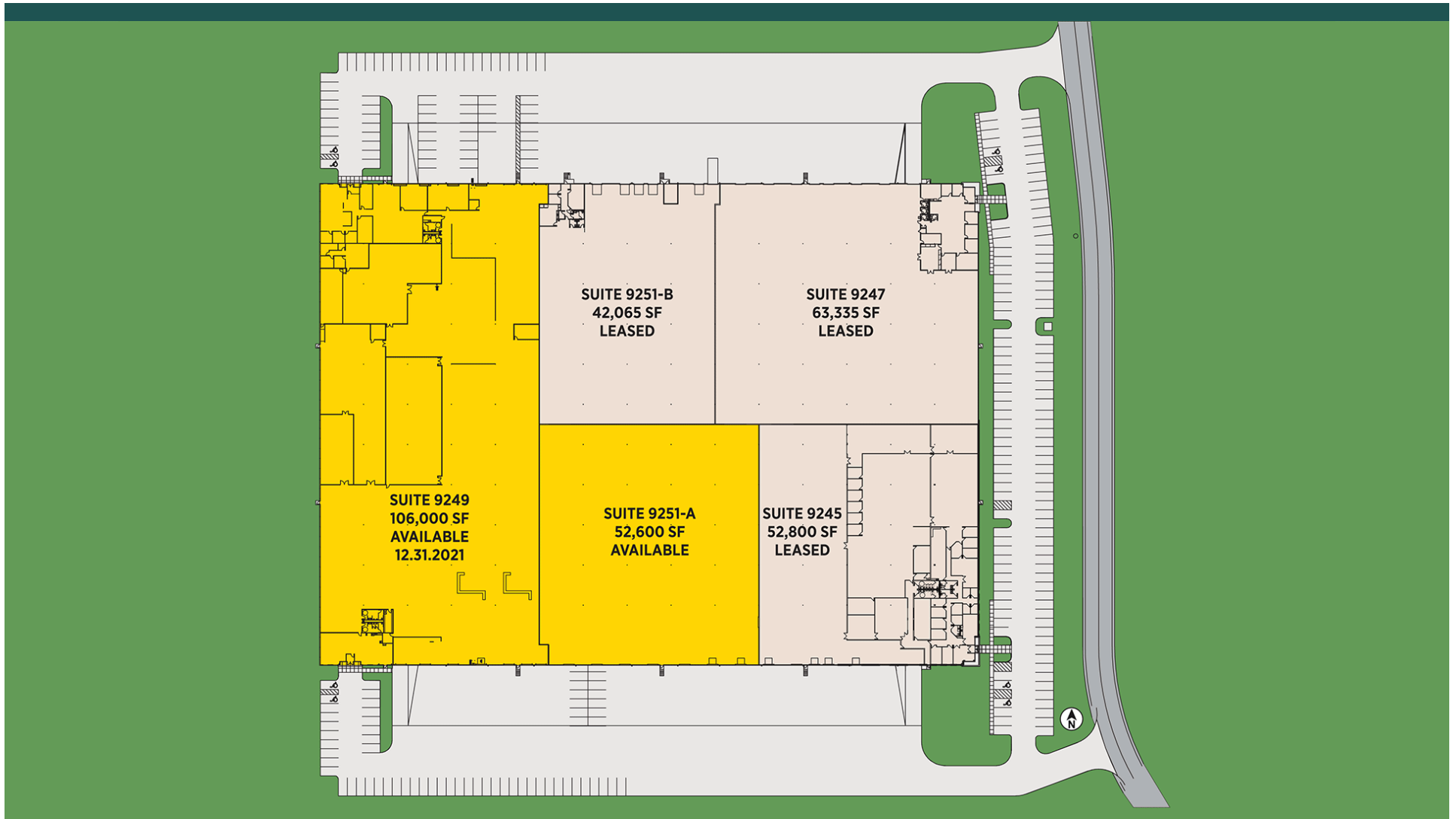

## LOCAL MARKET CONTACTS

John Gartner | 513.562.2207 | john.gartner@colliers.com

Ben Struewing | 614.932.6020 | ben.struewing@dukerealty.com

# WORLD PARK AT UNION CENTRE

Mulhauser & Allen Roads, West Chester, OH 45069



## PARK HIGHLIGHTS

- ¼ mile from I-75 (Union Centre exit)
- Located in West Chester Township
- 0% local earnings tax
- Numerous amenities nearby

## PARK LOCATION

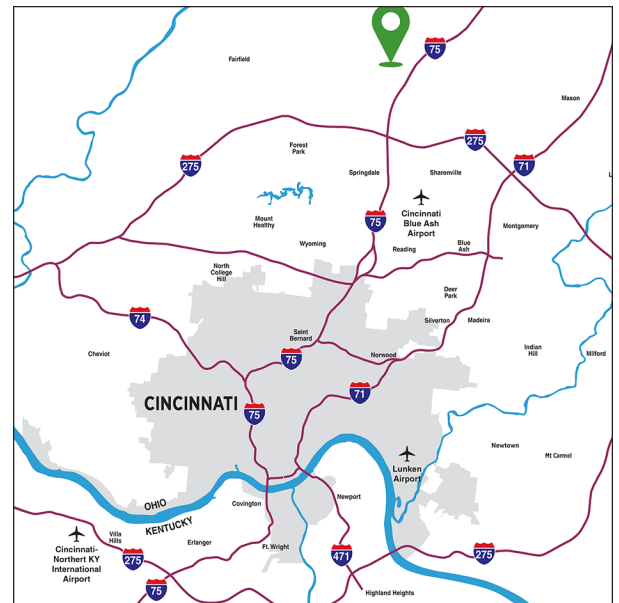

### LOCAL MARKET CONTACT

Ben Struewing | 614.932.6020 | ben.struewing@dukerealty.com