



AVAILABLE FOR SUBLEASE

601 WALNUT STREET, PHILADELPHIA, PA

HIGHLIGHTS

- Plug-and-play opportunity available immediately
- 2nd floor sublet opportunity (up to 15,786 RSF)
- Sublease Expiration - March 31, 2030
- Two mid-size conference rooms, three breakout rooms, one private wellness room, and one large 14-seat boardroom.
- High-tech finishes with all furniture available
- Professional copying machines available for tenant use
- Large open kitchen area with seating, automatic coffee maker, and two large refrigerators
- Flexible sublease term

LOCATION DESCRIPTION

Located in the heart of the Washington Square Park with excellent views and access of the square.

Great access to all public transportation

Front and back entrance to space

Elevator lobby exposure

CONTACTS

Matt Lipson
Associate
215.803.5100
mlipson@binswanger.com

Jason Kramer
Partner & Senior Vice President
O: 215.448.6051 | C: 609.828.2685
jkramer@binswanger.com

Joshua Haber
Partner & Senior Vice President
O: 215.448.6099 | C: 267.738.7157
jhaber@binswanger.com

Two Logan Square
Philadelphia, PA 19103
Phone: 215.448.6000
binswanger.com

The information contained herein is from sources deemed reliable, but no warranty or representation is made as to the accuracy thereof and no liability may be imposed.



CONTACTS

Matt Lipson
Associate
215.803.5100
mlipson@binswanger.com

Jason Kramer
Partner & Senior Vice President
O: 215.448.6051 | C: 609.828.2685
jkramer@binswanger.com

Joshua Haber
Partner & Senior Vice President
O: 215.448.6099 | C: 267.738.7157
jhaber@binswanger.com

Two Logan Square
Philadelphia, PA 19103
Phone: 215.448.6000
binswanger.com

The information contained herein is from sources deemed reliable, but no warranty or representation is made as to the accuracy thereof and no liability may be imposed.

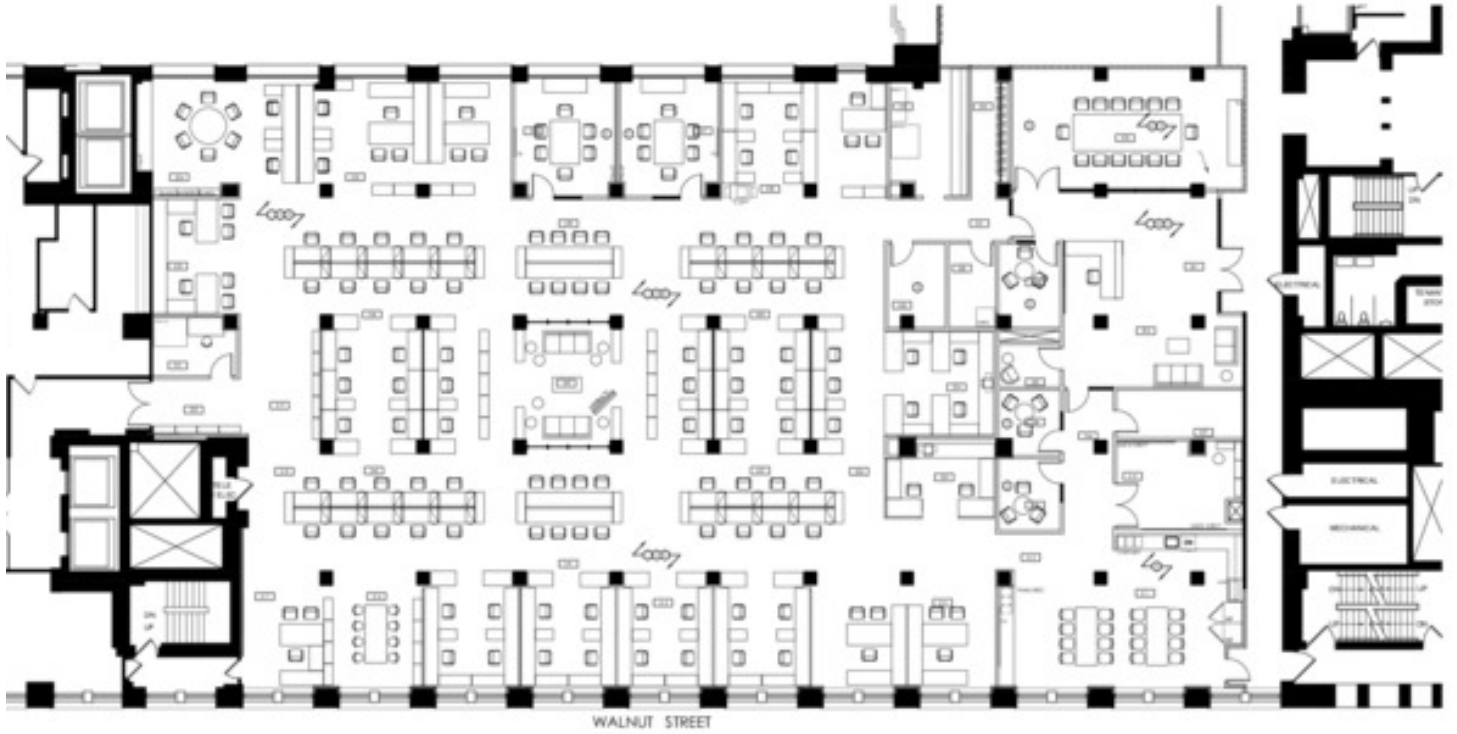

FURNITURE PLAN
SCALE 1/8" = 1'-0"

CONTACTS

Matt Lipson
Associate
215.803.5100
mlipson@binswanger.com

Jason Kramer
Partner & Senior Vice President
O: 215.448.6051 | C: 609.828.2685
jkramer@binswanger.com

Joshua Haber
Partner & Senior Vice President
O: 215.448.6099 | C: 267.738.7157
jhaber@binswanger.com

Two Logan Square
Philadelphia, PA 19103
Phone: 215.448.6000
binswanger.com

The information contained herein is from sources deemed reliable, but no warranty or representation is made as to the accuracy thereof and no liability may be imposed.