



400 HORSHAM ROAD, HORSHAM, PA

SINGLE-STORY OFFICE SPACE WITH PRIVATE ENTRANCES

HIGHLIGHTS

Last two suites remaining:

- 5,576 SF - Available immediately with plenty of private offices
- 8,821 SF - Can be built out to your desired floor plan. Divisible to 3,121 SF
- Private suite entrances with signage, great window line and ceiling heights
- Great on-site amenities include the Horsham Athletic Club (Individual and Corporate Memberships offered), day care facility, shared meeting room, tenant lounge and café
- Expansive parking lot with the ability to accommodate users with a large parking requirement (5/1000 Parking Ratio)

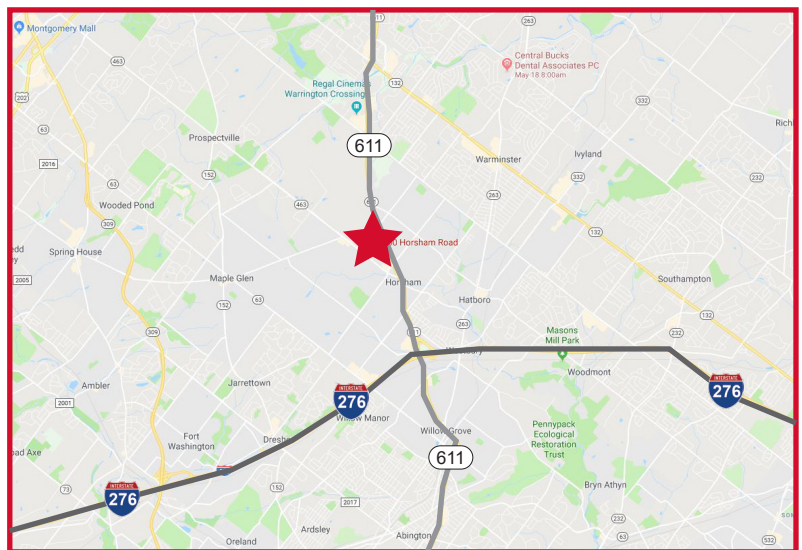

LOCATION OVERVIEW:

Great location on Horsham Road, can be accessed from Easton Road (611), PA Turnpike Access (1.5 miles), and serviced by SEPTA Bus Route 55



CONTACT DETAILS



Doug Kelly
610.270.1270

dkelly@binswanger.com

BINSWANGER

International Real Estate
Two Logan Square, Philadelphia, PA, 19103
Phone: 215.448.6000
Fax: 215.448.6238
binswanger.com

The information contained herein is from sources deemed reliable, but no warranty or representation is made as to the accuracy thereof and no liability may be imposed.

FLOORPLAN



ROUTE 611/EASTON ROAD

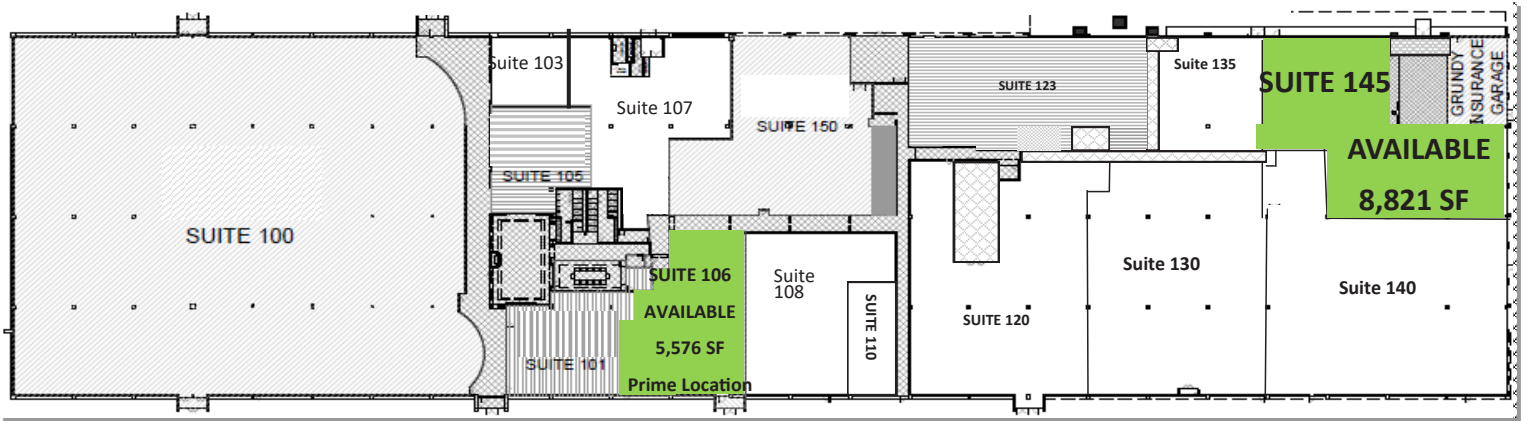

400 HORSHAM ROAD

COMMON AREA

SUITE 106 AVAILABLE 5,576 SF
SUITE 145 AVAILABLE 8,821 SF

CONTACT DETAILS



Doug Kelly
610.270.1270

dkelly@binswanger.com



International Real Estate
Two Logan Square, Philadelphia, PA, 19103
Phone: 215.448.6000
Fax: 215.448.6238
binswanger.com

The information contained herein is from sources deemed reliable, but no warranty or representation is made as to the accuracy thereof and no liability may be imposed.