

369

PINE

STREET

SAN FRANCISCO



maven
RETAIL

FINANCIAL DISTRICT

RETAIL/RESTAURANT/CAFE

WITH ADJACENT OUTDOOR COURTYARD



NEW TO MARKET

Built in 1918, The Exchange Block Building is an 8-story property located in the epicenter of San Francisco's Financial District. It was designed by Frederick Whitton, and is considered one of the most attractive period buildings in the Financial District. Its historic elements are nicely blended with modern conveniences, and the building's operations are supported by a best of class, long-term, stable ownership group.

The subject space is located on the northeast corner of the property, and enjoys high traffic and visibility from Pine Street. The space boasts high ceilings, big windows, and a spacious floor plan. Its most attractive feature is the adjacent courtyard that can be used for outdoor seating, fitness, or other related outdoor activities. Although the space was last used as a café, its location in the FiDi fitness hub (with neighbors such as Rumble, Equinox, Bodyrok, and Bay Club) might make it attractive to fitness uses. The space is in close proximity to mass transit systems such as MUNI, BART, and Golden Gate Transit. The East Bay bus line terminal and CalTrain are also easily accessible via the City's Muni bus and train system.



FEATURES



FEATURES

- +/- 4,473 SF located in the core of San Francisco's Financial District
- Corner space that sits adjacent to a spacious courtyard that can accommodate outdoor seating or fitness activities
- Ceiling heights up to 20'.5".
- Over 130 feet of storefront starting on Pine Street and running the length of the courtyard
- Excellent signage opportunity with two highly noticeable blade signs
- Excellent visibility from the busy Pine Street corridor
- High pedestrian and vehicle traffic
- Located in one of San Francisco's classic early century buildings
- Nearby neighbors include Equinox, Blue Bottle Coffee, Rumble, Wayfare Tavern, The Treasury, Bodyrok, and more.
- Close proximity to MUNI/BART/Transbay Terminal

Floor Plan

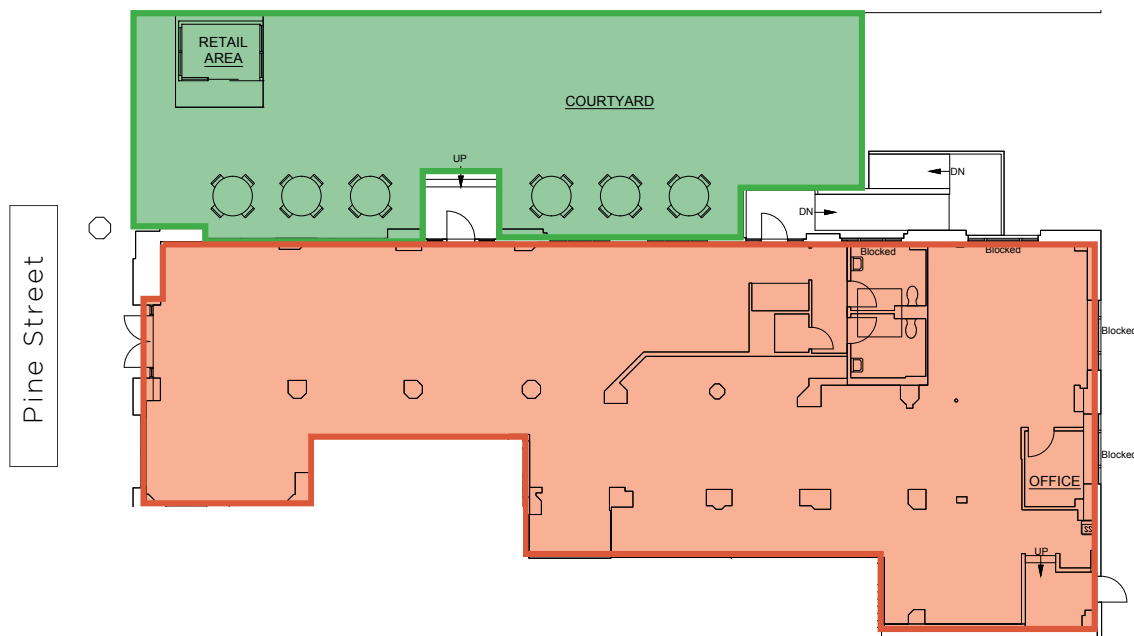

369 PINE MAP



Ferry Building

The Embarcadero

Washington Street

Jackson Street

Kokkari
5A5 Steak Lounge

Schott NYC
Aesop

diPietro Todd Salon

Isabel Marant
Shinola

Verjus
Kusakabe

Barbarossa

Leo's

Palio

Ladle & Leaf

Sansome Street
FEIT
Bix

Filson
Zimmermann

The Rug Company

Quince

William Stout
Architectural Books

Fjällräven

Montgomery Street

Cotogna

Roka | Bar

Bask

Lost Coast Outfitters

Columbus Street

Trestle

Kerry Street

Financial District

Four Seasons (2020)

Rumble

Planet Fitness

Chase Bank

Transamerica Pyramid

Orangetheory Fitness

The Julia Morgan Ballroom

Sterling Bank & Trust

Walgreens

Wayfare Tavern

One Medical

Omni San Francisco

Le Méridien



SOMA

Salesforce Tower



Bank of America Financial Center

Montgomery Station



Blue Bottle Coffee

Philz Coffee

369 PINE STREET
SAN FRANCISCO

Charles Schwab

Powell Station



24 Hour Fitness

Ladle & Leaf

Crocker Galleria

Equinox

The City Club of San Francisco

Market Street

Credo

Cafe Venue

Sam's Grill & Seafood Restaurant

Juice Shop

Cafe Bastille

B44 Catalan Bistro

Wells Fargo

Pine Street

California Street

Sacramento Street



NEIGHBORHOOD



POTENTIAL USES

C-3-0 ZONING





PINE STREET

SAN FRANCISCO

PAMELA MENDELSON

office 415.404.6650
pam@mavenproperties.com
DRE #00953050

SARAH BRETT SCHWARTZ

office 415.404.6959
sarah@mavenproperties.com
DRE #01903152

SANTINO DEROSE

office 415.404.7337
sd@mavenproperties.com
DRE #01338326

HALEY KLEIN

office 415.404.7330
haley@mavenproperties.com
DRE #01907308

maven
RETAIL

NOTICE: This information has been secured from sources we believe to be reliable but we make no representations, warranties, express or implied, as to the accuracy of the information. Listing broker has been given enough information to provide only a preliminary interest in the property. The materials are not to be considered fact. The information contained herein is not a substitute for thorough due diligence investigation. References to square footage, zoning, use, or age are approximate. Please contact the San Francisco Planning Department to verify zoning at (415) 558-6378, as neither broker or landlord represent that this space is suitable for your use. Tenant or Buyer must verify the information at their own expense and bears all the risk for any inaccuracies. By receiving these materials you are agreeing to the disclaimers set forth herein. DRE#01878802