

FOR LEASE

Anchor/Junior Box at Park Place Mall

5950 E Broadway Blvd | Tucson, AZ 85711



Overview

AVAILABLE 168,900 SF (divisible; 2 levels)

RATES Call for Rates

Demographics

	3 MILE	5 MILE	10 MILE
2020 Est Population	124,583	260,504	660,030
Average HH Income	\$58,864	\$66,149	\$70,430
Daytime Population	140,389	276,325	691,015

Year: 2020 | Source: Esri

Traffic Counts

Broadway Boulevard	52,750 VPD
Wilmot Road	41,586 VPD

Year: 2020 | Source: MPSI

Contact

BRIAN POLACHEK
602.682.6045
brian.polachek@srsre.com

SCOTT ELLSWORTH
602.682.6063
scott.ellsworth@srsre.com

MIKE POLACHEK
602.682.6080
mike.polachek@srsre.com

ED BEEH
602.682.6040
ed.beeh@srsre.com

Description

- Join Round 1, now open and operating
- Prominent location at Park Place Mall
- Highest volume mall is Southern Arizona (\$500 PSF)
- Major retail hub at Broadway Boulevard and Wilmot Road with great visibility to over 94,000 vehicles per day at the intersection
- Diverse mix of restaurant, retail and services uses
- Anchor, junior anchor and pad opportunities available
- Anchored by:

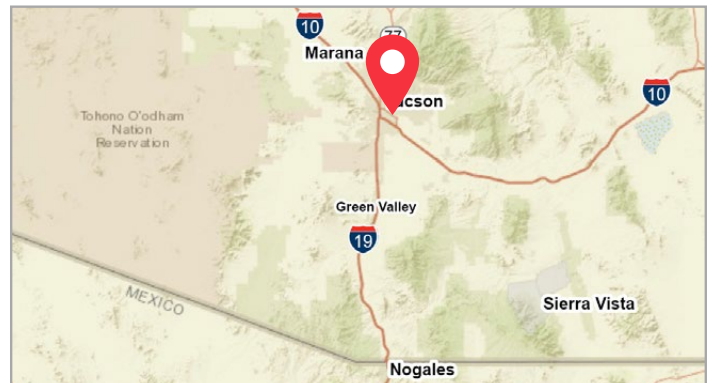

Park Place Mall

5950 East Broadway Boulevard | Tucson, Arizona 85711

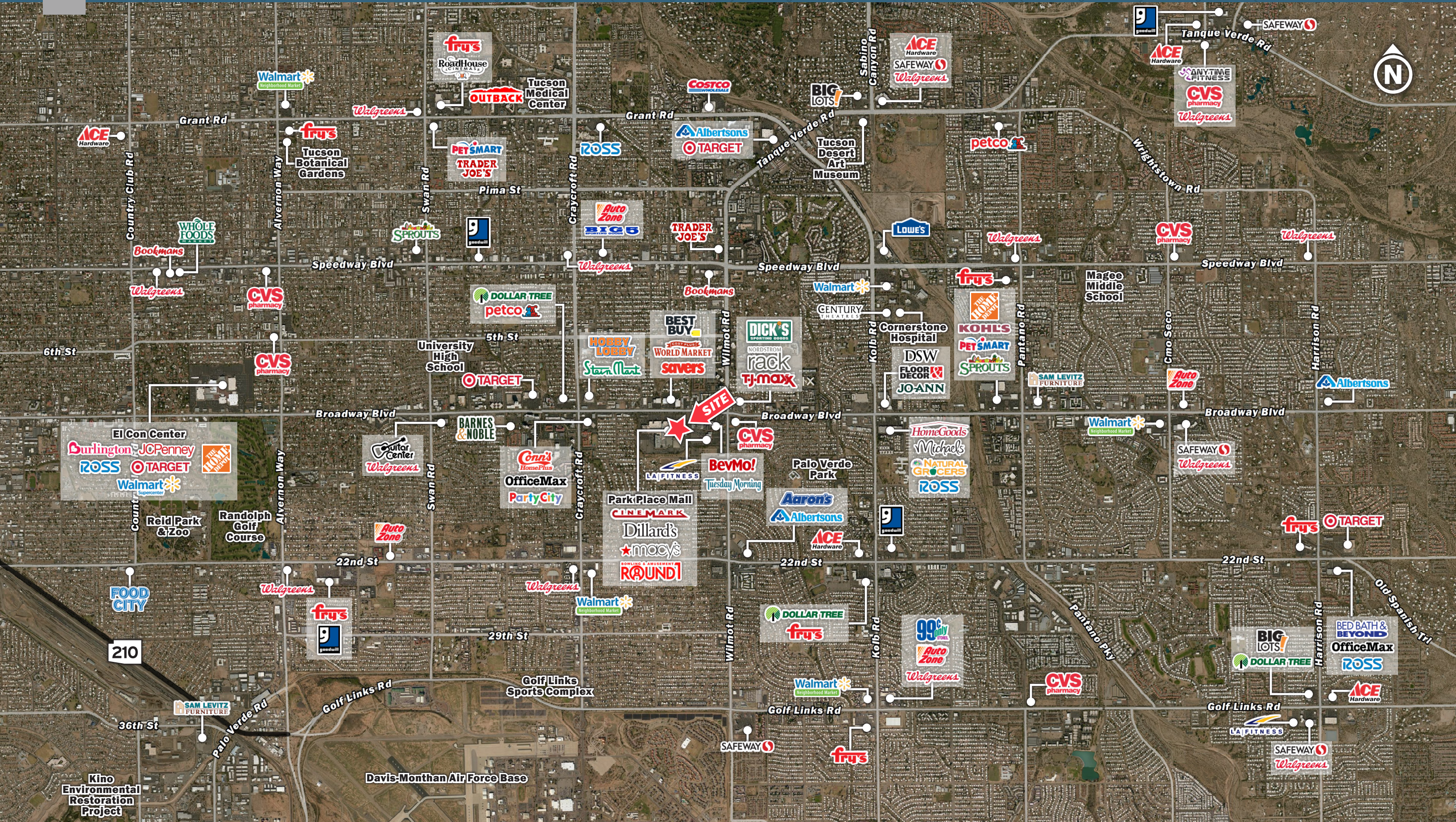

El Con Center
 Burlington JCPenney
 ROSS TARGET
 Walmart
 Home Depot

SITE
 BeMo!
 Tuesday Morning
 Aaron's
 Albertsons
 ACE Hardware
 Dillard's
 macy's
 ROUND1

BIG LOTS!
 DOLLAR TREE
 OfficeMax
 ROSS
 ACE Hardware

Anchor/Junior Box at Park Place Mall

5950 E Broadway Blvd | Tucson, AZ 85711

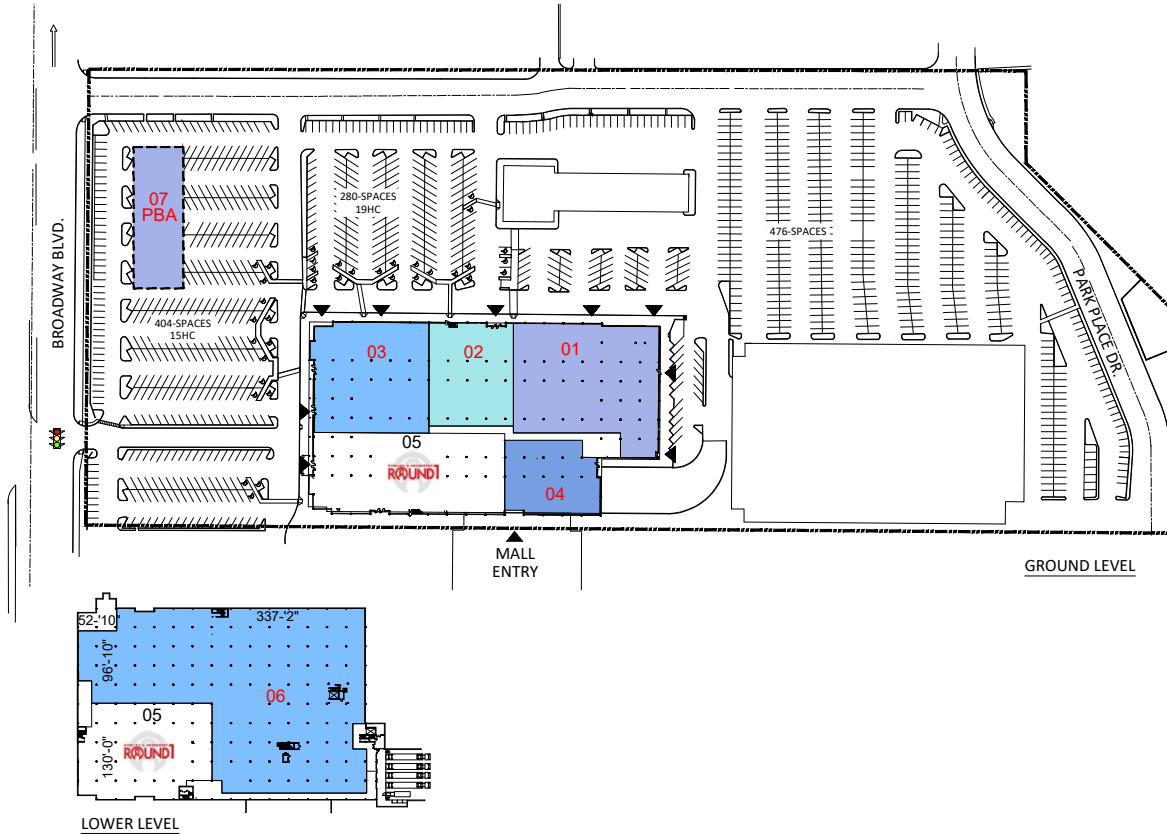

TUSCON, AZ - 219,450 SF

● 01 AVAILABLE	30,900 SF	● 04 AVAILABLE	12,050 SF	● 07 AVAILABLE - PBA	14,000 SF
● 02 AVAILABLE	15,850 SF	○ 05 ROUND 1	50,550 SF		
● 03 AVAILABLE	23,450 SF	● 06 AVAILABLE	72,650 SF		

Anchor/Junior Box at Park Place Mall

5950 E Broadway Blvd | Tucson, AZ 85711



	3 miles	5 miles	10 miles
Population			
2000 Population	121,132	250,711	585,875
2010 Population	119,538	250,062	624,246
2020 Population	124,583	260,504	660,030
2025 Population	127,688	267,081	680,936
2000-2010 Annual Rate	-0.13%	-0.03%	0.64%
2010-2020 Annual Rate	0.40%	0.40%	0.55%
2020-2025 Annual Rate	0.49%	0.50%	0.63%
2020 Male Population	48.6%	48.7%	49.2%
2020 Female Population	51.4%	51.3%	50.8%
2020 Median Age	39.3	39.6	36.7
Households			
2000 Households	53,838	109,277	236,144
2010 Households	53,167	110,368	252,062
2020 Total Households	55,768	115,645	267,042
2025 Total Households	57,257	118,734	275,990
2000-2010 Annual Rate	-0.13%	0.10%	0.65%
2010-2020 Annual Rate	0.47%	0.46%	0.56%
2020-2025 Annual Rate	0.53%	0.53%	0.66%
2020 Average Household Size	2.19	2.21	2.40
Housing Units			
2020 Total Housing Units	63,099	128,677	298,131
2020 Owner Occupied Housing Units	24,923	56,049	139,166
2020 Renter Occupied Housing Units	30,845	59,595	127,876
2020 Vacant Housing Units	7,331	13,032	31,089
Race and Ethnicity			
2020 White Alone	71.0%	72.6%	68.6%
2020 Black Alone	6.6%	5.9%	4.7%
2020 American Indian/Alaska Native Alone	1.8%	1.8%	2.6%
2020 Asian Alone	3.6%	3.9%	3.8%
2020 Pacific Islander Alone	0.3%	0.3%	0.2%
2020 Hispanic Origin (Any Race)	32.4%	31.1%	42.4%
Income			
2020 Median Household Income	\$43,384	\$47,346	\$48,047
2020 Average Household Income	\$58,864	\$66,149	\$70,430
2020 Per Capita Income	\$26,437	\$29,470	\$28,584
2019 Population 25+ by Educational Attainment			
Total	88,672	185,891	444,318
High School Graduate	19.6%	17.9%	18.0%
GED/Alternative Credential	4.2%	3.8%	4.2%
Some College, No Degree	26.7%	26.0%	24.0%
Associate Degree	9.7%	9.8%	8.8%
Bachelor's Degree	18.4%	19.5%	18.4%
Graduate/Professional Degree	12.3%	14.6%	14.2%
Daytime Population			
2020 Total Daytime Population	140,389	276,325	691,015
Workers	70,027	130,337	312,307
Residents	70,362	145,988	378,708

Source: Esri, U.S. Census