

FOR LEASE

Greenway & Tatum Center

SWC Greenway Rd & Tatum Blvd | Phoenix, AZ



Overview

AVAILABLE 2,300 SF
PRICE Call for Details

Demographics

	1 MILE	3 MILE	5 MILE
2020 Est Population	14,363	123,808	247,851
2025 Est Population	14,896	130,341	265,169
Average HH Income	\$126,677	\$100,615	\$110,706
Daytime Population	10,413	109,078	267,973

Year: 2020 | Source: Esri

Traffic Counts

Tatum Boulevard	33,695 VPD
Greenway Road	35,916 VPD

Year: 2020 | Source: MPSI

Contact

BRIAN POLACHEK

602.682.6045 | brian.polachek@srsre.com



Description

- Monument signage available on Tatum Blvd
- Outstanding North Phoenix location
- Close proximity to Paradise Valley Mall, Kierland, Scottsdale Quarter & Desert Ridge Marketplace
- Excellent visibility from Tatum Blvd
- Owner/Agent
- Join:



SRS | 3131 E Camelback Road, Suite 110 | Phoenix, AZ 85016 | 602.682.6000

This information contained herein was obtained from sources deemed to be reliable; however SRS makes no guarantees, warranties or representations as to the completeness or accuracy thereof.

Owner/Agent

SRSRE.COM

Greenway & Tatum Center

SWC Greenway Rd & Tatum Blvd | Phoenix, AZ



GREENWAY RD

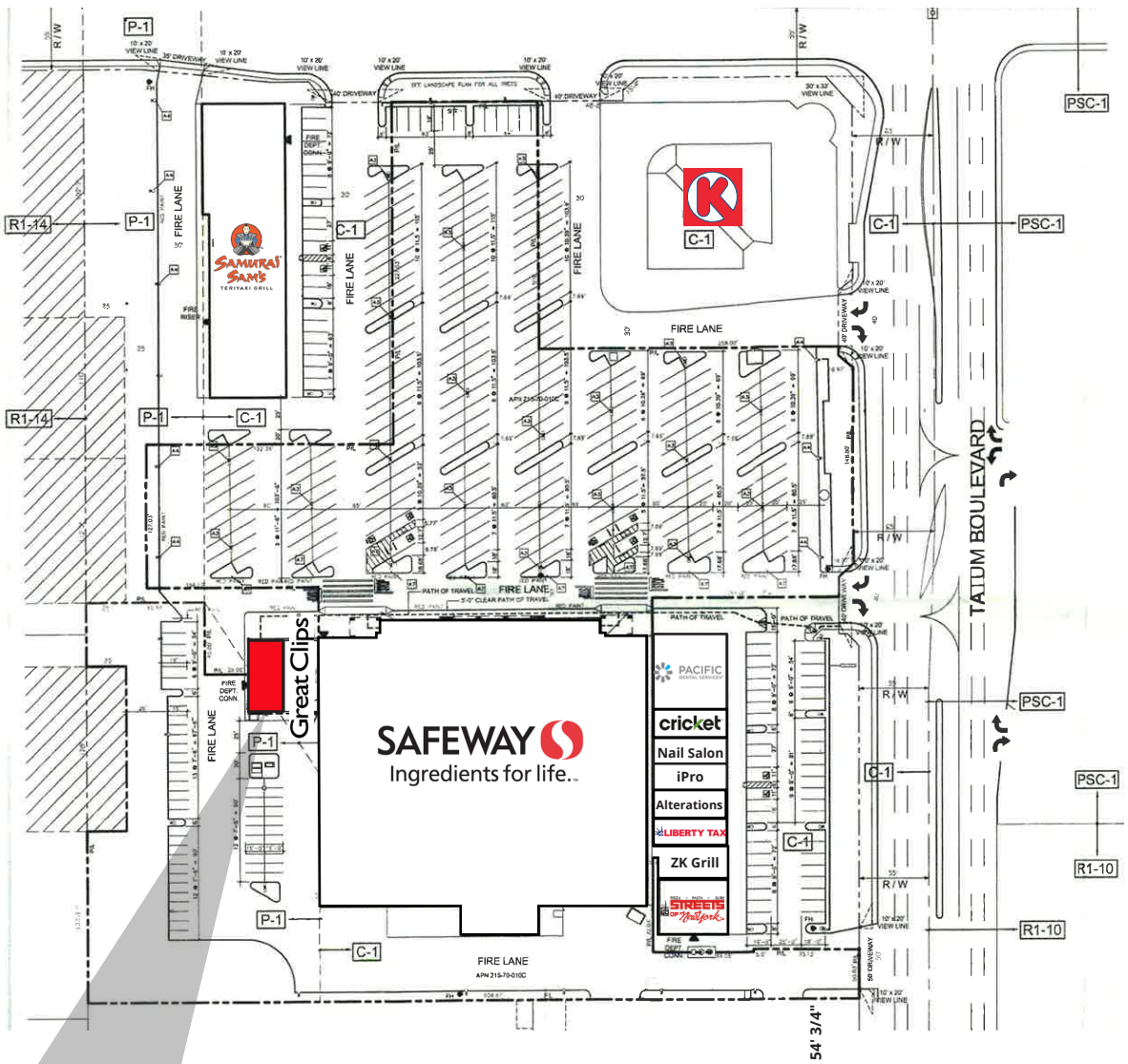

**AVAILABLE
2,300 SF**



Greenway & Tatum Center

SWC Greenway Rd & Tatum Blvd | Phoenix, AZ

