

1740 POLK STREET

FOR LEASE | San Francisco, CA 94109



NATHAN NIEBERGALL
Sales & Leasing Associate
nathan@starboardnet.com
415.250.4599 | BRE # 01967005

HANS HANSSON
Principal
hans@starboardnet.com
415.517.2589 | BRE #00872902

This information has been secured by Starboard TCN from sources believed to be reliable. It is not guaranteed, however, and should be verified prior to consummating any transaction. California Dept. of Real Estate License # 01103056



1740 POLK STREET SAN FRANCISCO, CA 94109

Suite B

- 2059 SF
- Rate: \$42.00
- Space in Vanilla Shell
- TI's Negotiable

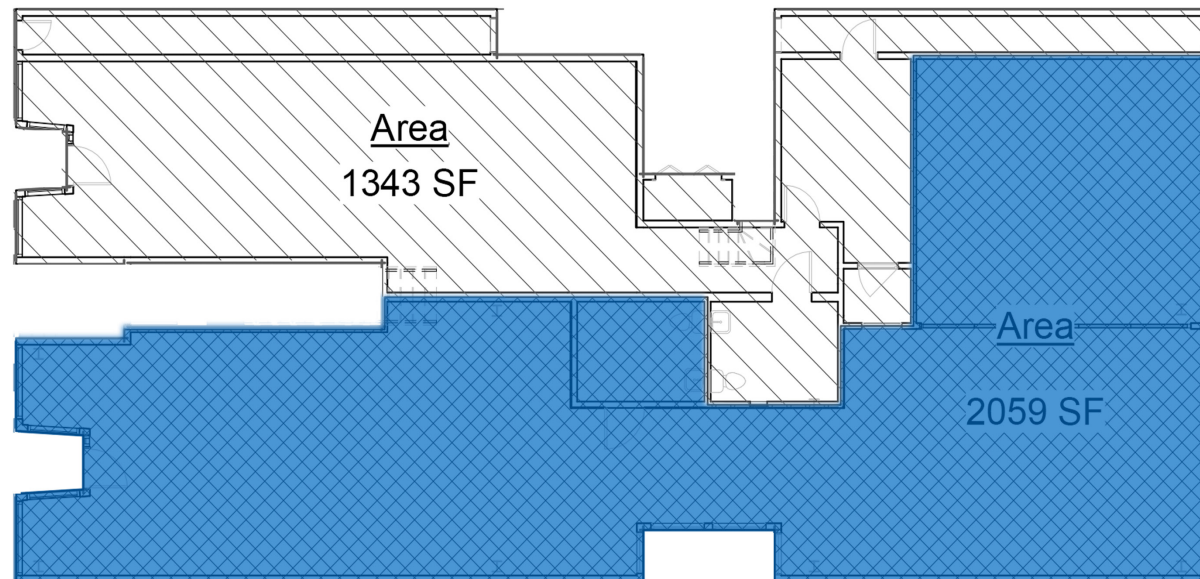

POINTS OF INTEREST

1740 POLK ST
FOR LEASE

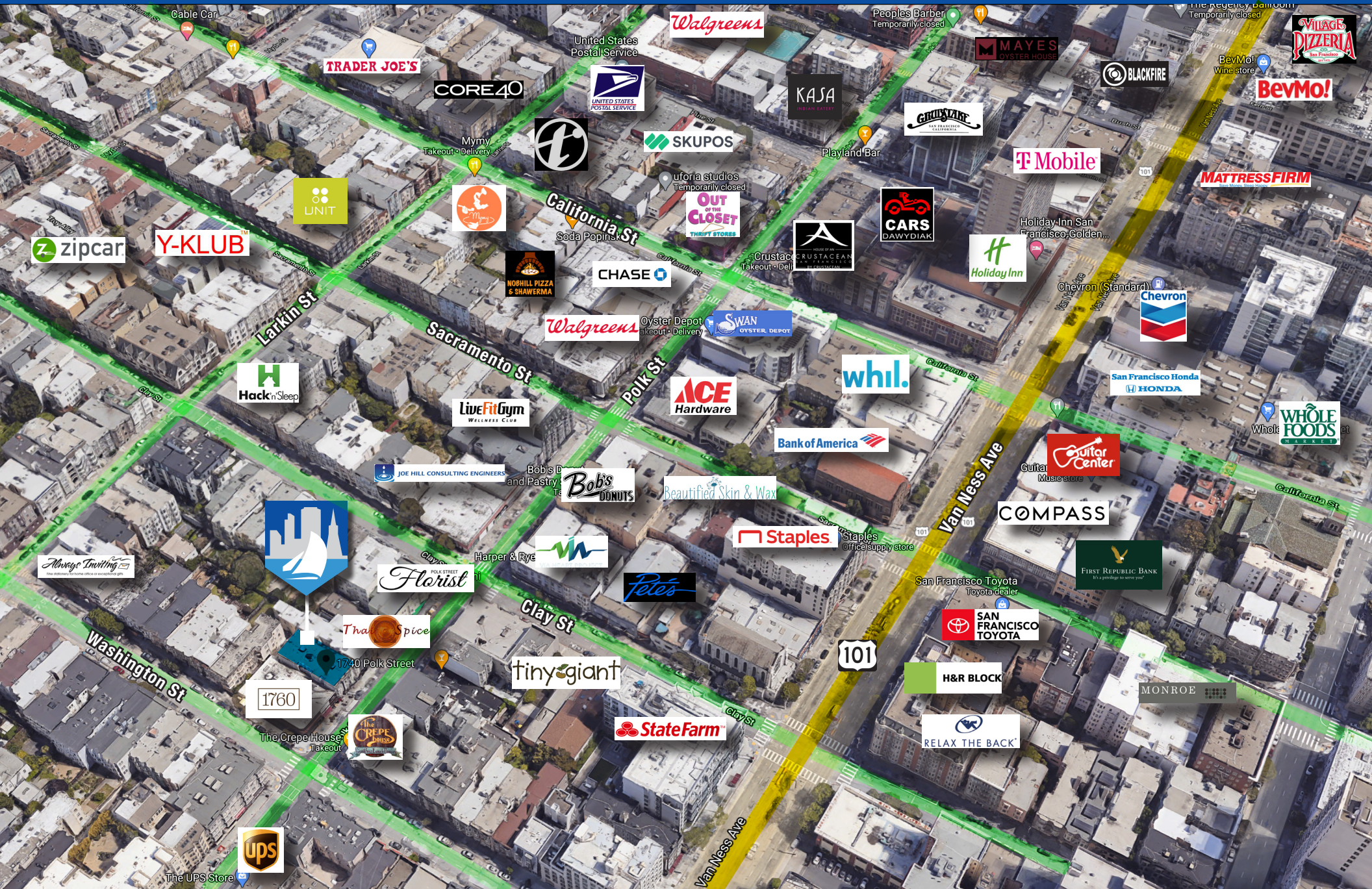

NATHAN NIEBERGALL
Sales & Leasing Associate
nathan@starboardnet.com
415.250.4599 | BRE # 01967005

HANS HANSSON
Principal
hans@starboardnet.com
415.517.2589 | BRE #00872902

This information has been secured by Starboard TCN from sources believed to be reliable. It is not guaranteed, however, and should be verified prior to consummating any transaction. California Dept. of Real Estate License # 01103056



PLACES OF INTEREST

- | | | | | |
|-----------------------|-------------------------------|-----------------|--------------------------|-------------------|
| 1 THE CREPE HOUSE | 5 HARPER & RYE | 9 MOKA COFFEE | 13 CABIN | 17 HAHN'S HIBACHI |
| 2 DOKKAEBIER | 6 CO NAM | 10 TOAST EATERY | 14 THAI SPICE RESTAURANT | |
| 3 EL CAPITAN TAQUERIA | 7 BOB'S DONUT AND PASTRY SHOP | 11 1760 | 15 LOTTA'S BAKERY | |
| 4 CINCH SALOON | 8 DUNYA MEDITERRANEAN | 12 AMELIE | 16 FISH N GARI | |

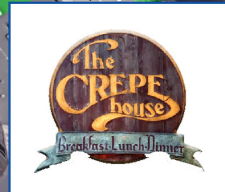

NATHAN NIEBERGALL
Sales & Leasing Associate
nathan@starboardnet.com
415.250.4599 | BRE # 01967005

HANS HANSSON
Principal
hans@starboardnet.com
415.517.2589 | BRE #00872902

This information has been secured by Starboard TCN from sources believed to be reliable. It is not guaranteed, however, and should be verified prior to consummating any transaction. California Dept. of Real Estate License # 01103056

