



THE PROFESSIONAL OFFICES AT
BARCLAY PARK
NOW LEASING



535 NORTH CHURCH STREET | WEST CHESTER, PA

PROPERTY HIGHLIGHTS



THE PROFESSIONAL OFFICES AT
BARCLAY PARK

- +/- 17,400 SF Available
- +/- 5,800 SF Floorplans Available on 3 Floors
- Fully ADA Compliant, High End Finishes with historical accents (new construction)
- High floor to glass line ratio with abundant natural light overlooking a Borough Park
- Elevator serviced, Secured entry 24/7 access to building
- Ample parking onsite
- One Block from West Chester Country Club - Tennis and Golf
- Walking distance to Downtown West Chester
- TI Packages Available for Qualified Tenants



**EXPECTED
DELIVERY**
SPRING *of* 2022

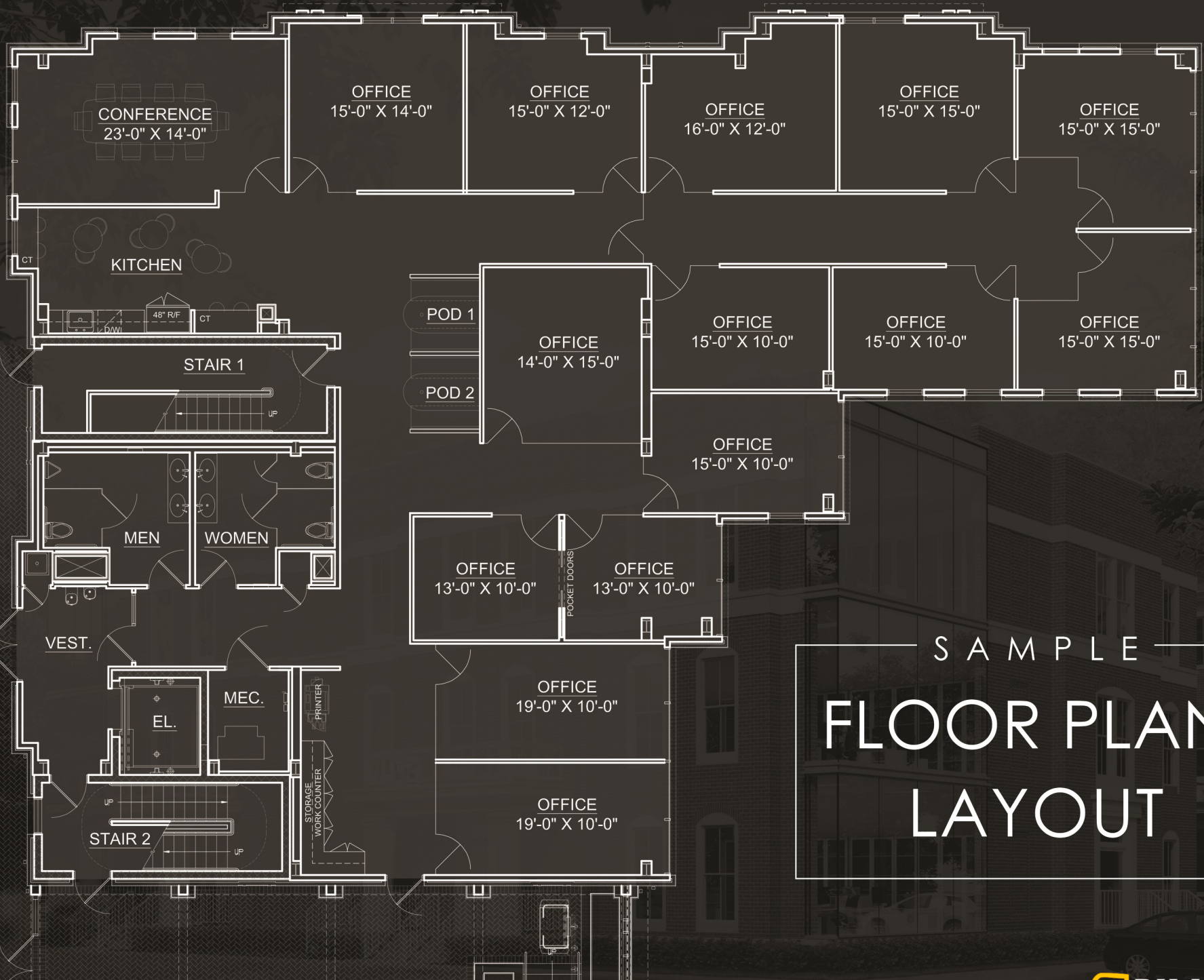

SAMPLE
FLOOR PLAN
LAYOUT

AERIAL VIEW

NORTH HIGH STREET

WEST VIRGINIA AVE

WEST MARSHALL STREET

**17,400 SF
ADDITION
COMING SOON!**

Barclay
Park

On-Site
Parking

NORTH CHURCH STREET

AERIAL VIEW

ROUTE 202

 Penn Medicine
Chester County
Hospital

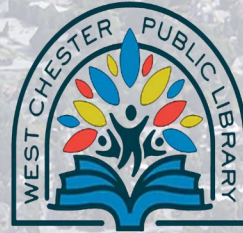

GAY STREET
MARKET STREET

ROUTE 100 HIGH STREET





West Chester

pennsylvania

West Chester is the historic county seat and a vibrant part of the Brandywine River Valley.

With more than 60 shops and 65 restaurants, West Chester can keep you busy for an entire day. Enjoy historic walking tours at your leisure.

West Chester was named to the top ten "Best Small Town Downtowns in the United States" by Bert Sperling and Peter Stander, authors of Best Places to Raise a Family.

Hosting over 100 events annually, West Chester brings thousands of visitors and residents to the area on a regular basis.



@westchesterviews

CONTACT INFORMATION



ERIC KUHN

(484) 887-8202 - EXT 101

EKUHN@PILLARREALESTATEADVISORS.COM

ANDREW TURNER

(484) 887-8202 - EXT 102

ATURNER@PILLARREALESTATEADVISORS.COM

ANDREW CARLINO

(484) 887-8202 - EXT 103

ACARLINO@PILLARREALESTATEADVISORS.COM

"The information contained in this document has been obtained from sources believed reliable. While Pillar Real Estate Advisors, LLC does not doubt its accuracy, Pillar Real Estate Advisors, LLC. has not verified it and makes no guarantee, warranty or representation about it. It is your responsibility to independently confirm its accuracy and completeness. Any projections, opinions, assumptions or estimates used are for example only and do not represent the current or future performance of the property. The value of this transaction to you depends on several factors which should be evaluated by your tax, financial and legal advisors to determine to your satisfaction the suitability of the property for your needs.

Photos herein are the property of their respective owners and use of these images without the express written consent of the owner is prohibited."