

PAUL BROWN LOFTS RETAIL

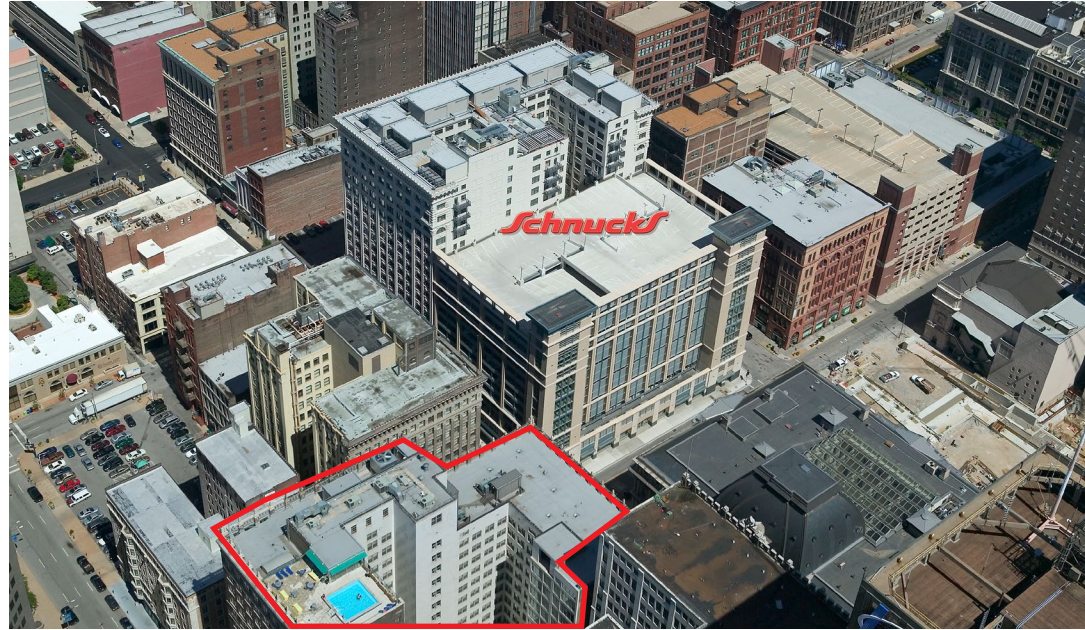

PAUL BROWN LOFTS RETAIL DOWNTOWN, ST. LOUIS

SANSONE
group

FOR LEASE: 1,070 - 2,370 SF





PROPERTY FEATURES

- Located in downtown St. Louis at 9th & Olive next to the renovated Old Post Office and directly across from Schnucks Culineria
- Tenants include People's National Bank, Pitas & More, Dao Tien Bistro and Great Clips
- Outstanding daytime demographics with nearly 90,000 employees in the downtown area
- Area offers high quality infrastructure, including state-of-the-art telecommunications services, redundant power and fiber-optic systems

SEC N. 9TH STREET & OLIVE STREET
206 N 9th Street • St. Louis, MO 63101

Area Demographics

			
1 mile	15,094	7,975	\$70,926
3 miles	81,852	36,451	\$62,695
5 miles	229,443	100,378	\$61,446

FOR MORE INFORMATION PLEASE CONTACT:

Tim McFarland
tmcfarland@sansonegroup.com

For more information, contact:

Tim McFarland
tmcfarland@sansonegroup.com

SANSONE
group

www.sansonegroup.com

314-727-6664

120 S. Central, Suite 500
St. Louis, Missouri 63105



314-727-6664



www.sansonegroup.com



120 S. Central, Suite 500
St. Louis, Missouri 63105

PAUL BROWN LOFTS RETAIL

SANSONE
group

TENANT INDEX

SUITE	TENANT	SQ. FT.
1	AVAILABLE	2,370
2	Dao Tien Bistro	3,573
	Ground Floor	3,153
	Mezzanine	420
3	People's National Bank	5,800
	Ground Floor	2,630
	Mezzanine	3,170
4	AVAILABLE	1,105
5	AVAILABLE	1,070
6	Residential Leasing Office	1,263
7	Pharaoh Donuts	3,252
8	AVAILABLE	2,016

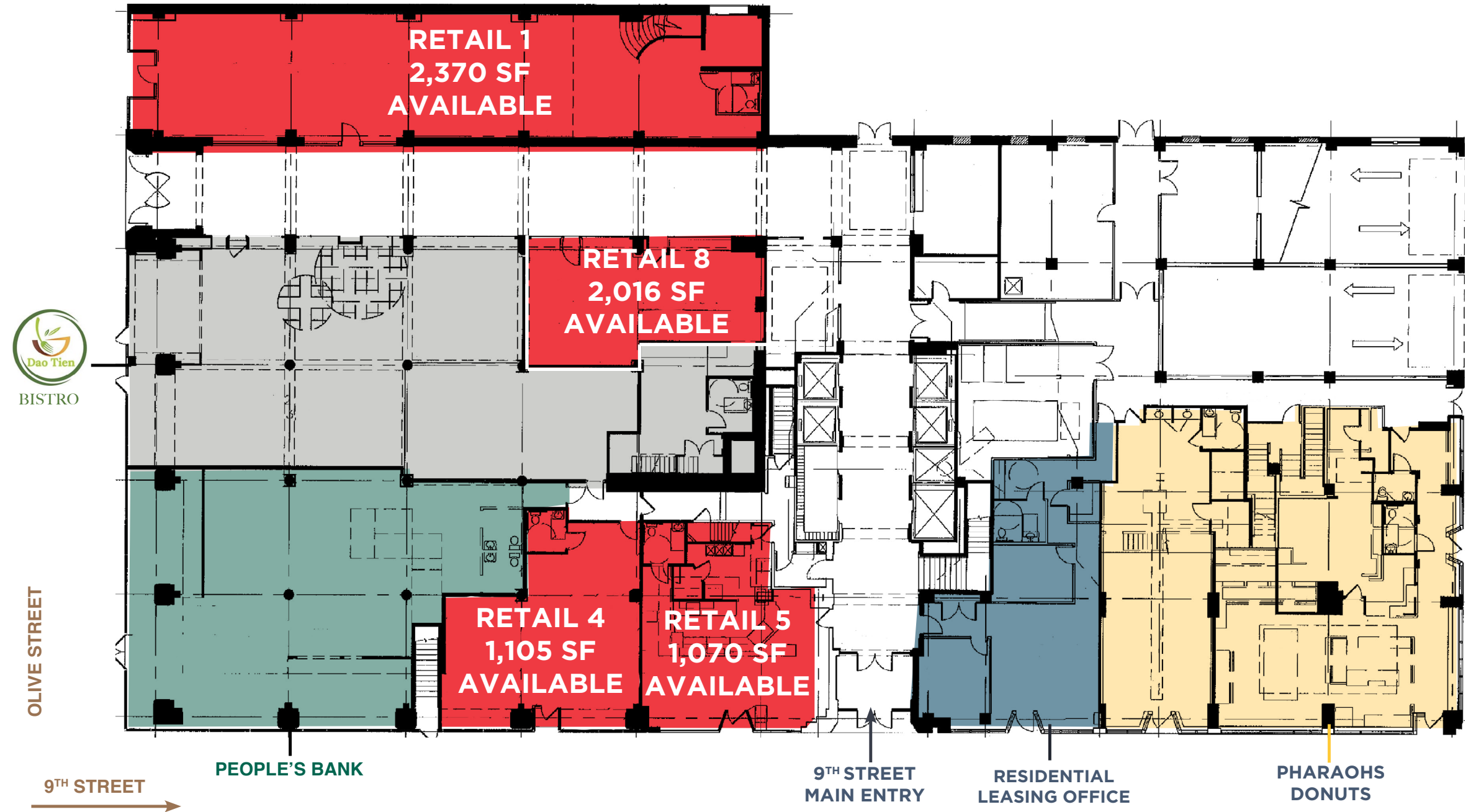

DOWNTOWN ST. LOUIS SNAPSHOT

Downtown St. Louis is the legal, financial and governmental hub and largest employment center in the 16 county, bi-state St. Louis metropolitan area, the 18th largest market in the U.S.

Ideally located at the center of the region and the center of the country, Downtown St. Louis has over 11 million square feet of Class A and B office space and is home to 1,700 businesses with a workforce population of nearly 90,000 employees.

Since 2000, over \$4.5 billion dollars have been invested in the center city spurring a dramatic turnaround that has re-established downtown as the heart and soul of the St. Louis region.