

TENANT INDEX

SUITE	TENANT
40-39	Three Kings Public House
38	Subway
34-35	Clothes Mentor
36-37	Plato's Closet
30-33	SSM Healthcare St. Louis
29	SSM Select Rehab
28	Labcorp
24-27	Skin Institute
21-23	Teacher's Lounge
19-20	Medical West
18	Performance Salon
17	Rosen Optometry
16	Edward D. Jones & Co.
15	AVAILABLE (2,747 SF)
14	Blumenfeld Family Chiropractic
13	AVAILABLE (1,560 SF)
12	AVAILABLE (1,300 SF)
11	Affton Dental
10	AVAILABLE (3,397 SF)
8-9	Old Republic Title
7	Coldstone Creamery
5-6	AVAILABLE (4,740 SF)
1-4	New Seasons Spa
	T.G.I. Friday's
	54th Street Grill
	Ronnie's Cine
Outlot	AVAILABLE (1-2 Acres)

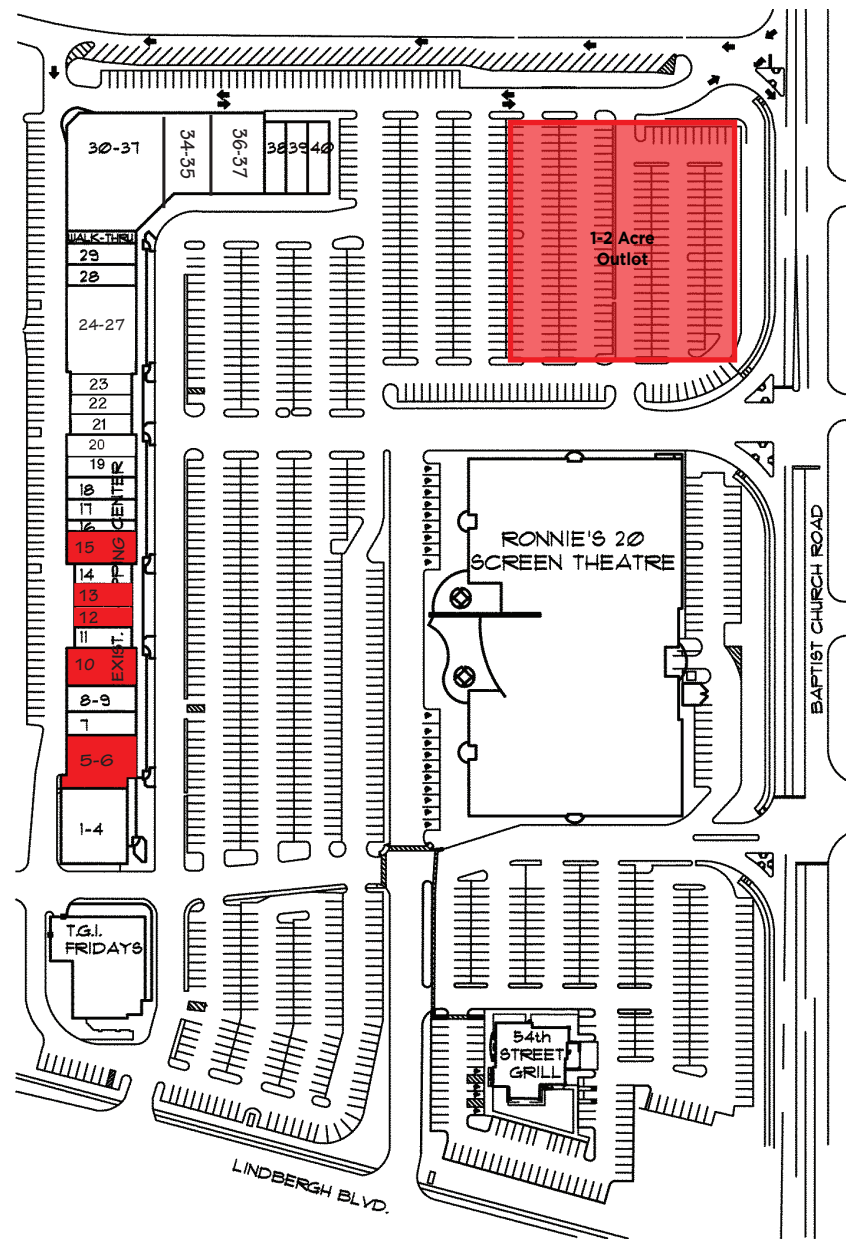

RONNIE'S PLAZA

ST. LOUIS, MISSOURI

SANSONE
group

FOR LEASE: 1,300 - 4,740 SF Retail Space

**1-2 ACRE
OUTLOT
AVAILABLE!**



PROPERTY FEATURES

- 189,309 SF Shopping Center - a Landmark location in South St. Louis County!
- 2nd Gen Medical Space Available
- Retail center features the recently renovated Ronnie's 20-screen cinema, which is the largest grossing theatre in St. Louis
- Easy access to I-270; located one mile east of I-270 and Tesson Ferry Road
- Anchored by Ronnie's Cine, T.G.I. Friday's and 54th Street Grill
- Traffic Volume: 20,215 VPD on Lindbergh Blvd

NWC OF LINDBERGH BLVD. & BAPTIST CHURCH RD.
St. Louis, MO 63117

Area Demographics

3 miles	78,213	34,926	\$93,133
5 miles	216,048	93,312	\$95,722
7 miles	405,760	174,989	\$96,971

For more information, contact:

Tim McFarland
tmcfarland@sansonegroup.com

SANSONE
group

314-727-6664
www.sansonegroup.com



The information contained herein is not warranted, although it has been obtained from the owner of the property or from other sources that we deem reliable. It is subject to change without notice. Seller and broker make no representation as to the environmental condition of the property and recommend purchaser's independent investigation.

314-727-6664

www.sansonegroup.com

120 S. Central, Suite 500
St. Louis, Missouri 63105

