

FOR LEASE

# 8,250 SF HOF'S HUT AVAILABLE (DIVISIBLE)

LOS ALAMITOS PLAZA, 10900 LOS ALAMITOS BOULEVARD, LOS ALAMITOS, CA 90720



## PROPERTY DESCRIPTION

Located at the NEC of Katella Avenue and Los Alamitos Boulevard, the center caters to a strong residential population with excellent day time traffic located near Los Alamitos Hospital.

Restaurant, retail and office space for lease in free standing Los Alamitos building. ±8,250 SF with potential for division in busy shopping center high visibility on Katella Avenue and easy access from both cross-streets. Seeking sit down restaurant concept, dental, gym, adult day care, charter school, real estate office, urgent care, surgical center and more.

Located at the signalized intersection Los Alamitos Boulevard and Katella Avenue -- one of the community's most trafficked retail, office & medical corridors. Surround by a multitude of A+ retailers.

## DEMOGRAPHICS

	1 MILE	3 MILES	5 MILES
Total Population	16,950	170,089	500,220
Average HH Income	\$122,022	\$118,085	\$113,546

FOR LEASE

# LOS ALAMITOS PLAZA

10900 LOS ALAMITOS BOULEVARD, LOS ALAMITOS, CA 90720

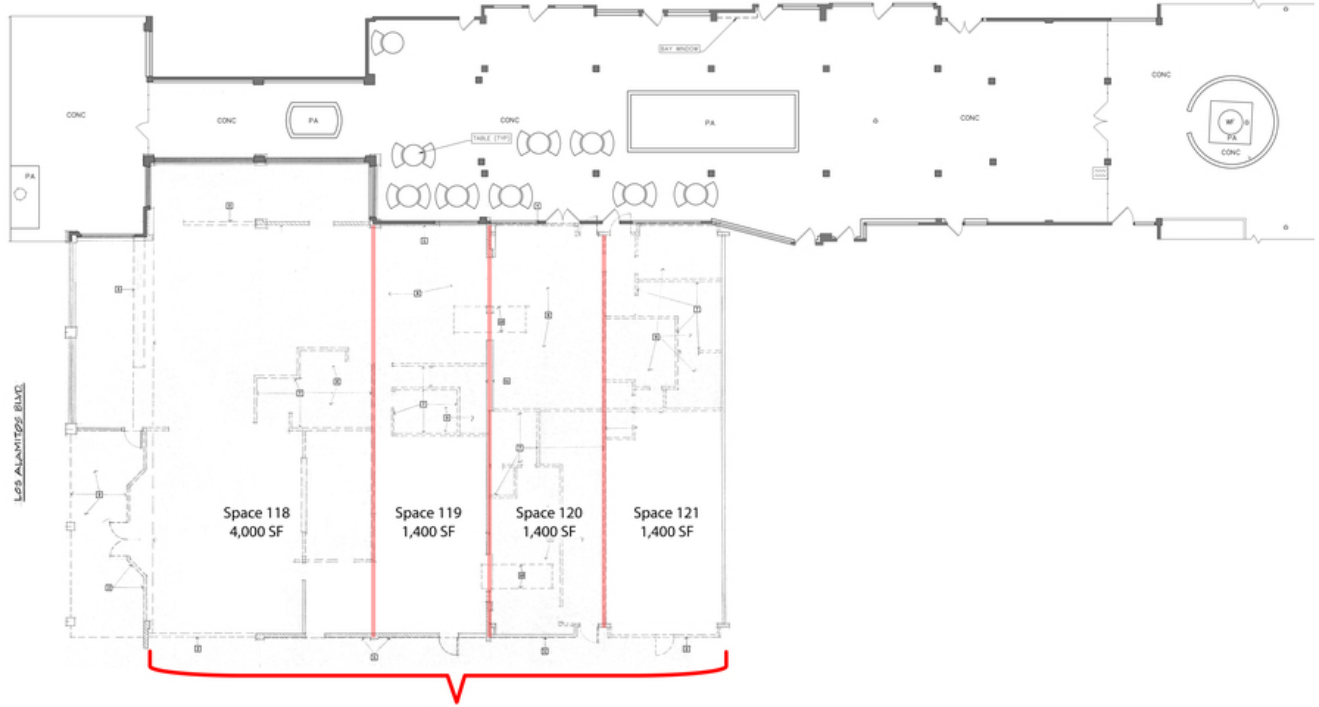

## SPACES

	LEASE RATE	SPACE SIZE
FORMER RESTAURANT - Suite 118-121	Negotiable	1,000 - 8,200 SF
RETAIL - Suite 146	Negotiable	850 SF
AVAILABLE - Suite 206	Negotiable	450 SF
AVAILABLE - Suite 207	Negotiable	580 SF
AVAILABLE - Suite 208	Negotiable	792 SF
AVAILABLE - Suite 210	Negotiable	475 SF
AVAILABLE - Suite 212	Negotiable	387 SF
AVAILABLE - Suite 213-214	Negotiable	900 SF
AVAILABLE - Suite 215-216	Negotiable	900 SF
RETAIL PAD - Unit 3569	Negotiable	1,285 SF



LOS A

FOR LEASE

# LOS ALAMITOS PLAZA

10900 LOS ALAMITOS BOULEVARD, LOS ALAMITOS, CA 90720



Map data ©2021 Imagery ©2021, Maxar Technologies, U.S. Geological Survey, USDA Farm Service Agency

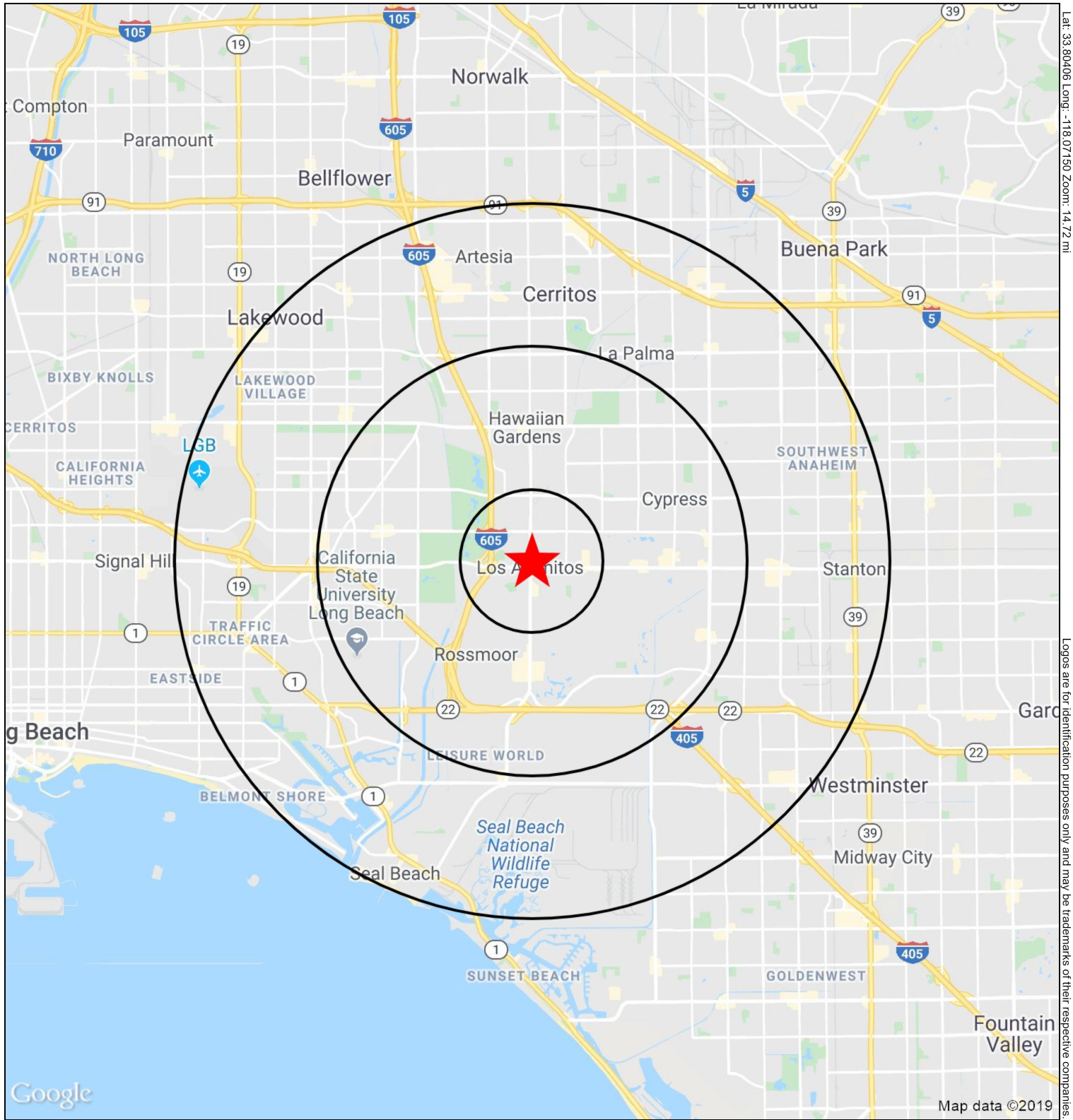

Lat: 33.80406 Long: -118.07150 Zoom: 14.72 mi

Logos are for identification purposes only and may be trademarks of their respective companies.

### Los Alamitos Plaza

10900 Los Alamitos Blvd, Los Alamitos, CA 90720



This map was produced using data from private and government sources deemed to be reliable. The information herein is provided without representation or warranty

# SUMMARY PROFILE

2000-2010 Census, 2019 Estimates with 2024 Projections  
 Calculated using Weighted Block Centroid from Block Groups



Lat/Lon: 33.8042/-118.0714

RS1

Los Alamitos Plaza		1 mi radius	3 mi radius	5 mi radius
10900 Los Alamitos Blvd, Los Alamitos, CA 90720				
POPULATION	2019 Estimated Population	16,950	170,089	500,220
	2024 Projected Population	16,936	169,606	499,083
	2010 Census Population	16,495	169,005	496,717
	2000 Census Population	16,555	168,100	492,652
	Projected Annual Growth 2019 to 2024	-	-	-
	Historical Annual Growth 2000 to 2019	0.1%	-	-
	2019 Median Age	42.3	41.9	40.4
HOUSEHOLDS	2019 Estimated Households	6,472	61,754	179,730
	2024 Projected Households	6,706	64,160	186,212
	2010 Census Households	6,116	59,438	172,823
	2000 Census Households	6,131	59,944	173,182
	Projected Annual Growth 2019 to 2024	0.7%	0.8%	0.7%
	Historical Annual Growth 2000 to 2019	0.3%	0.2%	0.2%
RACE AND ETHNICITY	2019 Estimated White	69.0%	60.3%	53.8%
	2019 Estimated Black or African American	3.3%	4.1%	4.6%
	2019 Estimated Asian or Pacific Islander	16.4%	21.5%	26.0%
	2019 Estimated American Indian or Native Alaskan	0.3%	0.6%	0.6%
	2019 Estimated Other Races	11.0%	13.6%	15.0%
	2019 Estimated Hispanic	19.5%	25.5%	26.8%
INCOME	2019 Estimated Average Household Income	\$122,022	\$118,085	\$113,546
	2019 Estimated Median Household Income	\$104,454	\$95,771	\$91,325
	2019 Estimated Per Capita Income	\$46,689	\$42,931	\$40,897
EDUCATION (AGE 25+)	2019 Estimated Elementary (Grade Level 0 to 8)	3.2%	4.7%	5.8%
	2019 Estimated Some High School (Grade Level 9 to 11)	3.8%	4.4%	5.3%
	2019 Estimated High School Graduate	15.0%	18.4%	18.5%
	2019 Estimated Some College	19.6%	22.9%	22.5%
	2019 Estimated Associates Degree Only	8.6%	8.8%	9.0%
	2019 Estimated Bachelors Degree Only	29.6%	25.9%	25.3%
	2019 Estimated Graduate Degree	20.2%	15.0%	13.5%
BUSINESS	2019 Estimated Total Businesses	1,437	6,251	22,123
	2019 Estimated Total Employees	11,902	57,400	212,024
	2019 Estimated Employee Population per Business	8.3	9.2	9.6
	2019 Estimated Residential Population per Business	11.8	27.2	22.6

This report was produced using data from private and government sources deemed to be reliable. The information herein is provided without representation or warranty.