

FOR LEASE

Courtyard at La Paz

25232-25334 McIntyre Street | Laguna Hills, CA 92653

Up to 19,236 SF Co-Anchor Space Available

631 SF - 5,520 SF Retail Space Available



Property Highlights

- South Orange County retail space for lease
- High disposable incomes
- Easy access to Interstate 5 Freeway
- Dense population & strong daytime population within 1, 3 & 5 miles radiuses
- Close proximity to Mission Viejo High School, La Paz Junior High School, & Valencia Elementary
- Recently upgraded common area courtyard



Demographics

EST. 2020	1 MILE	3 MILE	5 MILE
Population	15,555	164,314	347,932
Average Household Income	\$180,479	\$133,080	\$141,241
Daytime Population	6,229	67,549	161,573

Source: Esri

TRAFFIC COUNT

La Paz Road (E/W)	approx. 36,000 cars per day
1-5 Freeway	approx. 320,000 cars per day

Source: Costar

Contact

CASEY MAHONY

949.698.1108 | casey.mahony@srsre.com
CA License No. 01886184

ADAM HANDFIELD

949.698.1109 | adam.handfield@srsre.com
CA License No. 01959419

SRS REAL ESTATE PARTNERS

610 Newport Center Drive, Suite 1500, Newport Beach, CA 92660

This information contained herein was obtained from sources deemed to be reliable; however SRS Real Estate Partners makes no guarantees, warranties or representations as to the completeness or accuracy thereof.



Courtyard at La Paz Tenant Directory

NO.	TENANT	(SF)	NO.	TENANT	(SF)
Building 25252					
A	Available	6,183	X	Greek Bistro	3,000
B	Available	13,053	W	Solo Ice Cream	1,500
			T	Second Reef Deli	1,200
Building 25282					
Available	3,708	R	Pengo Drinks	1,560	
		Q	Storymakery	1,503	
Building 25272					
A	Available	2,079	P	Available	1,500
J	A+ Body Care	1,132	C-2	Storm Fight & Fitness	6,230
H	Doctor of Chiropractic	1,200	C-1	EMS Barber Shop	741
G	Available	631	A	Professional Nails & Spa	1,250
D-E	ITC Dental	1,750			
Building 25292			Building 25342		
O	Available (Divisible)	±5,520		Flamingo's Mexican Grill & Bar	4,225
K	La Paz Dentistry	3,582	Pad Building	Advanced Beauty College	8,597
H-J	La Paz Animal Clinic	2,640	Pad	Dunkin' Donuts	1,800



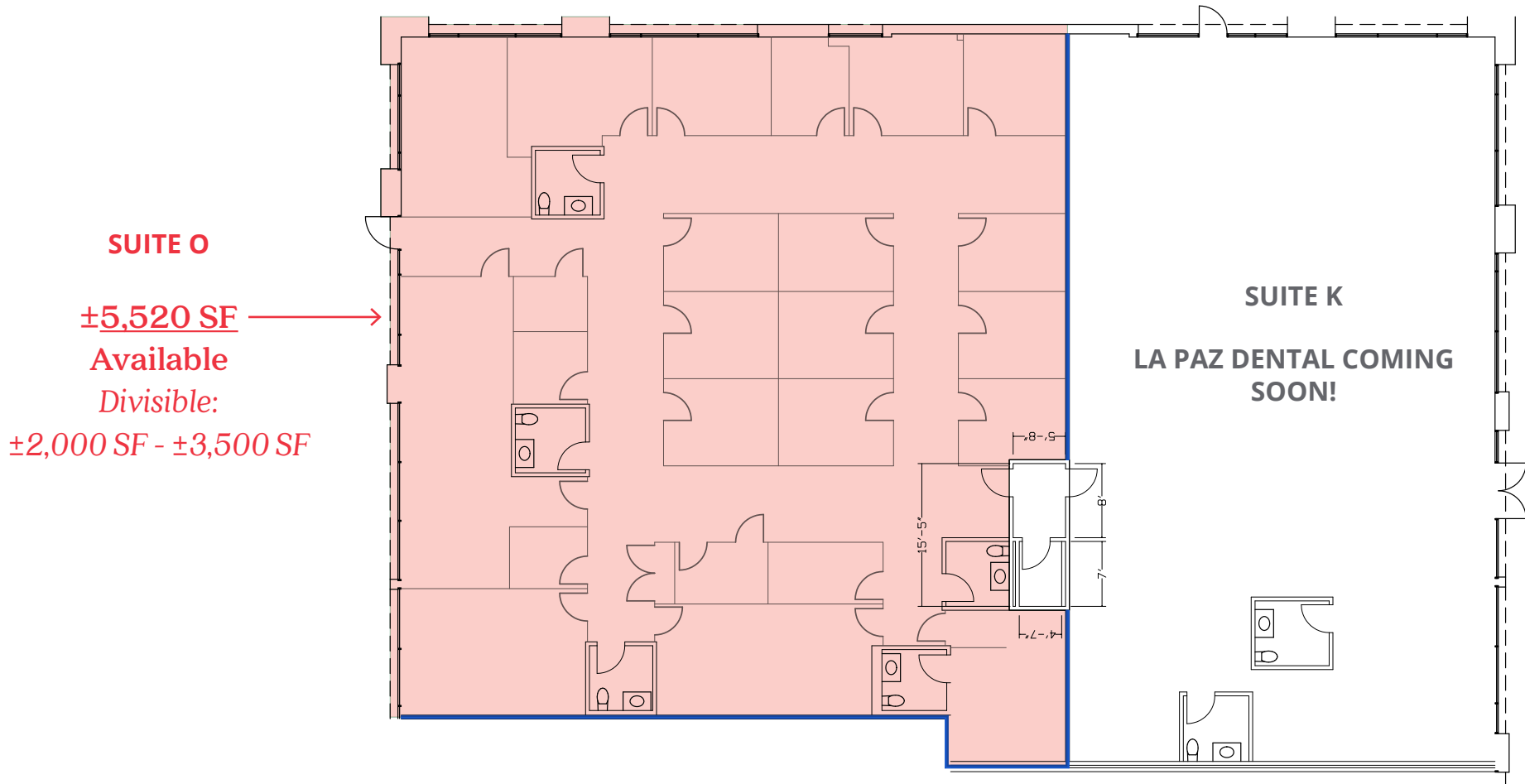

Contact

CASEY MAHONY
casey.mahony@srsre.com
949.698.1108
CA License No. 01886184

ADAM HANDFIELD
adam.handfield@srsre.com
949.698.1109
CA License No. 01959419

SRS REAL ESTATE PARTNERS
610 Newport Center Drive, Suite 1500, Newport Beach, CA 92660

This information contained herein was obtained from sources deemed to be reliable; however SRS Real Estate Partners makes no guarantees, warranties or representations as to the completeness or accuracy thereof.

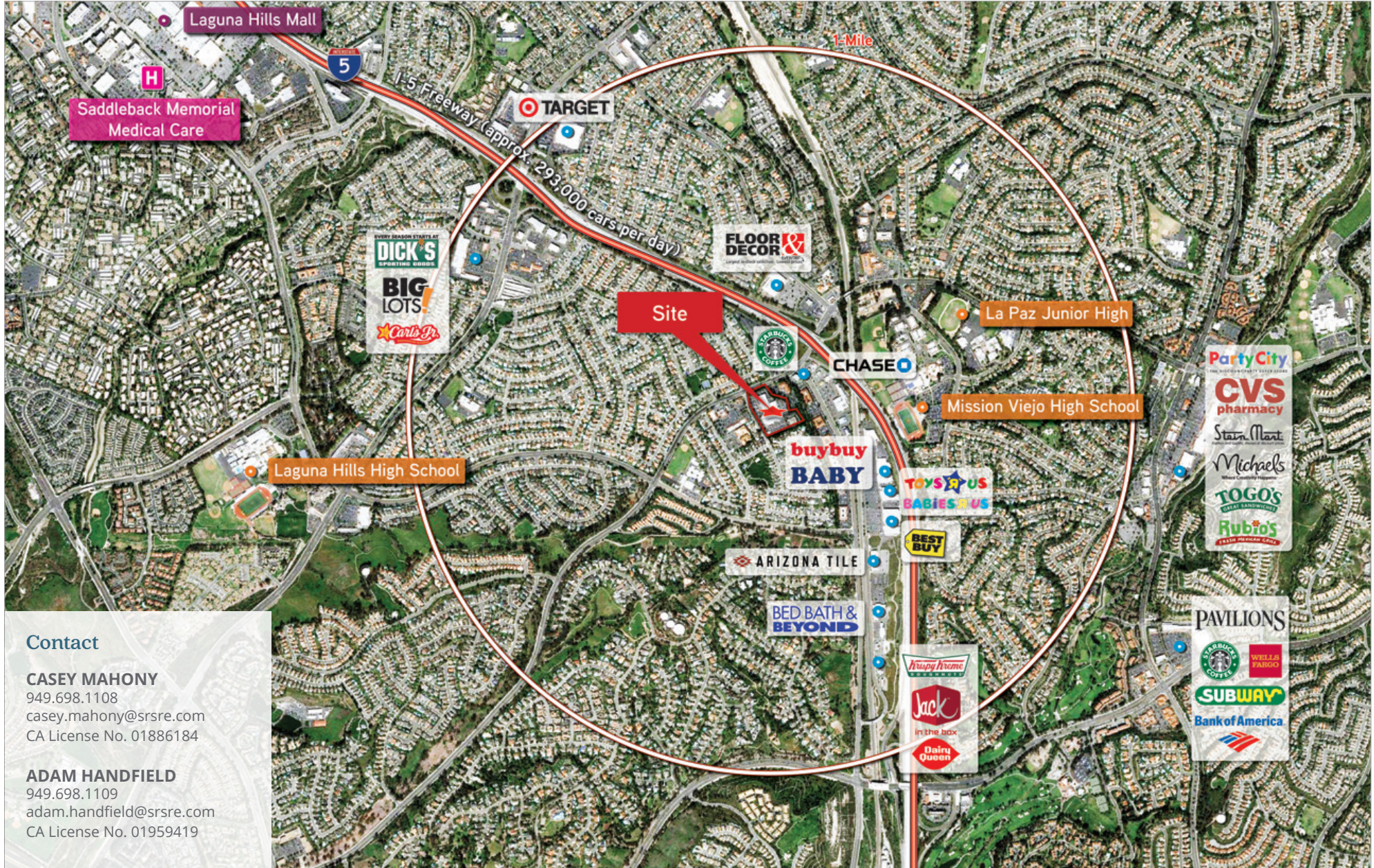

Contact

CASEY MAHONY
949.698.1108
casey.mahony@srsre.com
CA License No. 01886184

ADAM HANDFIELD
949.698.1109
adam.handfield@srsre.com
CA License No. 01959419