

FOR LEASE

# Former Walgreens

730 Market Street | San Francisco, CA

*Walgreens*

## Overview

AVAILABLE SF	13,899 SF
LEASE END DATE	12/1/2028
RATE	\$40 PSF

## Description

Former Walgreens space located on Market Street.

- Over 100 feet of frontage on Market Street
- Located within two blocks of Union Square, Financial District and Moscone Center.
- Heavy pedestrian traffic
- Easily accessible by Muni and BART

## Nearby Retailers

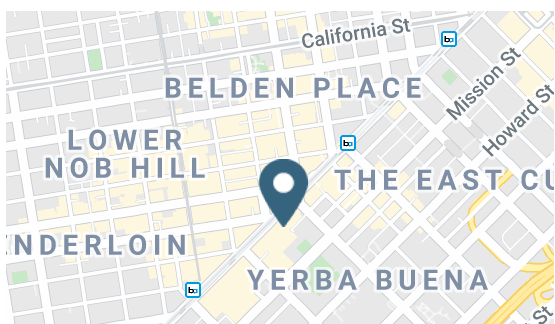

NESPRESSO



Hakkasan



## Contact

### GEORGE DONOVAN

415.908.4947 | george.donovan@srsre.com  
CA License No. 006377756

### MATTHEW ALEXANDER

415.908.4938 | matt.alexander@srsre.com  
CA License No. 883993

## Demographics

	1 MILE	3 MILES	5 MILES
Population	137,909	433,345	707,483
Median HH Income	\$68,257	\$114,871	\$115,773
Daytime Population	424,946	754,530	978,698

Year: 2019 | Source: Esri, Esri and Infogroup, US Census

SRS REAL ESTATE PARTNERS | 100 Pine Street, Suite 1550 | San Francisco, CA 94111 | 415.908.4930

This information contained herein was obtained from sources deemed to be reliable; however SRS Real Estate Partners makes no guarantees, warranties or representations as to the completeness or accuracy thereof.

SRSRE.COM

# Former Walgreens

730 Market Street | San Francisco, CA

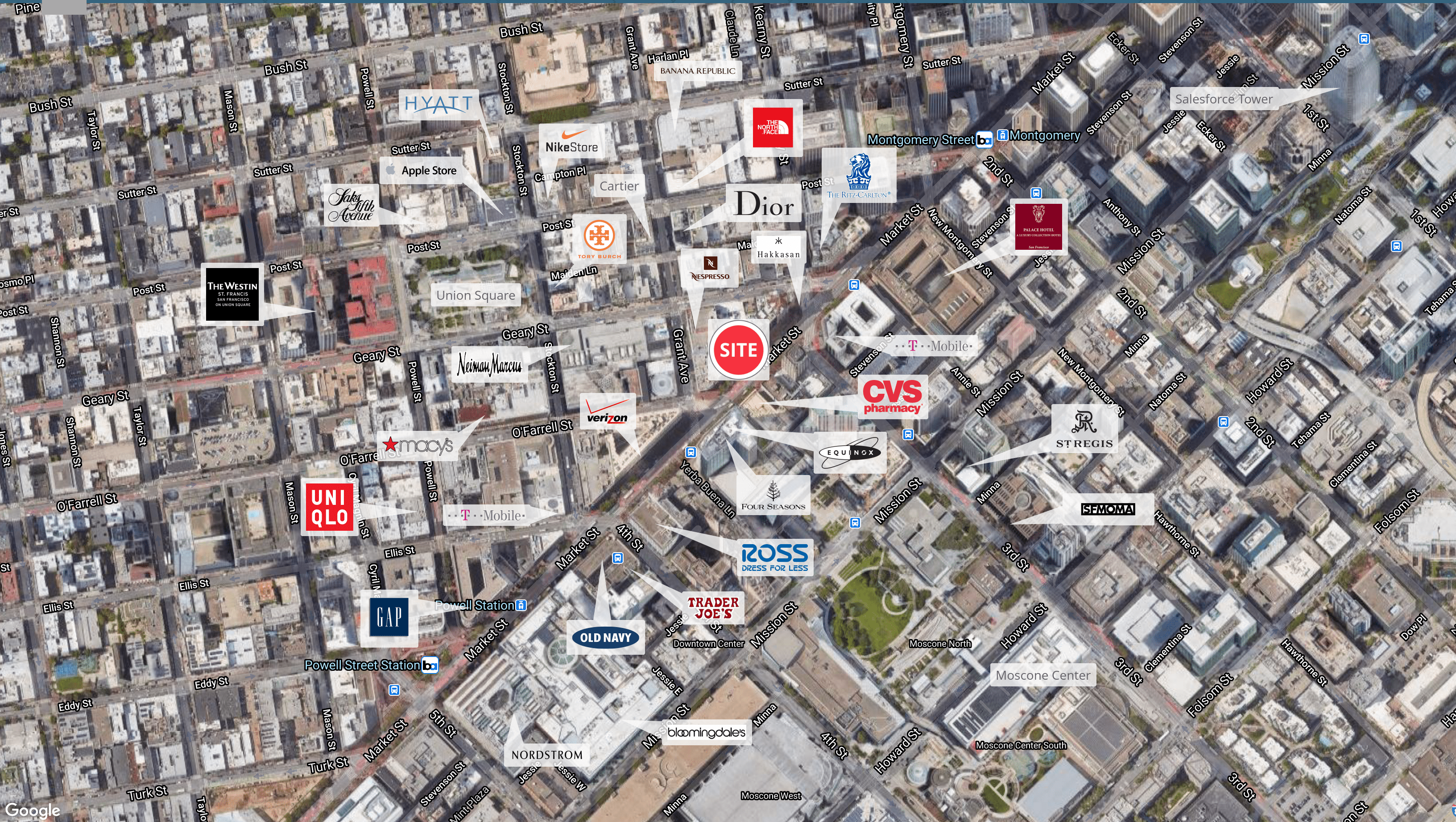

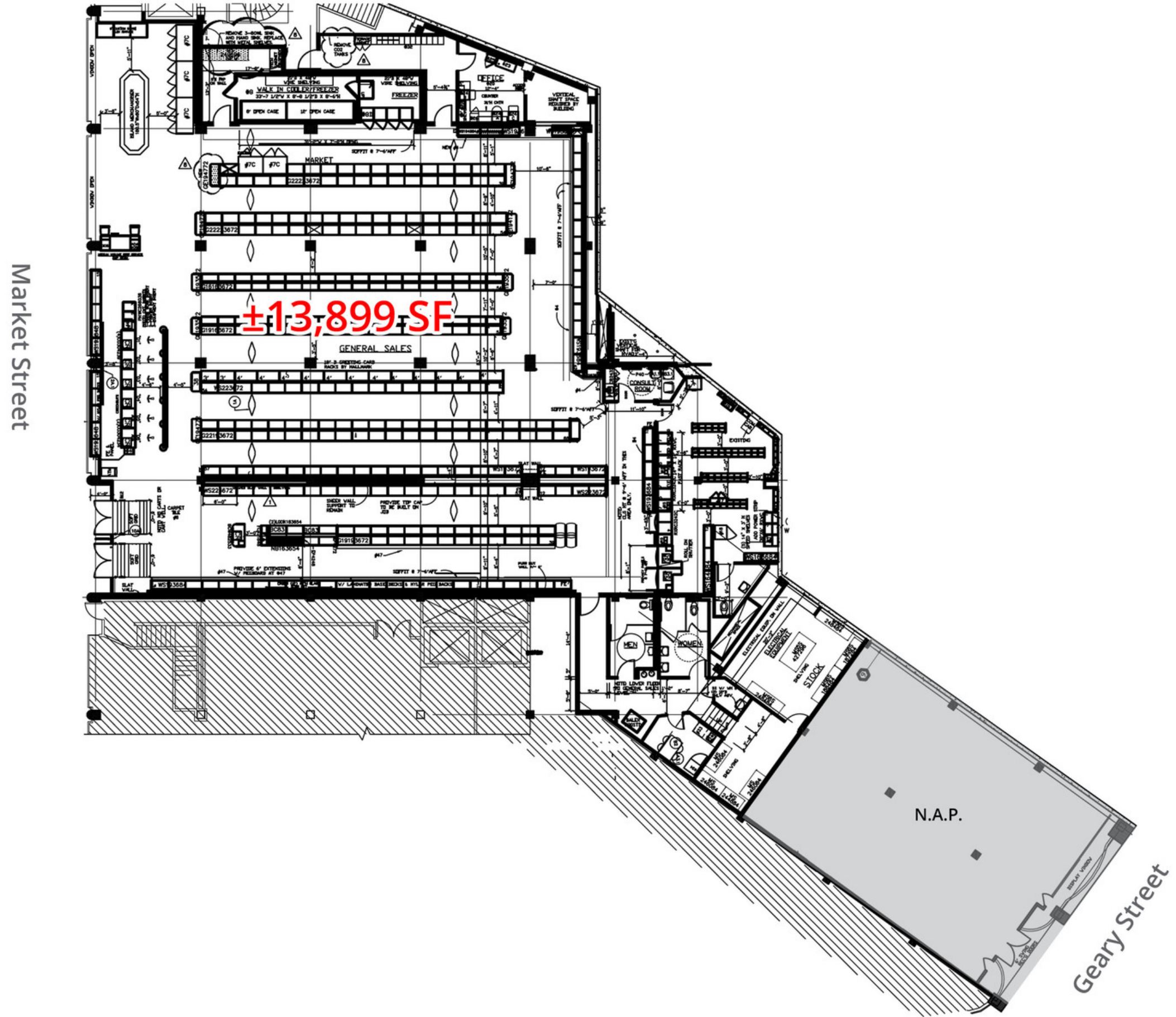

Market Street

Geary Street

N.A.P.

	1 mile	3 miles	5 miles
<b>Population</b>			
2000 Population	101,533	358,822	616,831
2010 Population	117,458	379,876	637,858
2019 Population	137,909	433,345	707,483
2024 Population	147,133	455,550	748,341
2000-2010 Annual Rate	1.47%	0.57%	0.34%
2010-2019 Annual Rate	1.75%	1.43%	1.13%
2019-2024 Annual Rate	1.30%	1.00%	1.13%
2019 Male Population	54.5%	52.3%	51.1%
2019 Female Population	45.5%	47.7%	48.9%
2019 Median Age	41.3	38.9	39.5
2019 Total Daytime Population	424,946	754,530	978,698
Workers	369,335	599,168	703,186
Residents	55,611	155,362	275,512

In the identified area, the current year population is 137,909. In 2010, the Census count in the area was 117,458. The rate of change since 2010 was 1.75% annually. The five-year projection for the population in the area is 147,133 representing a change of 1.30% annually from 2015 to 2020. Currently, the population is 54.5% male and 45.5% female.

<b>Data for all businesses in area</b>			
Total Businesses:	24,134	43,639	52,349
Total Employees:	300,090	495,796	587,824
Total Residential Population:	137,909	433,345	707,483
Employee/Residential Population Ratio:	2.18:1	1.14:1	0.83:1

#### Median Age

The median age in this area is 41.3, compared to U.S. median age of 37.9.

#### Race and Ethnicity

2019 White Alone	42.1%	57.3%	51.0%
2019 Black Alone	5.2%	4.7%	5.3%
2019 American Indian/Alaska Native Alone	0.5%	0.5%	0.5%
2019 Asian Alone	42.1%	25.9%	30.9%
2019 Pacific Islander Alone	0.2%	0.2%	0.4%
2019 Other Race	5.2%	6.1%	6.7%
2019 Two or More Races	4.6%	5.2%	5.3%
2019 Hispanic Origin (Any Race)	12.0%	15.1%	15.7%

Persons of Hispanic origin represent 12.0% of the population in the identified area compared to 17.6% of the U.S. population. Persons of Hispanic Origin may be of any race. The Diversity Index, which measures the probability that two people from the same area will be from different race/ethnic groups, is 71.8 in the identified area, compared to 63.0 for the U.S. as a whole.

#### Median Household Income

2019 Median Household Income	\$68,257	\$114,871	\$115,773
2024 Median Household Income	\$93,586	\$136,784	\$137,037
2019-2024 Annual Rate	6.52%	3.55%	3.43%

#### Average Household Income

2019 Average Household Income	\$127,444	\$168,331	\$166,726
2024 Average Household Income	\$150,211	\$193,674	\$191,381
2019-2024 Annual Rate	3.34%	2.84%	2.80%

#### Per Capita Income

2019 Per Capita Income	\$70,487	\$86,183	\$76,219
2024 Per Capita Income	\$83,086	\$99,215	\$87,204
2019-2024 Annual Rate	3.34%	2.86%	2.73%

Source: Esri, Esri and Infogroup, U.S. Census

	1 mile	3 miles	5 miles
<b>2019 Employed Population 16+ by Occupation</b>			
Total	82,634	282,082	439,802
White Collar	73.3%	79.8%	76.5%
Management/Business/Financial	25.4%	27.7%	24.9%
Professional	28.6%	33.2%	32.3%
Sales	10.8%	10.8%	10.1%
Administrative Support	8.6%	8.2%	9.2%
Services	19.9%	14.3%	15.6%
Blue Collar	6.8%	5.9%	7.9%
Farming/Forestry/Fishing	0.1%	0.1%	0.1%
Construction/Extraction	1.0%	1.3%	2.1%
Installation/Maintenance/Repair	0.7%	0.8%	1.0%
Production	2.2%	1.6%	1.9%
Transportation/Material Moving	2.7%	2.0%	2.8%
<b>2019 Population 25+ by Educational Attainment</b>			
Total	116,319	358,628	566,020
Less than 9th Grade	10.7%	5.8%	6.3%
9th - 12th Grade, No Diploma	5.4%	3.6%	3.9%
High School Graduate	11.0%	8.3%	9.8%
GED/Alternative Credential	1.5%	1.1%	1.1%
Some College, No Degree	13.8%	12.1%	13.0%
Associate Degree	3.5%	3.6%	4.6%
Bachelor's Degree	32.9%	38.4%	36.0%
Graduate/Professional Degree	21.2%	27.2%	25.4%
<b>Households</b>			
2000 Households	54,912	181,154	277,424
2010 Households	64,174	194,330	291,063
2019 Total Households	75,309	220,767	322,062
2024 Total Households	80,515	232,389	339,779
2000-2010 Annual Rate	1.57%	0.70%	0.48%
2010-2019 Annual Rate	1.74%	1.39%	1.10%
2019-2024 Annual Rate	1.35%	1.03%	1.08%
2019 Average Household Size	1.73	1.89	2.13

The household count in this area has changed from 64,174 in 2010 to 75,309 in the current year, a change of 1.74% annually. The five-year projection of households is 80,515, a change of 1.35% annually from the current year total. Average household size is currently 1.73, compared to 1.70 in the year 2010. The number of families in the current year is 21,343 in the specified area.

#### Households by Income

Current median household income is \$68,257 in the area, compared to \$53,217 for all U.S. households. Median household income is projected to be \$93,586 in five years, compared to \$60,683 for all U.S. households

Current average household income is \$127,444 in this area, compared to \$74,699 for all U.S. households. Average household income is projected to be \$150,211 in five years, compared to \$84,910 for all U.S. households

Current per capita income is \$70,487 in the area, compared to the U.S. per capita income of \$28,597. The per capita income is projected to be \$83,086 in five years, compared to \$32,501 for all U.S. households

Source: Esri, Esri and InfoGroup, U.S. Census

SRS REAL ESTATE PARTNERS | 100 Pine Street, Suite 1550 | San Francisco, CA 94111 | 415.908.4930

This information contained herein was obtained from sources deemed to be reliable; however SRS Real Estate Partners makes no guarantees, warranties or representations as to the completeness or accuracy thereof.

SRSRE.COM