

NORTH GROVE CORPORATE PARK  
**Available for Lease**

MORTON GROVE, ILLINOIS



BUILDING	SIZE	AVAILABLE SPACE	SPACE TYPE
Oakton I	88,039 SF	3,591 - 6,676 SF	Industrial/Flex
Oakton II	87,566 SF	7,700 SF	Industrial/Flex
Oakton III	10,682 SF	0 SF	Industrial
Park Plaza	48,935 SF	2,306 - 3,652 SF	Industrial/Flex
Lehigh Plaza	121,448 SF	3,766 - 14,370 SF	Industrial/Flex
8200 Lehigh	12,000 SF	12,000 SF	Industrial



6241 PARK AVENUE - MORTON GROVE, ILLINOIS

# 3,652 SF For Lease

## PROPERTY FEATURES

- 3,652 SF available
- 3 offices w/higher end finishes
- 48,935 SF building
- 15' clear
- Warehouse access w/drive-in door
- Kitchen, Lab room w/sink
- Wet sprinklers
- Immediate availability
- Walking distance to Metra train stop
- Public transportation on Oakton Street
- 1/4 mile west of I-94 (Edens Xway)
- \$12.64 PSF Modified Gross

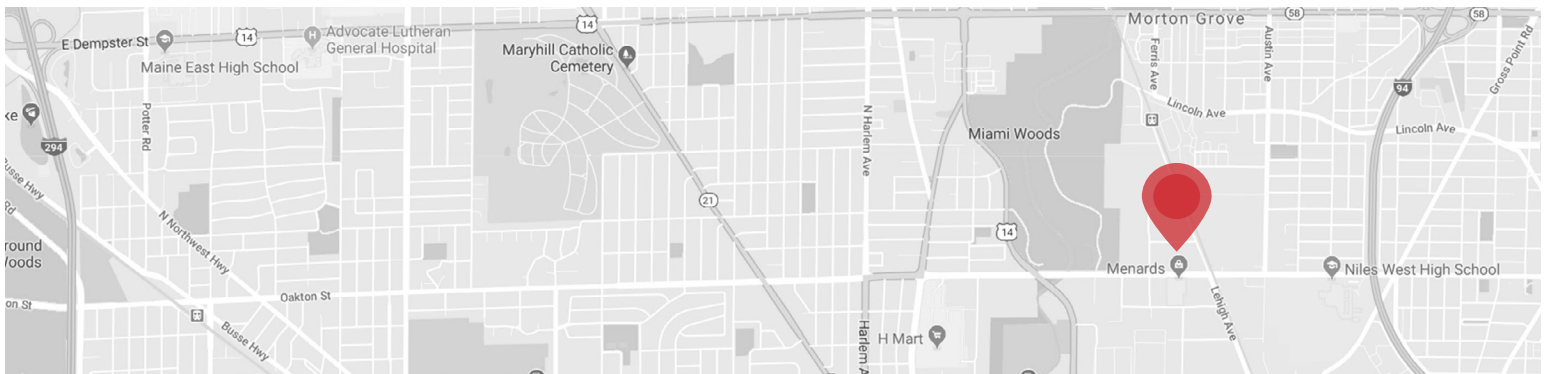

**Larry Much, SIOR**

630 691 0606

lmuch@hiffman.com

**Steve Chrastka**

630 317 0746

schrastka@hiffman.com

**Drew Bulson**

630 382 8637

dbulson@hiffman.com

6241 PARK AVENUE - MORTON GROVE, ILLINOIS

# 3,652 SF For Lease

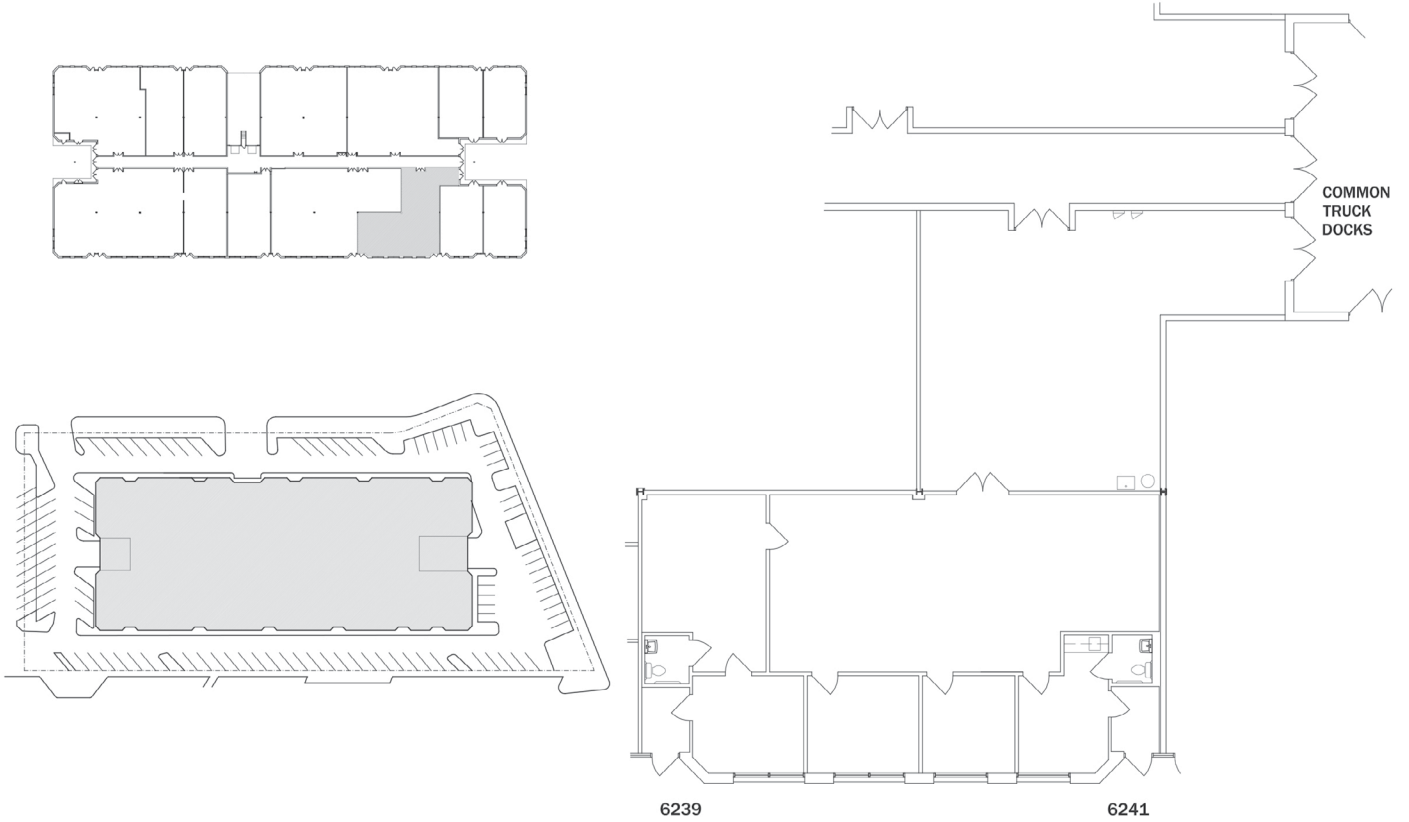

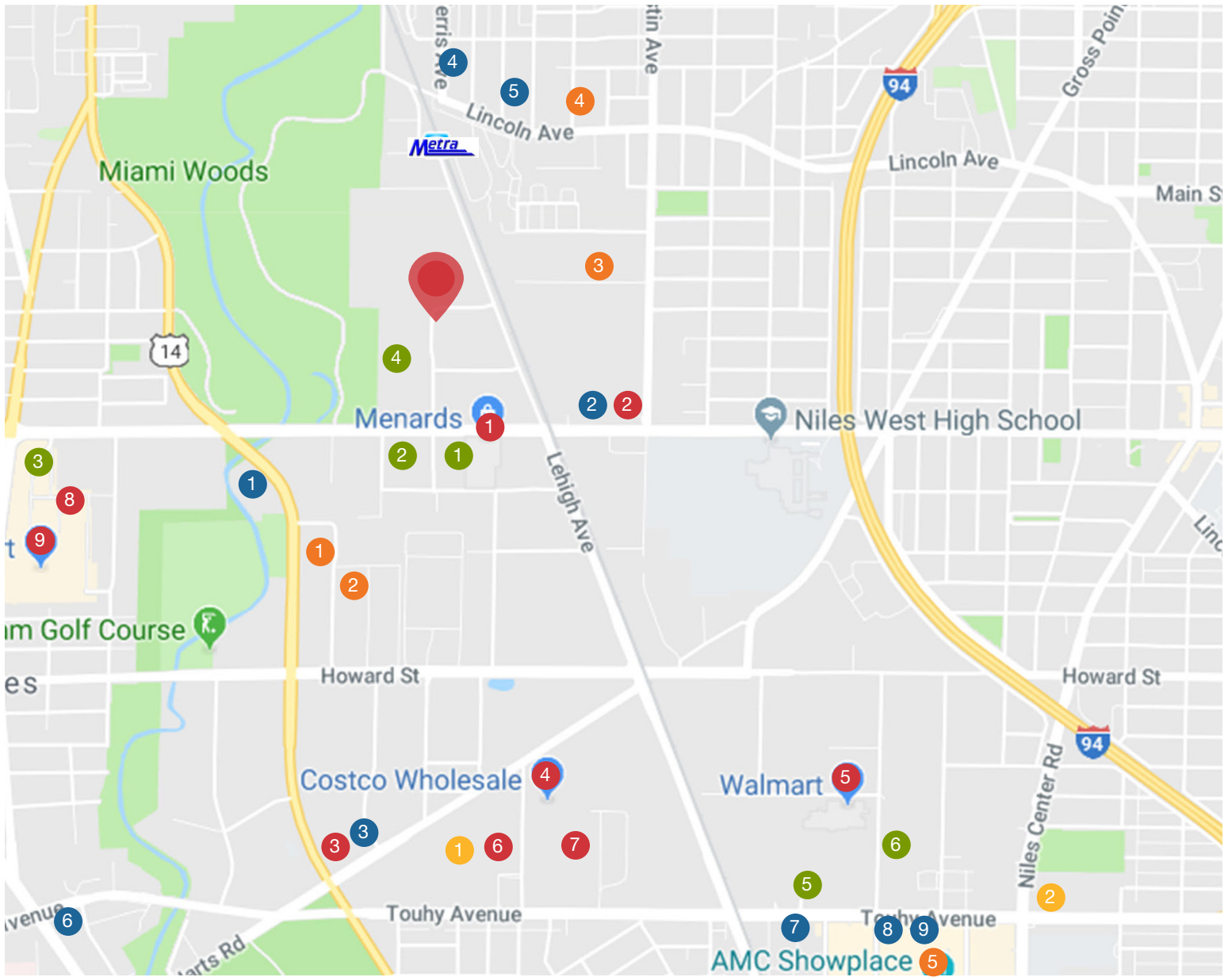

## Area Amenities

### Corporate

1. Lifeway Foods
2. Quantum Group
3. USPS
4. John Crane, Inc.
5. Wells Fargo Bank
6. Chase Bank

### Dining

1. Barnaby's
2. Biggie's
3. Dunkin Donuts
4. Burt's Place
5. Pequod's Pizza
6. Starbucks
7. Jersey Mike's Subs
8. Outback Stkhs
9. Chili's Bar & Grill

### Hospitality

1. Leaning Tower YMCA
2. Holiday Inn

### Entertainment

1. Sky High Sports
2. JumpZoneq
3. House of Torment
4. MG Public Library
5. AMC Showplace

### Retail

1. Menards
2. Marathon
3. Shell
4. Costco
5. Walmart
6. Aldi's
7. Target
8. The Home Depot
9. H Mart

### Larry Much, SIOR

630 691 0606  
lmuch@hiffman.com

### Steve Chrastka

630 317 0746  
schrastka@hiffman.com

### Drew Bulson

630 382 8637  
dbulson@hiffman.com