

42,100 SF & 46,784 SF Industrial Units for Lease

9200-9260 W 55TH STREET
MCCOOK ILLINOIS



NAL Hiffman
Commercial Real Estate Services, Worldwide.

Adam Stokes
847 698 7401
astokes@hiffman.com

9200-9260 W 55TH STREET MCCOOK ILLINOIS

42,100 SF & 46,784 SF Industrial Units for Lease



UNIT 9260

UNIT 9200

AVAILABLE
46,784 SF

OFFICE AREA
12,176 SF

CLEAR HEIGHT
30'

LOADING
8 Exterior Docks

DRIVE-IN DOORS
1

COLUMN SPACING
50' X 50'
60' Speed Bays

SPRINKLER
ESFR

POWER
600A @ 480V

LEASE RATE
Subject to Offer

AVAILABLE
42,100 SF

OFFICE AREA
6,634 SF

CLEAR HEIGHT
30'

LOADING
3 Exterior Docks
(5 exterior docks can be added)

DRIVE-IN DOORS
1

COLUMN SPACING
50' X 50'
60' Speed Bays

SPRINKLER
ESFR

POWER
600A @ 480V

LEASE RATE
Subject to Offer

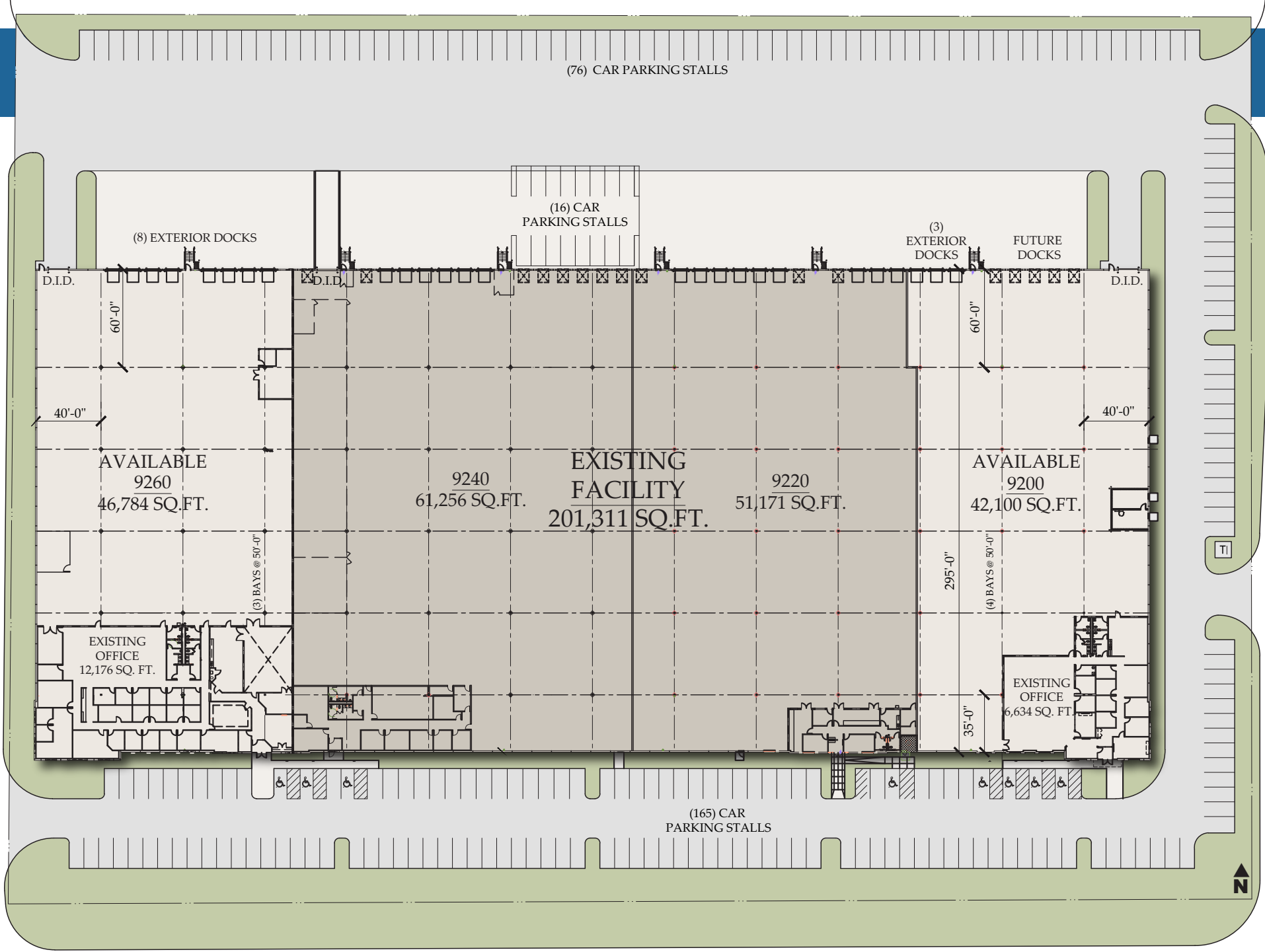

UNIT 9200

42,100 SF Industrial Unit for Lease

PROPERTY SPECS

- AVAILABLE
42,100 SF
- OFFICE AREA
6,634 SF
- CLEAR HEIGHT
30'
- LOADING
3 Exterior Docks
(5 exterior docks can be added)
- DRIVE-IN DOORS
1
- COLUMN SPACING
50' X 50'
60' Speed Bays
- SPRINKLER
ESFR
- POWER
600A @ 480V
- LEASE RATE
Subject to Offer

FOR MORE INFORMATION,
CONTACT

Adam Stokes
847 698 7401
astokes@hiffman.com

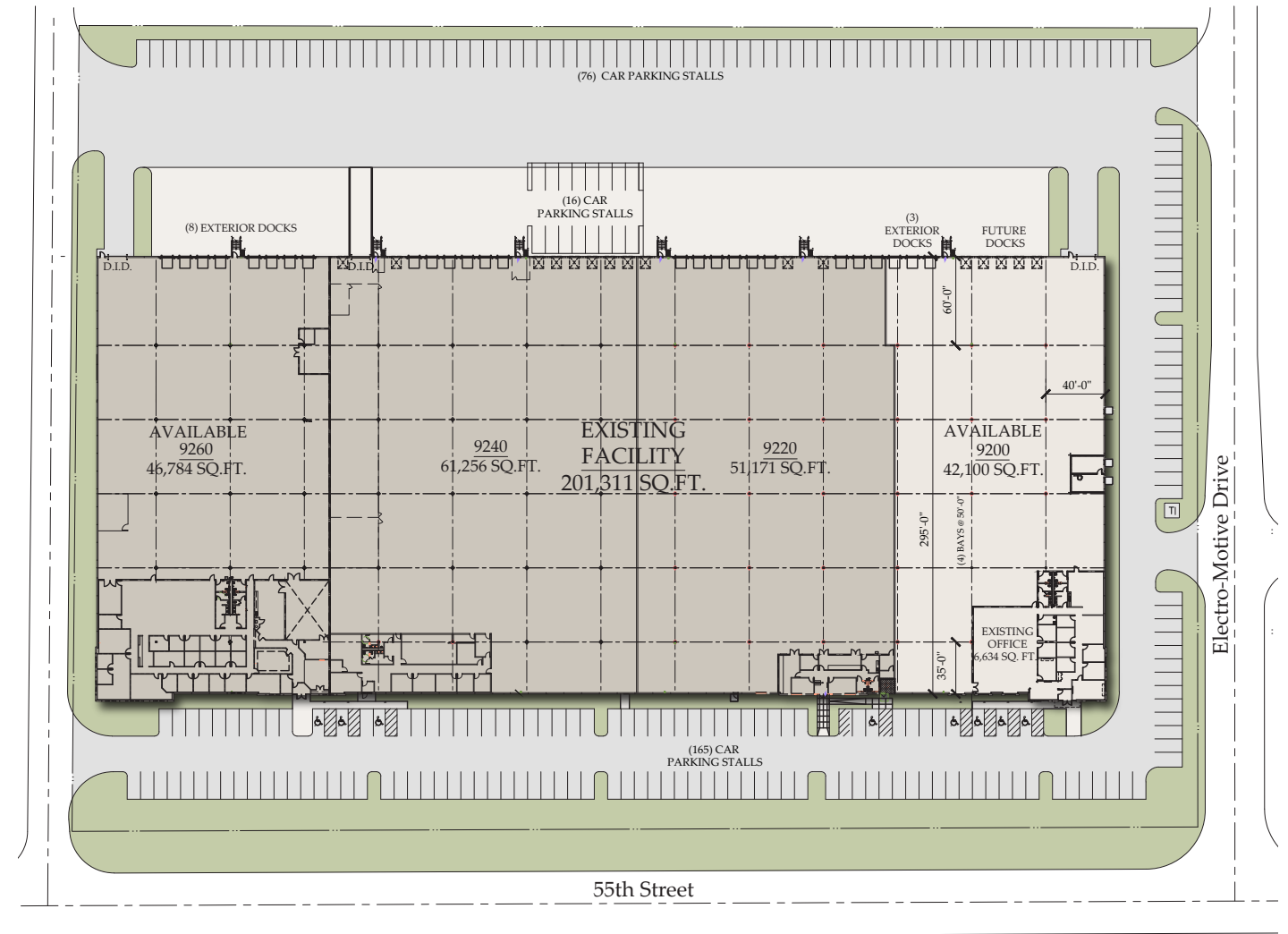

- PRIME END-CAP UNIT
- EXCELLENT SIGNAGE OPPORTUNITY
- DOCKS ARE EXPANDABLE
- 60' SPEED BAYS



NAI Hiffman
Commercial Real Estate Services, Worldwide.

UNIT 9260

46,784 SF Industrial Unit for Lease

PROPERTY SPECS

AVAILABLE
46,784 SF

OFFICE AREA
12,176 SF

CLEAR HEIGHT
30'

LOADING
8 Exterior Docks

DRIVE-IN DOORS
1

COLUMN SPACING
50' X 50'
60' Speed Bays

SPRINKLER
ESFR

POWER
600A @ 480V

LEASE RATE
Subject to Offer

FOR MORE INFORMATION,
CONTACT

Adam Stokes

847 698 7401
astokes@hiffman.com

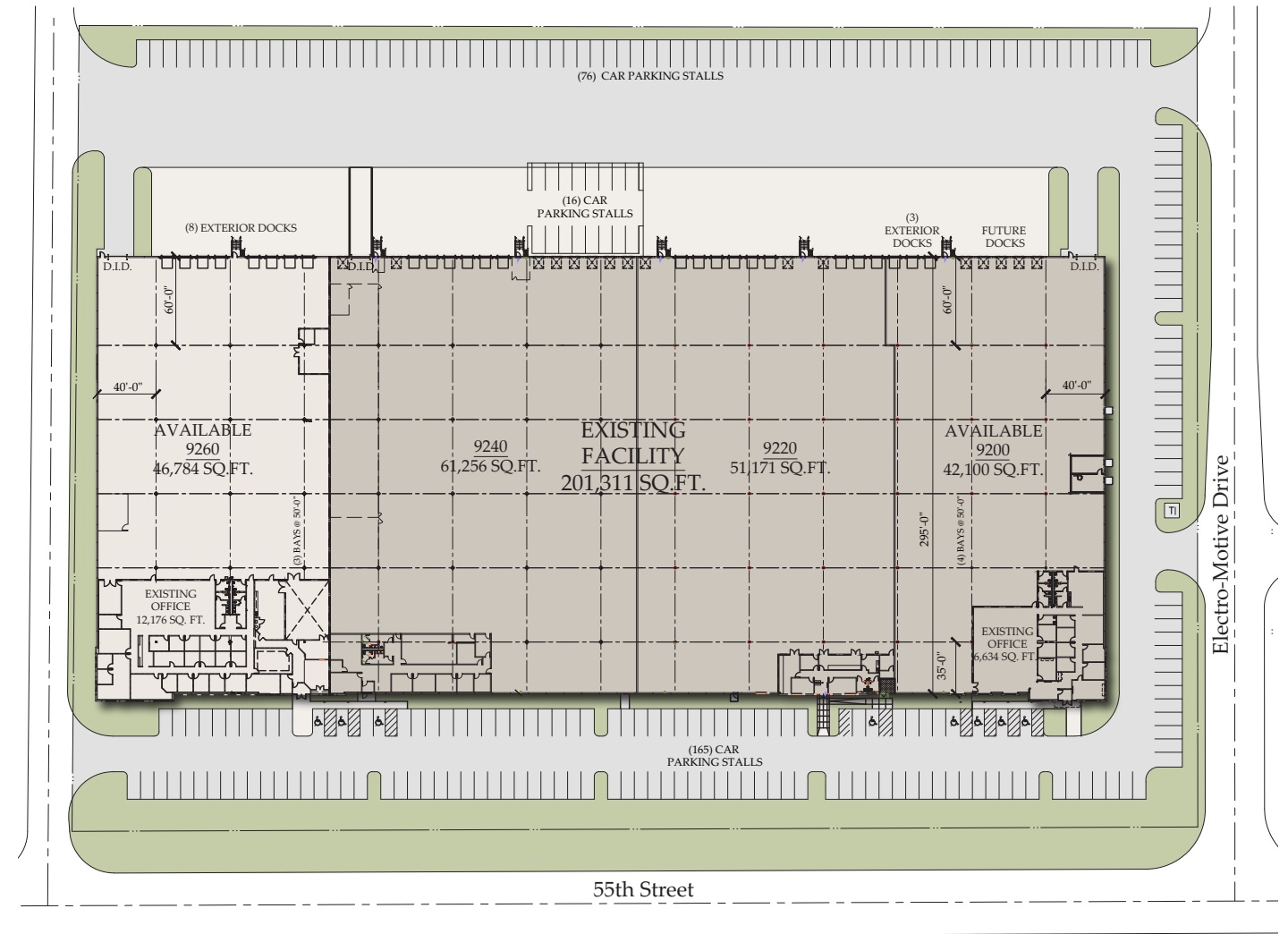

- PRIME END-CAP UNIT
- EXCELLENT SIGNAGE OPPORTUNITY
- 8 EXTERIOR DOCKS
- 60' SPEED BAYS





42,100 SF & 46,784 SF Industrial Units for Lease

9200-9260 W 55TH STREET MCCOOK ILLINOIS

- PRIME END-CAP UNITS
- CLASS A BUILDING - COMPLETED IN 2010
- LOCATED AT BUSINESS PARK ENTRANCE / SIGNALIZED INTERSECTION
- OUTSTANDING VISIBILITY ON 55TH STREET
- INSTITUTIONALLY OWNED / PROFESSIONALLY MANAGED



FOR MORE INFORMATION,
CONTACT

Adam Stokes

847 698 7401
astokes@hiffman.com

NAI Hiffman
Commercial Real Estate Services, Worldwide.