

Regent O'Hare

B U S I N E S S C E N T E R

870-898 Cambridge Drive
Elk Grove Village



Regent O'Hare

BUSINESS CENTER



870-898 Cambridge Drive, Elk Grove Village

REGENT O'HARE IS A BEST-IN-CLASS, EIGHT-BUILDING BUSINESS PARK TOTALING OVER 950,000 SF OF INDUSTRIAL & OFFICE SPACE IN THE HEART OF THE O'HARE SUBMARKET, ONE MILE WEST OF O'HARE INTERNATIONAL AIRPORT.

PROPERTY HIGHLIGHTS

- 15' CLEAR HEIGHT
- 2.13 / 1,000 SF PARKING RATIO
- HIGH IMAGE INDUSTRIAL PROPERTY
- NEW INSTITUTIONAL OWNER
- ON-SITE MANAGEMENT OFFICE
- PRIME LOCATION NEAR RESTAURANTS & RETAILERS
- VARIETY OF TENANT OPTIONS
- CLOSE PROXIMITY TO O'HARE AND MAJOR HIGHWAYS
- NEAR NORTH CARGO ENTRANCE AND FUTURE WEST ENTRANCE TO O'HARE AIRPORT
- MINUTES FROM NEW 4-WAY INTERCHANGE AT I-90 / ELMHURST ROAD (RTE 83)

SITE PLAN

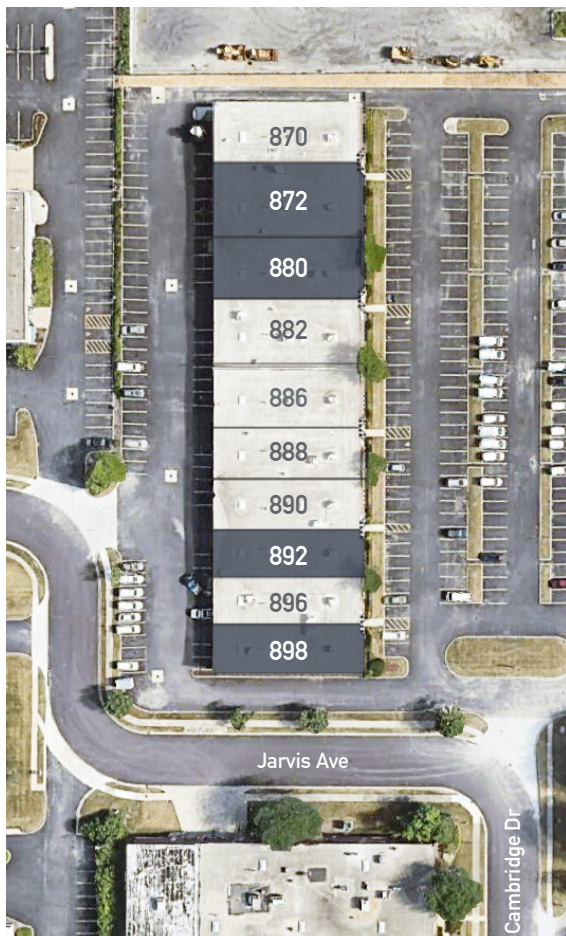

■ = Available Units

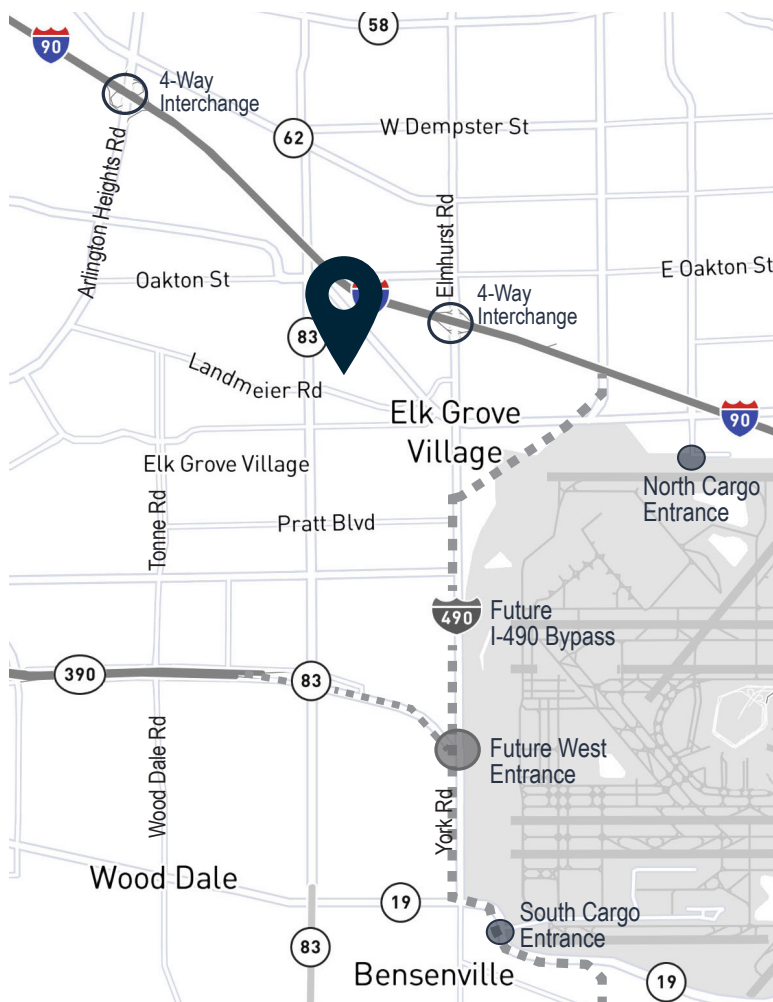

870-898 Cambridge Drive, Elk Grove Village
AVAILABLE UNITS

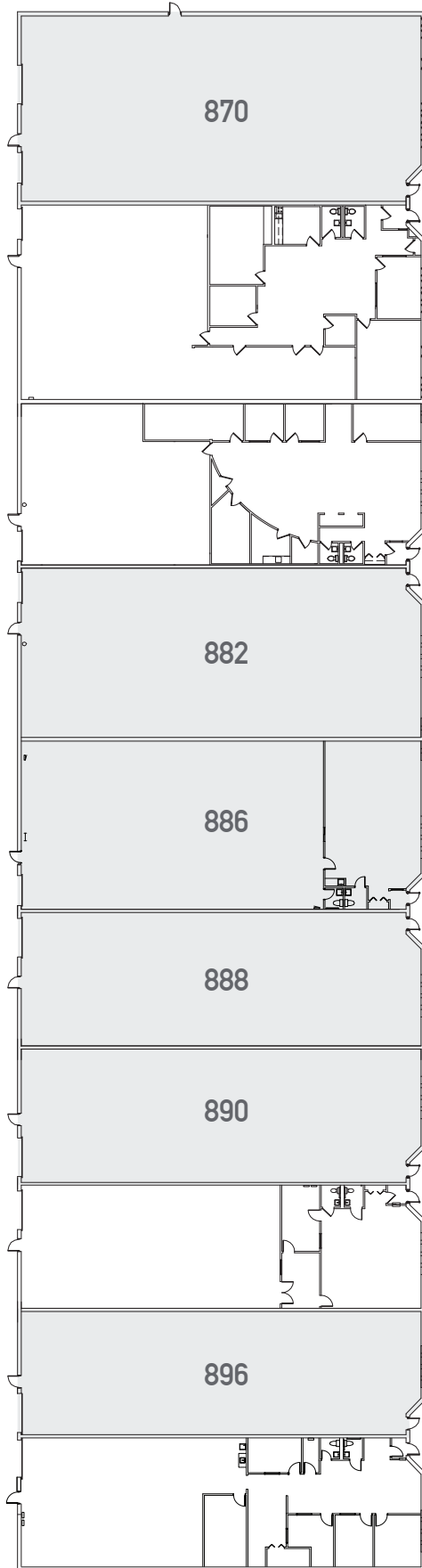

872 — 5,238 SF - Expandable to 9,963 SF
 OFFICE AREA 50%
 LOADING 1 drive-in door

880 — 4,725 SF - Expandable to 9,963 SF
 OFFICE AREA 50%
 LOADING 1 drive-in door

892 — 3,605 SF
 OFFICE AREA ±891 SF
 LOADING 1 drive-in door

898 — 3,640 SF
 OFFICE AREA ±1,550 SF
 LOADING 1 drive-in door

Regent O'Hare

B U S I N E S S C E N T E R

regentohare.com

LEASED BY

NAI Hiffman

Commercial Real Estate Services, Worldwide.

FOR LEASING INFORMATION,
PLEASE CONTACT:

Terry Herlihy
630 693 0664
therlihy@hiffman.com

OWNED & MANAGED BY

B R E N N A N
I N V E S T M E N T
G R O U P

INVESTCORP

NAI HIFFMAN
One Oakbrook Terrace Suite 400
Oakbrook Terrace, Illinois 60181

hiffman.com