

MADISON MEDICAL PLAZA

Medical Suites For Lease

301 N MADISON STREET, JOLIET, ILLINOIS



PROPERTY DETAILS

- Located on the Presence Saint Joseph Medical Center Campus
- Surgery center and pharmacy on-site
- Multiple PACE stops along Madison Street
- Ample parking
- 1.4 mile to full interchange of I-80 and Route 7
- 2.9 miles to I-55 via Jefferson St
- SPACE AVAILABLE:
 - > Suite 210 - 3,109 SF
 - > Suite 303 - 1,563 SF existing conditions medical suite
 - > Suite 308 - 2,760 SF existing conditions medical suite

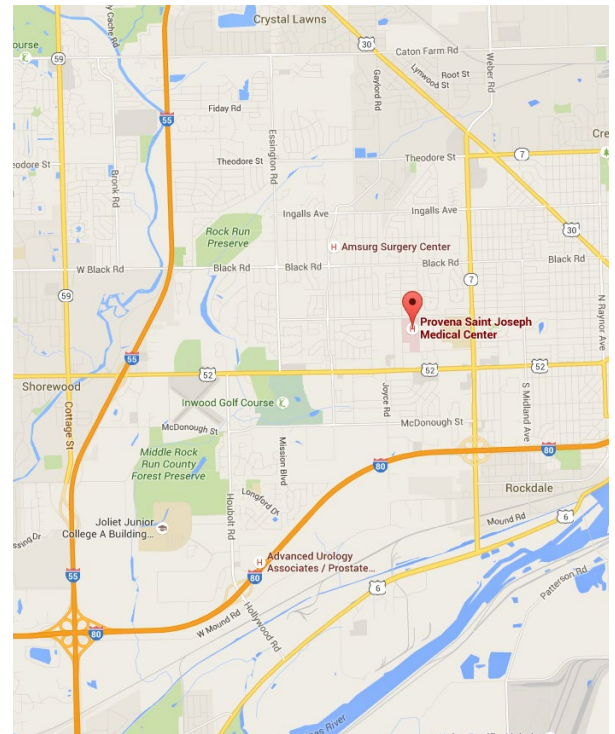

Brian Edgerton

+1 630 693 0671

bedgerton@hiffman.com

[PROPERTY WEBSITE](#)

MADISON MEDICAL PLAZA, JOLIET, ILLINOIS

Medical Suites For Lease

SECOND FLOOR

- SPACE AVAILABLE:
 - > Suite 210 - 3,109 SF

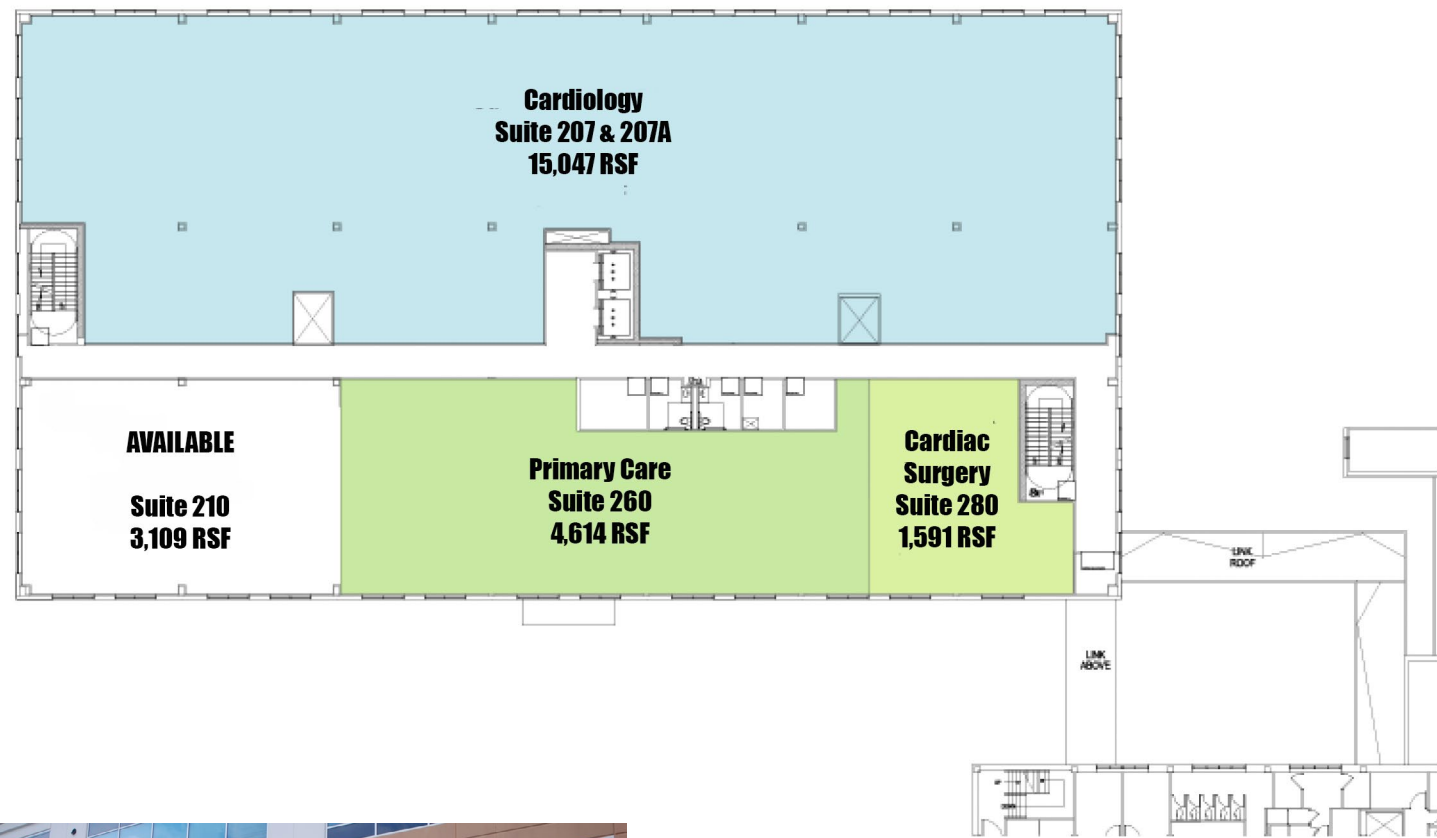

THIRD FLOOR

- SPACE AVAILABLE:
 - > Suite 303 - 1,563 SF
 - > Suite 308 - 2,760 SF

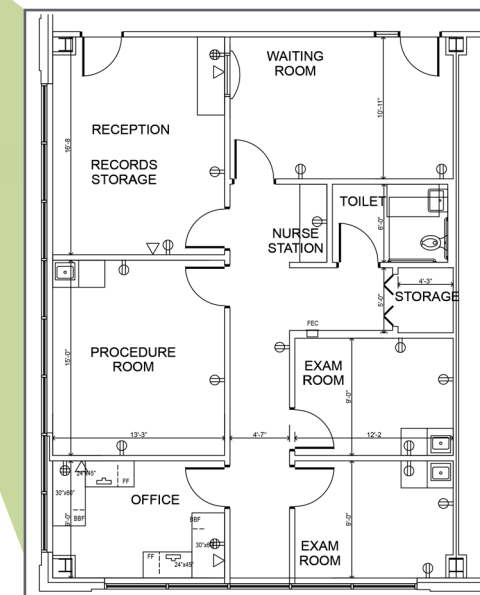
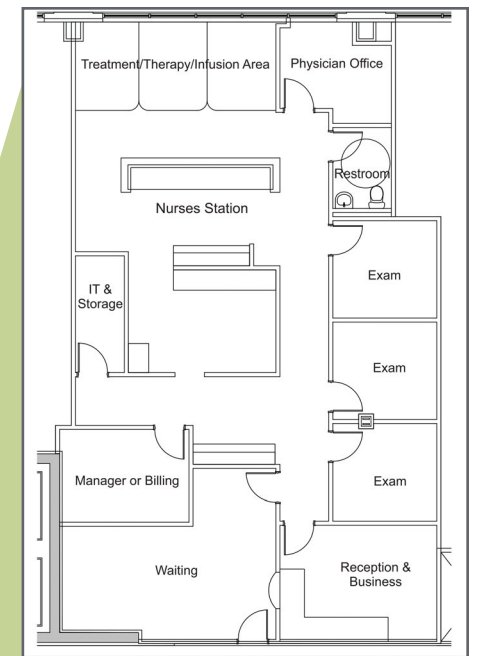
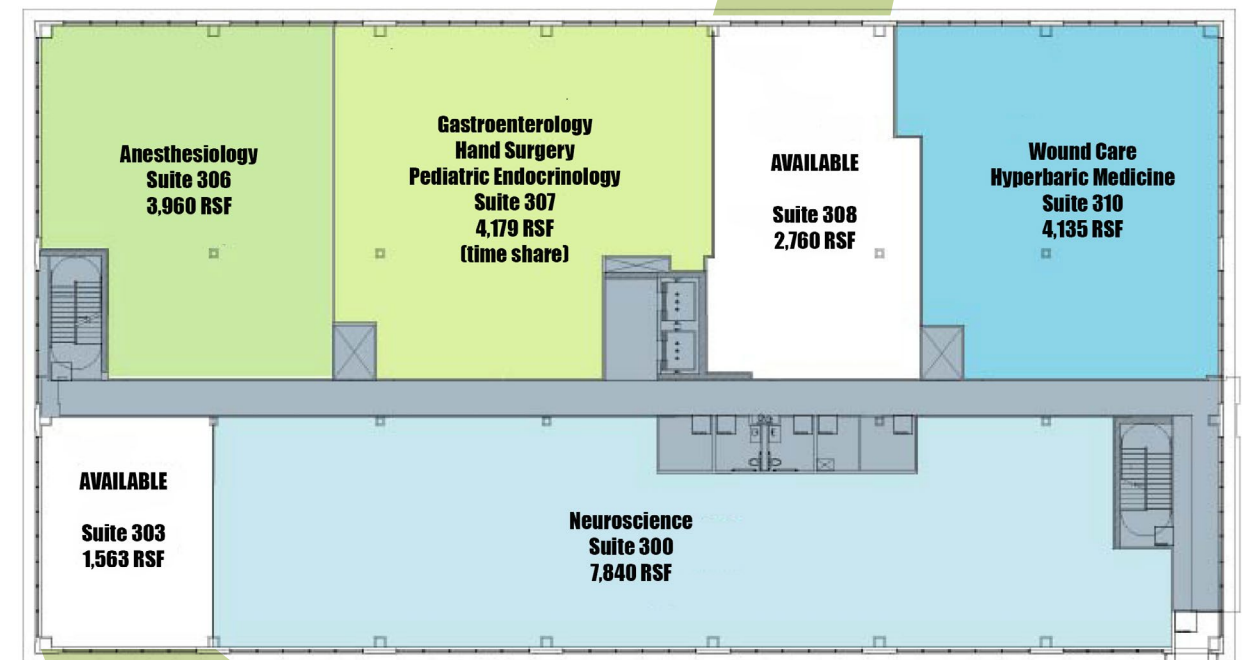

MADISON MEDICAL PLAZA, JOLIET, ILLINOIS

Medical Suites For Lease

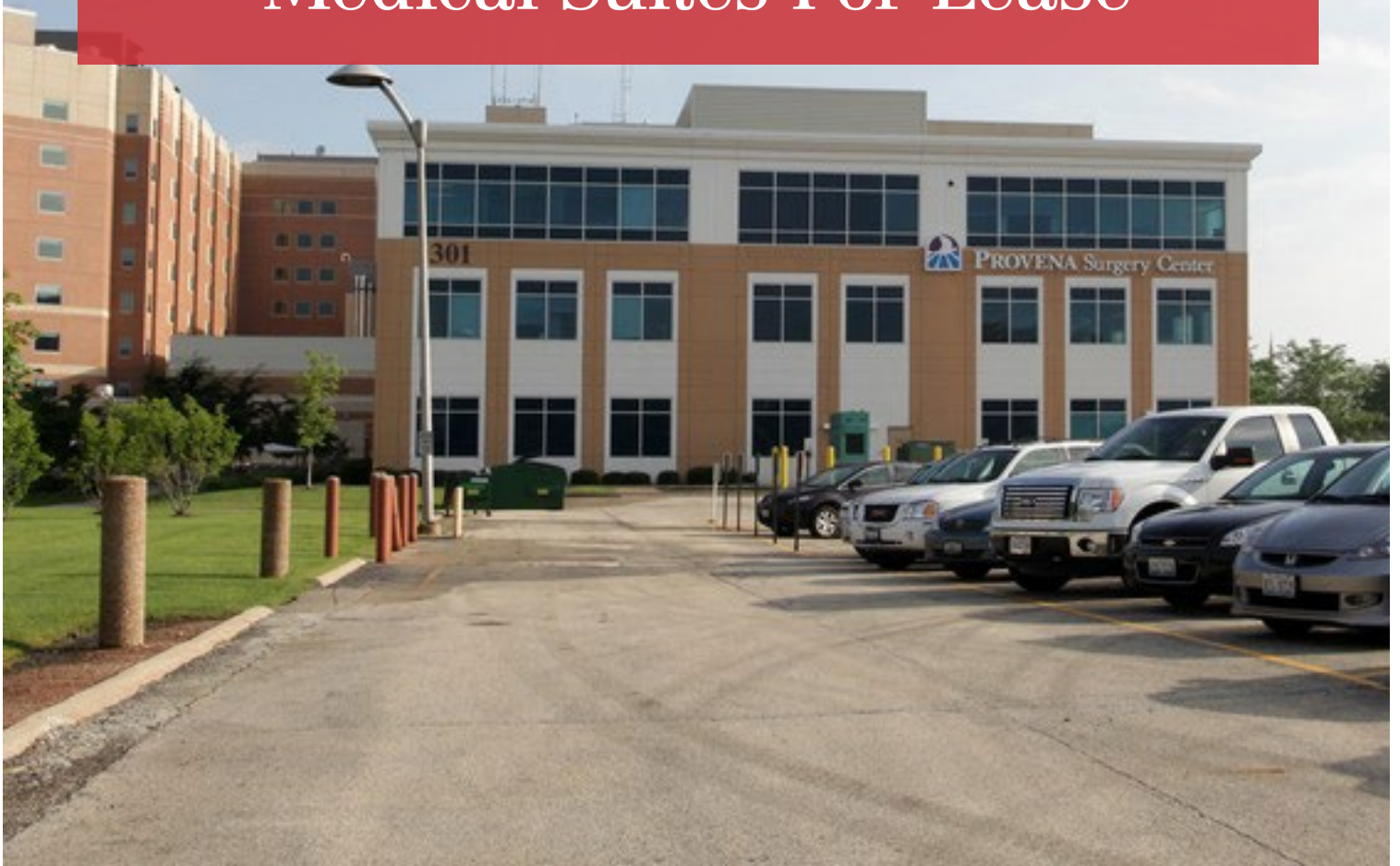

Brian Edgerton
+1 630 693 0671
bedgerton@hiffman.com