

RETAIL SPACE AVAILABLE

FOREST PARK PLAZA

MINUTES FROM I-290

3,808 SF
&
96,027 SF
FOR LEASE

7600 W Roosevelt Road
Forest Park Illinois

2 Outlots
6,000 SF Max Build



PROPERTY DETAILS

AVAILABLE SPACE

- 3,808 SF former clothing store
- 96,027 SF former HOBO space
- 2 outlots for 6,000 SF maximum build

PROPERTY DETAILS

- 254,433 SF shopping center
- Home to Living Word Christian Church (with attendance of ±18,000 people on a typical Sunday)
- Minutes from I-290 at Harlem Avenue
- Signalized intersections provides excellent ingress and egress to the center
- 27,800 VPD on Roosevelt Road
- Roosevelt Road new streetscape improvements completed

DEMOGRAPHICS

	Population	# of HH	HH Income
1 mile	17,299	7,003	\$81,592
3 miles	238,792	89,479	\$85,758
5 miles	642,165	224,342	\$73,333

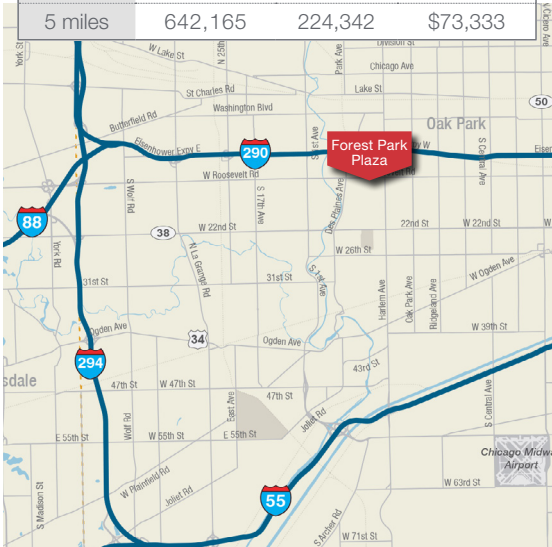

FOREST PARK PLAZA

7600 W Roosevelt Road
Forest Park Illinois

AVAILABLE FOR LEASE



PROPERTY DETAILS

FOREST PARK PLAZA

AVAILABLE FOR LEASE

7600 W Roosevelt Road
Forest Park Illinois

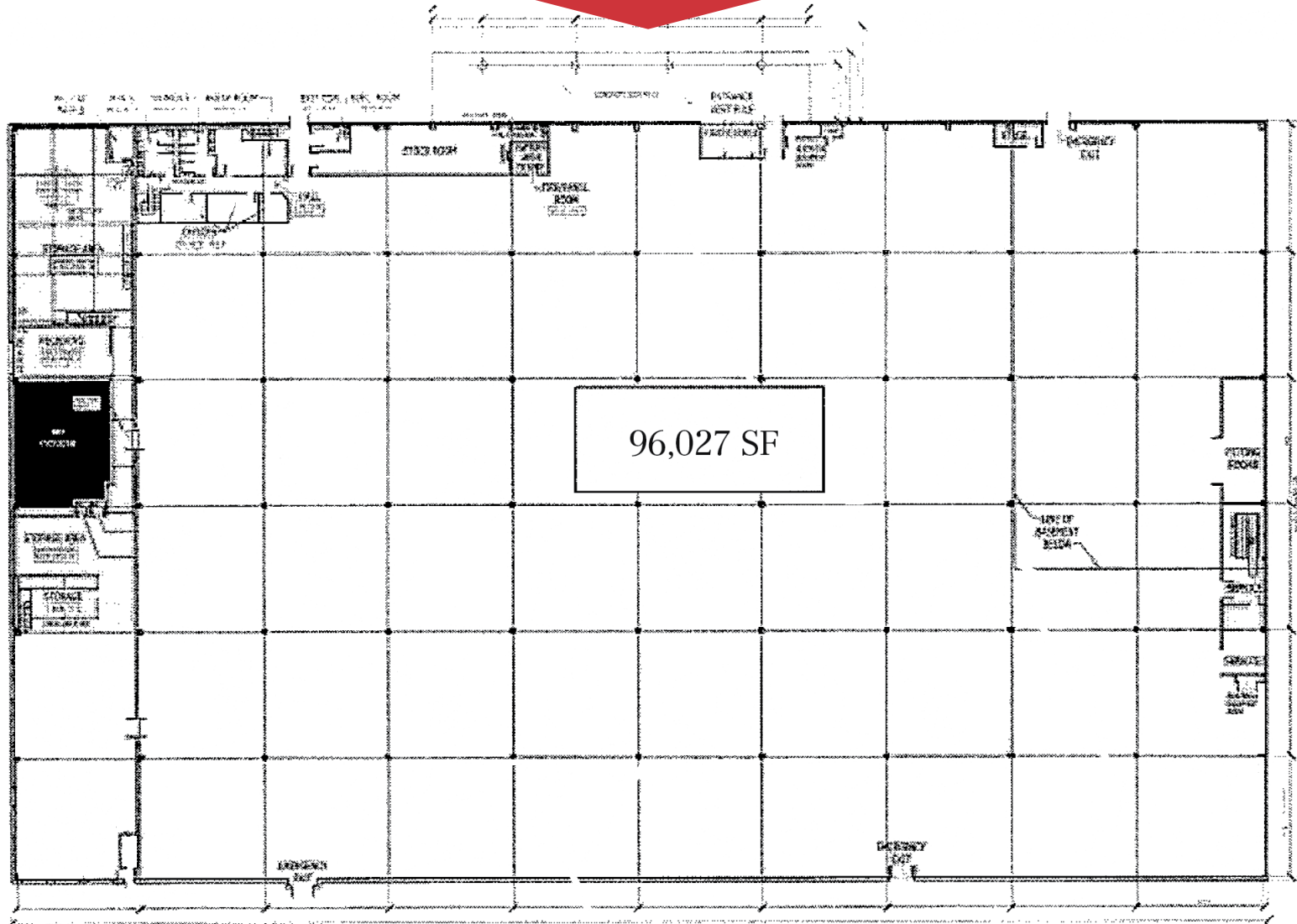

©2019 NAI HIFFMAN. ALL RIGHT RESERVED. ALL INFORMATION CONTAINED HEREIN IF FROM SOURCES DEEMED RELIABLE; HOWEVER, NO REPRESENTATION OR WARRANTY IS MADE TO THE ACCURACY THEREOF.

RETAIL SPACE AVAILABLE

FOREST PARK PLAZA

MINUTES FROM I-290

7600 W Roosevelt Road
Forest Park Illinois

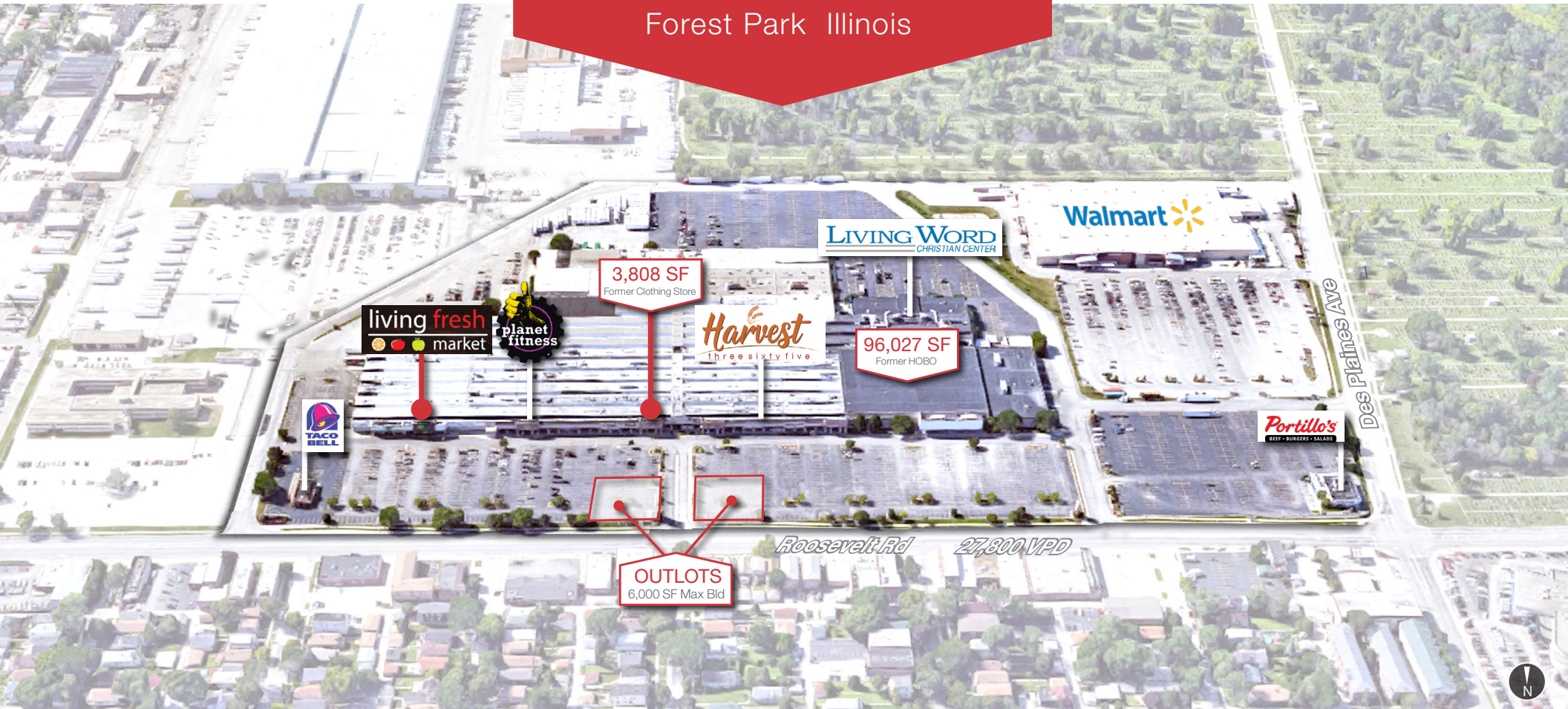

Join current tenants:



NAHiffman

One Oakbrook Terrace Suite 400
Oakbrook Terrace, Illinois 60181

hiffman.com

DAN HIFFMAN 630 693 0655 dan@hiffman.com