

NORTHWEST CORPORATE PARK I

# 32,122 SF Available for Lease

ELGIN ILLINOIS



## PROPERTY DETAILS

BUILDING SIZE	250,828 SF
AVAILABLE SF	32,122
OFFICE SF	2,330
BAY SIZE	46' X 50' TYPICAL
CLEAR HEIGHT	28'
LOADING	2 EXTERIOR DOCKS 1 DRIVE IN DOOR
CONSTRUCTION	PRECAST CONCRETE PANEL
SPRINKLER	ESFR
PARKING	31± SPACES
POWER	400 AMPS, 480/277 VOLTS 3 PHASE
HVAC	GAS UNIT HEATERS MAKE-UP AIR UNITS
FEATURES	T-5 WAREHOUSE LIGHTING ENERGY-EFFICIENT OFFICE LIGHT FIXTURES

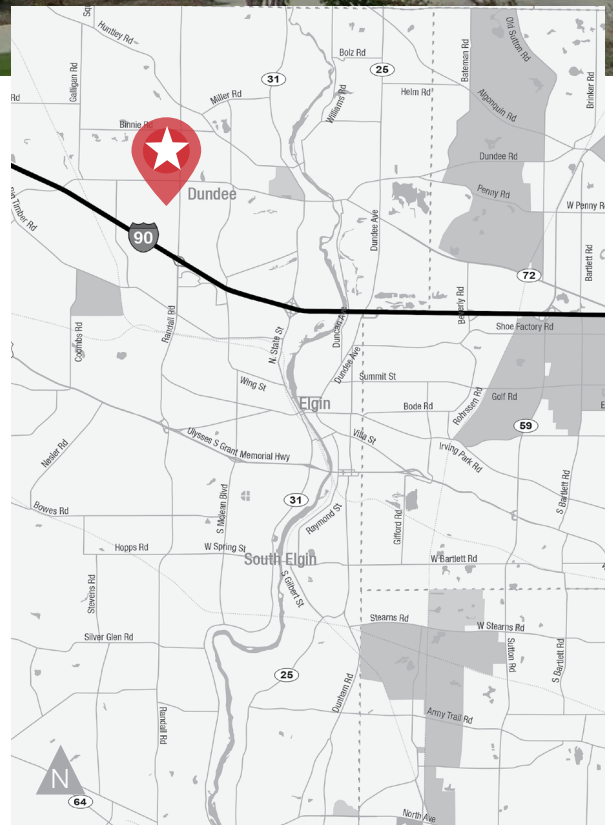

**\*\*CAN BE COMBINED WITH 2570 FOR 92,045 SF\*\***

**\*\*ON-SITE TRAILER PARKING AVAILABLE\*\***

2564 NORTHWEST PARKWAY  
ELGIN ILLINOIS



Commercial Real Estate Services, Worldwide

NORTHWEST CORPORATE PARK I

# 2564 Northwest Parkway Elgin IL

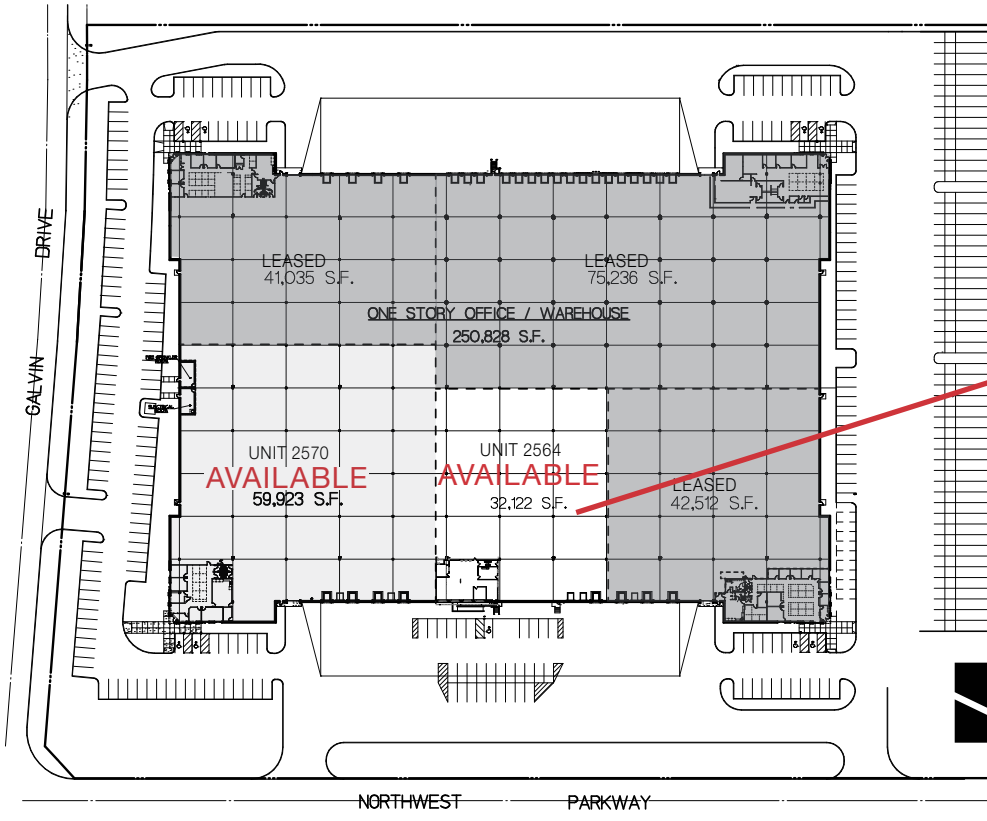

UNIT 2564 - 32,122 SF

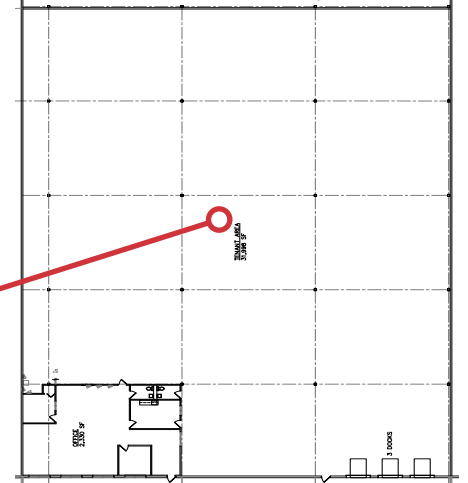

**NORTHWEST**  
CORPORATE PARK



**Steve Bass**

630 317 0738  
sbass@hiffman.com

**Jack Brennan**

630 317 0754  
jbrennan@hiffman.com

Owned by:



©2021 NAI Hiffman. All rights reserved. All information contained herein is from sources deemed reliable; however, no representation or warranty is made to the accuracy thereof.

