

NORTHWEST BUSINESS PARK III

41,013 SF Available for Lease

ELGIN ILLINOIS



NORTHWEST
BUSINESS PARK

PROPERTY DETAILS

BUILDING SIZE	250,530 SF
AVAILABLE SF	41,013
OFFICE SF	650±
CLEAR HEIGHT	30'
LOADING	4 EXTERIOR DOCKS (EXPANDABLE) 1 DRIVE IN DOOR (STANDARD) 1 DRIVE IN DOOR (20' X 18')
CONSTRUCTION	PRECAST PANEL
SPRINKLER	ESFR
PARKING	59 SPACES (EXPANDABLE)
BAY SIZE	50' X 40'
POWER	AMPLE, 480/277 VOLTS 3 PHASE
FEATURES	OVERSIZE DRIVE IN DOOR (20' X 18')

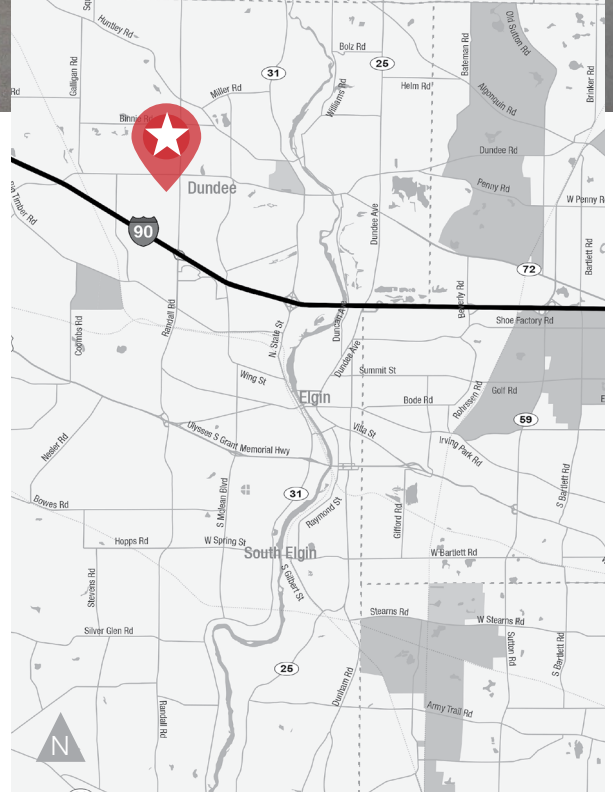

2762 SPECTRUM DRIVE
ELGIN ILLINOIS

NORTHWEST BUSINESS PARK III

2762 Spectrum Drive Elgin IL

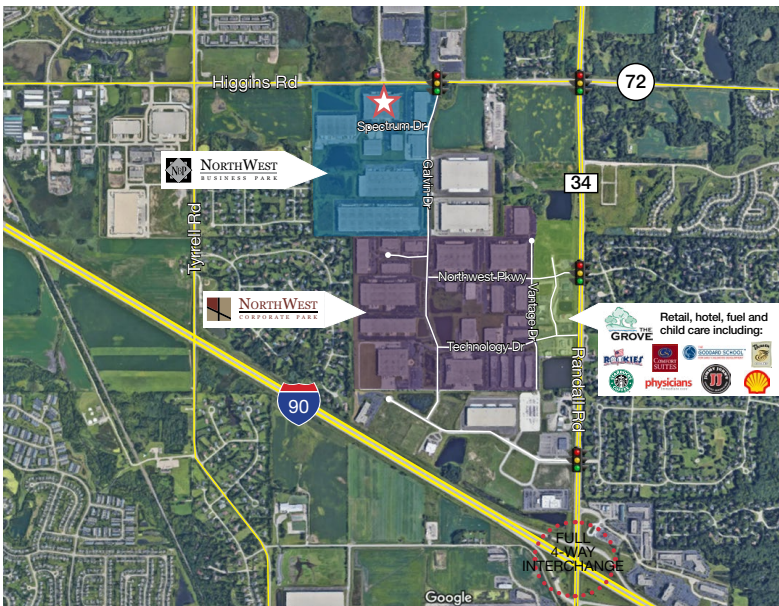
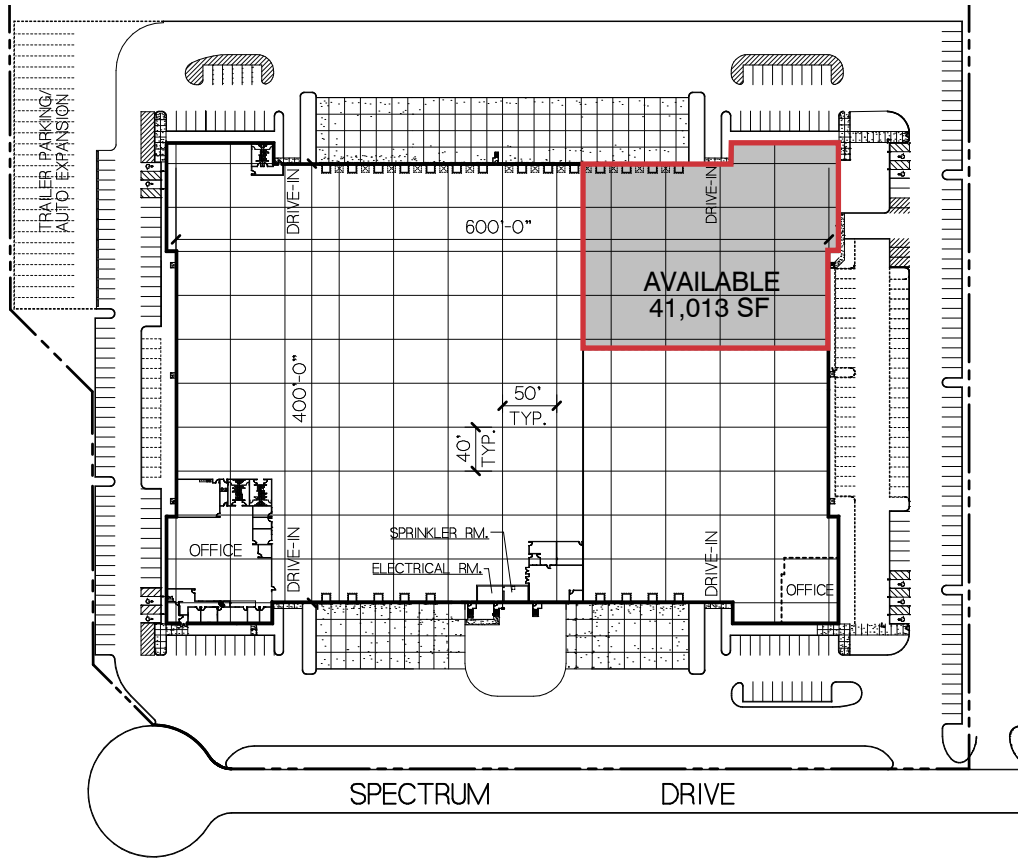

HIGHLIGHTS & FEATURES

- ±650 SF Office
- Oversize Drive-in Door (20' x 18')
- 30' Clear Height
- 25 Minutes to O'Hare International Airport
- Closest Access to Full 4-way Interchange in I-90 Corridor
- Full Range of Business Services at The Grove
- Full-time Property Management Service Representatives



NORTHWEST
BUSINESS PARK

Steve Bass

630 317 0738
sbass@hiffman.com

Jack Brennan

630 317 0754
jbrennan@hiffman.com

Owned by: