

# 1490 DENNISON CIRCLE

CARLISLE, PA 17013



60,000 - 135,000 SF | **FOR LEASE**

This Class A, front loading single story building is conveniently located in South Central Pennsylvania along Exit 44 of I-81 and is in close proximity to I-83, I-78 and I-76 (Pennsylvania Turnpike). Located 1 mile to UPS hub and within 26 miles to the Harrisburg Intermodal Yard (Lucknow).

## PROPERTY SPECIFICATIONS

Total Building Size:	300,000 SF
Year Built:	2008
Building Dimensions:	1000' x 300'
Available Space:	135,000 SF
Office:	3,400 SF
Warehouse:	131,600 SF
Truck Court:	190' deep with 10' concrete apron
Ceiling Height:	32'
Dock High Doors:	17
Drive In Doors:	2
Sprinkler:	ESFR
Lighting:	T-5

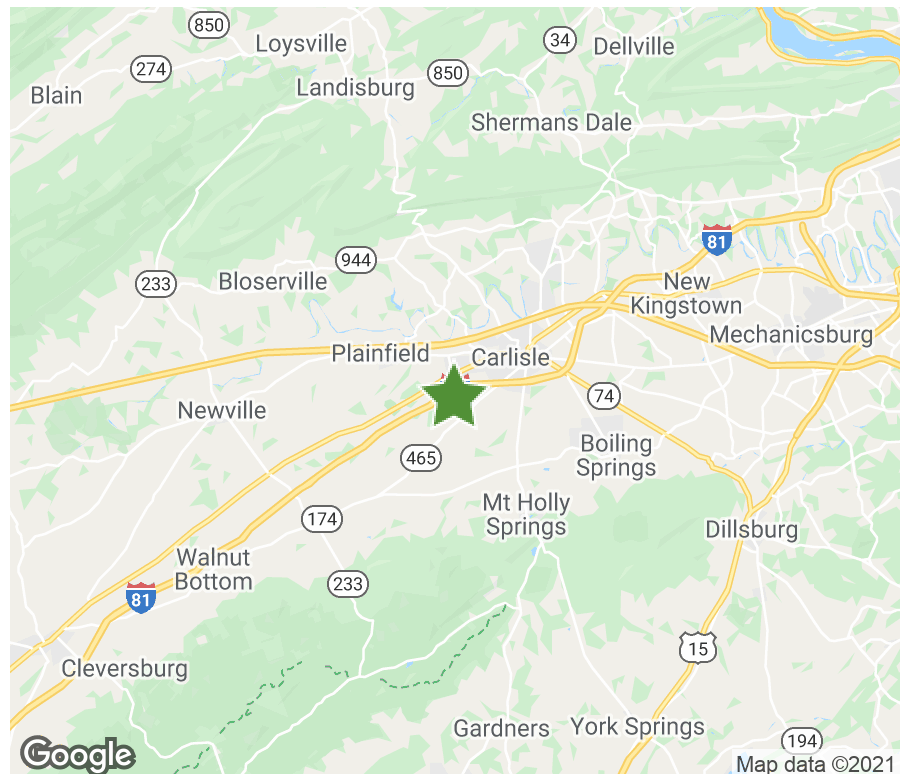

# 1490 DENNISON CIRCLE

60,000 - 135,000 SF | FOR LEASE

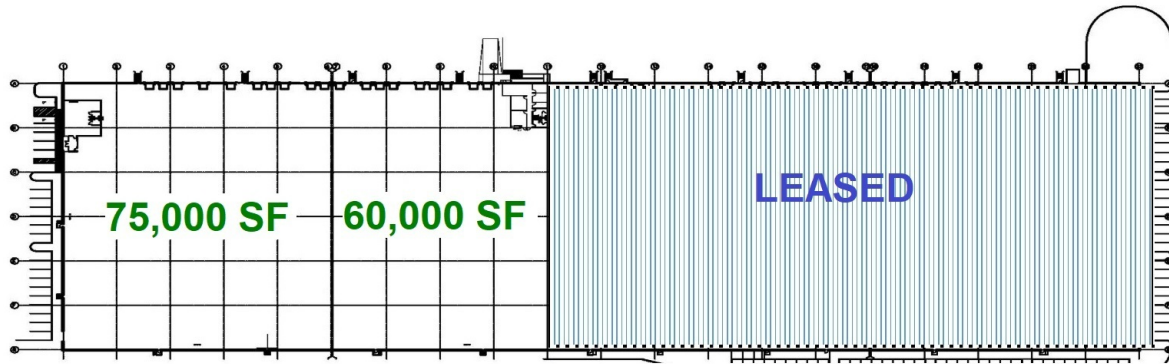

**FLOOR PLAN**

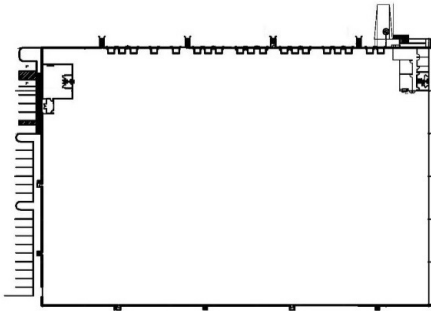

## BROKER CONTACT

### Maria Ratzlaff

Jones Lang LaSalle  
Vice President  
717.791.2210  
maria.ratzlaff@am.jll.com



## OWNER CONTACT

### Lois Matarazzi

Senior Marketing Leasing Coordinator  
717.216.2020  
lmatarazzi@firstindustrial.com



2780 Commerce Drive, Suite 100

Middletown, PA 17057

717.657.0372

All information furnished regarding the property for sale, rental or financing is obtained from sources deemed reliable. No representation is made to the accuracy thereof and is submitted subject to errors, omissions, change of price rental or other conditions, prior sale, lease, or financing, or withdrawal without notice. First Industrial Realty Trust, Inc. represents the Seller in this transaction and as such owes all duties and obligations thereto.