



For Lease

Retail | 1,086 - 2,120 SF

\$13.00 SF/yr

109 & 111 1/2 S Washington Sq.

Lansing, Michigan 48933

Property Highlights

- 109 S. Washington Square is 2,120 SF of open retail space with plentiful basement storage
- Formerly the site of Craving's Popcorn Store and ideal for similar retail users
- 111 1/2 S. Washington Square is 1,086 SF of open retail space
- Formerly occupied by a salon user and ideal for similar uses
- Prime Washington Square/downtown location with substantial foot traffic
- Join Neighboring retailers such as Jimmy Johns, Los Tres Amigos & La Cocina Cubana
- Minutes from Michigan State Capitol Building.

Property Description

Two retail suites available for lease in Downtown Lansing area

OFFERING SUMMARY

Available SF	1,086 - 2,120 SF
Lease Rate	\$13.00 SF/yr (NNN)
Building Size	6,360 SF

DEMOGRAPHICS

Stats	Population	Avg. HH Income
1 Mile	11,522	\$34,899
3 Miles	91,288	\$45,881
5 Miles	204,826	\$49,024

For more information

**Tanner Lundberg, Commercial
Advisor**

O: 517 487 9222 | C: 517 281 1962
tlundberg@naimidmichigan.com

For Lease

Retail | 1,086 - 2,120 SF

\$13.00 SF/yr

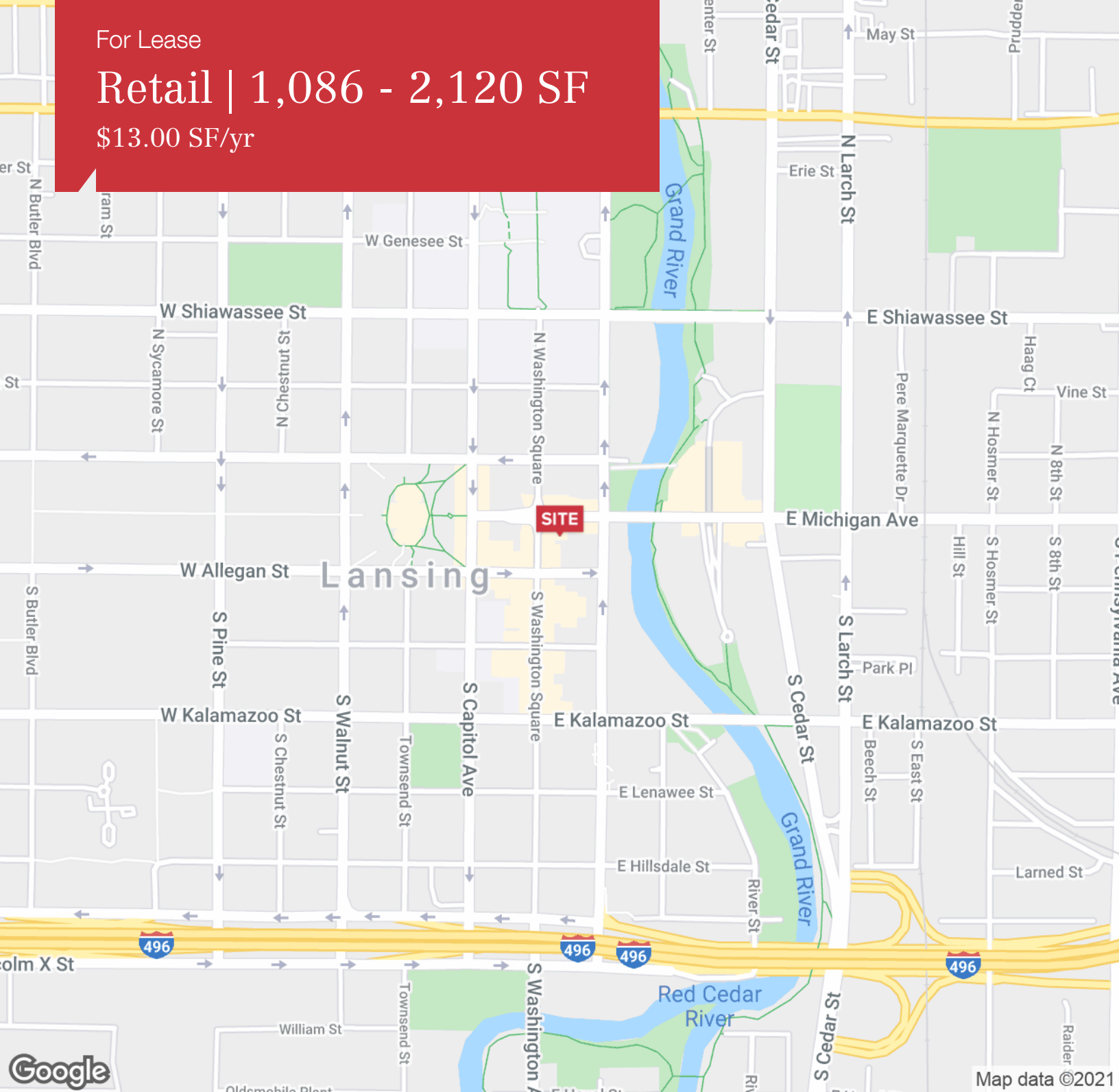

LOCATION DESCRIPTION

Located in Downtown Lansing two blocks from the Michigan State Capitol Building. Surrounded by local and national retailers alike and one mile north of I-496 Highway servicing all parts of Downtown Lansing/East Lansing.

For Lease

Retail | 1,086 - 2,120 SF

\$13.00 SF/yr

LEASE TYPE | NNN **TOTAL SPACE** | 1,086 - 2,120 SF **LEASE TERM** | Negotiable **CAM & TAX** |

109 S. Washington Sq.

111 1/2 S. Washington Square

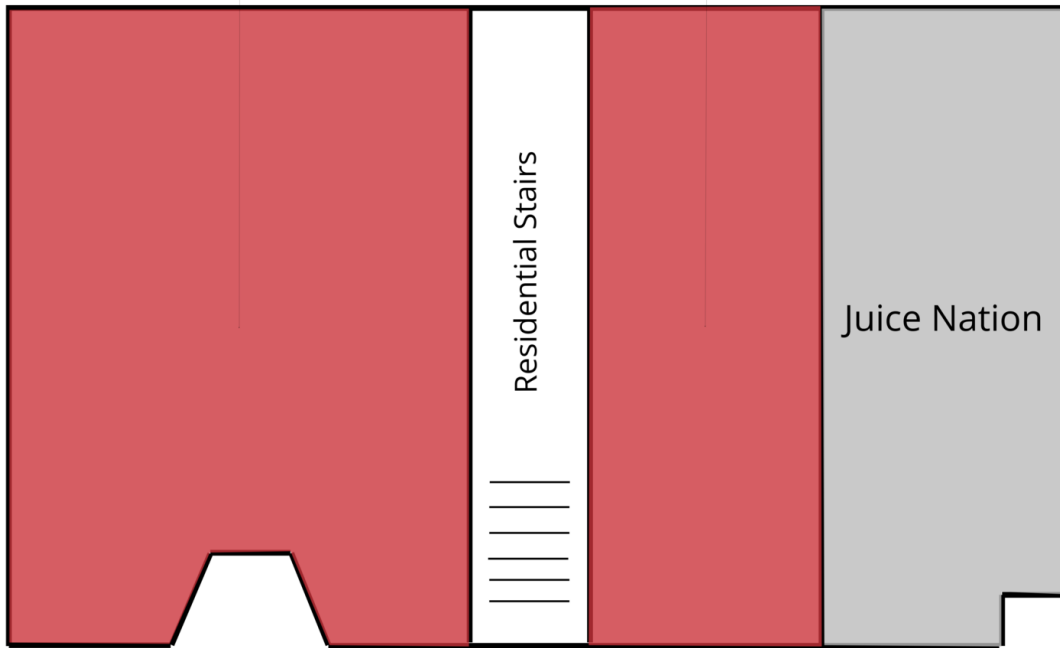

UNAVAILABLE

AVAILABLE

SUITE

SIZE

TENANT

TYPE

RATE

109 S. Washington Sq.

2,120 SF

Available

NNN

\$13.00 SF/yr

111 1/2 S. Washington Square

1,000 SF

Available

NNN

\$13.00 SF/yr