



FOR LEASE



RETAIL



1,710 SF



1795 Long Beach Blvd

Long Beach, California 90813

Property Highlights

- Located on the Corner of Long Blvd Blvd and Pacific Coast Hwy
- 60,000 ADTC
- Major Metro Transit Hub
- with 15,000 ave weekly boarding on the Blue Line
- Seeking Cafes, Services, Community stores for this very busy intersection
- New Mixed Use Building - Retail Space Available
- Patio Seating Available
- 8 retail parking spaces included
- Available early 2021
- Retail 1 – 1160sf
- Retail 2 – 1710sf
- Retail 3 – 1210sf

OFFERING SUMMARY

Lease Rate:	\$2.75 SF/yr (NNN)
Available SF:	1,160 SF - 2,920 SF
Lot Size:	1 Acres
Building Size:	105,000 SF

DEMOGRAPHICS

	1 MILE	2 MILES	3 MILES
Total Households	19,095	47,453	75,374
Total Population	45,381	137,643	222,093
Average HH Income	\$50,901	\$46,685	\$51,604



Patrick Ortiz

Senior Vice President | 818.905.2400
portiz@naicapital.com | CalDRE #01756382

Jesse Paster

Vice President | 818.742.1624
jpaster@naicapital.com | CalDRE #01316106



www.naicapital.com

NO WARRANTY, EXPRESS OR IMPLIED, IS MADE AS TO THE ACCURACY OF THE INFORMATION CONTAINED HEREIN. THIS INFORMATION IS SUBMITTED SUBJECT TO ERRORS, OMISSIONS, CHANGE OF PRICE, RENTAL OR OTHER CONDITIONS, WITHDRAWAL WITHOUT NOTICE, AND IS SUBJECT TO ANY SPECIAL LISTING CONDITIONS IMPOSED BY OUR PRINCIPALS. COOPERATING BROKERS, BUYERS, TENANTS AND OTHER PARTIES WHO RECEIVE THIS DOCUMENT SHOULD NOT RELY ON IT, BUT SHOULD USE IT AS A STARTING POINT OF ANALYSIS, AND SHOULD INDEPENDENTLY CONFIRM THE ACCURACY OF THE INFORMATION CONTAINED HEREIN THROUGH A DUE DILIGENCE REVIEW OF THE BOOKS, RECORDS, FILES AND DOCUMENTS THAT CONSTITUTE RELIABLE SOURCES OF THE INFORMATION DESCRIBED HEREIN. LOGOS ARE FOR IDENTIFICATION PURPOSES ONLY AND MAY BE TRADEMARKS OF THEIR RESPECTIVE COMPANIES. NAI CAPITAL, INC. CAL DRE LIC. #01990696.



FOR LEASE



RETAIL



1,710 SF

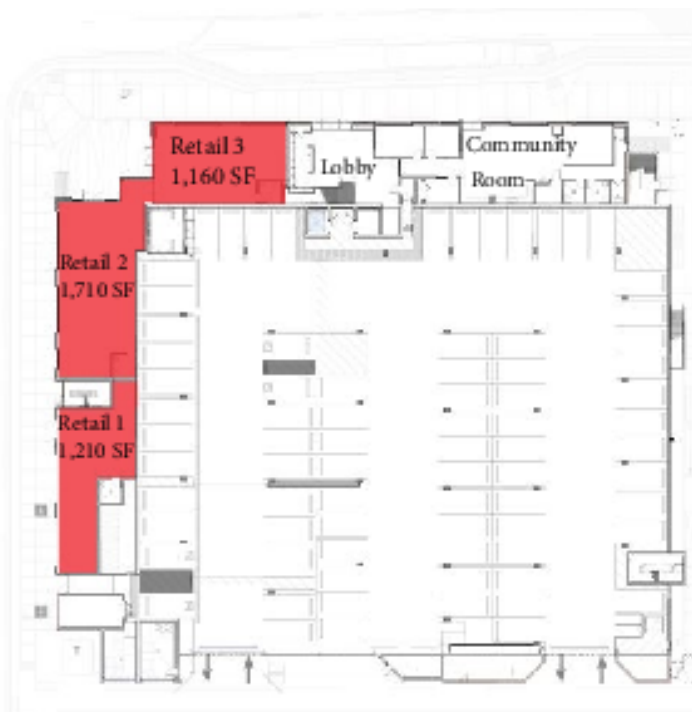
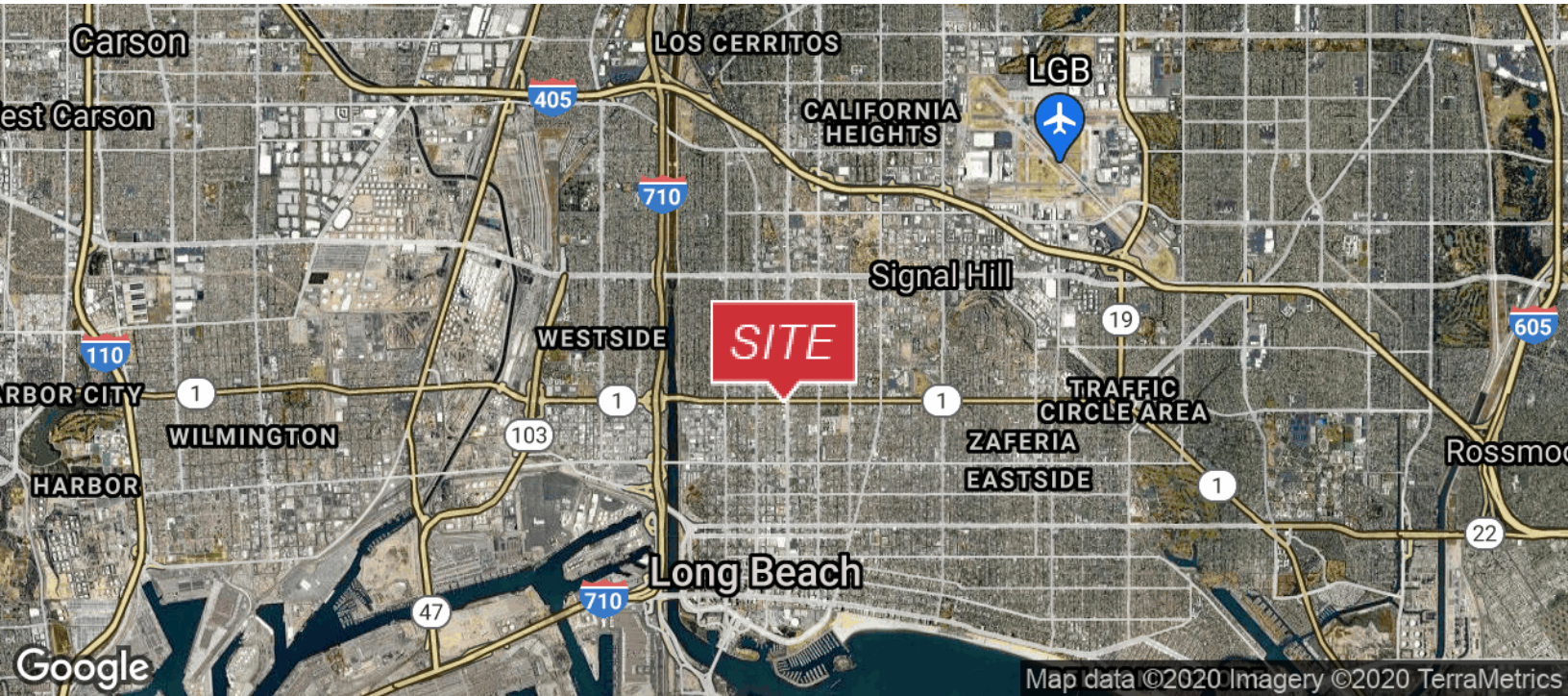

Patrick Ortiz

Senior Vice President | 818.905.2400
portiz@naicapital.com | CalDRE #01756382

Jesse Paster

Vice President | 818.742.1624
jpaster@naicapital.com | CalDRE #01316106

