



## Premier Lofts

2200 Market Street | Denver, CO 80206

### Property Features

- 1,884 SF street level retail space available for lease
- Loft-style apartment building with 250 units
- Two (2) dedicated spaces in parking garage
- Located in the heart of Denver's Ballpark District steps from Coors Field, Union Station, and Central Business District
- Strong visibility on 22nd Street and Park Avenue West
- More than 18,000 apartments and 145,000 total employees in Downtown Denver

### Contact Broker for Lease Rate

### Property Details

BUILDING SIZE	282,781 SF
AVAILABLE	1,884 SF
YEAR BUILT	2004
TOTAL UNITS	250 Apartments

For more information:

**Cory Dulberg**

+1 303 565 3039

[cdulberg@shamesmakovsky.com](mailto:cdulberg@shamesmakovsky.com)

NO WARRANTY OR REPRESENTATION, EXPRESS OR IMPLIED, IS MADE AS TO THE ACCURACY OF THE INFORMATION CONTAINED HEREIN, AND THE SAME IS SUBMITTED SUBJECT TO ERRORS, OMISSIONS, CHANGE OF PRICE, RENTAL OR OTHER CONDITIONS, PRIOR SALE, LEASE OR FINANCING, OR WITHDRAWAL WITHOUT NOTICE, AND OF ANY SPECIAL LISTING CONDITIONS IMPOSED BY OUR PRINCIPALS NO WARRANTIES OR REPRESENTATIONS ARE MADE AS TO THE CONDITION OF THE PROPERTY OR ANY HAZARDS CONTAINED THEREIN ARE ANY TO BE IMPLIED.

1400 Glenarm Place, Suite 100  
Denver, Colorado 80202  
+1 303 534 5005  
[naishamesmakovsky.com](http://naishamesmakovsky.com)

FOR LEASE

1,884 SF

2200 Market Street | Denver, CO 80205

## Floor Plan

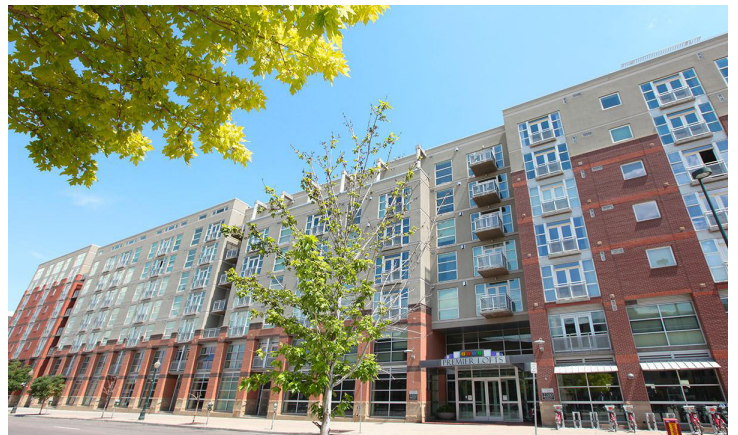
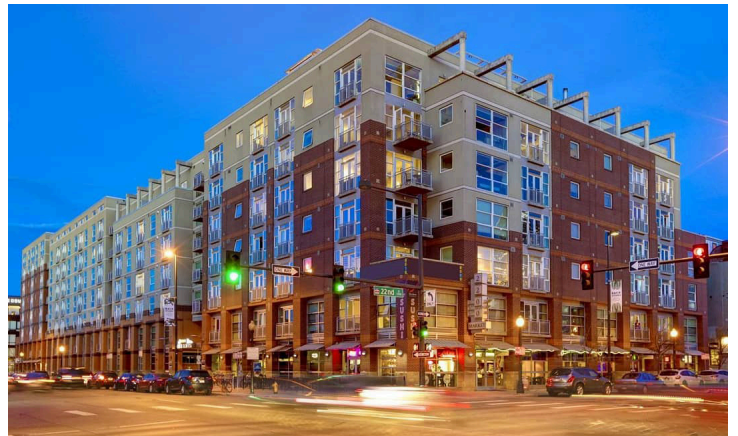
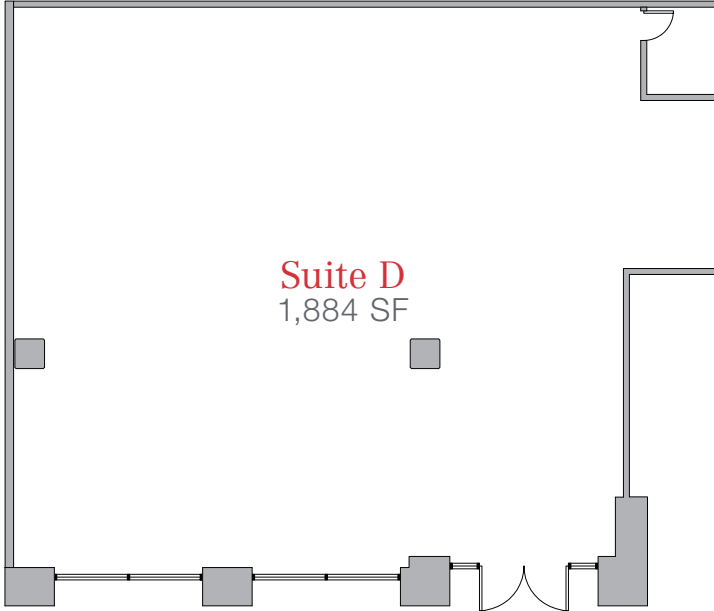

FOR LEASE

1,884 SF

2200 Market Street | Denver, CO 80205

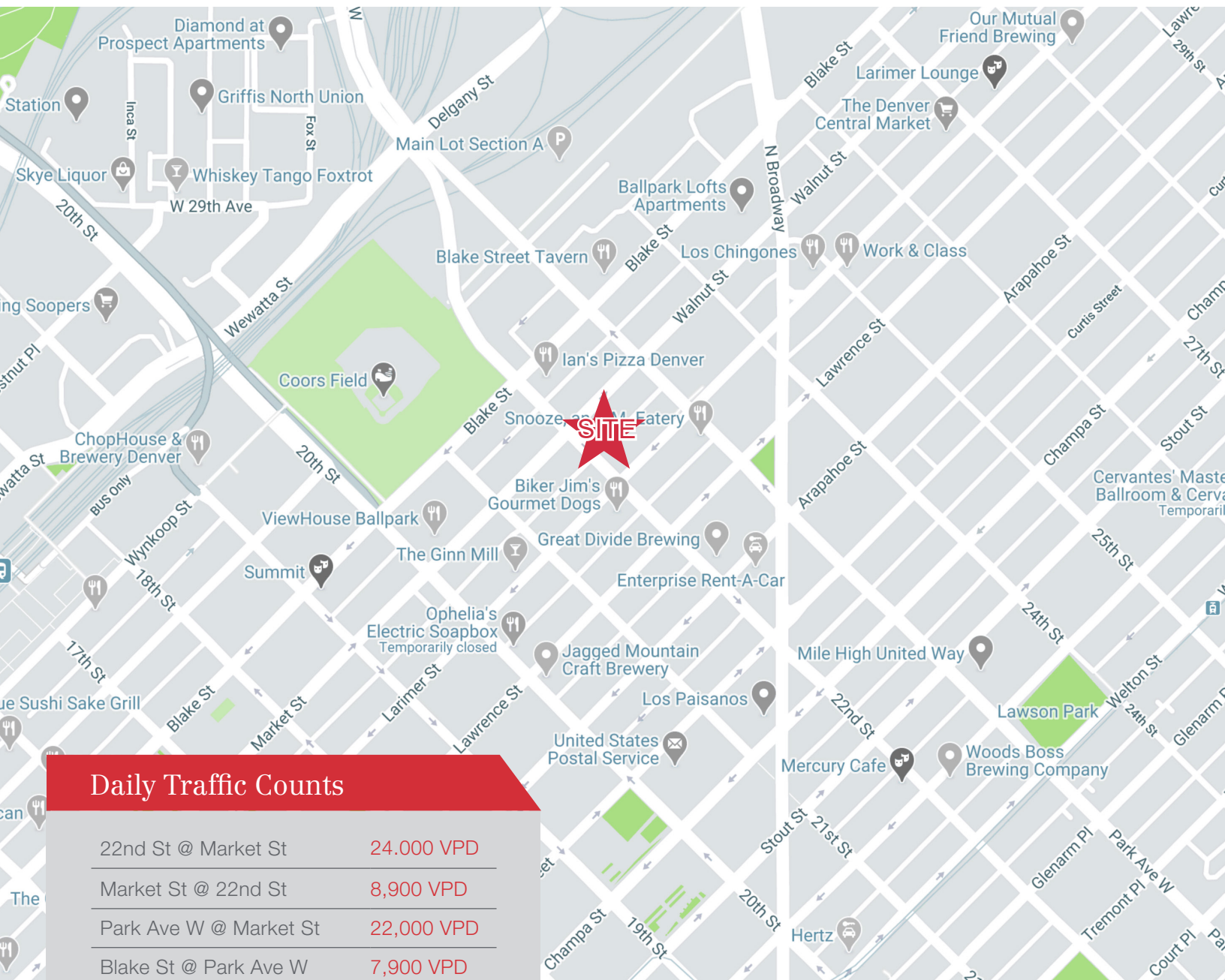

### Daily Traffic Counts

22nd St @ Market St	24,000 VPD
Market St @ 22nd St	8,900 VPD
Park Ave W @ Market St	22,000 VPD
Blake St @ Park Ave W	7,900 VPD

For more information:

**Cory Dulberg**

+1 303 565 3039

[cdulberg@shamesmakovsky.com](mailto:cdulberg@shamesmakovsky.com)

Walk Score

96

Transit Score

88

Bike Score

98

1400 Glenarm Place, Suite 100  
Denver, Colorado 80202  
+1 303 534 5005

**NAI**Shames Makovsky

[naishamesmakovsky.com](http://naishamesmakovsky.com)