

MSC



THE STANDARD AT AUSTIN

715 W 23RD STREET, AUSTIN, TEXAS

±4,000 SF OF RETAIL/RESTAURANT OPPORTUNITIES FOR LEASE



DEVELOPED BY:



THE STANDARD AT AUSTIN



715 W 23RD STREET | AUSTIN, TX

±4,000 SF OF RETAIL/RESTAURANT OPPORTUNITIES FOR LEASE

CONTACT



MATTHEW STEIN

mstein@hellomsc.com
833.FOR.MSCU

MATTHEW COOPER

mcooper@hellomsc.com
833.FOR.MSCU



PROPERTY DETAILS

- 4,000 retail / restaurant opportunity for lease adjacent to University of Texas
- New construction, mixed use student housing project comprised of 974 beds / 287 units
- In the center of residential density near campus
- Walking distance to Greek Row
- One mile from the State Capitol
- Tenant delivery estimated for Fall 2021

NEIGHBORING AREA RETAIL

URBAN OUTFITTERS



The information contained herein has been obtained from sources deemed reliable. MSC cannot verify it and makes no guarantee, warranty or representation about its accuracy. Any projections, opinions, assumptions or estimates provided by MSC are for discussion purposes only and do not represent the current or future performance of a property, location or market.

MSC

SITE PLAN

CONTACT

MATTHEW STEIN
mstein@hellomsc.com
833.FOR.MSCU

MATTHEW COOPER
mcooper@hellomsc.com
833.FOR.MSCU

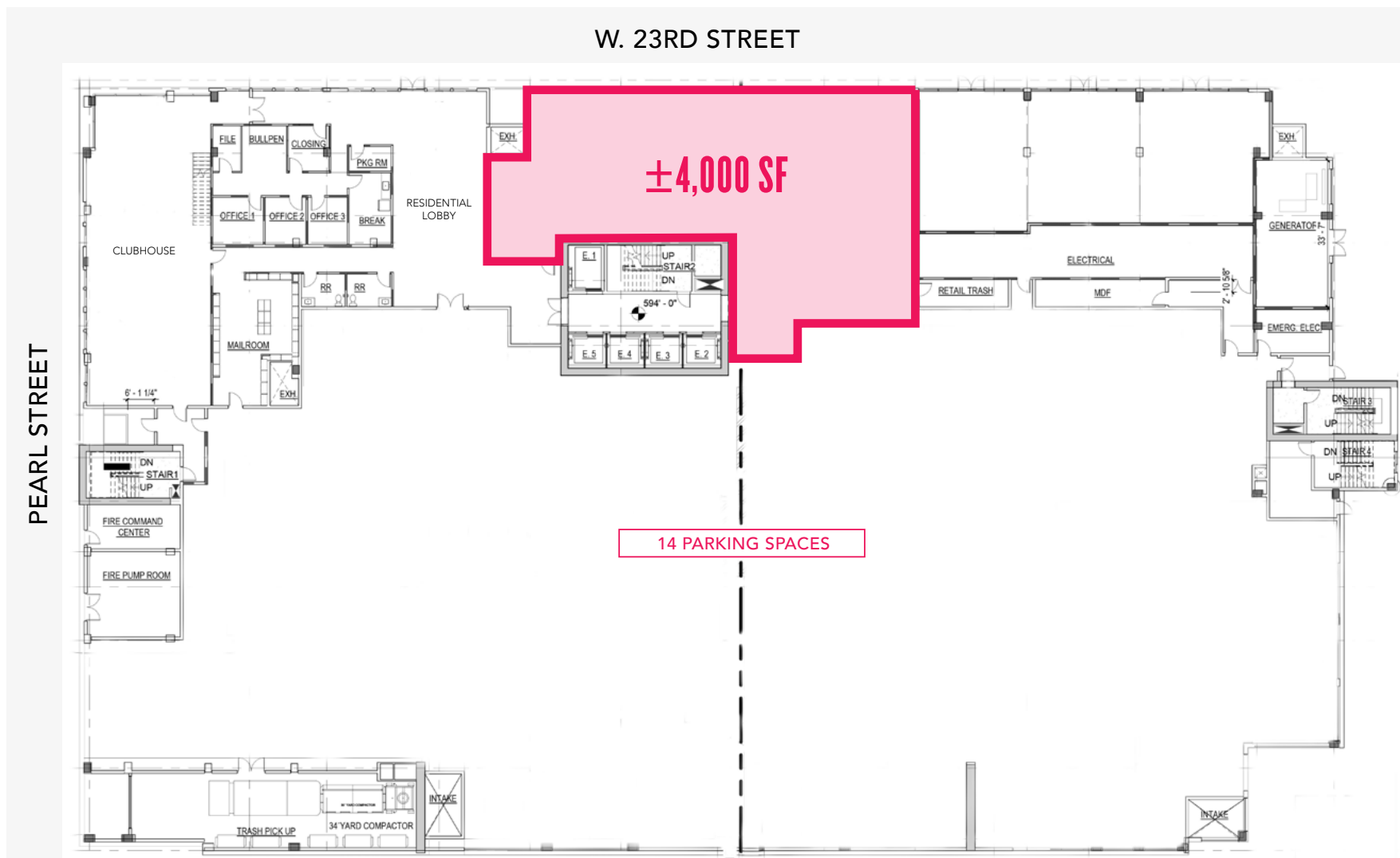

THE STANDARD AT AUSTIN



715 W 23RD STREET | AUSTIN, TX

EXTERIOR RENDERINGS

CONTACT



MATTHEW STEIN
mstein@hellomsc.com
833.FOR.MSCU

MATTHEW COOPER
mcooper@hellomsc.com
833.FOR.MSCU



VIEW FROM NORTHEAST



VIEW FROM NORTHWEST

NEIGHBORHOOD LANDMARKS

CONTACT

MATTHEW STEIN
mstein@hellomsc.com
833.FOR.MSCU

MATTHEW COOPER
mcooper@hellomsc.com
833.FOR.MSCU

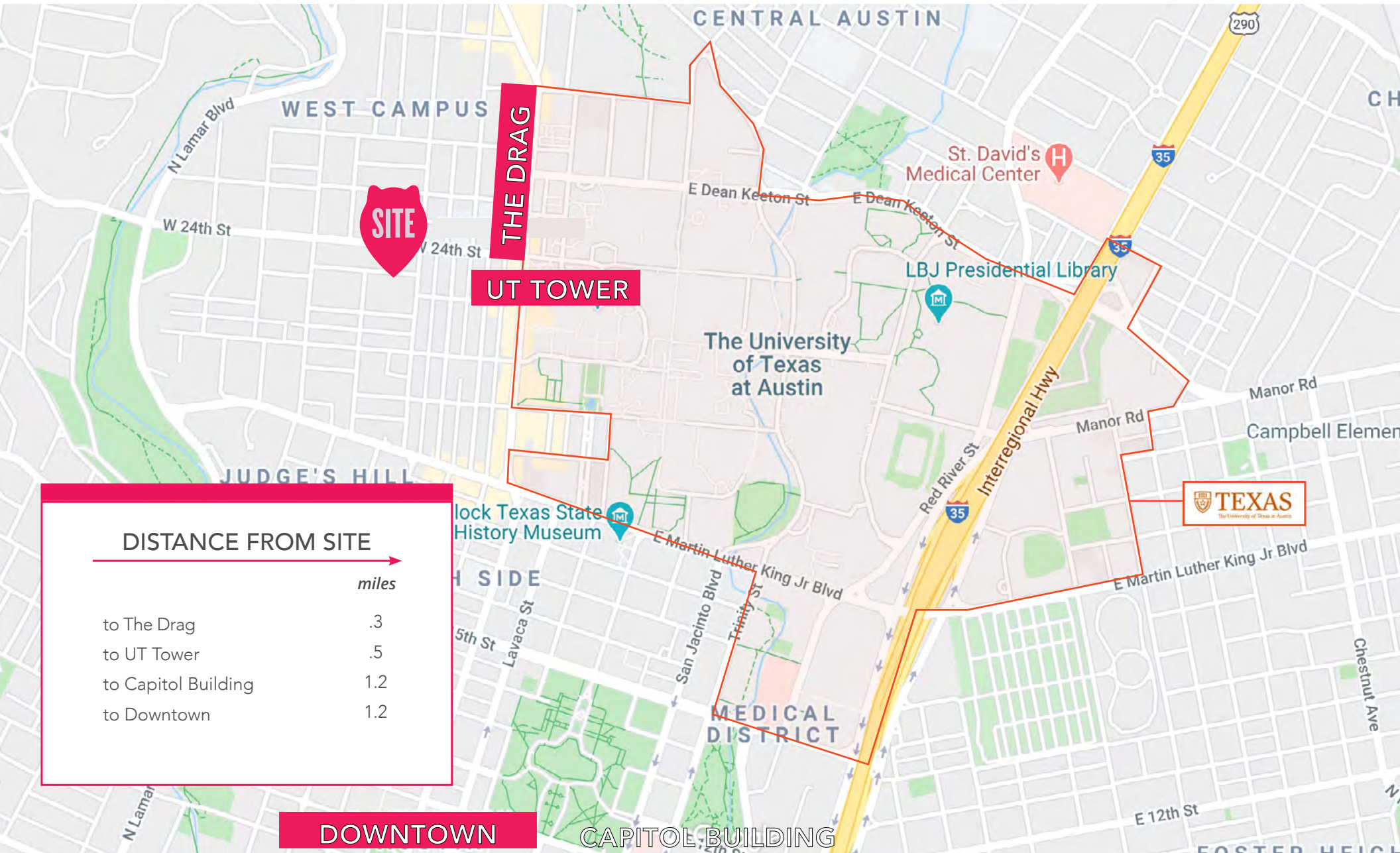

THE STANDARD AT AUSTIN



715 W 23RD STREET | AUSTIN, TX

STRIP MAP

CONTACT



MATTHEW STEIN
mstein@hellomsc.com
833.FOR.MSCU

MATTHEW COOPER
mcooper@hellomsc.com
833.FOR.MSCU

MARTIN LUTER
KING JR BLVD

W 24TH STREET



GUADALUPE STREET
"THE DRAG"

The information contained herein has been obtained from sources deemed reliable. MSC cannot verify it and makes no guarantee, warranty or representation about its accuracy. Any projections, opinions, assumptions or estimates provided by MSC are for discussion purposes only and do not represent the current or future performance of a property, location or market.



CSU AT A GLANCE



TEXAS
The University of Texas at Austin



51,832

TOTAL STUDENT POPULATION

Undergraduate	40,800
Graduate	11,000
Faculty/Staff	3,200

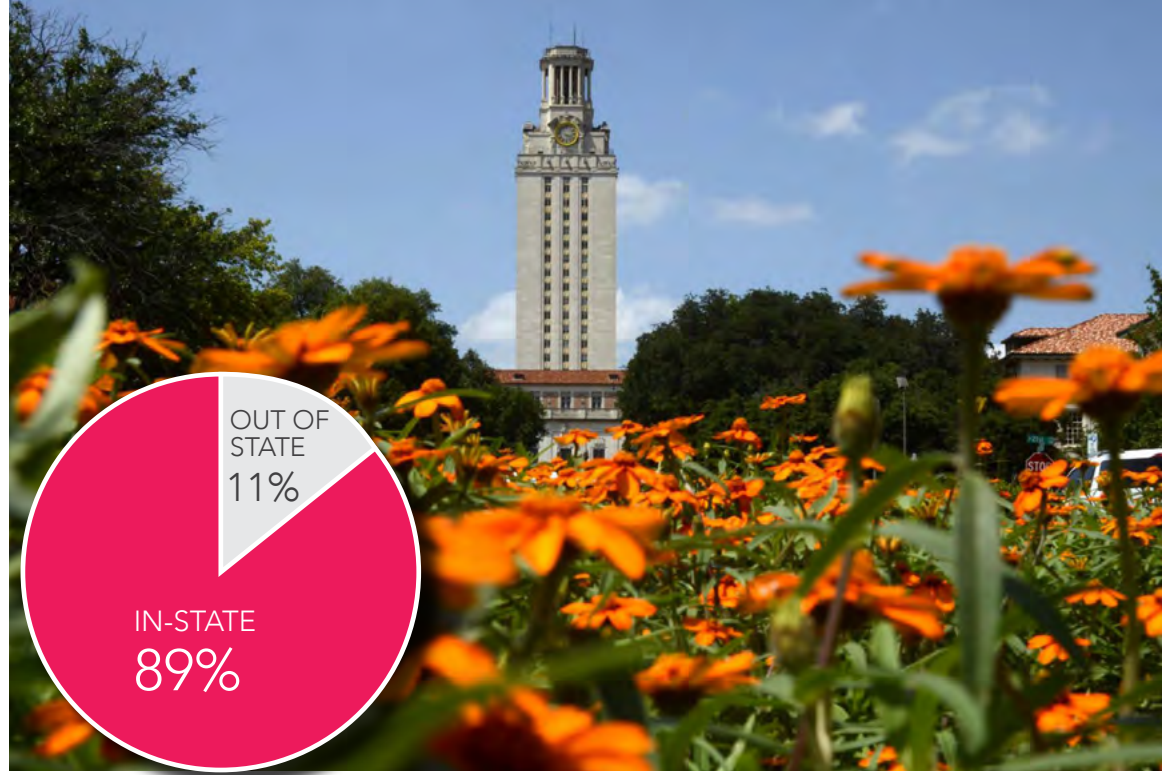
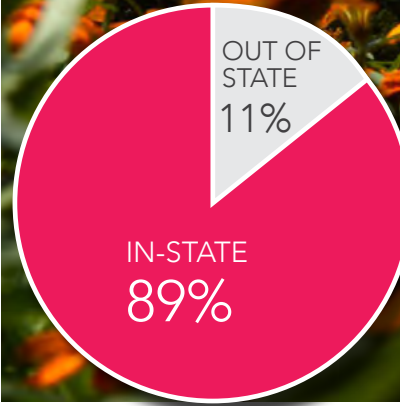

POPULATION SUMMARY

	1 Mile	3 Mile	5 Mile
2019 Estimated Population	37,264	173,783	376,727
2024 Projected Population	39,374	188,920	410,293
Projected Annual Growth 2019 to 2024	1.1%	1.7%	1.8%
Historical Annual Growth 2000 to 2019	1.9%	1.9%	1.4%

2019 HOUSEHOLDS BY INCOME

	1 Mile	3 Mile	5 Mile
<\$15,000	43.2%	15.8%	14.3%
\$15,000 - \$24,999	10.5%	7.4%	8.3%
\$25,000 - \$34,999	5.9%	6.4%	7.5%
\$35,000 - \$49,000	8.0%	10.0%	11.7%
\$50,000 - \$74,999	10.0%	14.2%	15.8%
\$75,000 - \$99,999	7.5%	11.4%	11.7%
\$100,000 - \$149,999	6.9%	14.2%	13.1%
\$150,000 - \$199,999	3.9%	8.6%	7.4%
\$200,000+	4.1%	11.9%	10.2%
Average Household Income	\$41,317	\$96,346	\$92,668

HOUSEHOLD SUMMARY

	1 Mile	3 Mile	5 Mile
2019 Estimated Households	13,500	82,416	171,321
2024 Projected Households	15,052	91,914	191,211
Projected Annual Growth 2019 to 2024	2.3%	2.3%	2.3%
Historical Annual Growth 2000 to 2019	2.0%	2.7%	1.9%
2019 Estimated Total Housing Units	13,911	85,519	177,366
2019 Estimated Owner-Occupied	13.3%	29.7%	31.8%
2019 Estimated Renter-Occupied	83.8%	66.7%	64.8%
2019 Estimated Vacant Housing	3.0%	3.6%	3.4%

DATA FOR ALL BUSINESSES IN AREA

	1 Mile	3 Mile	5 Mile
2019 Estimated Total Businesses	4,026	16,573	28,311
2019 Estimated Total Employees	80,918	226,597	335,337

2018 MEDIAN AGE

	1 Mile	3 Mile	5 Mile
2019 Median Age	24.3	32.7	33.1

DEMOGRAPHICS



MSC

FOR MORE INFORMATION:

Matthew Stein
mstein@hellomsc.com | 833.FOR.MSCU

Matthew Cooper
mcooper@hellomsc.com | 833.FOR.MSCU

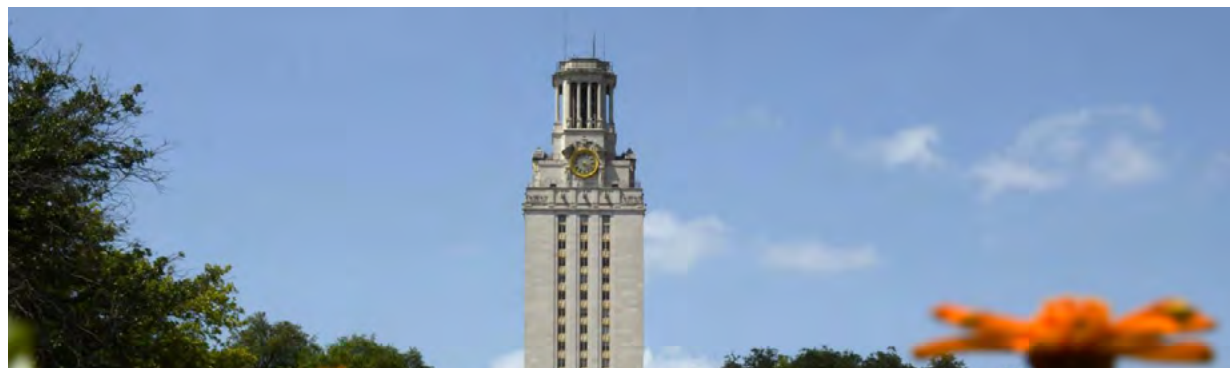

The information contained herein has been obtained from sources deemed reliable. MSC cannot verify it and makes no guarantee, warranty or representation about its accuracy. Any projections, opinions, assumptions or estimates provided by MSC are for discussion purposes only and do not represent the current or future performance of a property, location or market.