

**AVAILABLE FOR LEASE**  
**Two Suites ± 1,400 - ± 1,500 SF AVAILABLE**  
**Lancaster, Pennsylvania**



**Location:** 2160 E. Lincoln Highway (Unit 1-4A and Unit 1-3A), East Lampeter Township, Lancaster, PA 17602

**Zoning:** C-2 Commercial - permitted uses include offices, convenience stores, emergency service facilities, financial institutions, hotels and/or motels, restaurants, retail stores, and more.

**Available Space:** Unit 3: ± 1,500 square feet  
 Unit 4: ± 1,400 square feet

**Fit-Out\*:** Unit 3: Hair salon  
 Unit 4: Currently configured as office space, including four offices, conference room, reception, work area and private restroom.

\*Spaces are contiguous and can be combined

**Construction:** Single-story stone and stucco exterior

**Mechanicals:** HVAC system is a gas-fired furnace with split system heat pump (air conditioning and heat) for each space.

**Parking:** 65 spaces on three sides of the building for convenient access.

<b>Demographics:</b>	<b>2017</b>	<b><u>3 Miles</u></b>	<b><u>5 Miles</u></b>	<b><u>10 Miles</u></b>
Population:		27,044	126,427	302,785
Average HH Income:		\$84,114	\$67,852	\$79,087

**Traffic Counts:** Lincoln Highway East (Route 30): 29,131 vehicles per day, both directions

**Rent:** **\$13 PSF NNN plus electric/ HVAC**

\* Landlord will consider a gross lease plus electric at \$18 PSF.

# FLOOR PLAN

## Unit 1-4A

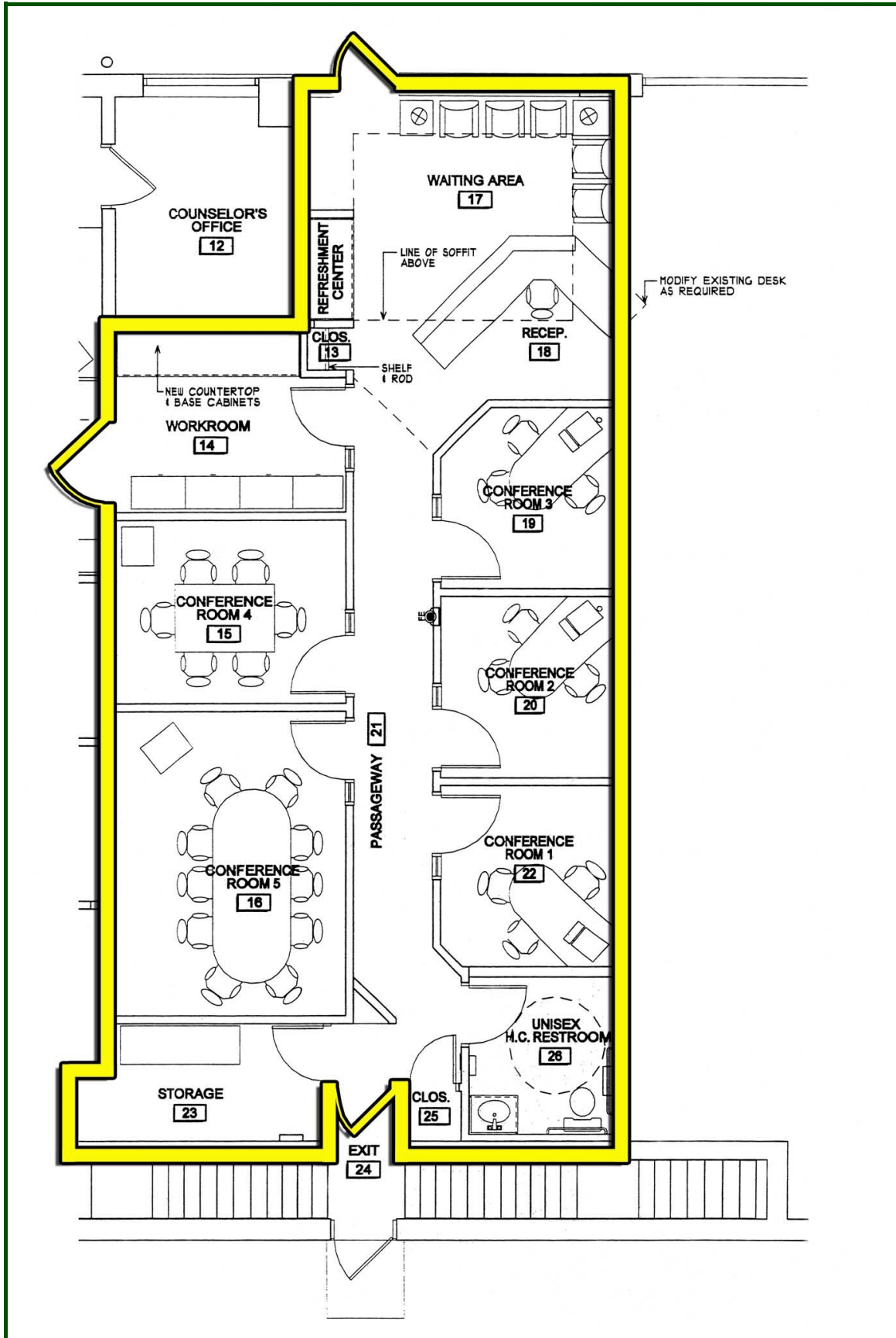

**LOCAL MAP**

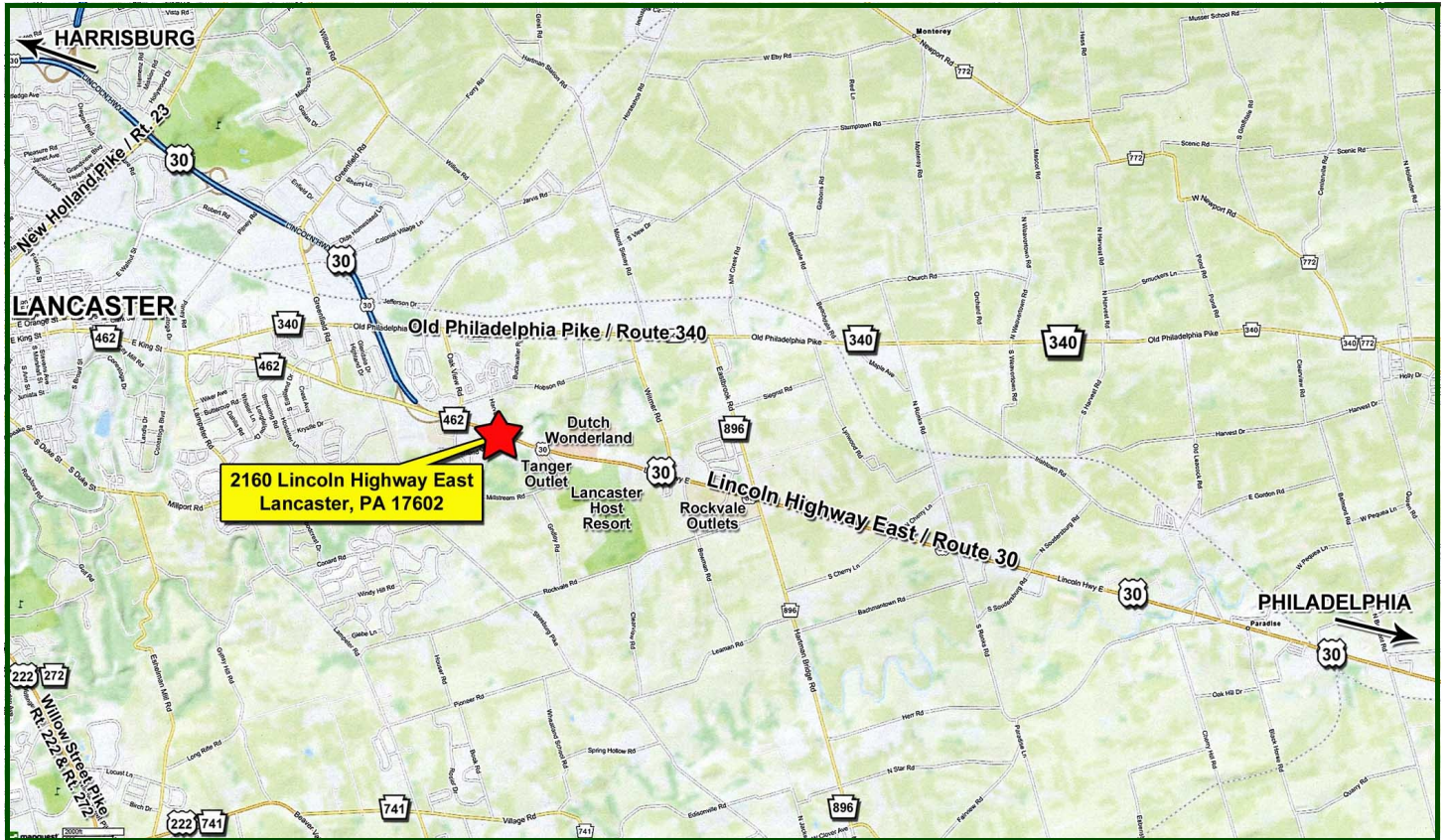

**Michael D. Wagner, CCIM**



**1650 Crooked Oak Drive, Suite 310**

**Lancaster, PA 17601**

**[mike@uscommercialrealty.net](mailto:mike@uscommercialrealty.net)**

**(717) 735-6000 • (717) 735-6001 Fax**

**[www.uscommercialrealty.net](http://www.uscommercialrealty.net)**

Information concerning this offering is from sources deemed reliable, but no warranty is made as to the accuracy thereof and it is submitted subject to errors, omissions, change of price or other conditions, prior sale or lease or withdrawal without notice.