



FOR LEASE



WAREHOUSE



14,570 SF



20885 Currier Rd

City of Industry, California 91789

Property Highlights

- Built in 1999
- 2,369 SF of office space
- 400 amps of power
- Plenty of parking
- 24 ft ceilings (20 ft clearance)
- One ground level loading dock
- One dock high loading dock with interior well
- 2-story office space

SPACES	LEASE RATE	SPACE SIZE
20885 Currier Rd.	\$1.08 SF/month	14,570 SF

Tina LaMonica

Executive Vice President | 626.204.1523
tlamonica@naicapital.com | CalDRE #01841057





FOR LEASE



WAREHOUSE



14,570 SF

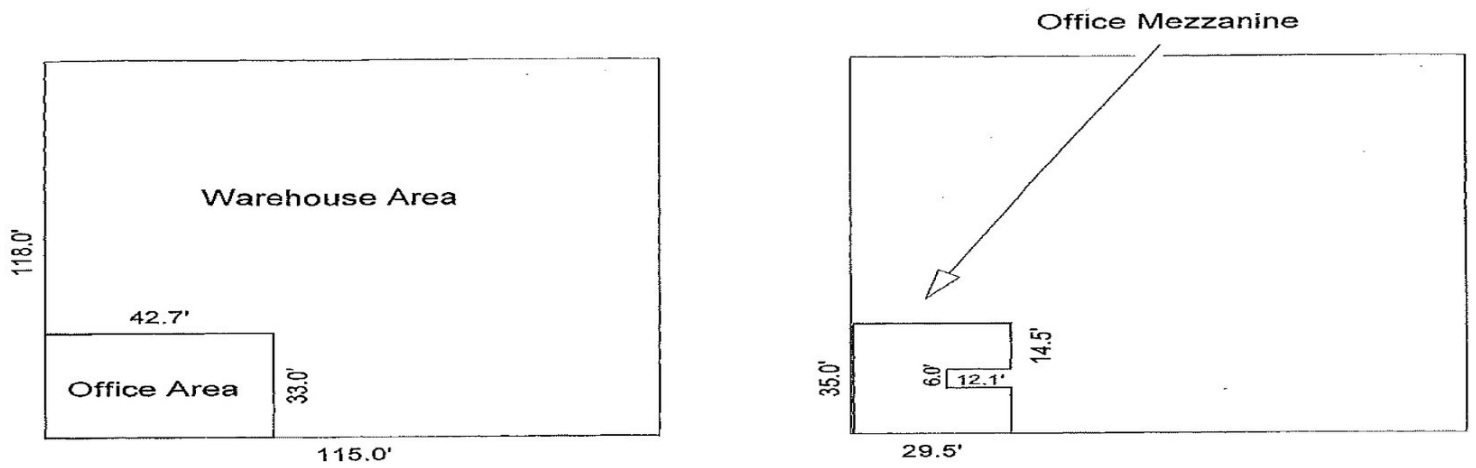

Scale: 1 = 40



www.naicapital.com

Tina LaMonica

Executive Vice President | 626.204.1523

tlamonica@naicapital.com | CalDRE #01841057

NO WARRANTY, EXPRESS OR IMPLIED, IS MADE AS TO THE ACCURACY OF THE INFORMATION CONTAINED HEREIN. THIS INFORMATION IS SUBMITTED SUBJECT TO ERRORS, OMISSIONS, CHANGE OF PRICE, RENTAL OR OTHER CONDITIONS, WITHDRAWAL WITHOUT NOTICE, AND IS SUBJECT TO ANY SPECIAL LISTING CONDITIONS IMPOSED BY OUR PRINCIPALS, COOPERATING BROKERS, BUYERS, TENANTS AND OTHER PARTIES WHO RECEIVE THIS DOCUMENT SHOULD NOT RELY ON IT, BUT SHOULD USE IT AS A STARTING POINT OF ANALYSIS, AND SHOULD INDEPENDENTLY CONFIRM THE ACCURACY OF THE INFORMATION CONTAINED HEREIN THROUGH A DUE DILIGENCE REVIEW OF THE BOOKS, RECORDS, FILES AND DOCUMENTS THAT CONSTITUTE RELIABLE SOURCES OF THE INFORMATION DESCRIBED HEREIN. LOGOS ARE FOR IDENTIFICATION PURPOSES ONLY AND MAY BE TRADEMARKS OF THEIR RESPECTIVE COMPANIES. NAI CAPITAL, INC. CAL DRE LIC. #02130474