



18500 Via Princessa

Santa Clarita, California 91387

Lease Highlights

- Part of a highly visible mixed-use retail/medical center
- Across from Costco & 24 Hour Fitness, adjacent to I-14 freeway on-ramp
- Surrounded by thousands of newly developed homes with limited commercial services
- Building signage available

Property Description

Building C - Unit 2B | Medical clinic space with 7 exam rooms, X-Ray area, restroom, and business office

Building A - Suite 205 | Small 2nd floor office suite with private office, open area, and private restroom

Available Spaces

Spaces	Lease Rate	Size (SF)
Building C - Unit 2B	\$2.25 SF/month	2,675
Building A - Suite 205	\$2.25 SF/month	638

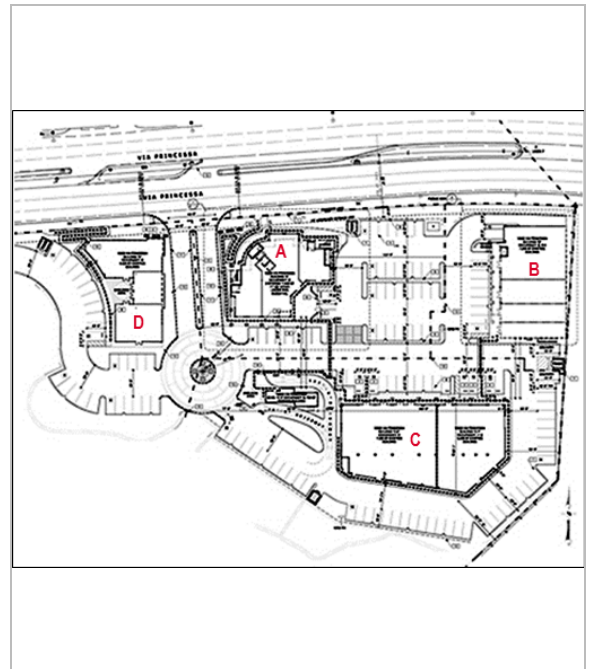

For more information

Scott Crane

O: 310.440.8500

scrane@naicapital.com | CalDRE #00973713

Peter Lund

O: 310.440.8500

plund@naicapital.com | CalDRE #01052090

No warranty, express or implied, is made as to the accuracy of the information contained herein. This information is submitted subject to errors, omissions, change of price, rental or other conditions, withdrawal without notice, and is subject to any special listing conditions imposed by our principals. Cooperating brokers, buyers, tenants and other parties who receive this document should not rely on it, but should use it as a starting point of analysis, and should independently confirm the accuracy of the information contained herein through a due diligence review of the books, records, files and documents that constitute reliable sources of the information described herein. Logos are for identification purposes only and may be trademarks of their respective companies. NAI Capital, Inc. CAL DRE Lic. #02130474

NAI Capital

11835 W. Olympic Blvd. Ste. 700E

Los Angeles, CA 90064

310.440.8500

naicapital.com

For Lease

18500 Via Princessa

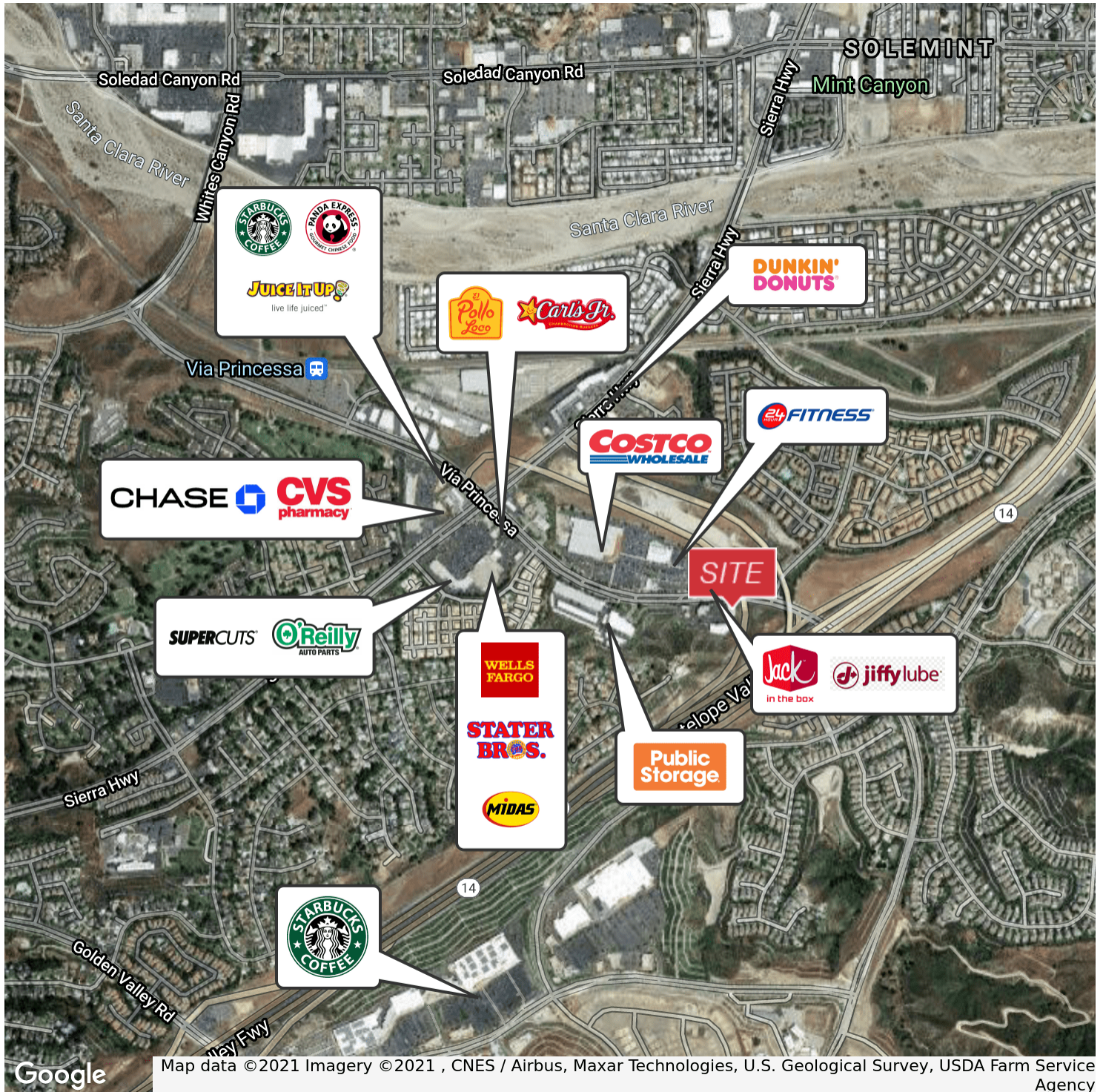

Scott Crane
310.440.8500
scrane@naicapital.com
CalDRE #00973713

Peter Lund
310.440.8500
plund@naicapital.com
CalDRE #01052090

NAI Capital
COMMERCIAL REAL ESTATE SERVICES, WORLDWIDE

For Lease

18500 Via Princessa

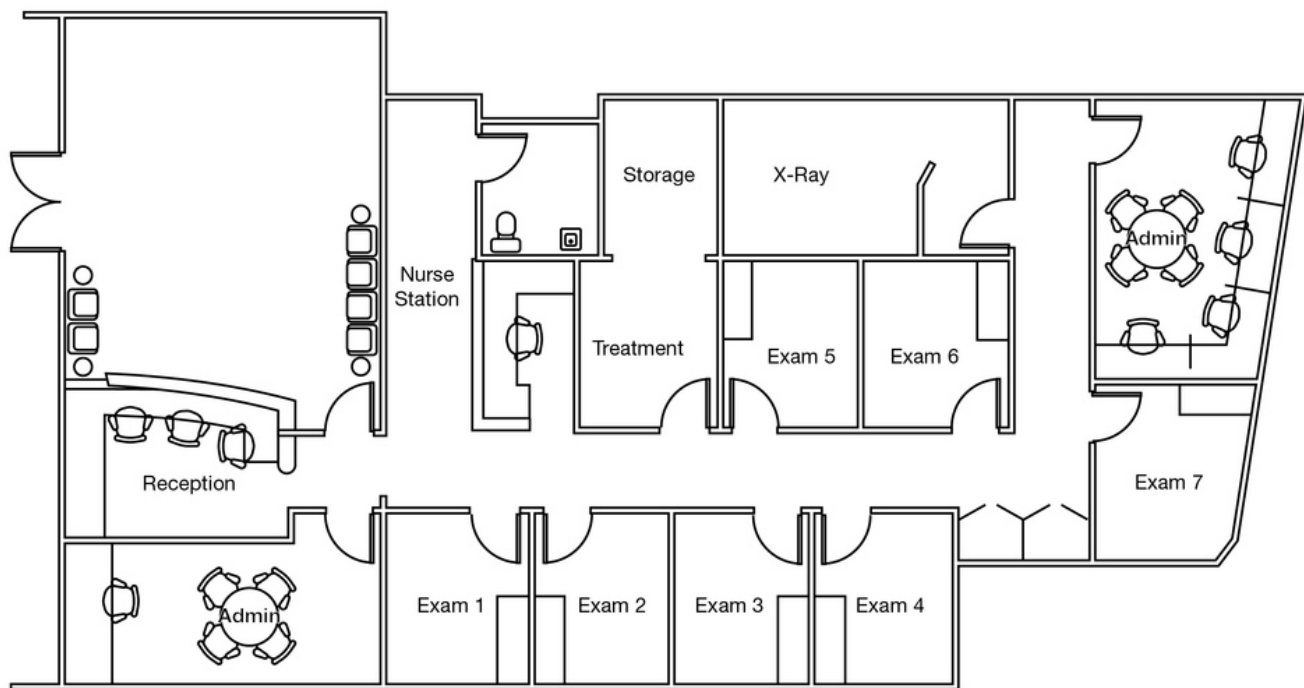

Building C - Unit 2B | Built-out medical space consisting of 7 exam rooms and X-ray area.

Scott Crane

310.440.8500
scrane@naicapital.com
CalDRE #00973713

Peter Lund

310.440.8500
plund@naicapital.com
CalDRE #01052090

NAICapital
COMMERCIAL REAL ESTATE SERVICES, WORLDWIDE