

# 5181 W Adams Blvd.

Los Angeles, California 90016

## Property Features

- Estimated delivery Q2 2022
- Great mixed use project!
- 115 units over retail/medical
- Ground breaking Adams Blvd project
- Located just West of the intersection of Adams and La Brea
- The facility will be ideally located near West LA Kaiser Hospital, Olympia Hospital, and Cedars Sinai Medical Center.
- Well served by public transit
- Traffic count: 23,680 cars per day

Space	Lease Rate	Size (SF)
5181 W Adams Blvd	\$2.50 SF/MONTH (NNN)	12,800 SF (DIVISIBLE)
5181 W Adams Blvd	\$2.75 SF/MONTH (NNN)	3,900 SF



NO WARRANTY, EXPRESS OR IMPLIED, IS MADE AS TO THE ACCURACY OF THE INFORMATION CONTAINED HEREIN. THIS INFORMATION IS SUBMITTED SUBJECT TO ERRORS, OMISSIONS, CHANGE OF PRICE, RENTAL OR OTHER CONDITIONS, WITHDRAWAL WITHOUT NOTICE, AND IS SUBJECT TO ANY SPECIAL LISTING CONDITIONS IMPOSED BY OUR PRINCIPALS. COOPERATING BROKERS, BUYERS, TENANTS AND OTHER PARTIES WHO RECEIVE THIS DOCUMENT SHOULD NOT RELY ON IT, BUT SHOULD USE IT AS A STARTING POINT OF ANALYSIS, AND SHOULD INDEPENDENTLY CONFIRM THE ACCURACY OF THE INFORMATION CONTAINED HEREIN THROUGH A DUE DILIGENCE REVIEW OF THE BOOKS, RECORDS, FILES AND DOCUMENTS THAT CONSTITUTE RELIABLE SOURCES OF THE INFORMATION DESCRIBED HEREIN. LOGOS ARE FOR IDENTIFICATION PURPOSES ONLY AND MAY BE TRADEMARKS OF THEIR RESPECTIVE COMPANIES. NAI CAPITAL, INC. CAL DRE LIC. #02130474

**Sam Kangavari**  
310.806.6135  
skangavari@naicapital.com  
CalDRE #01846336

**Peter Lund**  
310.440.8500  
plund@naicapital.com  
CalDRE #01052090

**Scott Crane**  
310.440.8500  
scrane@naicapital.com  
CalDRE #00973713

NAI Capital  
11835 W. Olympic Blvd. Ste. 700E  
Los Angeles, CA 90064  
310.440.8500  
[www.naicapital.com](http://www.naicapital.com)



For Lease

**Retail**

**3,900 - 12,800 SF**

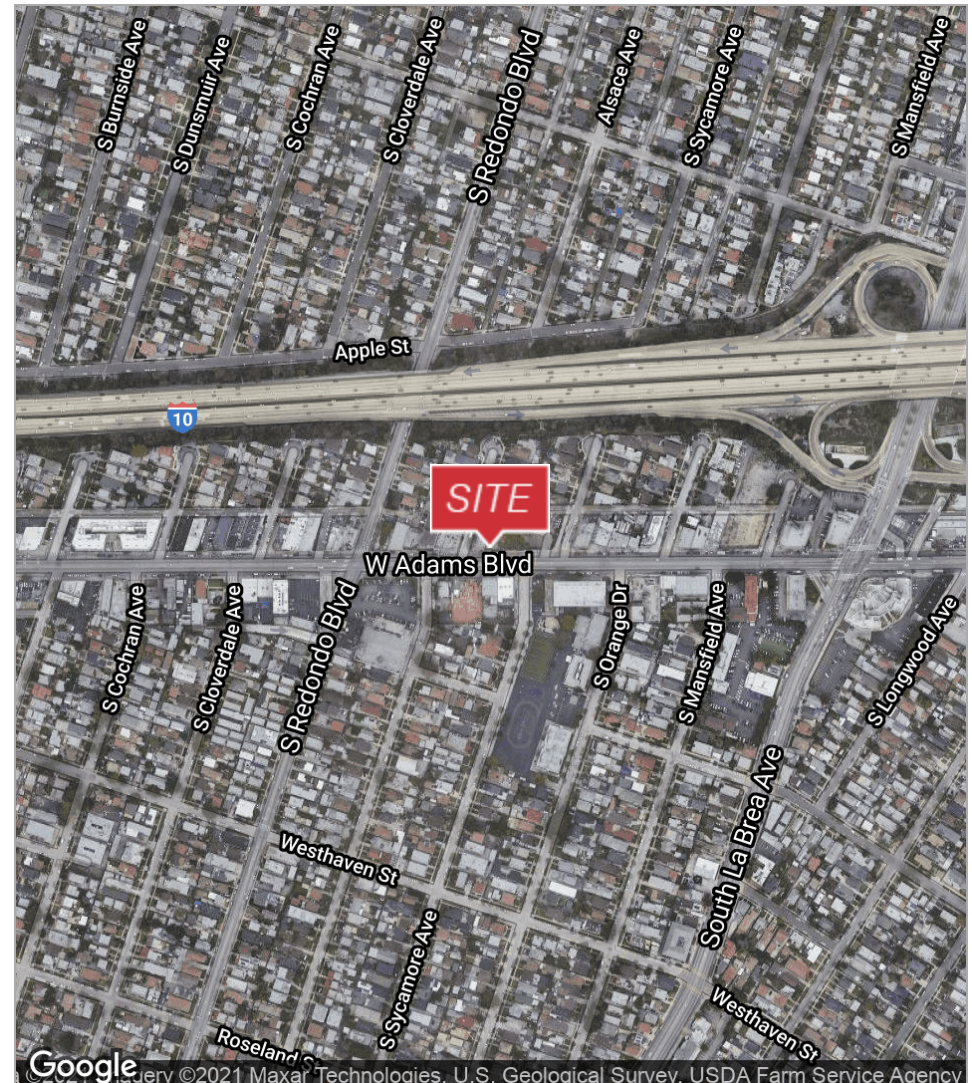
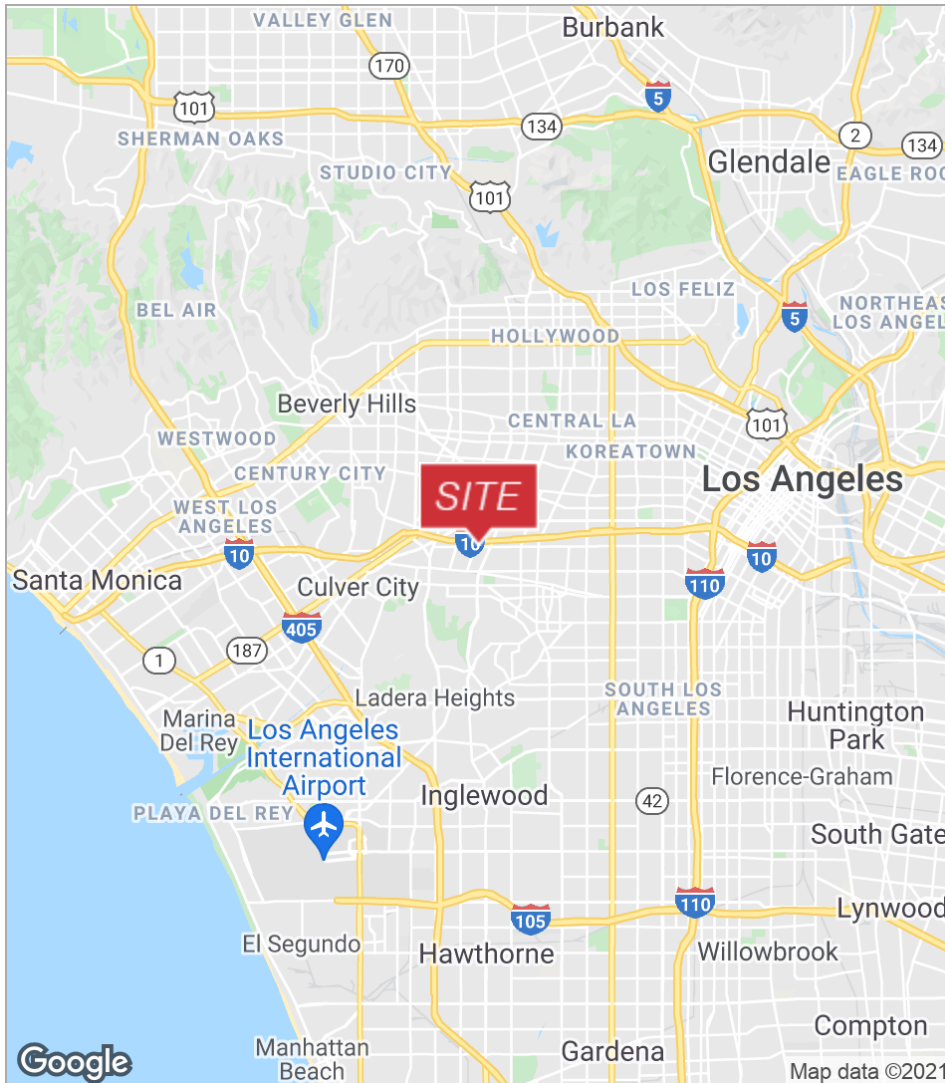

NO WARRANTY, EXPRESS OR IMPLIED, IS MADE AS TO THE ACCURACY OF THE INFORMATION CONTAINED HEREIN. THIS INFORMATION IS SUBMITTED SUBJECT TO ERRORS, OMISSIONS, CHANGE OF PRICE, RENTAL OR OTHER CONDITIONS, WITHDRAWAL WITHOUT NOTICE, AND IS SUBJECT TO ANY SPECIAL LISTING CONDITIONS IMPOSED BY OUR PRINCIPALS. COOPERATING BROKERS, BUYERS, TENANTS AND OTHER PARTIES WHO RECEIVE THIS DOCUMENT SHOULD NOT RELY ON IT, BUT SHOULD USE IT AS A STARTING POINT OF ANALYSIS, AND SHOULD INDEPENDENTLY CONFIRM THE ACCURACY OF THE INFORMATION CONTAINED HEREIN THROUGH A DUE DILIGENCE REVIEW OF THE BOOKS, RECORDS, FILES AND DOCUMENTS THAT CONSTITUTE RELIABLE SOURCES OF THE INFORMATION DESCRIBED HEREIN. LOGOS ARE FOR IDENTIFICATION PURPOSES ONLY AND MAY BE TRADEMARKS OF THEIR RESPECTIVE COMPANIES. NAI CAPITAL, INC. CAL DRE LIC. #02130474

**Sam Kangavari**  
310.806.6135  
skangavari@naicapital.com  
CalDRE #01846336

**Peter Lund**  
310.440.8500  
plund@naicapital.com  
CalDRE #01052090

**Scott Crane**  
310.440.8500  
scrane@naicapital.com  
CalDRE #00973713

NAI Capital  
11835 W. Olympic Blvd. Ste. 700E  
Los Angeles, CA 90064  
310.440.8500  
[www.naicapital.com](http://www.naicapital.com)



For Lease

**Retail**

**3,900 - 12,800 SF**



NO WARRANTY, EXPRESS OR IMPLIED, IS MADE AS TO THE ACCURACY OF THE INFORMATION CONTAINED HEREIN. THIS INFORMATION IS SUBMITTED SUBJECT TO ERRORS, OMISSIONS, CHANGE OF PRICE, RENTAL OR OTHER CONDITIONS, WITHDRAWAL WITHOUT NOTICE, AND IS SUBJECT TO ANY SPECIAL LISTING CONDITIONS IMPOSED BY OUR PRINCIPALS. COOPERATING BROKERS, BUYERS, TENANTS AND OTHER PARTIES WHO RECEIVE THIS DOCUMENT SHOULD NOT RELY ON IT, BUT SHOULD USE IT AS A STARTING POINT OF ANALYSIS, AND SHOULD INDEPENDENTLY CONFIRM THE ACCURACY OF THE INFORMATION CONTAINED HEREIN THROUGH A DUE DILIGENCE REVIEW OF THE BOOKS, RECORDS, FILES AND DOCUMENTS THAT CONSTITUTE RELIABLE SOURCES OF THE INFORMATION DESCRIBED HEREIN. LOGOS ARE FOR IDENTIFICATION PURPOSES ONLY AND MAY BE TRADEMARKS OF THEIR RESPECTIVE COMPANIES. NAI CAPITAL, INC. CAL DRE LIC. #02130474

**Sam Kangavari**  
310.806.6135  
skangavari@naicapital.com  
CalDRE #01846336

**Peter Lund**  
310.440.8500  
plund@naicapital.com  
CalDRE #01052090

**Scott Crane**  
310.440.8500  
scrane@naicapital.com  
CalDRE #00973713

NAI Capital  
11835 W. Olympic Blvd. Ste. 700E  
Los Angeles, CA 90064  
310.440.8500  
[www.naicapital.com](http://www.naicapital.com)

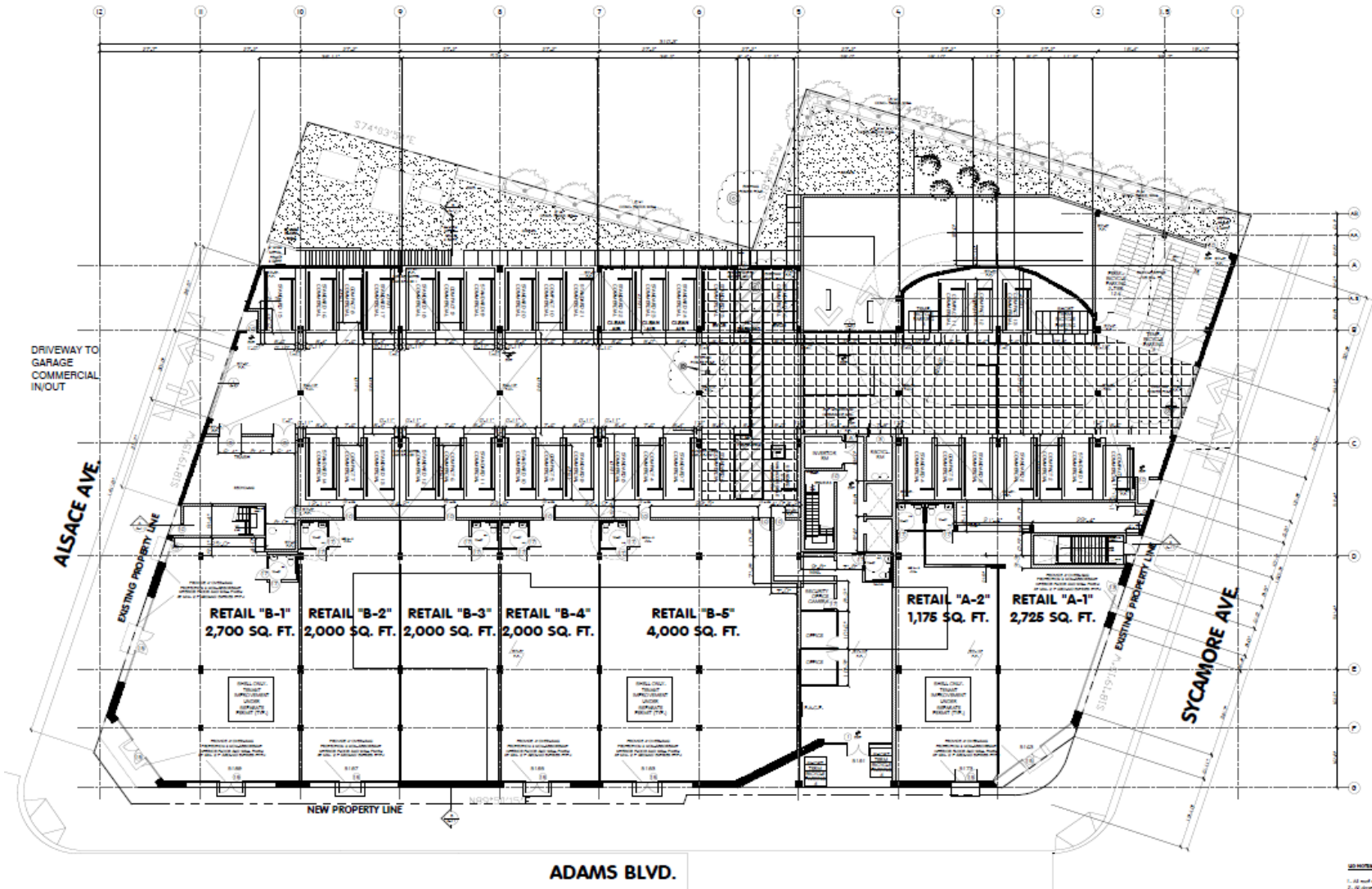

NO WARRANTY, EXPRESS OR IMPLIED, IS MADE AS TO THE ACCURACY OF THE INFORMATION CONTAINED HEREIN. THIS INFORMATION IS SUBMITTED SUBJECT TO ERRORS, OMISSIONS, CHANGE OF PRICE, RENTAL OR OTHER CONDITIONS, WITHDRAWAL WITHOUT NOTICE, AND IS SUBJECT TO ANY SPECIAL LISTING CONDITIONS IMPOSED BY OUR PRINCIPALS. COOPERATING BROKERS, BUYERS, TENANTS AND OTHER PARTIES WHO RECEIVE THIS DOCUMENT SHOULD NOT RELY ON IT, BUT SHOULD USE IT AS A STARTING POINT OF ANALYSIS, AND SHOULD INDEPENDENTLY CONFIRM THE ACCURACY OF THE INFORMATION CONTAINED HEREIN THROUGH A DUE DILIGENCE REVIEW OF THE BOOKS, RECORDS, FILES AND DOCUMENTS THAT CONSTITUTE RELIABLE SOURCES OF THE INFORMATION DESCRIBED HEREIN. LOGOS ARE FOR IDENTIFICATION PURPOSES ONLY AND MAY BE TRADEMARKS OF THEIR RESPECTIVE COMPANIES. NAI CAPITAL, INC. CAL DRE LIC. #02130474

**Sam Kangavari**  
310.806.6135  
skangavari@naicapital.com  
CalDRE #01846336

**Peter Lund**  
310.440.8500  
plund@naicapital.com  
CalDRE #01052090

**Scott Crane**  
310.440.8500  
scrane@naicapital.com  
CalDRE #00973713

NAI Capital  
11835 W. Olympic Blvd. Ste. 700E  
Los Angeles, CA 90064  
310.440.8500  
[www.naicapital.com](http://www.naicapital.com)