



NO WARRANTY, EXPRESS OR IMPLIED, IS MADE AS TO THE ACCURACY OF THE INFORMATION CONTAINED HEREIN. THIS INFORMATION IS SUBMITTED SUBJECT TO ERRORS, OMISSIONS, CHANGE OF PRICE, RENTAL OR OTHER CONDITIONS, WITHDRAWAL WITHOUT NOTICE, AND IS SUBJECT TO ANY SPECIAL LISTING CONDITIONS IMPOSED BY OUR PRINCIPALS. COOPERATING BROKERS, BUYERS, TENANTS AND OTHER PARTIES WHO RECEIVE THIS DOCUMENT SHOULD NOT RELY ON IT, BUT SHOULD USE IT AS A STARTING POINT OF ANALYSIS, AND SHOULD INDEPENDENTLY CONFIRM THE ACCURACY OF THE INFORMATION CONTAINED HEREIN THROUGH A DUE DILIGENCE REVIEW OF THE BOOKS, RECORDS, FILES AND DOCUMENTS THAT CONSTITUTE RELIABLE SOURCES OF THE INFORMATION DESCRIBED HEREIN. LOGOS ARE FOR IDENTIFICATION PURPOSES ONLY AND MAY BE TRADEMARKS OF THEIR RESPECTIVE COMPANIES. NAI CAPITAL, INC. CAL DRE LIC. #01990696.

Jack Dwyer, CCIM
805.277.4014
jdwyer@naicapital.com
CalDRE #00468626

Tom Sexton
650.667.9081
tsexton@naicapital.com
CalDRE #02094807

NAI Capital
2555 Townsgate Road, Suite 320
Westlake Village, CA 91361
805.446.2400

www.naicapital.com

Kanan Village

5019-5021 Kanan Road, Agoura Hills, California 91301

Property Features

- Prime Location High Volume Shopping Center
- Ventura FWY offramp to City of Agoura Hills
- High income / Low Crime / Ample Parking
- Rent Only \$2.50 psf NNN per Mo. with Low CAM Fee \$0.68
- Join Jack in the Box, IHop, Chevron, and Islands Restaurant
- High Ceilings with 11 ft to 12 ft ceiling heights
- Contemporary Architecture - Well Maintained
- Both Monument and Fascia Signage
- 5021 Kanan Expandable to 3,300 SF by adding adjacent 1,500 sf 5019 Kanan



Population	1 Mile	5 Miles	10 Miles
TOTAL POPULATION	6,049	74,393	353,845
MEDIAN AGE	42.2	42.0	40.8
MEDIAN AGE (MALE)	40.2	40.9	39.9
MEDIAN AGE (FEMALE)	43.9	43.2	41.5

Households & Income	1 Mile	5 Miles	10 Miles
TOTAL HOUSEHOLDS	2,246	27,702	124,290
# OF PERSONS PER HH	2.7	2.7	2.8
AVERAGE HH INCOME	\$145,362	\$155,973	\$134,836
AVERAGE HOUSE VALUE	\$733,322	\$827,583	\$707,177

Race	1 Mile	5 Miles	10 Miles
% WHITE	80.7%	84.9%	81.1%
% BLACK	1.4%	1.4%	1.4%
% ASIAN	8.2%	8.1%	7.9%
% HAWAIIAN	0.0%	0.0%	0.1%
% INDIAN	0.2%	0.2%	0.4%
% OTHER	3.0%	2.1%	6.0%

Ethnicity	1 Mile	5 Miles	10 Miles
% HISPANIC	10.5%	7.3%	14.9%

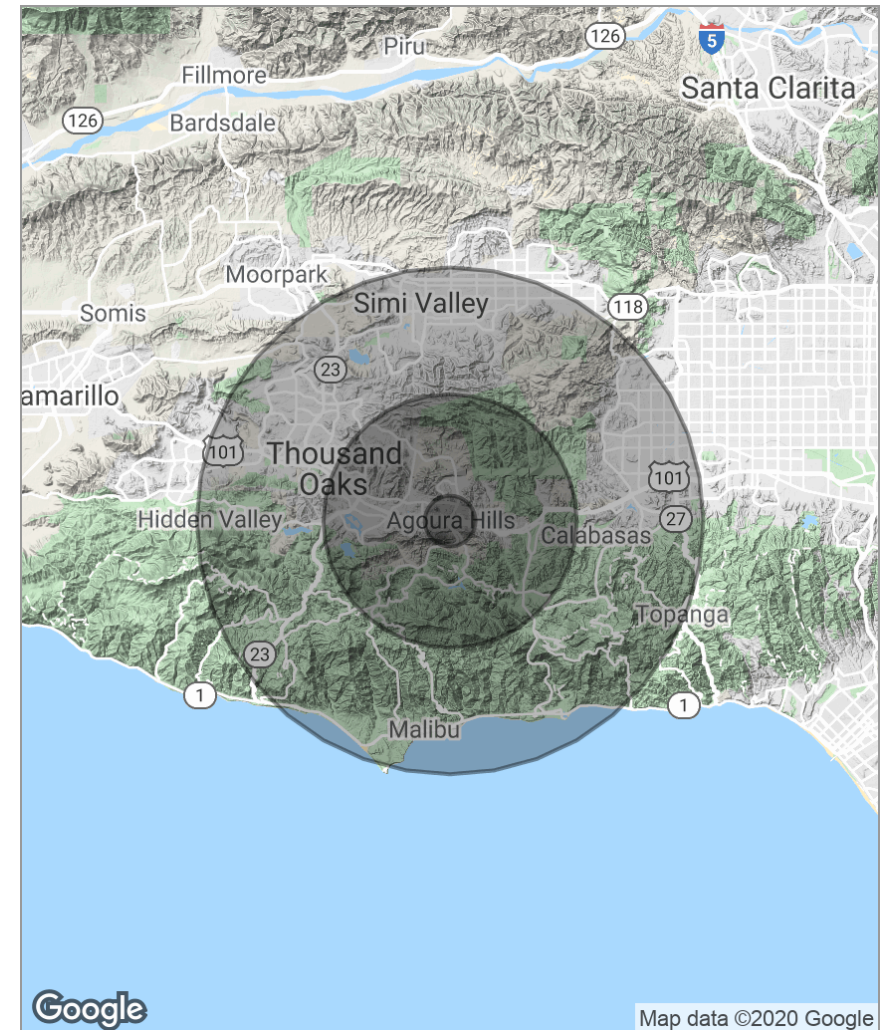

For Lease

Retail

1,500 - 3,300 SF

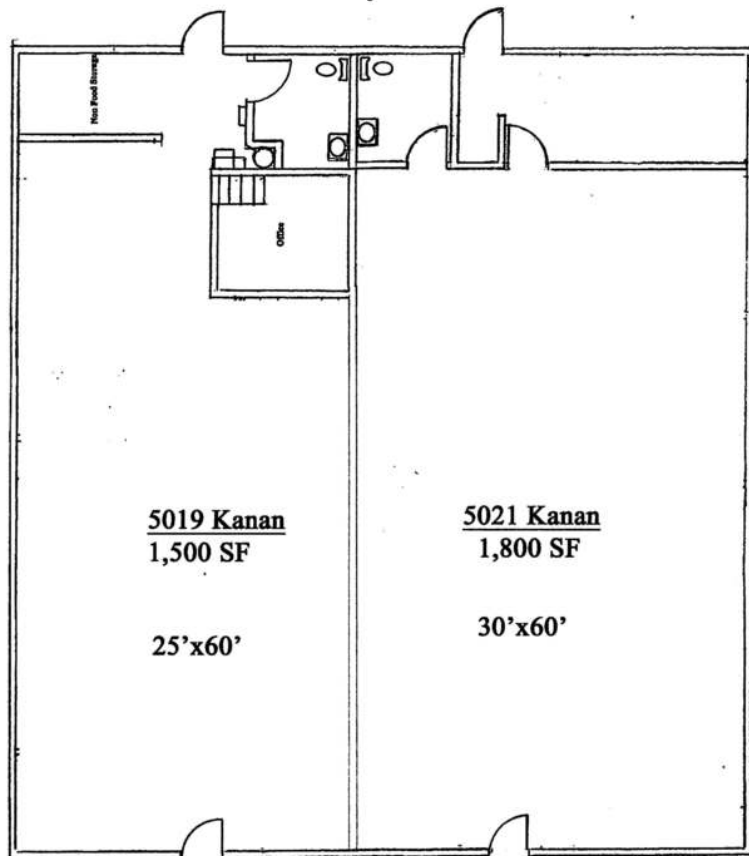

NO WARRANTY, EXPRESS OR IMPLIED, IS MADE AS TO THE ACCURACY OF THE INFORMATION CONTAINED HEREIN. THIS INFORMATION IS SUBMITTED SUBJECT TO ERRORS, OMISSIONS, CHANGE OF PRICE, RENTAL OR OTHER CONDITIONS, WITHDRAWAL WITHOUT NOTICE, AND IS SUBJECT TO ANY SPECIAL LISTING CONDITIONS IMPOSED BY OUR PRINCIPALS. COOPERATING BROKERS, BUYERS, TENANTS AND OTHER PARTIES WHO RECEIVE THIS DOCUMENT SHOULD NOT RELY ON IT, BUT SHOULD USE IT AS A STARTING POINT OF ANALYSIS, AND SHOULD INDEPENDENTLY CONFIRM THE ACCURACY OF THE INFORMATION CONTAINED HEREIN THROUGH A DUE DILIGENCE REVIEW OF THE BOOKS, RECORDS, FILES AND DOCUMENTS THAT CONSTITUTE RELIABLE SOURCES OF THE INFORMATION DESCRIBED HEREIN. LOGOS ARE FOR IDENTIFICATION PURPOSES ONLY AND MAY BE TRADEMARKS OF THEIR RESPECTIVE COMPANIES. NAI CAPITAL, INC. CAL DRE LIC. #01990696.

Jack Dwyer, CCIM
 805.277.4014
 jdwyer@naicapital.com
 CalDRE #00468626

Tom Sexton
 650.667.9081
 tsexton@naicapital.com
 CalDRE #02094807

NAI Capital
 2555 Townsgate Road, Suite 320
 Westlake Village, CA 91361
 805.446.2400
www.naicapital.com

**KANAN VILLAGE
 TENANTS**



**NEIGHBORING
 TENANTS**



For Lease

Retail

1,500 - 3,300 SF

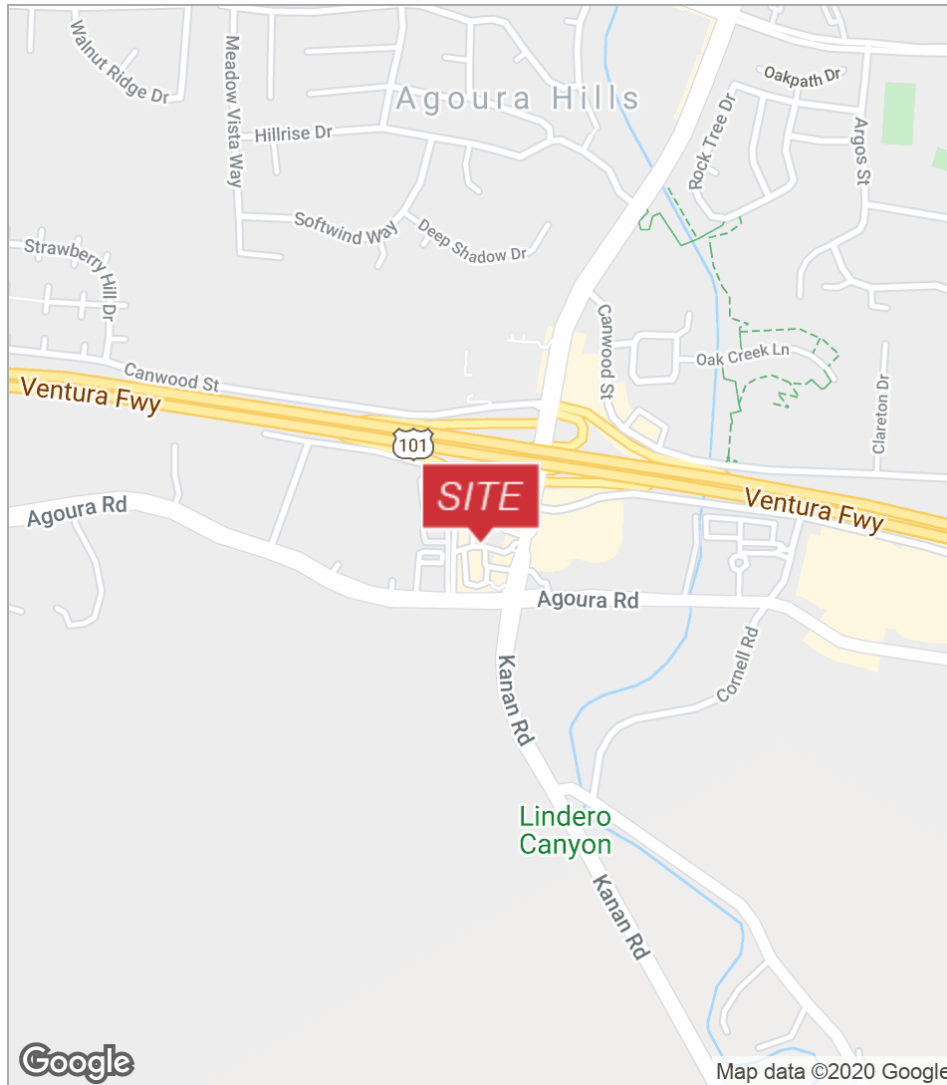

NO WARRANTY, EXPRESS OR IMPLIED, IS MADE AS TO THE ACCURACY OF THE INFORMATION CONTAINED HEREIN. THIS INFORMATION IS SUBMITTED SUBJECT TO ERRORS, OMISSIONS, CHANGE OF PRICE, RENTAL OR OTHER CONDITIONS, WITHDRAWAL WITHOUT NOTICE, AND IS SUBJECT TO ANY SPECIAL LISTING CONDITIONS IMPOSED BY OUR PRINCIPALS. COOPERATING BROKERS, BUYERS, TENANTS AND OTHER PARTIES WHO RECEIVE THIS DOCUMENT SHOULD NOT RELY ON IT, BUT SHOULD USE IT AS A STARTING POINT OF ANALYSIS, AND SHOULD INDEPENDENTLY CONFIRM THE ACCURACY OF THE INFORMATION CONTAINED HEREIN THROUGH A DUE DILIGENCE REVIEW OF THE BOOKS, RECORDS, FILES AND DOCUMENTS THAT CONSTITUTE RELIABLE SOURCES OF THE INFORMATION DESCRIBED HEREIN. LOGOS ARE FOR IDENTIFICATION PURPOSES ONLY AND MAY BE TRADEMARKS OF THEIR RESPECTIVE COMPANIES. NAI CAPITAL, INC. CAL DRE LIC. #01990696.

Jack Dwyer, CCIM
 805.277.4014
 jdwyer@naicapital.com
 CalDRE #00468626

Tom Sexton
 650.667.9081
 tsexton@naicapital.com
 CalDRE #02094807

NAI Capital
 2555 Townsgate Road, Suite 320
 Westlake Village, CA 91361
 805.446.2400
www.naicapital.com



Google

Map data ©2020 Google Imagery ©2020, City of Thousand Oaks, Maxar Technologies, U.S. Geological Survey, USDA Farm Service Agency

NO WARRANTY, EXPRESS OR IMPLIED, IS MADE AS TO THE ACCURACY OF THE INFORMATION CONTAINED HEREIN. THIS INFORMATION IS SUBMITTED SUBJECT TO ERRORS, OMISSIONS, CHANGE OF PRICE, RENTAL OR OTHER CONDITIONS, WITHDRAWAL WITHOUT NOTICE, AND IS SUBJECT TO ANY SPECIAL LISTING CONDITIONS IMPOSED BY OUR PRINCIPALS. COOPERATING BROKERS, BUYERS, TENANTS AND OTHER PARTIES WHO RECEIVE THIS DOCUMENT SHOULD NOT RELY ON IT, BUT SHOULD USE IT AS A STARTING POINT OF ANALYSIS, AND SHOULD INDEPENDENTLY CONFIRM THE ACCURACY OF THE INFORMATION CONTAINED HEREIN THROUGH A DUE DILIGENCE REVIEW OF THE BOOKS, RECORDS, FILES AND DOCUMENTS THAT CONSTITUTE RELIABLE SOURCES OF THE INFORMATION DESCRIBED HEREIN. LOGOS ARE FOR IDENTIFICATION PURPOSES ONLY AND MAY BE TRADEMARKS OF THEIR RESPECTIVE COMPANIES. NAI CAPITAL, INC. CAL DRE LIC. #01990696.

Jack Dwyer, CCIM
 805.277.4014
 jdwyer@naicapital.com
 CalDRE #00468626

Tom Sexton
 650.667.9081
 tsexton@naicapital.com
 CalDRE #02094807

NAI Capital
 2555 Townsgate Road, Suite 320
 Westlake Village, CA 91361
 805.446.2400

www.naicapital.com