

## 13074-13076 Saticoy Street

North Hollywood, California 91605

### Property Features

- 13,947 SF (FULLY AIR CONDITIONED BUILDING)
- Gated Business Park Environment
- 14'+ Interior Ceiling Height
- (2) Ground Level Loading 14' x 14' Loading Doors
- +/-300 SF of Office Space
- Heart of North Hollywood Location
- 10 Parking Stalls
- 600 Amps of 120/240 Volt; 3 Phase Power
- LEASE RATE: \$1.15 / SF Industrial Gross + \$0.10 / SF additional monthly Common Area Maintenance Charge



## Property Overview

- FULLY AIR CONDITIONED BUILDING
- Gated Business Park Environment
- 14'+ Interior Ceiling Height Clearance
- (2) Ground Level Loading Doors each measuring 14' x 14'
- +/-300 SF of Office Space
- Heart of North Hollywood Location
- 10 Parking Stalls
- 600 Amps of 120/240 Volt; 3 Phase Power
- Lease Rate: \$1.15 / SF Industrial Gross + \$0.10 / SF additional monthly CAM's

## Location Overview

Located in the heart of North Hollywood, California, near the intersection of Saticoy Street and Coldwater Canyon. The property offers immediate access to the Hollywood 170 Freeway, with connections to Interstate 5 and the 101 Freeway. The property is proximate to the Burbank Airport and the major entertainment studios located in Burbank.





NO WARRANTY, EXPRESS OR IMPLIED, IS MADE AS TO THE ACCURACY OF THE INFORMATION CONTAINED HEREIN. THIS INFORMATION IS SUBMITTED SUBJECT TO ERRORS, OMISSIONS, CHANGE OF PRICE, RENTAL OR OTHER CONDITIONS, WITHDRAWAL WITHOUT NOTICE, AND IS SUBJECT TO ANY SPECIAL LISTING CONDITIONS IMPOSED BY OUR PRINCIPALS. COOPERATING BROKERS, BUYERS, TENANTS AND OTHER PARTIES WHO RECEIVE THIS DOCUMENT SHOULD NOT RELY ON IT, BUT SHOULD USE IT AS A STARTING POINT OF ANALYSIS, AND SHOULD INDEPENDENTLY CONFIRM THE ACCURACY OF THE INFORMATION CONTAINED HEREIN THROUGH A DUE DILIGENCE REVIEW OF THE BOOKS, RECORDS, FILES AND DOCUMENTS THAT CONSTITUTE RELIABLE SOURCES OF THE INFORMATION DESCRIBED HEREIN. LOGOS ARE FOR IDENTIFICATION PURPOSES ONLY AND MAY BE TRADEMARKS OF THEIR RESPECTIVE COMPANIES. NAI CAPITAL, INC. CAL DRE LIC. #02130474

**Chad Gahr**  
818.742.1626  
cgahr@naicapital.com  
CalDRE #01230414

**David Young**  
818.742.1651  
dyoung@naicapital.com  
CalDRE #00914504

NAI Capital  
15821 Ventura Blvd.  
Encino, CA 91436  
818.905.2400  
[www.naicapital.com](http://www.naicapital.com)



NO WARRANTY, EXPRESS OR IMPLIED, IS MADE AS TO THE ACCURACY OF THE INFORMATION CONTAINED HEREIN. THIS INFORMATION IS SUBMITTED SUBJECT TO ERRORS, OMISSIONS, CHANGE OF PRICE, RENTAL OR OTHER CONDITIONS, WITHDRAWAL WITHOUT NOTICE, AND IS SUBJECT TO ANY SPECIAL LISTING CONDITIONS IMPOSED BY OUR PRINCIPALS. COOPERATING BROKERS, BUYERS, TENANTS AND OTHER PARTIES WHO RECEIVE THIS DOCUMENT SHOULD NOT RELY ON IT, BUT SHOULD USE IT AS A STARTING POINT OF ANALYSIS, AND SHOULD INDEPENDENTLY CONFIRM THE ACCURACY OF THE INFORMATION CONTAINED HEREIN THROUGH A DUE DILIGENCE REVIEW OF THE BOOKS, RECORDS, FILES AND DOCUMENTS THAT CONSTITUTE RELIABLE SOURCES OF THE INFORMATION DESCRIBED HEREIN. LOGOS ARE FOR IDENTIFICATION PURPOSES ONLY AND MAY BE TRADEMARKS OF THEIR RESPECTIVE COMPANIES. NAI CAPITAL, INC. CAL DRE LIC. #02130474

**Chad Gahr**  
818.742.1626  
cgahr@naicapital.com  
CalDRE #01230414

**David Young**  
818.742.1651  
dyoung@naicapital.com  
CalDRE #00914504

NAI Capital  
15821 Ventura Blvd.  
Encino, CA 91436  
818.905.2400  
[www.naicapital.com](http://www.naicapital.com)



NO WARRANTY, EXPRESS OR IMPLIED, IS MADE AS TO THE ACCURACY OF THE INFORMATION CONTAINED HEREIN. THIS INFORMATION IS SUBMITTED SUBJECT TO ERRORS, OMISSIONS, CHANGE OF PRICE, RENTAL OR OTHER CONDITIONS, WITHDRAWAL WITHOUT NOTICE, AND IS SUBJECT TO ANY SPECIAL LISTING CONDITIONS IMPOSED BY OUR PRINCIPALS. COOPERATING BROKERS, BUYERS, TENANTS AND OTHER PARTIES WHO RECEIVE THIS DOCUMENT SHOULD NOT RELY ON IT, BUT SHOULD USE IT AS A STARTING POINT OF ANALYSIS, AND SHOULD INDEPENDENTLY CONFIRM THE ACCURACY OF THE INFORMATION CONTAINED HEREIN THROUGH A DUE DILIGENCE REVIEW OF THE BOOKS, RECORDS, FILES AND DOCUMENTS THAT CONSTITUTE RELIABLE SOURCES OF THE INFORMATION DESCRIBED HEREIN. LOGOS ARE FOR IDENTIFICATION PURPOSES ONLY AND MAY BE TRADEMARKS OF THEIR RESPECTIVE COMPANIES. NAI CAPITAL, INC. CAL DRE LIC. #02130474

**Chad Gahr**  
818.742.1626  
cgahr@naicapital.com  
CalDRE #01230414

**David Young**  
818.742.1651  
dyoung@naicapital.com  
CalDRE #00914504

NAI Capital  
15821 Ventura Blvd.  
Encino, CA 91436  
818.905.2400  
[www.naicapital.com](http://www.naicapital.com)



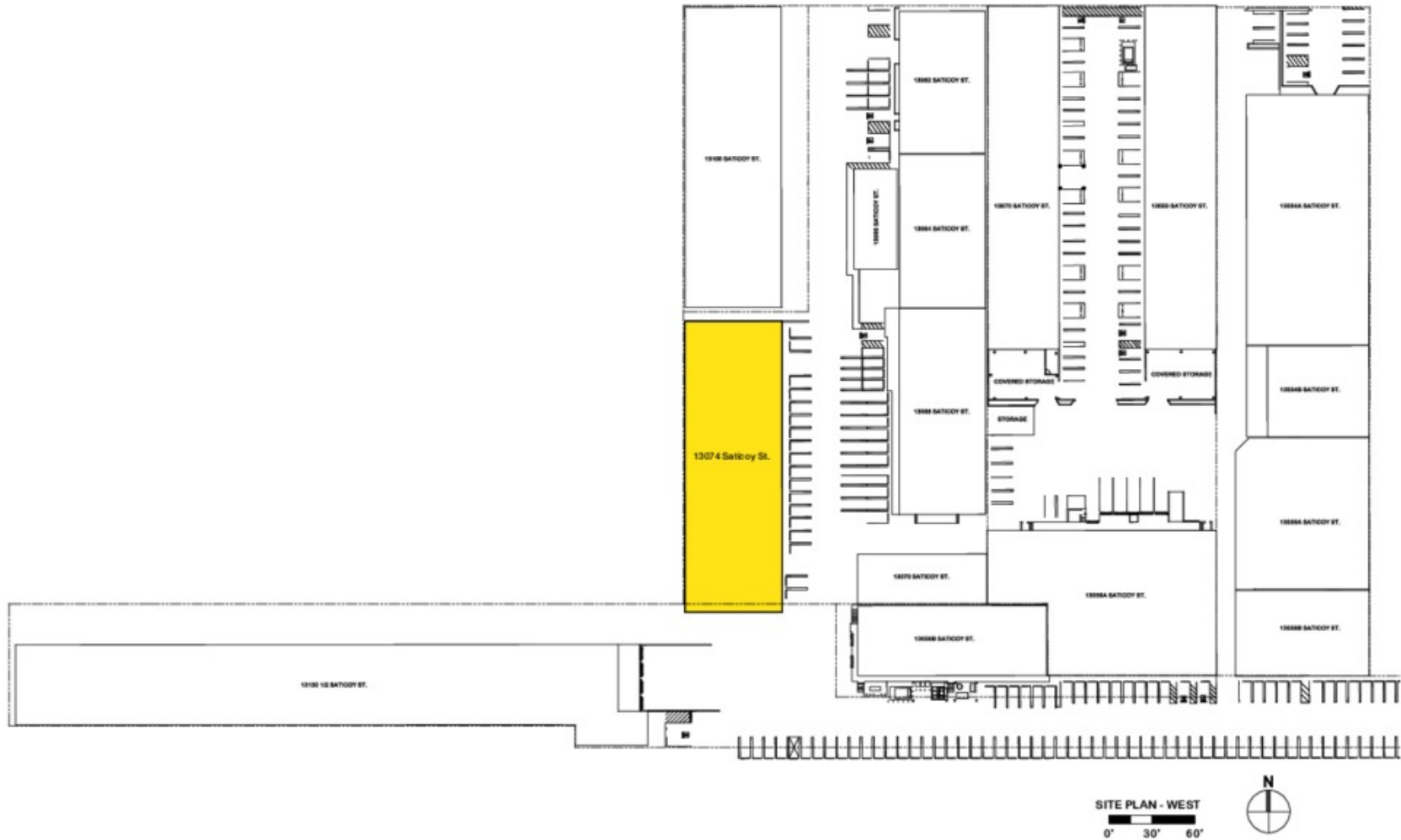

NO WARRANTY, EXPRESS OR IMPLIED, IS MADE AS TO THE ACCURACY OF THE INFORMATION CONTAINED HEREIN. THIS INFORMATION IS SUBMITTED SUBJECT TO ERRORS, OMISSIONS, CHANGE OF PRICE, RENTAL OR OTHER CONDITIONS, WITHDRAWAL WITHOUT NOTICE, AND IS SUBJECT TO ANY SPECIAL LISTING CONDITIONS IMPOSED BY OUR PRINCIPALS. COOPERATING BROKERS, BUYERS, TENANTS AND OTHER PARTIES WHO RECEIVE THIS DOCUMENT SHOULD NOT RELY ON IT, BUT SHOULD USE IT AS A STARTING POINT OF ANALYSIS, AND SHOULD INDEPENDENTLY CONFIRM THE ACCURACY OF THE INFORMATION CONTAINED HEREIN THROUGH A DUE DILIGENCE REVIEW OF THE BOOKS, RECORDS, FILES AND DOCUMENTS THAT CONSTITUTE RELIABLE SOURCES OF THE INFORMATION DESCRIBED HEREIN. LOGOS ARE FOR IDENTIFICATION PURPOSES ONLY AND MAY BE TRADEMARKS OF THEIR RESPECTIVE COMPANIES. NAI CAPITAL, INC. CAL DRE LIC. #02130474

**Chad Gahr**  
 818.742.1626  
 cgahr@naicapital.com  
 CalDRE #01230414

**David Young**  
 818.742.1651  
 dyoung@naicapital.com  
 CalDRE #00914504

NAI Capital  
 15821 Ventura Blvd.  
 Encino, CA 91436  
 818.905.2400  
[www.naicapital.com](http://www.naicapital.com)

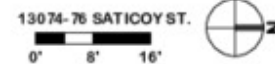
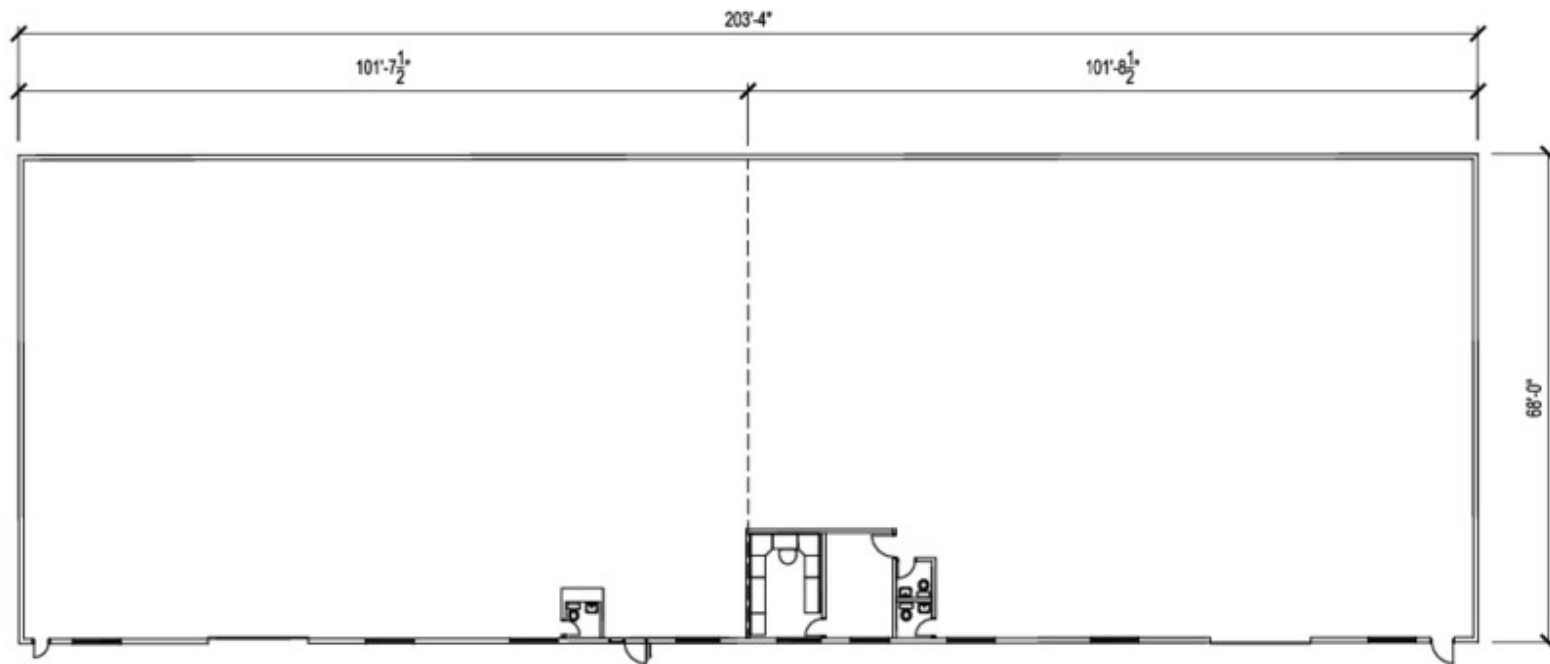

NO WARRANTY, EXPRESS OR IMPLIED, IS MADE AS TO THE ACCURACY OF THE INFORMATION CONTAINED HEREIN. THIS INFORMATION IS SUBMITTED SUBJECT TO ERRORS, OMISSIONS, CHANGE OF PRICE, RENTAL OR OTHER CONDITIONS, WITHDRAWAL WITHOUT NOTICE, AND IS SUBJECT TO ANY SPECIAL LISTING CONDITIONS IMPOSED BY OUR PRINCIPALS. COOPERATING BROKERS, BUYERS, TENANTS AND OTHER PARTIES WHO RECEIVE THIS DOCUMENT SHOULD NOT RELY ON IT, BUT SHOULD USE IT AS A STARTING POINT OF ANALYSIS, AND SHOULD INDEPENDENTLY CONFIRM THE ACCURACY OF THE INFORMATION CONTAINED HEREIN THROUGH A DUE DILIGENCE REVIEW OF THE BOOKS, RECORDS, FILES AND DOCUMENTS THAT CONSTITUTE RELIABLE SOURCES OF THE INFORMATION DESCRIBED HEREIN. LOGOS ARE FOR IDENTIFICATION PURPOSES ONLY AND MAY BE TRADEMARKS OF THEIR RESPECTIVE COMPANIES. NAI CAPITAL, INC. CAL DRE LIC. #02130474

**Chad Gahr**  
818.742.1626  
cgahr@naicapital.com  
CalDRE #01230414

**David Young**  
818.742.1651  
dyoung@naicapital.com  
CalDRE #00914504

NAI Capital  
15821 Ventura Blvd.  
Encino, CA 91436  
818.905.2400  
[www.naicapital.com](http://www.naicapital.com)



COMMERCIAL REAL ESTATE SERVICES, WORLDWIDE

For Lease

# Industrial

## 13,947 SF

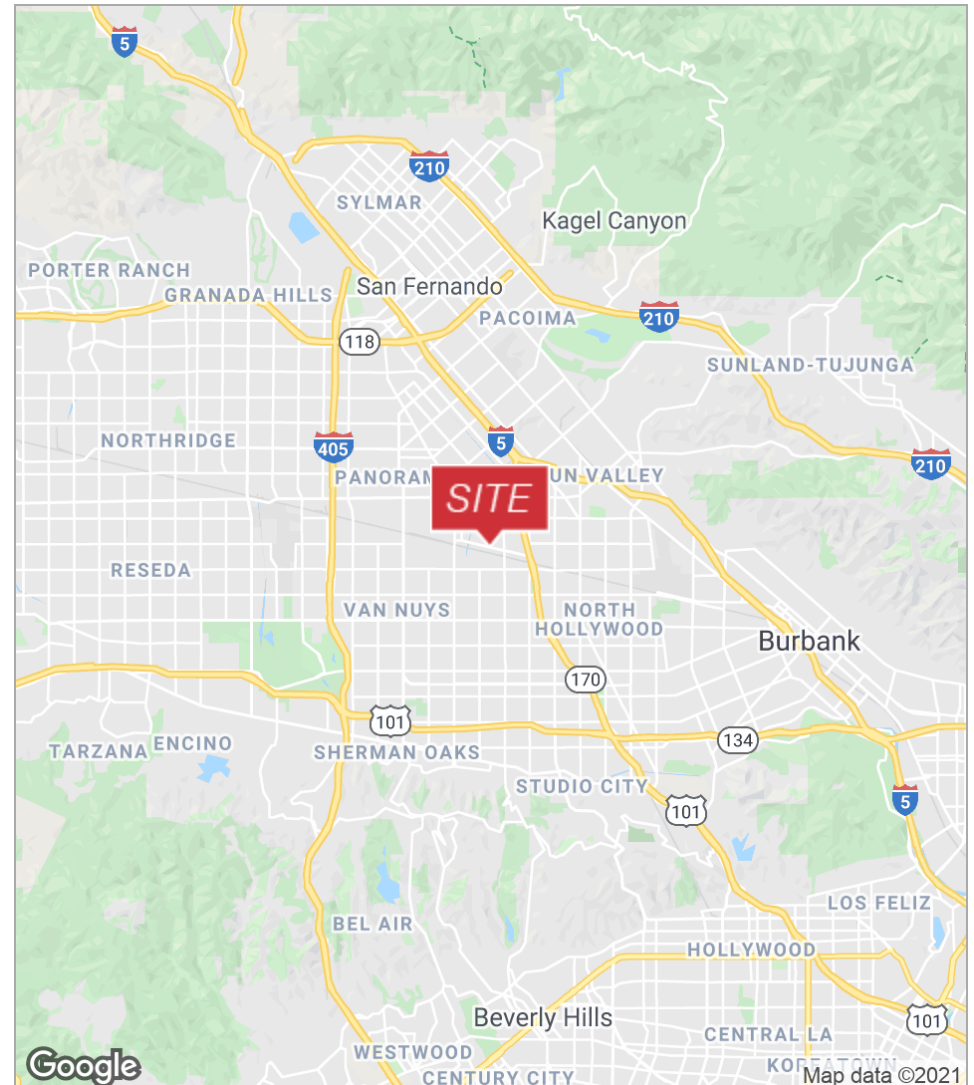
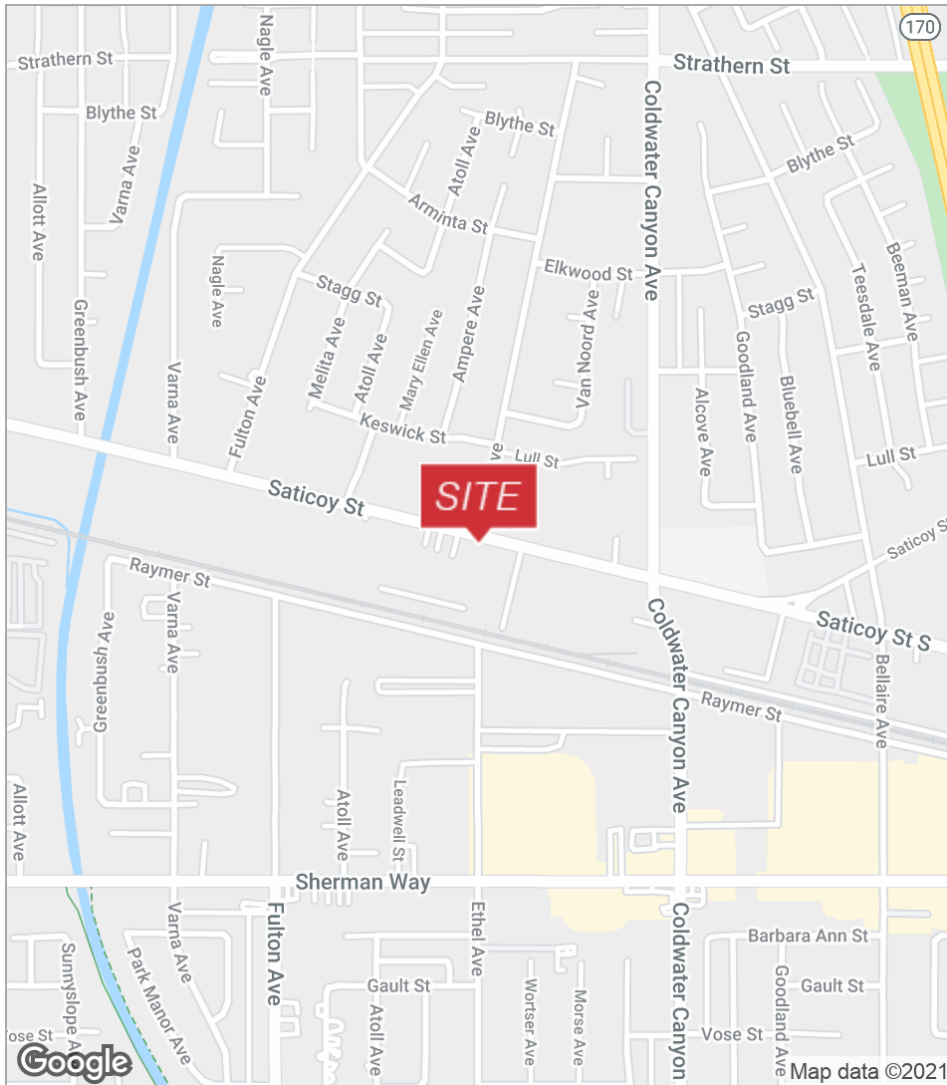

NO WARRANTY, EXPRESS OR IMPLIED, IS MADE AS TO THE ACCURACY OF THE INFORMATION CONTAINED HEREIN. THIS INFORMATION IS SUBMITTED SUBJECT TO ERRORS, OMISSIONS, CHANGE OF PRICE, RENTAL OR OTHER CONDITIONS, WITHDRAWAL WITHOUT NOTICE, AND IS SUBJECT TO ANY SPECIAL LISTING CONDITIONS IMPOSED BY OUR PRINCIPALS. COOPERATING BROKERS, BUYERS, TENANTS AND OTHER PARTIES WHO RECEIVE THIS DOCUMENT SHOULD NOT RELY ON IT, BUT SHOULD USE IT AS A STARTING POINT OF ANALYSIS, AND SHOULD INDEPENDENTLY CONFIRM THE ACCURACY OF THE INFORMATION CONTAINED HEREIN THROUGH A DUE DILIGENCE REVIEW OF THE BOOKS, RECORDS, FILES AND DOCUMENTS THAT CONSTITUTE RELIABLE SOURCES OF THE INFORMATION DESCRIBED HEREIN. LOGOS ARE FOR IDENTIFICATION PURPOSES ONLY AND MAY BE TRADEMARKS OF THEIR RESPECTIVE COMPANIES. NAI CAPITAL, INC. CAL DRE LIC. #01230474

**Chad Gahr**  
818.742.1626  
cgahr@naicapital.com  
CalDRE #01230414

**David Young**  
818.742.1651  
dyoung@naicapital.com  
CalDRE #00914504

NAI Capital  
15821 Ventura Blvd.  
Encino, CA 91436  
818.905.2400  
[www.naicapital.com](http://www.naicapital.com)