

1100 Glendon Ave. Suite 1200  
Los Angeles, CA 90024

OFFICE SPACE

**FOR SUBLEASE**





## AVAILABLE SPACE

SUITE #	RATE	USE	SIZE
1200	\$3.28/SF, FSG	Office	7,621 SF Sublease thru March 31, 2021

### Highlights:

- **Only \$25,000 per month. Incredible low Sublease Rate of only \$3.28 per square foot in one of West LA's premiere office buildings.**
- **Plug and play opportunity**
- **Fully Furnished (over \$70,000 worth of furniture, phone systems and monitors included)**
- **Fantastic end cap suite on the 12th floor with 270 degree sweeping panoramic views of the Los Angeles area.**
- **Multiple large segregated bullpen areas (perfect for social distancing), 3 conference rooms, incredible corner executive office, multiple private offices, large kitchen, reception and climate controlled server room**

For more information, contact:

### ADAM COMORA

Executive Vice President  
c. 818 521 2623 | o. 818 742 1610  
acomora@naicapital.com | Cal DRE Lic#01312271

# PROPERTY PHOTOS

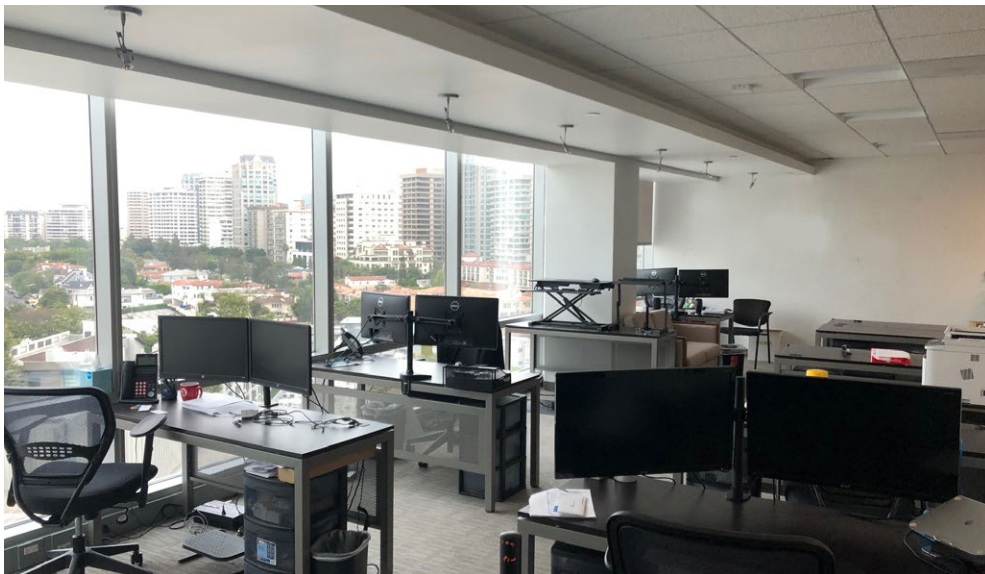

# PROPERTY PHOTOS



# PROPERTY PHOTOS



# PROPERTY PHOTOS



# PROPERTY PHOTOS



# FLOOR PLAN

## SPACE PLAN • 7,621 SF

Not to scale and may not be accurate. For illustration purposes only.

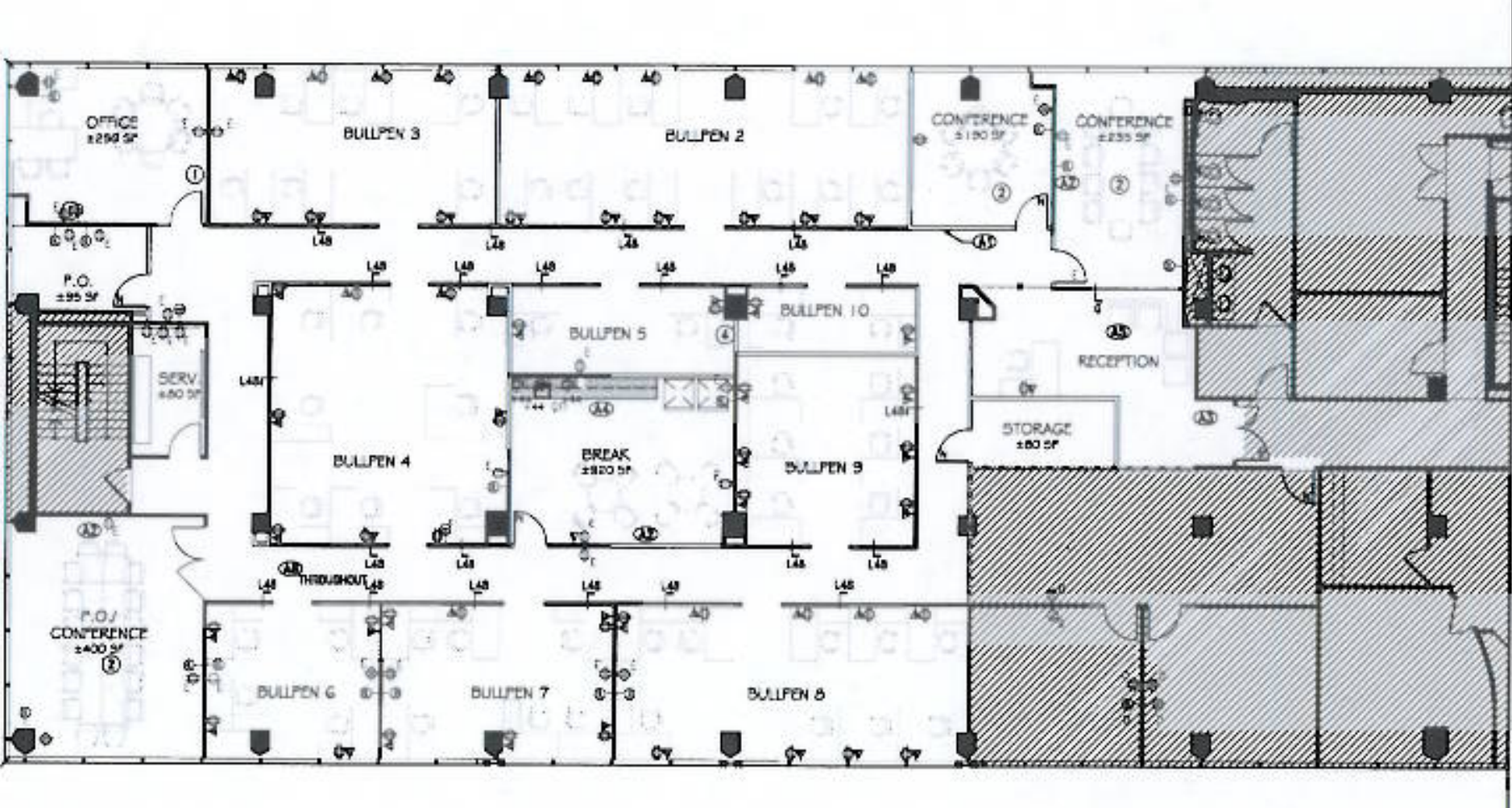

1100 Glendon Ave - Suite 1200  
Los Angeles, CA 90024

**ADAM COMORA**

Executive Vice President

c. 818 521 2623 | o. 818 742 1610

acomora@naicapital.com | Cal DRE Lic#01312271

**NAI Capital**

COMMERCIAL REAL ESTATE SERVICES, WORLDWIDE

No warranty, express or implied, is made as to the accuracy of the information contained herein. This information is submitted subject to errors, omissions, change of price, rental or other conditions, withdrawal without notice, and is subject to any special listing conditions imposed by our principals. Cooperating brokers, buyers, tenants and other parties who receive this document should not rely on it, but should use it as a starting point of analysis, and should independently confirm the accuracy of the information contained herein through a due diligence review of the books, records, files and documents that constitute reliable sources of the information described herein. NAI Capital CA DRE #01990696