

# FOR LEASE

1759 S Hillside Rd Wichita, KS 67211



## NaimMartens

Retail | 1759 S Hillside Rd.

- Strong visibility on the northeast corner of S Hillside & E Funston St.
- Anchored by Dollar General.
- Available SF: 2,400 SF
- Lease Rate: Negotiable
- NNN Expense: \$3.42/SF
- Building Size: 9,654 SF

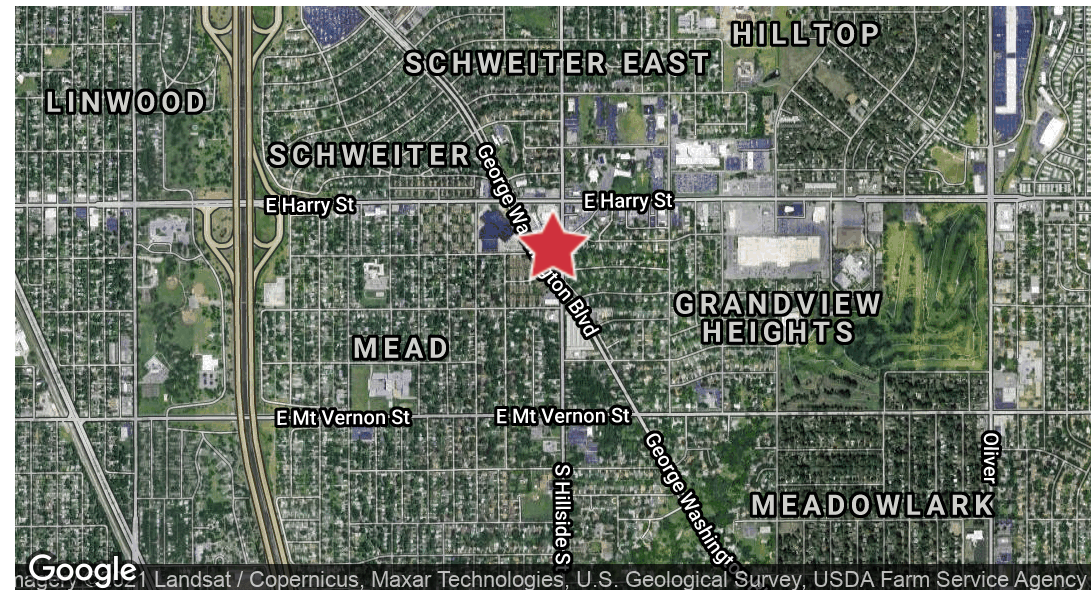

No Warranty Or Representation, Express Or Implied, Is Made As To The Accuracy Of The Information Contained Herein, And The Same Is Submitted Subject To Errors, Omissions, Change Of Price, Rental Or Other Conditions, Prior Sale, Lease Or Financing, Or Withdrawal Without Notice, And Of Any Special Listing Conditions Imposed By Our Principals No Warranties Or Representations Are Made As To The Condition Of The Property Or Any Hazards Contained Therein Are Any To Be Implied.

✉ Miles Osborne  
+1 316 928 8613  
Mosborne@naimartens.com

✉ Drew Gannon  
+1 316 262 0000  
dgannon@naimartens.com

# NaimMartens

# FOR LEASE

1759 S Hillside Rd Wichita, KS 67211

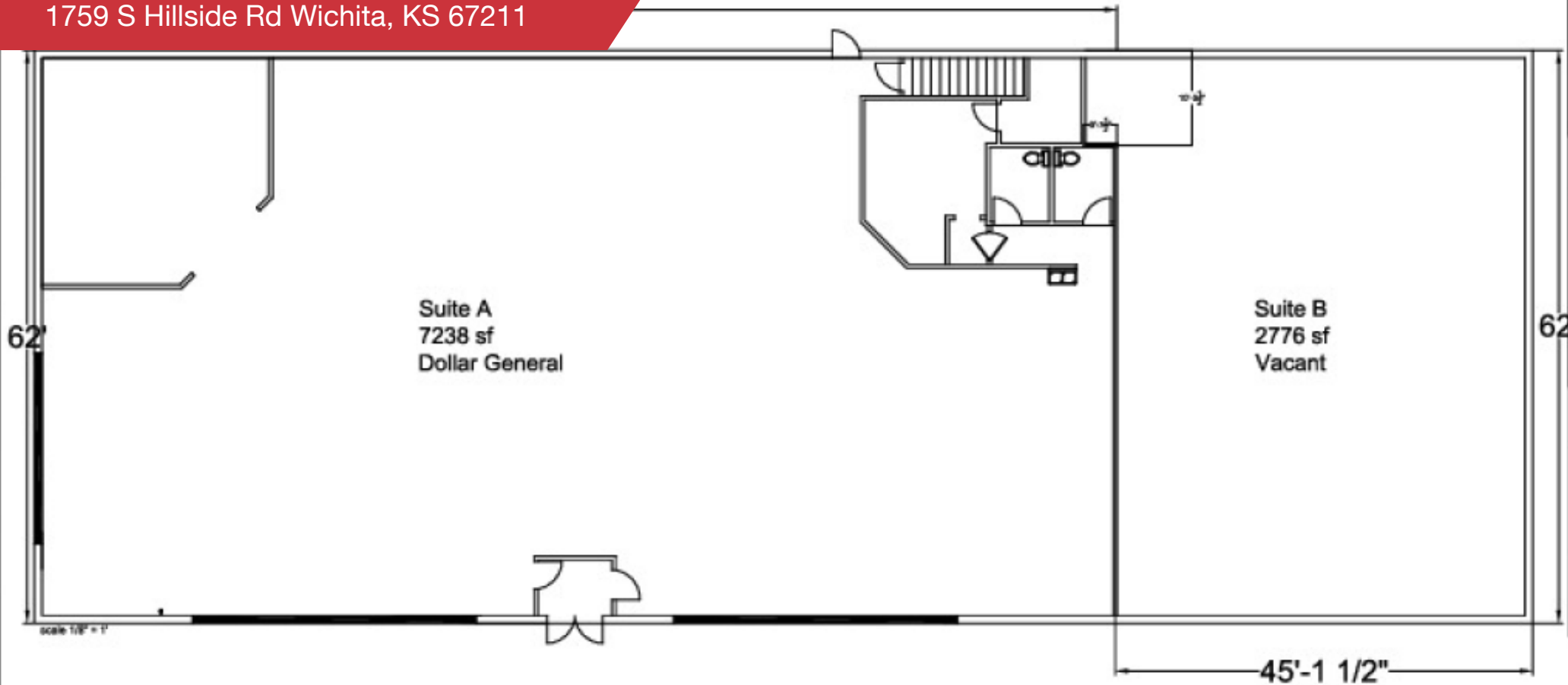

**#462 Wichita, KS**  
1759 S HILLSIDE ROAD, WICHITA, KS 67211

**\*EXISTING CONDITIONS: V.L.F.**  
Verify all dimensions and conditions in the field. Any discrepancies in these drawings shall be brought to the attention of the owner's representative prior to the submittal of plan sets for owner and city review. Failure to do so will not be an acceptable reason for change

No Warranty Or Representation, Express Or Implied, Is Made As To The Accuracy Of The Information Contained Herein, And The Same Is Submitted Subject To Errors, Omissions, Change Of Price, Rental Or Other Conditions, Prior Sale, Lease Or Financing, Or Withdrawal Without Notice, And Of Any Special Listing Conditions Imposed By Our Principals No Warranties Or Representations Are Made As To The Condition Of The Property Or Any Hazards Contained Therein Are Any To Be Implied.

✉ **Miles Osborne**  
+1 316 928 8613  
Mosborne@naimartens.com

✉ **Drew Gannon**  
+1 316 262 0000  
dgannon@naimartens.com



# FOR LEASE

1759 S Hillside Rd Wichita, KS 67211

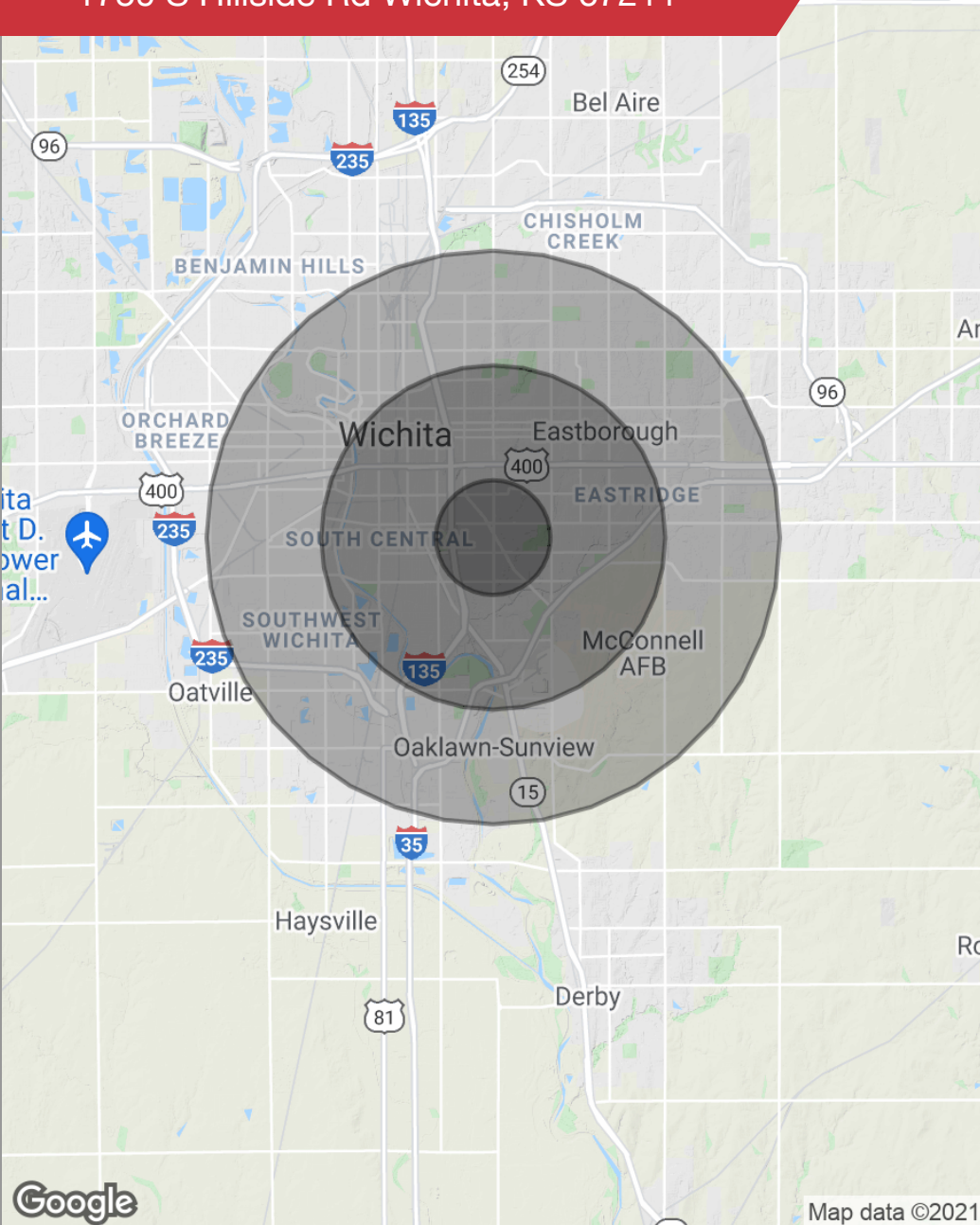

## Population

	1 Mile	3 Miles	5 Miles
Total population	11,101	96,930	224,839
Median age	40.1	32.9	32.7
Median age (male)	35.3	31.8	32.0
Median age (Female)	43.8	33.8	33.4

## Households & Income

	1 Mile	3 Miles	5 Miles
Total households	4,836	40,700	92,278
# of persons per HH	2.3	2.4	2.4
Average HH income	\$43,589	\$42,614	\$46,090
Average house value	\$92,181	\$97,768	\$112,911

\* Demographic data derived from 2010 US Census

No Warranty Or Representation, Express Or Implied, Is Made As To The Accuracy Of The Information Contained Herein, And The Same Is Submitted Subject To Errors, Omissions, Change Of Price, Rental Or Other Conditions, Prior Sale, Lease Or Financing, Or Withdrawal Without Notice, And Of Any Special Listing Conditions Imposed By Our Principals No Warranties Or Representations Are Made As To The Condition Of The Property Or Any Hazards Contained Therein Are Any To Be Implied.

✉ **Miles Osborne**  
+1 316 928 8613  
Mosborne@naimartens.com

✉ **Drew Gannon**  
+1 316 262 0000  
dgannon@naimartens.com

**NAIMartens**