

Brookfield Properties



2105 NW 102nd Avenue

Doral, Florida 33172



The 61,000 +/- RSF Property is located in the heart of the City of Doral, within the Airport West Submarket, with frontage to NW 102nd Avenue and NW 21st Street and easy access to SR 836, Florida Turnpike and all major thoroughfares.

AVAILABLE:	28,000 +/- RSF
OFFICE AREA:	5,000 +/- RSF on 2 Floors
DOCK DOORS:	Six (6)
RAMP:	One (1)
CLEAR HEIGHT	24'
CONSTRUCTION:	Concrete tilt-wall
FIRE SPRINKLER:	Class IV-System
BUILT:	1999
ZONING:	IC (City of Doral)
LEASE RATE:	\$12.50 per RSF Industrial Gross

Location

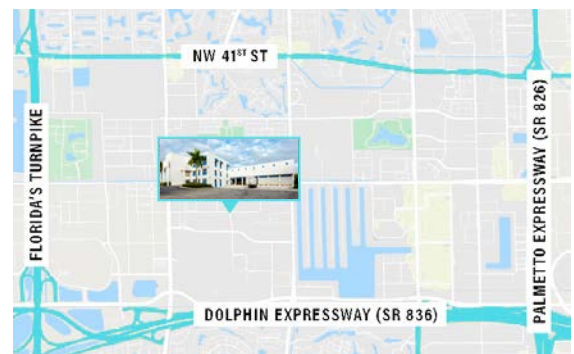

- Easy access to MIA cargo area thru the NW 25th Street Viaduct.
- Close to multiple UPS and FedEx hubs
- 3.5 miles to MIA cargo area
- 16 miles to Port of Miami
- 36 miles to Port Everglades

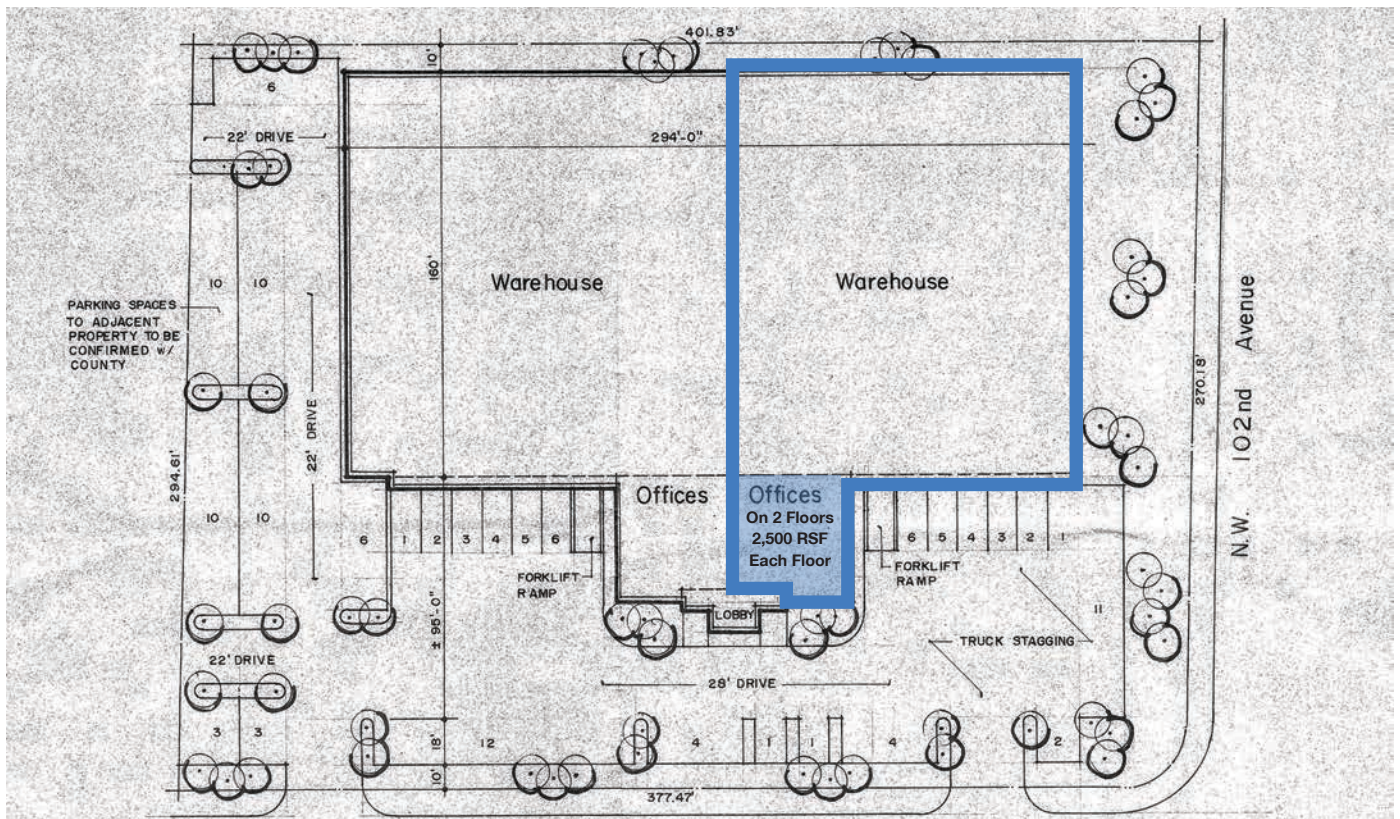

NO WARRANTY OR REPRESENTATION, EXPRESS OR IMPLIED, IS MADE AS TO THE ACCURACY OF THE INFORMATION CONTAINED HEREIN, AND THE SAME IS SUBMITTED SUBJECT TO ERRORS, OMISSIONS, CHANGE OF PRICE, RENTAL OR OTHER CONDITIONS, PRIOR SALE, LEASE OR FINANCING, OR WITHDRAWAL WITHOUT NOTICE, AND OF ANY SPECIAL LISTING CONDITIONS IMPOSED BY OUR PRINCIPALS NO WARRANTIES OR REPRESENTATIONS ARE MADE AS TO THE CONDITION OF THE PROPERTY OR ANY HAZARDS CONTAINED THEREIN ARE ANY TO BE IMPLIED.