



OFFICE/WAREHOUSE WITH FENCED YARD AVAILABLE FOR LEASE

5718 W. DANNON WAY, WEST JORDAN, UTAH 84081



PROPERTY INFORMATION

- 8,029 SF OFFICE/WAREHOUSE
- (2) 12' X 14' GROUND LEVEL DOORS
- CLEARANCE HEIGHT: 12' - 17'
- UP TO 0.25 ACRES YARD SPACE AVAILABLE
- 3 PHASE POWER/400 AMP/240 VOLT
- ZONING: M-1
- SITE SIZE: 2.50 ACRES
- FENCED LOT
- EASY ACCESS TO NEW BINGHAM HWY AND MOUNTAIN VIEW CORRIDOR

LEASE RATE
\$0.62/SF MONTH NNN

DEMOGRAPHICS

	2 MILE	5 MILE	10 MILE
TOTAL POPULATION	38,866	179,109	760,540
TOTAL HOUSEHOLDS	10,417	65,352	234,643
AVG. HOUSEHOLD INCOME	\$113,413	\$105,159	\$94,542

TRAFFIC COUNTS

9000 SOUTH: 17,800 ANNUAL AVERAGE DAILY TRAFFIC
5600 WEST: 8,305 ANNUAL AVERAGE DAILY TRAFFIC

CONTACT : 801.617.1700

DEREK KLOPFER

DEREK.KLOPFER@CRCNATIONWIDE.COM

MATT MANGUM

MATT.MANGUM@CRCNATIONWIDE.COM

5718 W. DANNON WAY, WEST JORDAN 84081

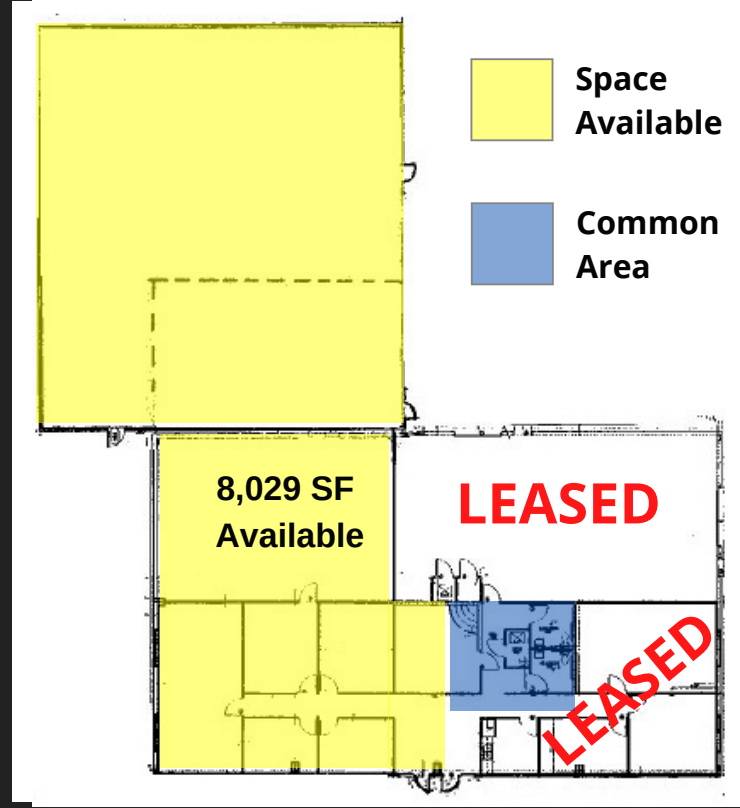

CONTACT : 801.617.1700

DEREK KLOPFER

DEREK.KLOPFER@CRCNATIONWIDE.COM

MATT MANGUM

MATT.MANGUM@CRCNATIONWIDE.COM