

2443 16TH STREET CHICAGO ILLINOIS

14,874 SF Industrial Space

74 GATED, EXCLUSIVE PARKING POSITIONS



PROPERTY DETAILS

AVAILABLE SIZE	14,874 SF
BUILDING	97,240 SF
CLEAR HEIGHT	10' - 18'
Drive-Thru Warehouse Area	10'10"
Warehouse Area	14'8"
Tech Area	18'
Flex Space	13'11"
POWER	600A
FLOOR LOAD	HEAVY
DRIVE-IN DOORS	3
SPRINKLERED	YES
CAR PARKING	74
Gated, lit, security cameras	
ZONING	PMD 7 (PLANNED MANUFACTURING DISTRICT)
LEASE RATE	SUBJECT TO OFFER
BASEMENT STORAGE AVAILABLE	

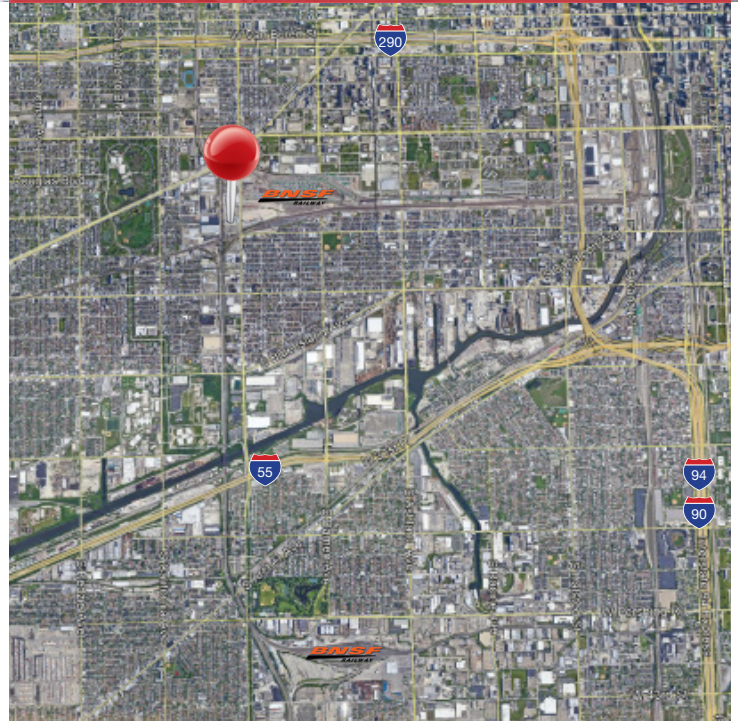

LOCATED NEAR 3
MAJOR EXPRESSWAYS:
I-290 / I-90 / I-55

AVAILABLE SPACE FLOOR PLAN

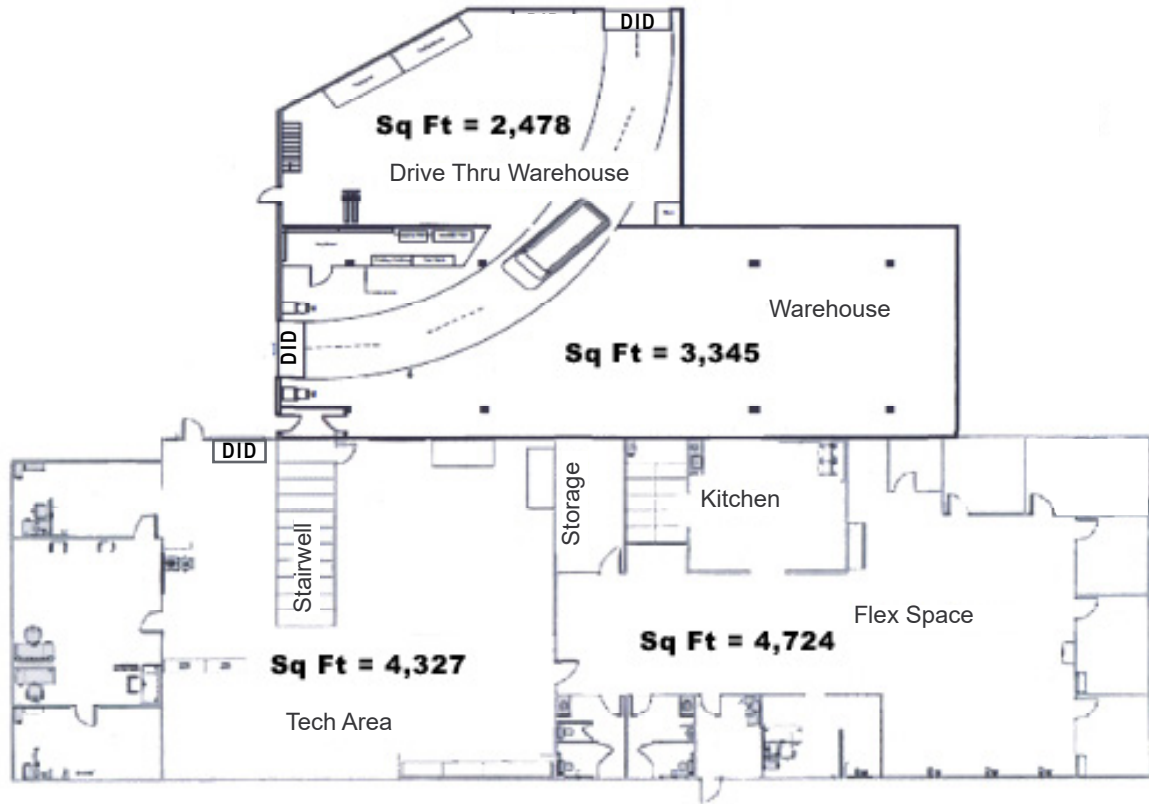

2443 16TH STREET CHICAGO ILLINOIS

14,874 SF Industrial Space



Alex Sutterer

630 693 0644
asutterer@hiffman.com

Art Burrows

630 693 0675
aburrows@hiffman.com

2443 16th Street, Chicago, IL



SUBJECT
Property



NAI Hiffman

Commercial Real Estate Services, Worldwide

ONE OAKBROOK TERRACE SUITE 400
OAKBROOK TERRACE IL 60181

HIFFMAN.COM

630 932 1234

@naihiffman



©2021 NAI Hiffman

The contents of this proposal are intended for the individuals to whom it is presented or delivered and their company associates.
Any dissemination or replication, without the express authorization of NAI Hiffman, is strictly prohibited.