

OFFICE/MEDICAL/RETAIL/BANK SPACE FOR LEASE

Atria - Ground Floor

1800 2ND STREET • SARASOTA, FL • 34236



PROPERTY OVERVIEW

Square Footage Available	5,000 - 28,487 sf
Property Type	Office/Retail
Property Size	199,770 sf
Year Built	1985
Class	A
Parking Ratio	2.5/1,000 (500 covered parking spaces)

PROPERTY FEATURES

- + Common area improvements underway!
- + 1st floor availabilities, including 2nd gen bank space
- + Large contiguous space with building signage available
- + Abundant free covered parking on-site
- + Beautiful open courtyard with lush greenery
- + Large windows provide natural lighting

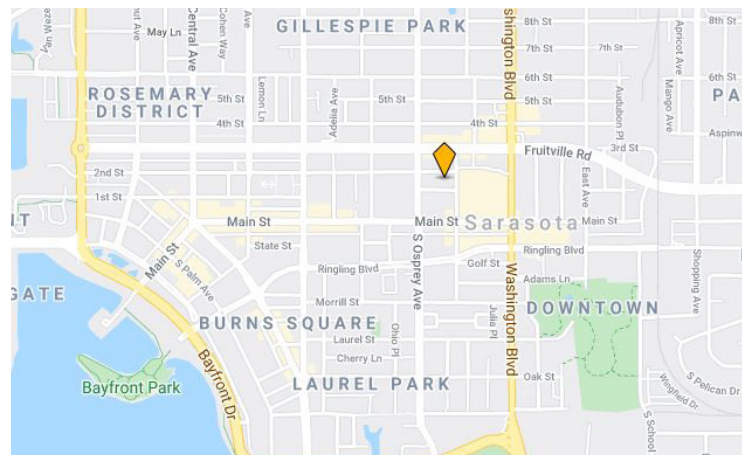

LOCATION

- + Ideally located in the heart of Sarasota
- + Situated just off SR-780, near US-301 & Main St
- + Less than 0.5 miles from the Sarasota Circuit Court

For additional information, contact:

Heather List
(813) 597-0026 office
hlist@ciminelli.com

Tom McGeachy, CCIM, CPM, RPA
(813) 908-1727 office
tmcgeachy@ciminelli.com



OFFICE/MEDICAL/RETAIL/BANK SPACE FOR LEASE

Atria - Ground Floor

1800 2ND STREET • SARASOTA, FL • 34236

DEMOGRAPHICS (3 MILE RADIUS)



77,607
POPULATION



\$48,506
MEDIAN HH INCOME



34,243
HOUSEHOLDS



45.8
MEDIAN AGE

Source: CoStar

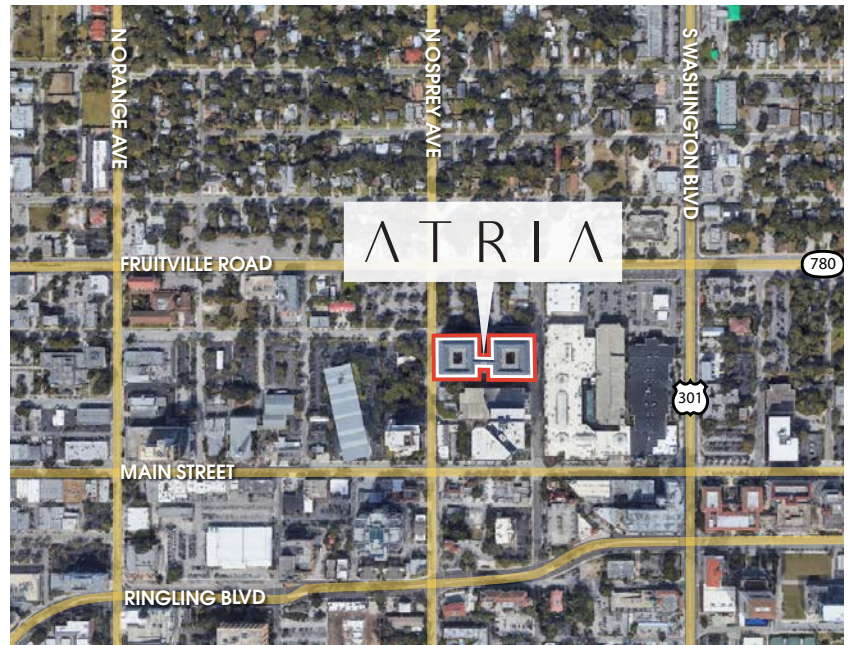
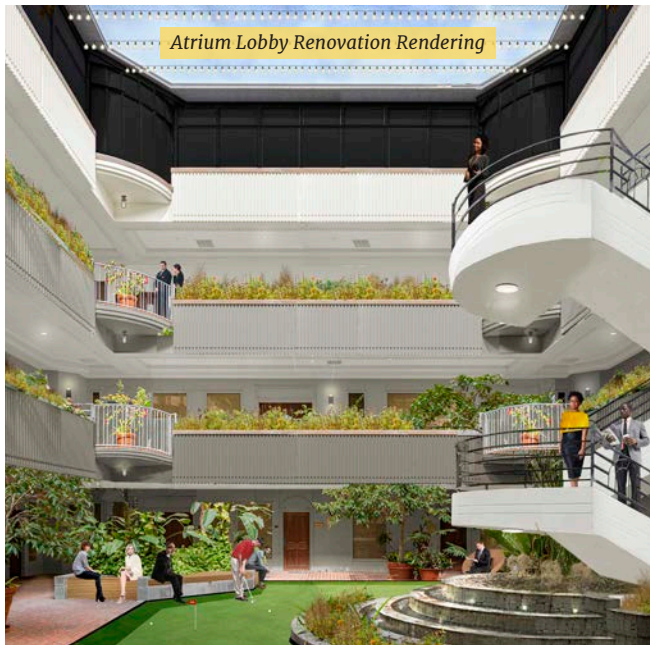

For additional information, contact:

Heather List
(813) 597-0026 office
hlist@ciminelli.com

Tom McGeachy, CCIM, CPM, RPA
(813) 908-1727 office
tmcgeachy@ciminelli.com

