

For Lease
Lincoln Corporate Center
Reading, PA 19606



Lincoln Corporate Center **90 Vanguard Drive**

Exeter Township
Reading, PA 19606

For more information, contact

Steve Willems, SIOR

+1 610 370 8506

swillems@naikeystone.com

Property Features:

- Suite #90 Available
- Quality Industrial Park Setting
- 4,800 SF +/-
- 23' 6" Ceiling Height in Industrial
- Half Industrial / Half Office
- East side of Berks County, easy access to Montgomery County / Phila.

NAIKeystone

875 Berkshire Boulevard, Suite 102

Wyomissing, PA 19610

+1 610 779 1400

naikeystone.com

NO WARRANTY OR REPRESENTATION, EXPRESS OR IMPLIED, IS MADE AS TO THE ACCURACY OF THE INFORMATION CONTAINED HEREIN, AND THE SAME IS SUBMITTED SUBJECT TO ERRORS, OMISSIONS, CHANGE OF PRICE, RENTAL OR OTHER CONDITIONS, PRIOR SALE, LEASE OR FINANCING, OR WITHDRAWAL WITHOUT NOTICE, AND OF ANY SPECIAL LISTING CONDITIONS IMPOSED BY OUR PRINCIPALS NO WARRANTIES OR REPRESENTATIONS ARE MADE AS TO THE CONDITION OF THE PROPERTY OR ANY HAZARDS CONTAINED THEREIN ARE ANY TO BE IMPLIED

Fact Sheet

GENERAL DATA	
Property Types:	Industrial/Warehouse/Office
Lot Size:	6.77 Acres
Zoning:	Light Industrial
Lease type:	NNN
CAM:	\$0.00 / SF
Tax:	\$1.48 / SF 2020 Budget

PROPERTY DATA	
Building Size & Availability:	74,827 SF Total 4,800 SF Available Now
Description:	The Suite is finished nicely w/ commercial grade carpeting, painted walls, vinyl base, 2' x 4' grid type ceiling set at 9' AFF, stained solid core doors set in hollow metal frames and 2' x 4' florescent lights with prismatic lenses. Six private offices, open area for works stations and a large 21' x 39' + room are present. One lunch room is also included. An 856 square foot mezzanine is available and not included in the rental calculations.
Construction:	100 Vanguard Drive is primarily a masonry building with plaster exterior with an addition featuring vertical steel panels. Building 6 features spit face masonry up 8' then vertical steel panels to the standing seam metal roof. Each has a typ. 6" reinforced concrete floor.
Ceiling Heights:	Office grid ceiling is 9' AFF Industrial is 23' 6" under steel
Truck Doors:	One 8' x 8' Dock with edge of dock leveler and dock seals
HVAC:	Gas forced air heat w/ A/C. Two zones in office with Honeywell programmable thermostats. Industrial area has a gas fired unit heater.
Water & Sewer:	Municipal for Muhlenberg Twp. Water Authority and Sewer Authority. Included in the CAM cost.
Lighting:	400 W Metal Halide in industrial area.
Electric:	100 Amp, 277/480 Volt, 3-Phase 4-Wire. Provided by Met Ed. Service paid directly by Tenant.
Gas:	Natural gas is provided by UGI Energy. Service is paid directly by Tenant.
Sprinkler:	100% Sprinklered at "Normal Hazard" level.
Telecom:	High Speed data from Penn-Tele-Data Company One hub is present. Cabling to all offices.
Age:	1991

**For Lease:
Lincoln Corporate Center
Reading, PA 19606**

Vanguard Drive Aerial



875 Berkshire Boulevard, Suite 102
Wyomissing, PA 19610
+1 610 779 1400
naikeystone.com

**For Lease:
Lincoln Corporate Center
Reading, PA 19606**

Suite 90 Photos

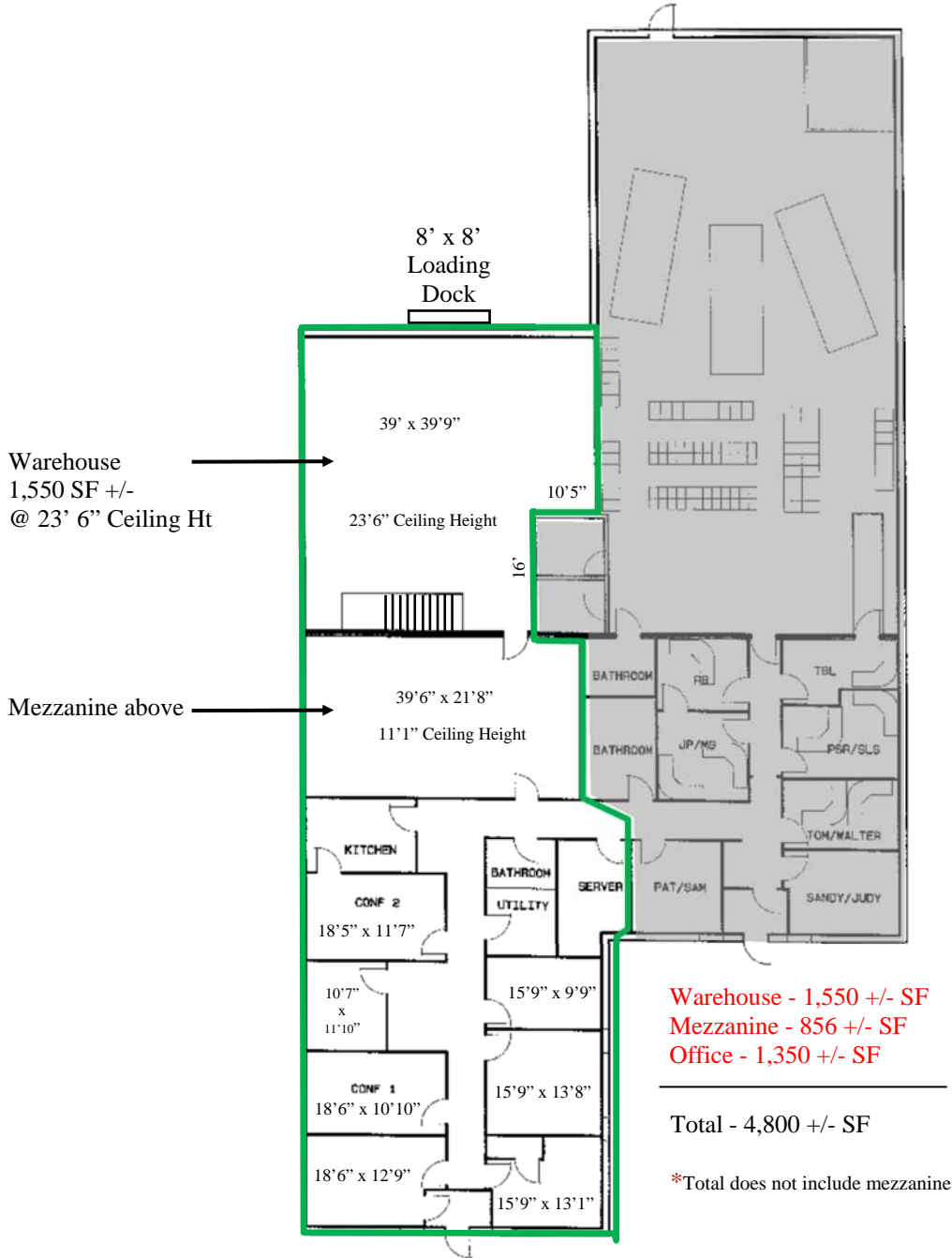

875 Berkshire Boulevard, Suite 102
 Wyomissing, PA 19610
 +1 610 779 1400
naikeystone.com

**For Lease:
Lincoln Corporate Center
Reading, PA 19606**

Photos



875 Berkshire Boulevard, Suite 102
Wyomissing, PA 19610
+1 610 779 1400
naikeystone.com

**For Lease:
Lincoln Corporate Center
Reading, PA 19606**

LOCATION

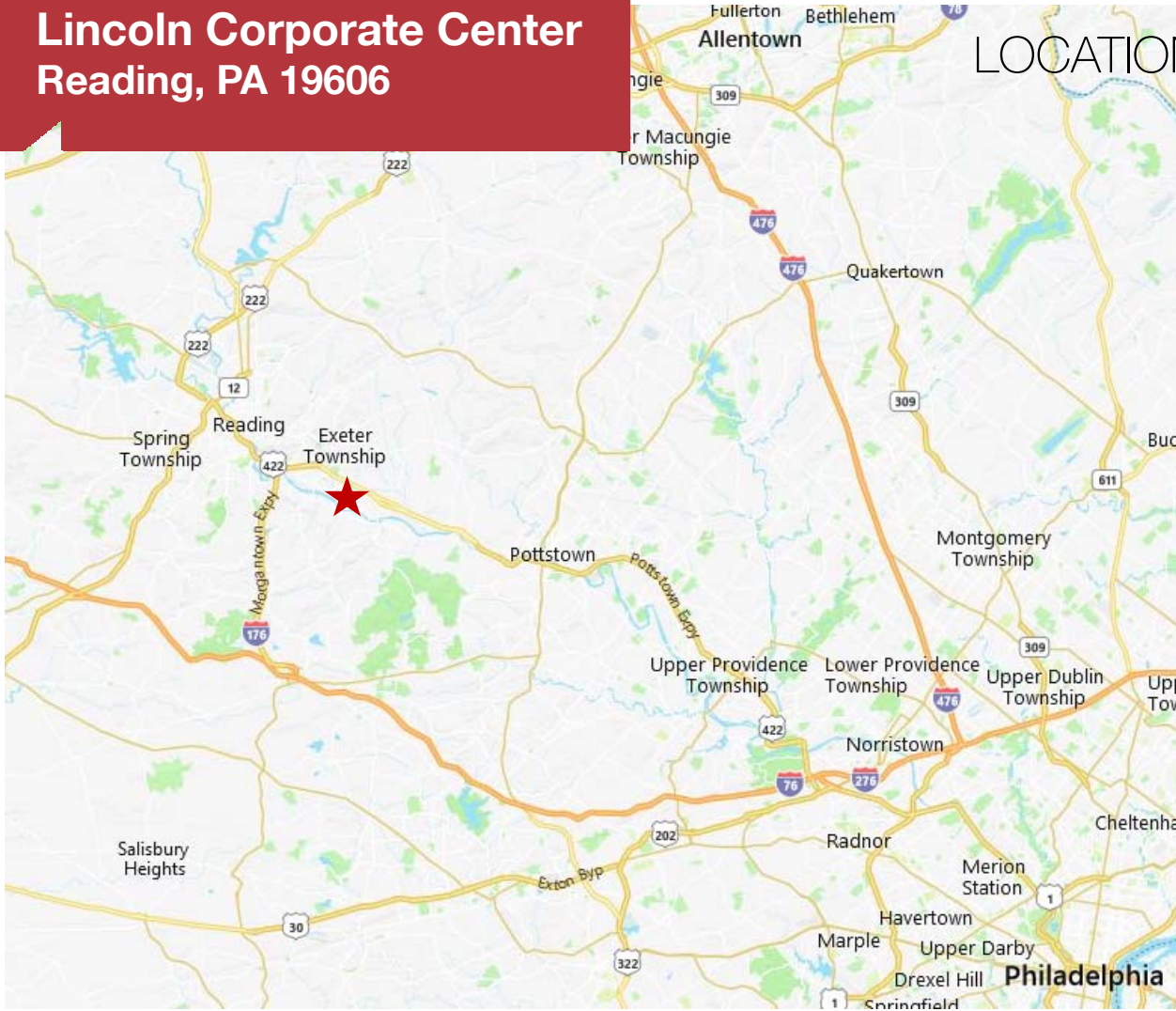

Major City	Mileage	Driving Time
Allentown, PA	42 Miles	1 Hour, 10 Minutes
Philadelphia, PA	53 Miles	1 Hour, 23 Minutes
Harrisburg, PA	74 Miles	1 Hour, 23 Minutes
Baltimore, MD	105 Miles	2 Hour, 18 Minutes
New York, NY	138 Miles	2 Hours, 41 Minutes

Mileage and driving times to nearby cities, marine terminals, and shipping centers.

Port	Mileage	Driving Time
Philadelphia Regional Port Authority	57 Miles	1 Hour, 17 Minutes
Delaware River Port Authority	55 Miles	1 Hour, 18 Minutes
Port of Wilmington	70 Miles	1 Hour, 24 Minutes

Shipping Center	Mileage	Driving Time
Fedex	1.1 Miles	3 Minutes
USPS	2.9 Miles	6 Minutes
UPS	6.8 Miles	14 Minutes
Norfolk Southern Intermodal	2.7 Miles	6 Minutes

Contact information

Steve Willems, SIOR

NAI Keystone Commercial & Industrial, LLC

Ph 610 779 1400

Email Swillems@naikeystone.com



Commercial Real Estate Services, Worldwide.

www.NAIkeystone.com