

**LOCATION.**  
commercial real estate

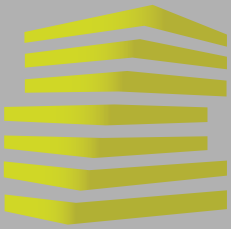

**8471 N. LINDBERGH BLVD.**

3,385 SQUARE FEET AVAILABLE AT HIGHLY VISIBLE CENTER WITH PYLON SIGNAGE AVAILABLE AND FULL ACCESS TO NORTHBOUND AND SOUTHBOUND N. LINDBERGH BLVD. IN FLORISSANT, MO.



# 8471 N. LINDBERGH BLVD.

## MARKET OVERVIEW

BRIAN DEUTSCH

314.818.1561 (DIRECT)  
314.805.6150 (MOBILE)  
Brian@LocationCRE.com

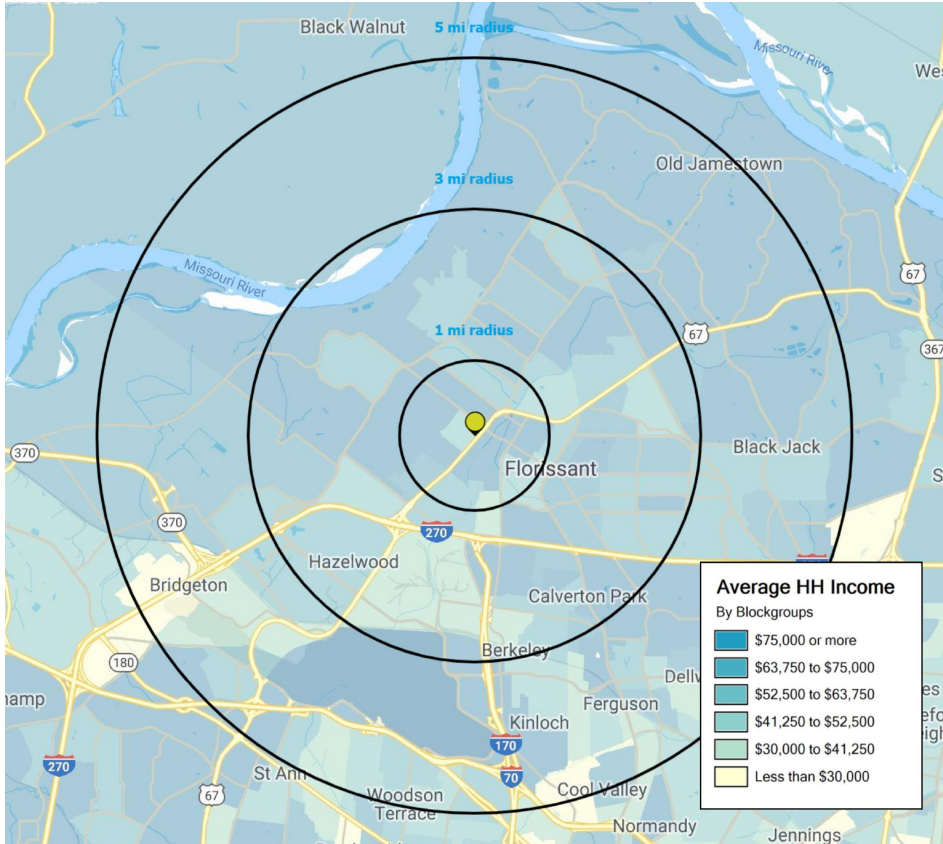

Florissant, a second-ring suburb of St. Louis, is located in North St. Louis County. Money magazine in 2012 ranked Florissant one of the Top 100 Best Places to live in their survey of America's best small cities. In 2014, website mcom ranked Florissant as #1 in their list of Best Small Cities to Retire to in America. As the 12th largest city in Missouri, Florissant boasts a population of over 52,000 residents. Florissant was also recently ranked as the 2nd safest city in Missouri.

Florissant is home to two theological colleges: St. Louis Christian College and Gateway College of Evangelical Urshan Graduate School of Theology. Lindenwood College, a private liberal arts university located in St. Charles, Missouri, has an extension campus in Florissant.

Nestled in the middle of the city is Historic Old Town Florissant, combining vintage nostalgia with a fun, vibrant community. Stores, restaurants and other businesses are housed in charming historic buildings, and rows of century homes run along peaceful tree-lined streets.

With affordable housing and good schools, Florissant is a progressive and thriving town with a reputation for "warm and friendly."

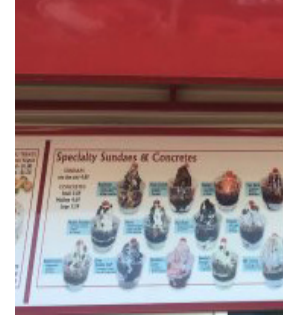
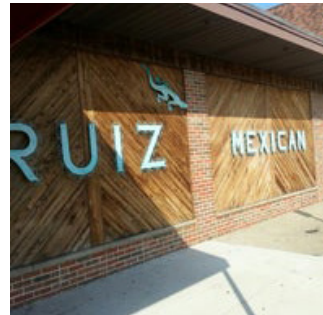
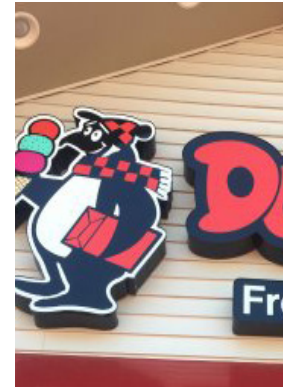

2020 DEMOGRAPHICS	POPULATION	1 MILE	3 MILES	5 MILES
	HOUSEHOLDS	5,997	38,864	68,496
	AVG HH INCOME	\$67,309	\$72,802	\$72,482

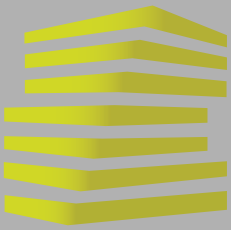

# 8471 N. LINDBERGH BLVD.

## FLOOR PLAN

BRIAN DEUTSCH

314.818.1561 (DIRECT)

314.805.6150 (MOBILE)

Brian@LocationCRE.com

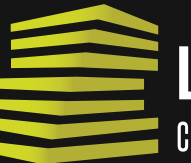
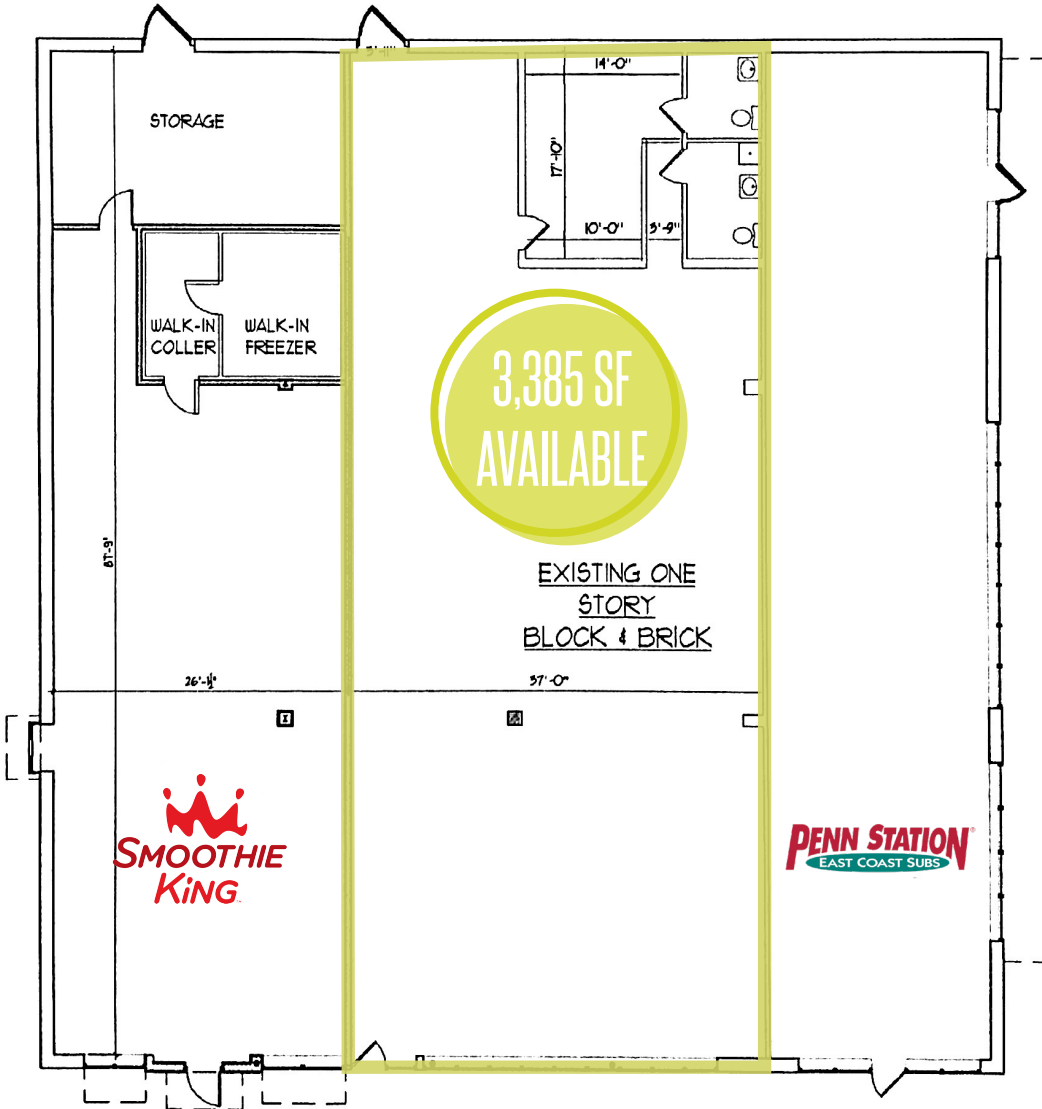

**LOCATION.**  
commercial real estate



[www.LocationCRE.com](http://www.LocationCRE.com)

THE INFORMATION IN THIS FLYER HAS BEEN OBTAINED FROM SOURCES BELIEVED RELIABLE. WHILE WE DO NOT DOUBT ITS ACCURACY, WE HAVE NOT VERIFIED IT AND MAKE NO GUARANTEE ABOUT IT. IT IS YOUR RESPONSIBILITY TO INDEPENDENTLY CONFIRM ITS ACCURACY AND COMPLETENESS. ANY PROJECTIONS, OPINIONS, ASSUMPTIONS OR ESTIMATES USED ARE FOR EXAMPLE ONLY AND DO NOT REPRESENT THE CURRENT OR FUTURE PERFORMANCE OF THE PROPERTY. THE VALUE OF THIS TRANSACTION TO YOU DEPENDS ON TAX AND OTHER FACTORS WHICH SHOULD BE EVALUATED BY YOUR TAX, FINANCIAL AND LEGAL ADVISORS. YOU AND YOUR ADVISORS SHOULD CONDUCT A CAREFUL, INDEPENDENT INVESTIGATION OF THE PROPERTY TO DETERMINE TO YOUR SATISFACTION THE SUITABILITY OF THE PROPERTY FOR YOUR NEEDS.

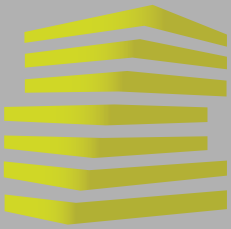

# 8471 N. LINDBERGH BLVD.

## MARKET AERIAL

BRIAN DEUTSCH

314.818.1561 (DIRECT)

314.805.6150 (MOBILE)

Brian@LocationCRE.com



SITE

67

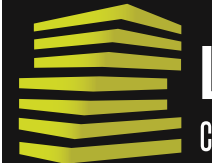

# LOCATION.

commercial real estate



[www.LocationCRE.com](http://www.LocationCRE.com)

THE INFORMATION IN THIS FLYER HAS BEEN OBTAINED FROM SOURCES BELIEVED RELIABLE. WHILE WE DO NOT DOUBT ITS ACCURACY, WE HAVE NOT VERIFIED IT AND MAKE NO GUARANTEE ABOUT IT. IT IS YOUR RESPONSIBILITY TO INDEPENDENTLY CONFIRM ITS ACCURACY AND COMPLETENESS. ANY PROJECTIONS, OPINIONS, ASSUMPTIONS OR ESTIMATES USED ARE FOR EXAMPLE ONLY AND DO NOT REPRESENT THE CURRENT OR FUTURE PERFORMANCE OF THE PROPERTY. THE VALUE OF THIS TRANSACTION TO YOU DEPENDS ON TAX AND OTHER FACTORS WHICH SHOULD BE EVALUATED BY YOUR TAX, FINANCIAL AND LEGAL ADVISORS. YOU AND YOUR ADVISORS SHOULD CONDUCT A CAREFUL, INDEPENDENT INVESTIGATION OF THE PROPERTY TO DETERMINE TO YOUR SATISFACTION THE SUITABILITY OF THE PROPERTY FOR YOUR NEEDS.