

# Ground Lease Pad

2424 Central Avenue Billings, MT 59102



## Retail Pad Locations

- Prime Retail Pad Locations Adjacent to WinCo (2019)
- Ground Lease Pad Available
- Parcel 1: Chase Bank
- Parcel 4: 22,389 SF - \$54,000 per year NNN (Adjacent to WinCo) Up to a 5,000 SF Building
- 5,000 SF Building Allowed
- High Exposure Locations at 24th Street West and Central Avenue
- 24th Street West: 27,313 ADT
- Central Avenue: 12,906 ADT
- Shadow Anchors: Rimrock Mall & Hobby Lobby

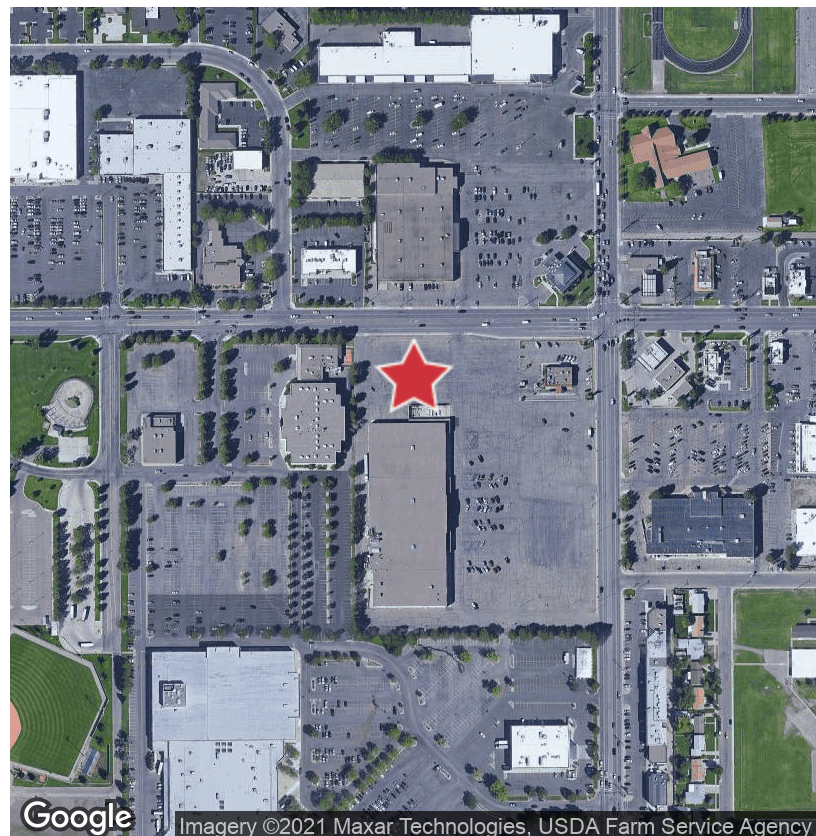

Google

Imagery ©2021 Maxar Technologies, USDA Farm Service Agency

✉ **Michael L. Walker**  
+1 406 294 6304  
mwalker@naibusinessproperties.com

✉ **Katelyn Panella**  
+1 406 294 6311  
kpanella@naibusinessproperties.com

No Warranty Or Representation, Express Or Implied, Is Made As To The Accuracy Of The Information Contained Herein, And The Same Is Submitted Subject To Errors, Omissions, Change Of Price, Rental Or Other Conditions, Prior Sale, Lease Or Financing, Or Withdrawal Without Notice, And Of Any Special Listing Conditions Imposed By Our Principals. No Warranties, Express Or Implied, Are Made As To The Condition Of The Property, And No Hazards Contained Therein Are Any To Be Implied.

# Ground Lease Pad

2424 Central Avenue Billings, MT 59102



✉ **Michael L. Walker**  
+1 406 294 6304  
mwalker@naibusinessproperties.com

✉ **Katelyn Panella**  
+1 406 294 6311  
kpanella@naibusinessproperties.com

No Warranty, Or Representation, Express Or Implied, Is Made As To The Accuracy Of The Information Contained Herein, And The Same Is Submitted Subject To Errors, Omissions, Change Of Price, Rental Or Other Conditions, Prior Sale, Lease Or Financing, Or Withdrawal Without Notice, And Of Any Special Listing Conditions Imposed By Our Principals. No Warranties, Express Or Implied, Are Made As To The Condition Of The Property, Or Any Hazards Contained Therein. Any To Be Implied.

# Ground Lease Pad

2424 Central Avenue Billings, MT 59102

## RETAILER MAP

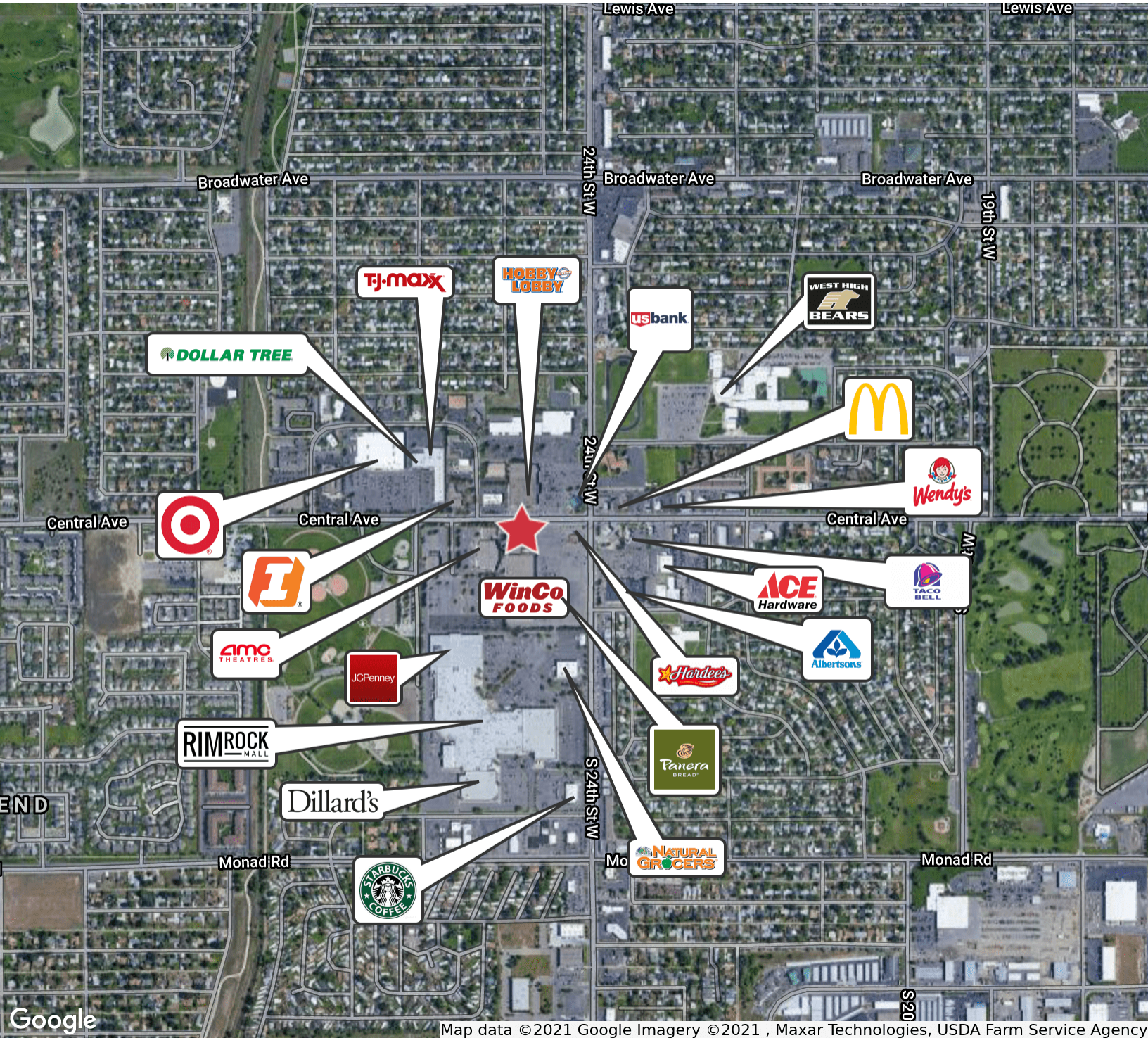

Map data ©2021 Google Imagery ©2021, Maxar Technologies, USDA Farm Service Agency

✉ **Michael L. Walker**  
+1 406 294 6304  
mwalker@naibusinessproperties.com

✉ **Katelyn Panella**  
+1 406 294 6311  
kpanella@naibusinessproperties.com

No Warranty Or Representation, Express Or Implied, Is Made As To The Accuracy Of The Information Contained Herein, And The Same Is Submitted Subject To Errors, Omissions, Change Of Price, Rental Or Other Conditions, Prior Sale, Lease Or Financing, Or Withdrawal Without Notice, And Of Any Special Listing Conditions Imposed By Our Principals. No Warranties Of Any Kind Are Made As To The Condition Of The Property. Hazards Contained Therein Are Any To Be Implied.

**NAI Business Properties**

# Ground Lease Pad

2424 Central Avenue Billings, MT 59102

## SITE PLAN

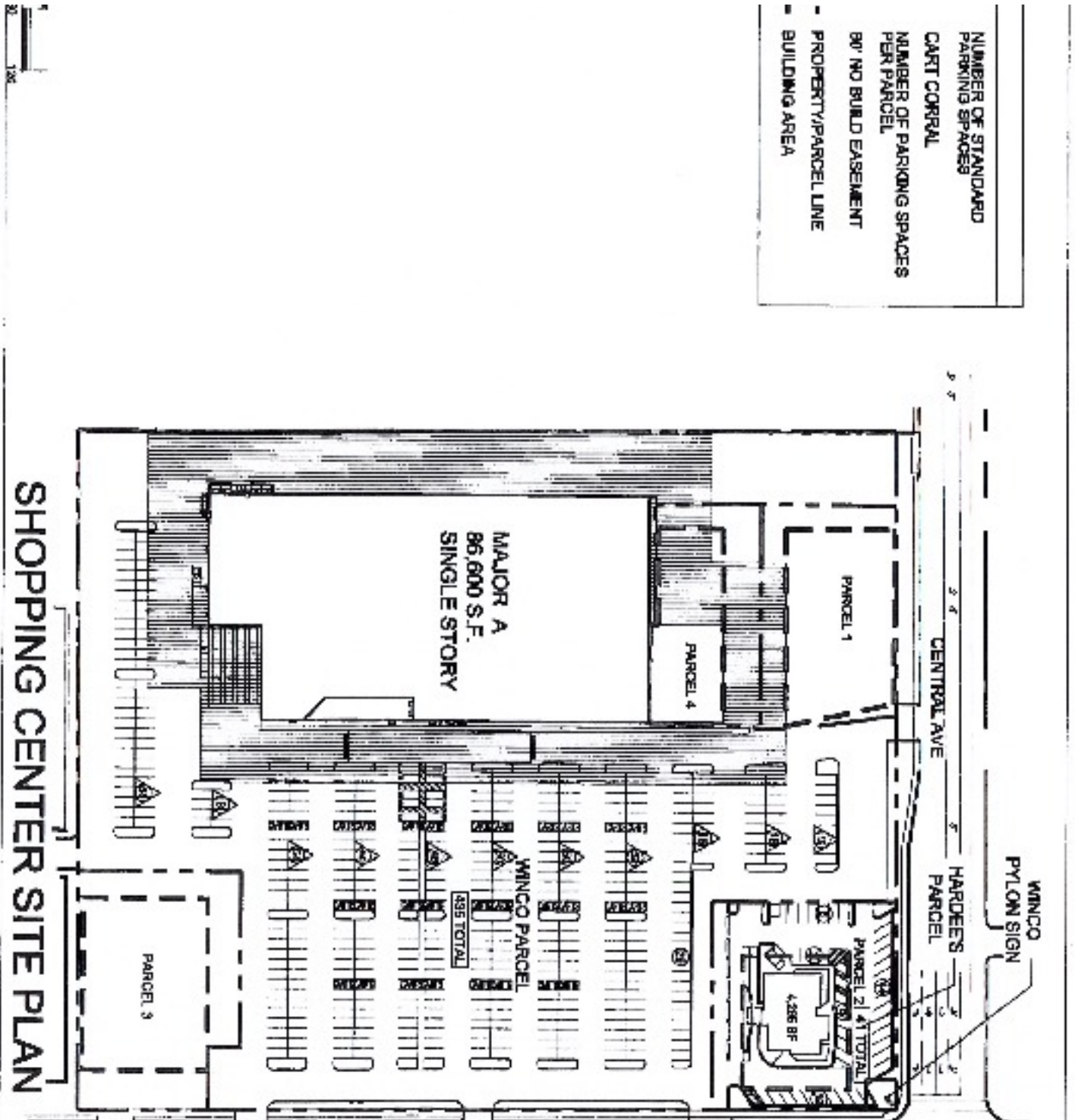

Michael L. Walker  
+1 406 294 6304  
mwalker@naibusinessproperties.com

Katelyn Panella  
+1 406 294 6311  
kpanella@naibusinessproperties.com

No Warranty Or Representation, Express Or Implied, Is Made As To The Accuracy Of The Information Contained Herein, And The Same Is Submitted Subject To Errors, Omissions, Change Of Price, Rental Or Other Conditions, Prior Sale, Lease Or Financing, Or Withdrawal Without Notice, And Of Any Special Listing Conditions Imposed By Our Principals. No Warranties Are Made As To The Condition Of The Property, Or Hazards Contained Therein. Any To Be Implied.

NAI Business Properties

# Ground Lease Pad

2424 Central Avenue Billings, MT 59102

## SITE PLAN

### EXHIBIT C

Located on Lot 1, Block 1, of REB Subdivision located in the NE1/4 of Section 12, Township 1 South, Range 25 East, P.M.M. Yellowstone County, City of Billings, Montana.

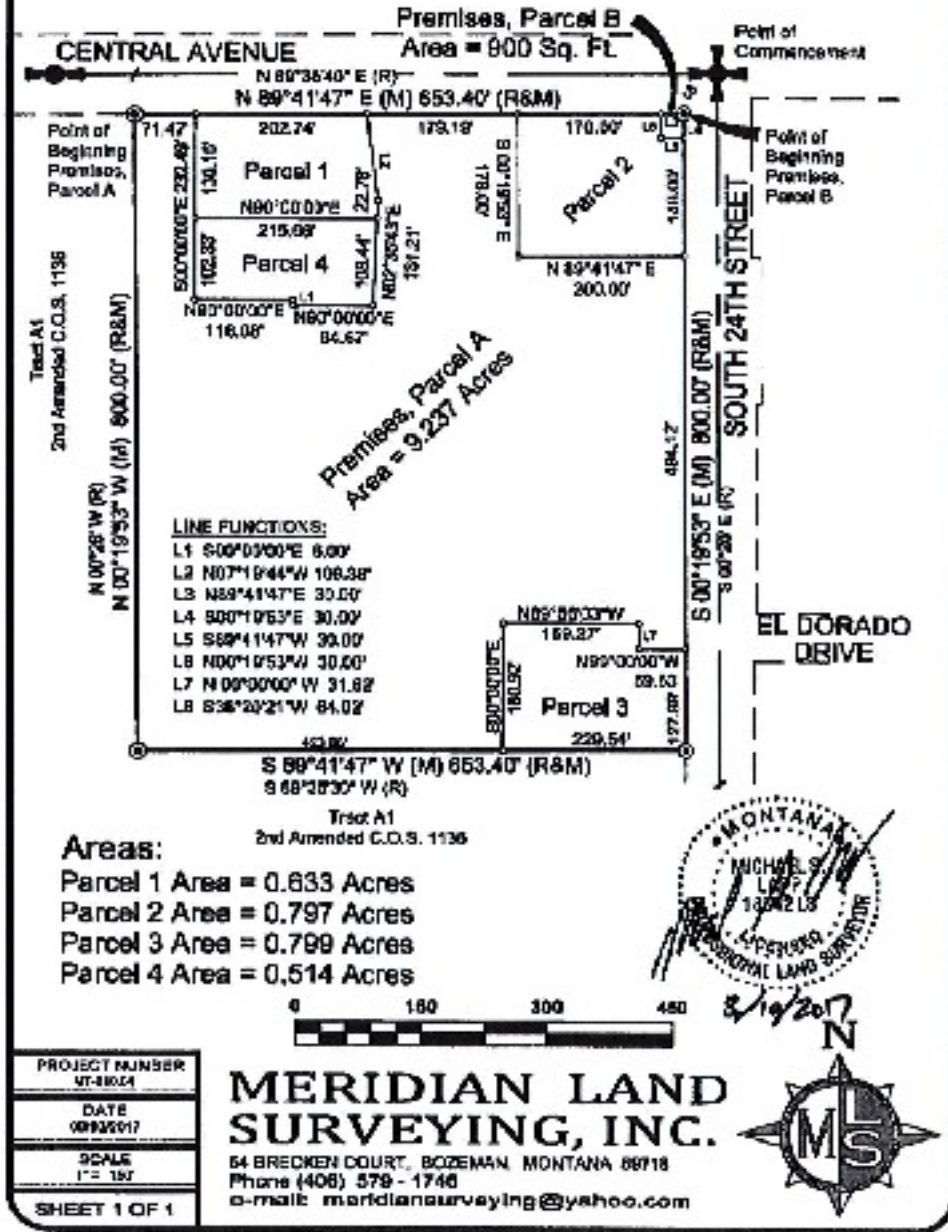

Acres055950.603464549:0 2

Michael L. Walker  
 +1 406 294 6304  
 mwalker@naibusinessproperties.com

Katelyn Panella  
 +1 406 294 6311  
 kpanella@naibusinessproperties.com

No Warranty Or Representation, Express Or Implied, Is Made As To The Accuracy Of The Information Contained Herein, And The Same Is Submitted Subject To Errors, Omissions, Change Of Price, Rental Or Other Conditions, Prior Sale, Lease Or Financing, Or Withdrawal Without Notice, And Of Any Special Listing Conditions Imposed By Our Principals. No Warranties Are Made As To The Condition Of The Property Or Hazards Contained Therein As Any To Be Implied.

NAI Business Properties

# Ground Lease Pad

2424 Central Avenue Billings, MT 59102

## DEMOGRAPHICS MAP

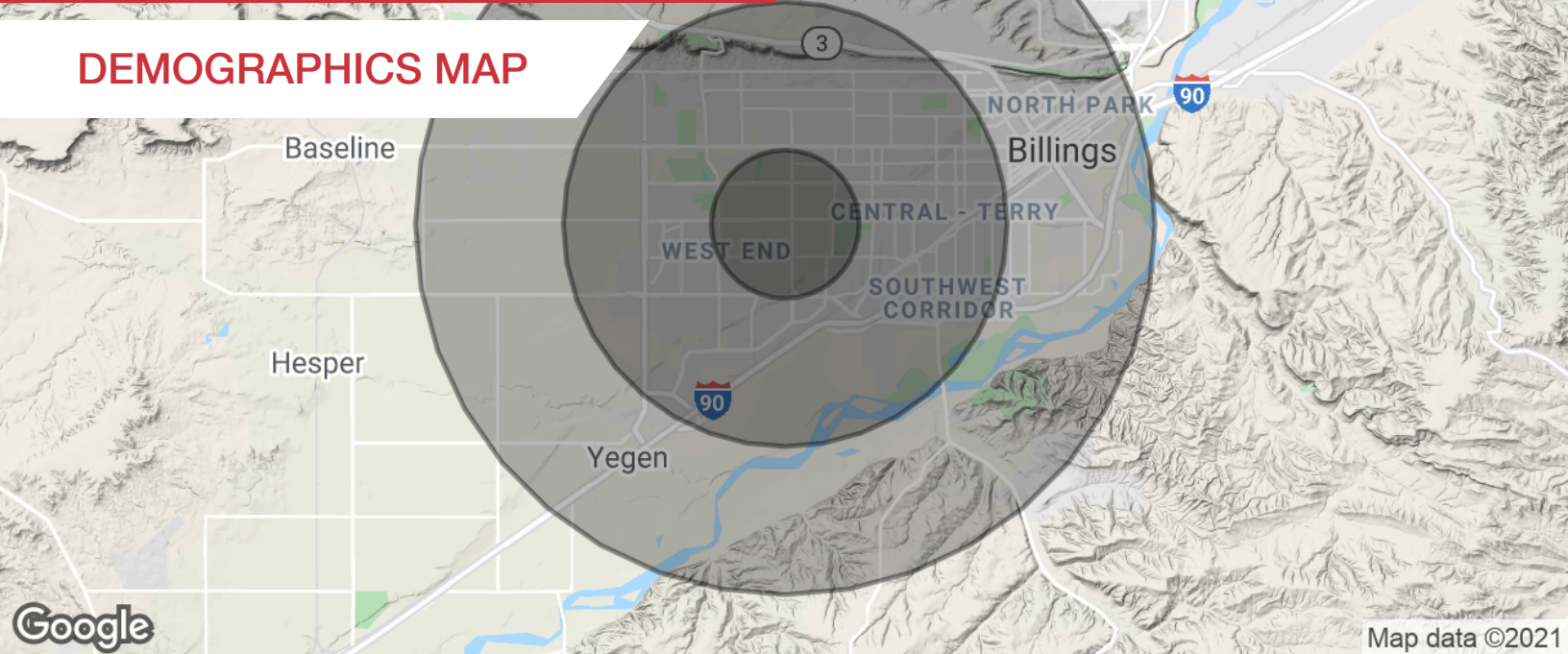

### Population

	1 Mile	3 Miles	5 Miles
Total population	6,704	64,278	96,843
Median age	39.3	39.7	38.4
Median age (male)	36.7	37.4	36.4
Median age (Female)	41.5	41.9	40.6

### Households & Income

	1 Mile	3 Miles	5 Miles
Total households	2,856	28,923	42,732
# of persons per HH	2.3	2.2	2.3
Average HH income	\$57,906	\$58,861	\$58,960
Average house value	\$159,069	\$188,604	\$194,693

\* Demographic data derived from 2010 US Census