

For Lease

# Office

822 - 5,687 SF | 2.05 - 2.10 SF/month



## 201 W Liberty St

Reno, Nevada 89501

### Property Highlights

- Walking Distance to downtown, courthouse, banks and shopping.
- Office with Mountain and Downtown views.
- Plenty of parking.
- Newly Remodeled building.
- Open office area for cubicles.

### Property Description

This building is 33,208 SF and has undergone a full remodel on the interior and exterior. It is directly opposite the Nevada Museum of Art and offers abundant surface parking with the following modern amenities:

- High speed elevators
- High-Speed fiber connection, Low-cost DSL
- On-Demand after hours HVAC
- State of the art lighting
- Wi-Fi hotspot
- Short walking distance to County & Federal courts, Truckee River and Downtown restaurants

### OFFERING SUMMARY

Available SF	822 - 5,687 SF
Lease Rate	\$2.05 - \$2.10 SF/month (Full Service)

### AVAILABLE SPACES

Suite	Lease Rate	SF
208	\$2.10 SF/month	822
210	\$2.05 SF/month	4,663
102	\$2.05 SF/month	5,687

For more information

#### Chase Houston, SIOR

NV #S.0174274  
O: 775 336 4645  
chouston@naialliance.com

#### Dan Oster, SIOR

NV #B.0143648.LLC  
O: 775 336 4665  
doster@naialliance.com



5345 Kietzke Lane, Suite 100  
Reno, NV 89511  
775 336 4600 tel  
[naialliance.com](http://naialliance.com)

For Lease

# Office Building

822 - 5,687 SF | \$2.05 SF/month

LEASE TYPE | Full Service

TOTAL SPACE | 822 - 5,687 SF

LEASE TERM | Negotiable

LEASE RATE | \$1.75 SF/month

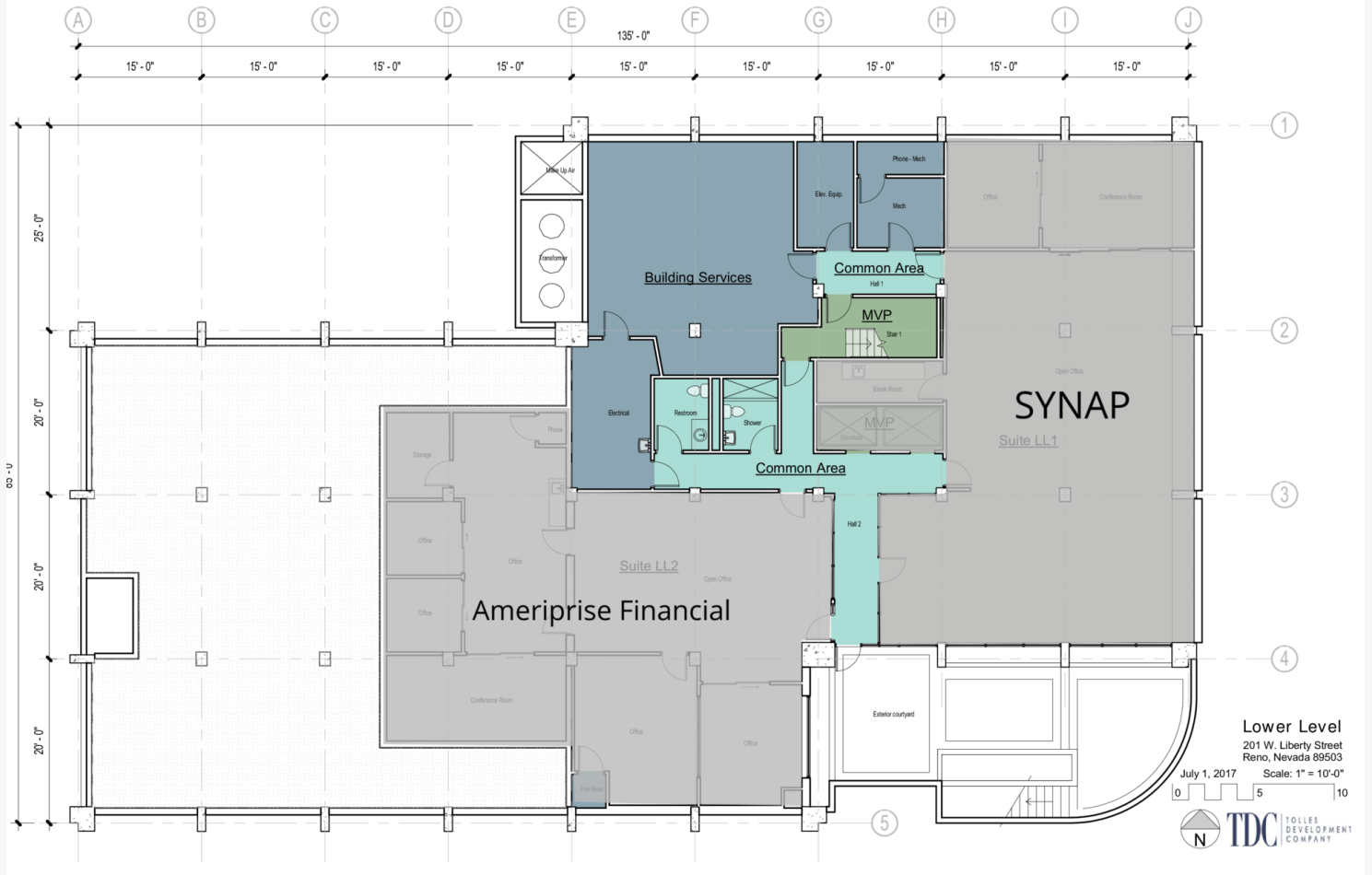

UNAVAILABLE

For Lease

# Office Building

822 - 5,687 SF | \$2.05 SF/month

LEASE TYPE | Full Service

TOTAL SPACE | 822 - 5,687 SF

LEASE TERM | Negotiable

LEASE RATE | \$2.05 SF/month

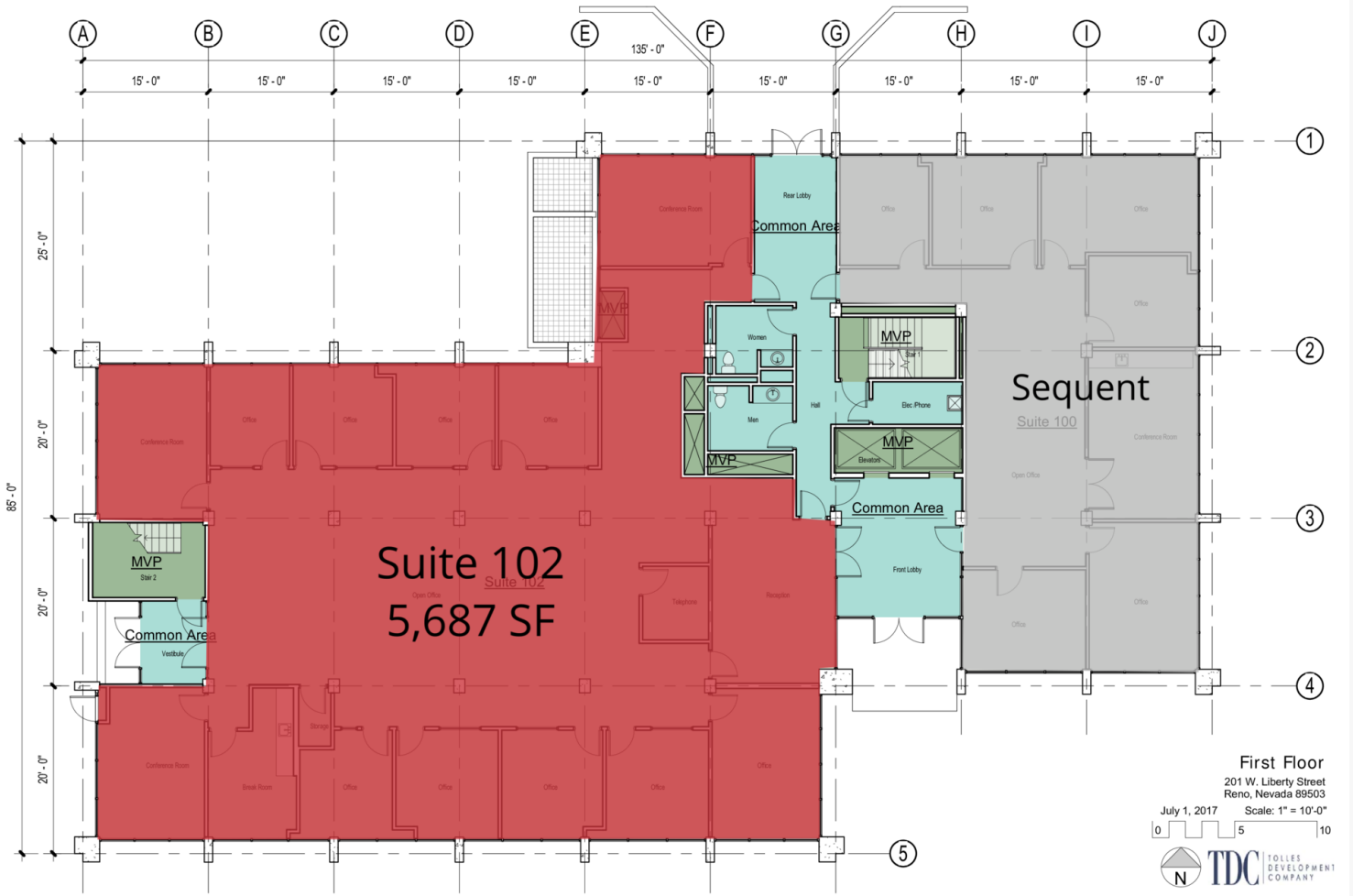

First Floor

201 W. Liberty Street  
Reno, Nevada 89503

July 1, 2017 Scale: 1" = 10'-0"



UNAVAILABLE

AVAILABLE

For Lease

# Office Building

822 - 5,687 SF | \$2.05 SF/month

LEASE TYPE | Full Service

TOTAL SPACE | 822 - 5,687 SF

LEASE TERM | Negotiable

LEASE RATE | \$2.10 SF/month

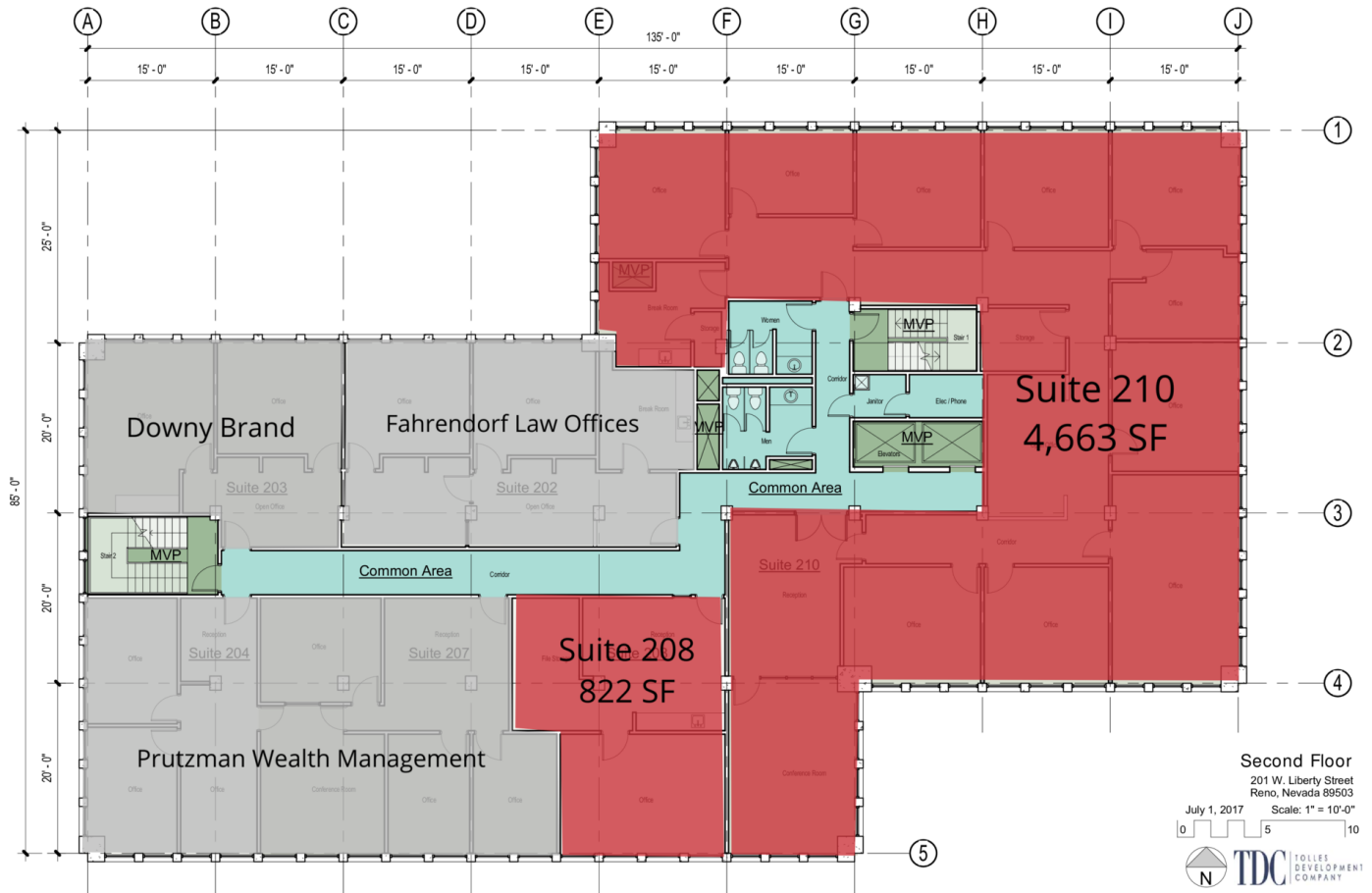

For Lease

# Office Building

822 - 5,687 SF | \$2.05 SF/month

LEASE TYPE | Gross

TOTAL SPACE | 822 - 5,687 SF

LEASE TERM | Negotiable

LEASE RATE | \$2.05 SF/month

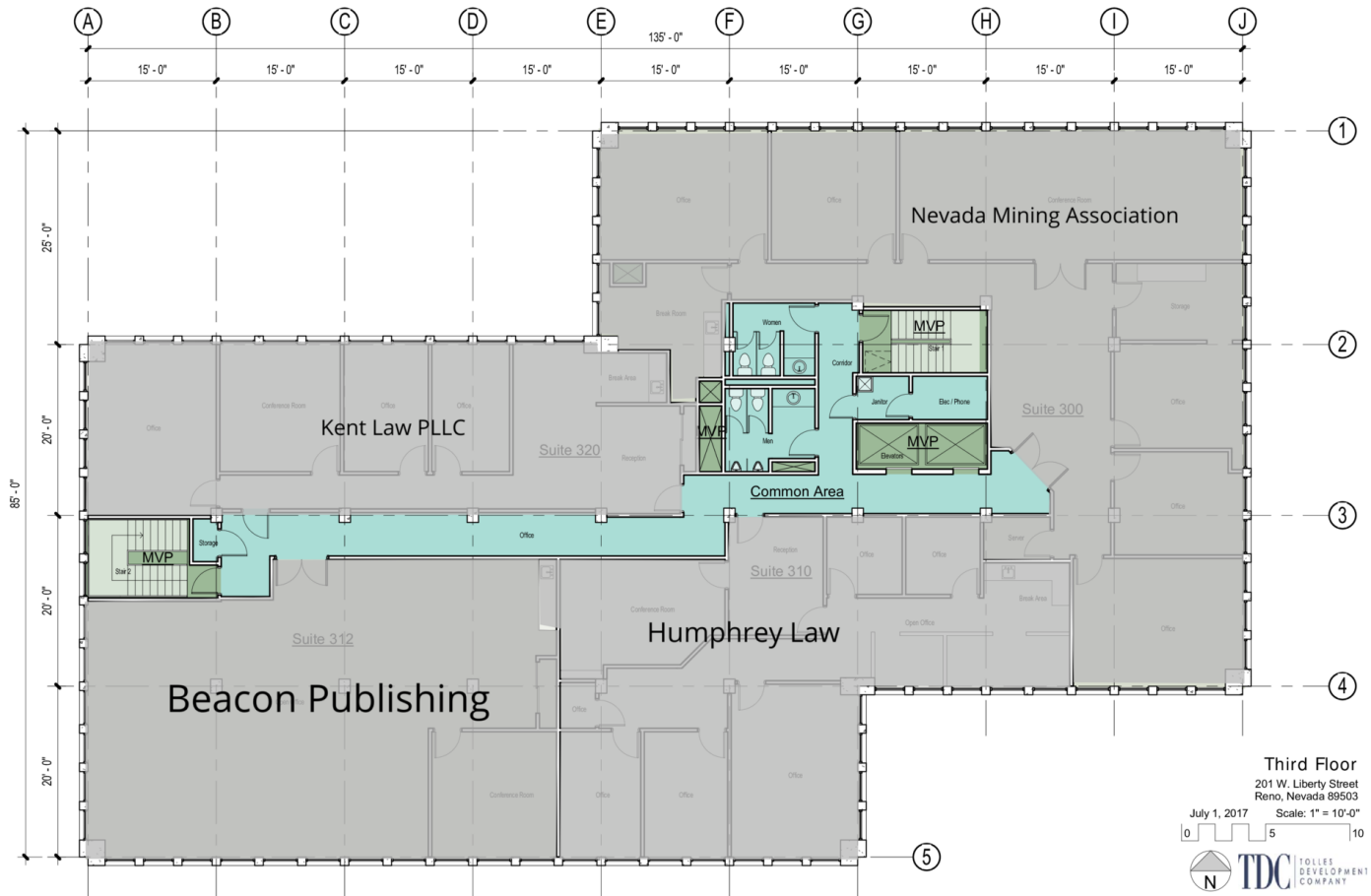

UNAVAILABLE

For Lease

# Office Building

822 - 5,687 SF | \$2.05 SF/month



# Additional Photos



## NAI Alliance

Chase Houston, SIOR  
Vice President  
T +1 775.336.4645  
E [chouston@naialliance.com](mailto:chouston@naialliance.com)

NAI Alliance  
5345 Kietzke Lane  
Reno, NV 89511  
[naialliance.com](http://naialliance.com)

Dan Oster, SIOR  
Senior Vice President & Principal  
Industrial & Office Properties  
T +1 775.336.4665  
E [doster@naialliance.com](mailto:doster@naialliance.com)