

7390 S Creek Road #104, Sandy, UT 84093

OFFICE  
FOR SALE

# Creek Road Office Condo

7390 S Creek Road #104  
Sandy, UT 84093

OFFICE  
FOR SALE



## PROPERTY INFORMATION

- > Sales price: \$480,000.00
- > Approx \$151.00 PSF
- > 2,145 SF office\*
- > 1,035 SF basement storage\*
- > 4 private offices
- > 1 conference room
- > Monument signage
- > Main floor suite

*\*Note: The total square footage includes the common area of the building.*

## DEMOGRAPHICS

	1 MILE	3 MILE	5 MILE
POPULATION			
2020 EST	18,058	138,949	312,782
2025 EST	19,062	147,025	332,347
HOUSEHOLDS			
2020 EST	7,615	52,010	114,471
2025 EST	8,025	54,991	121,544
INCOME			
2020 AVG	\$99,492	\$99,901	\$102,081
2020 MED	\$76,938	\$76,741	\$77,036

Source: Esri 2020

**NAIPremier**

7455 Union Park Avenue Ste. A, Midvale, Utah 84047  
801 255 3333 | [naipremier.com](http://naipremier.com)

**NAIPremier**  
COMMERCIAL REAL ESTATE SERVICES, WORLDWIDE

7455 Union Park Avenue Ste. A,  
Midvale, Utah 84047

801 255 3333 | [naipremier.com](http://naipremier.com)

**Mark Lundgren**

c 801 913 1802  
[mlundgren@naipremier.com](mailto:mlundgren@naipremier.com)

**Christopher Wilson, CCA**

c 801 783 6269  
[cwilson@naipremier.com](mailto:cwilson@naipremier.com)

NO WARRANTY OR REPRESENTATION, EXPRESS OR IMPLIED, IS MADE AS TO THE ACCURACY OF THE INFORMATION CONTAINED HEREIN, AND THE SAME IS SUBMITTED SUBJECT TO ERRORS, OMISSIONS, CHANGE OF PRICE, RENTAL OR OTHER CONDITIONS, PRIOR SALE, LEASE OR FINANCING, OR WITHDRAWAL WITHOUT NOTICE, AND OF ANY SPECIAL LISTING CONDITIONS IMPOSED BY OUR PRINCIPALS. NO WARRANTIES OR REPRESENTATIONS ARE MADE AS TO THE CONDITION OF THE PROPERTY OR ANY HAZARDS CONTAINED THEREIN ARE ANY TO BE IMPLIED.



Suite 104 - 2,145 SF\*

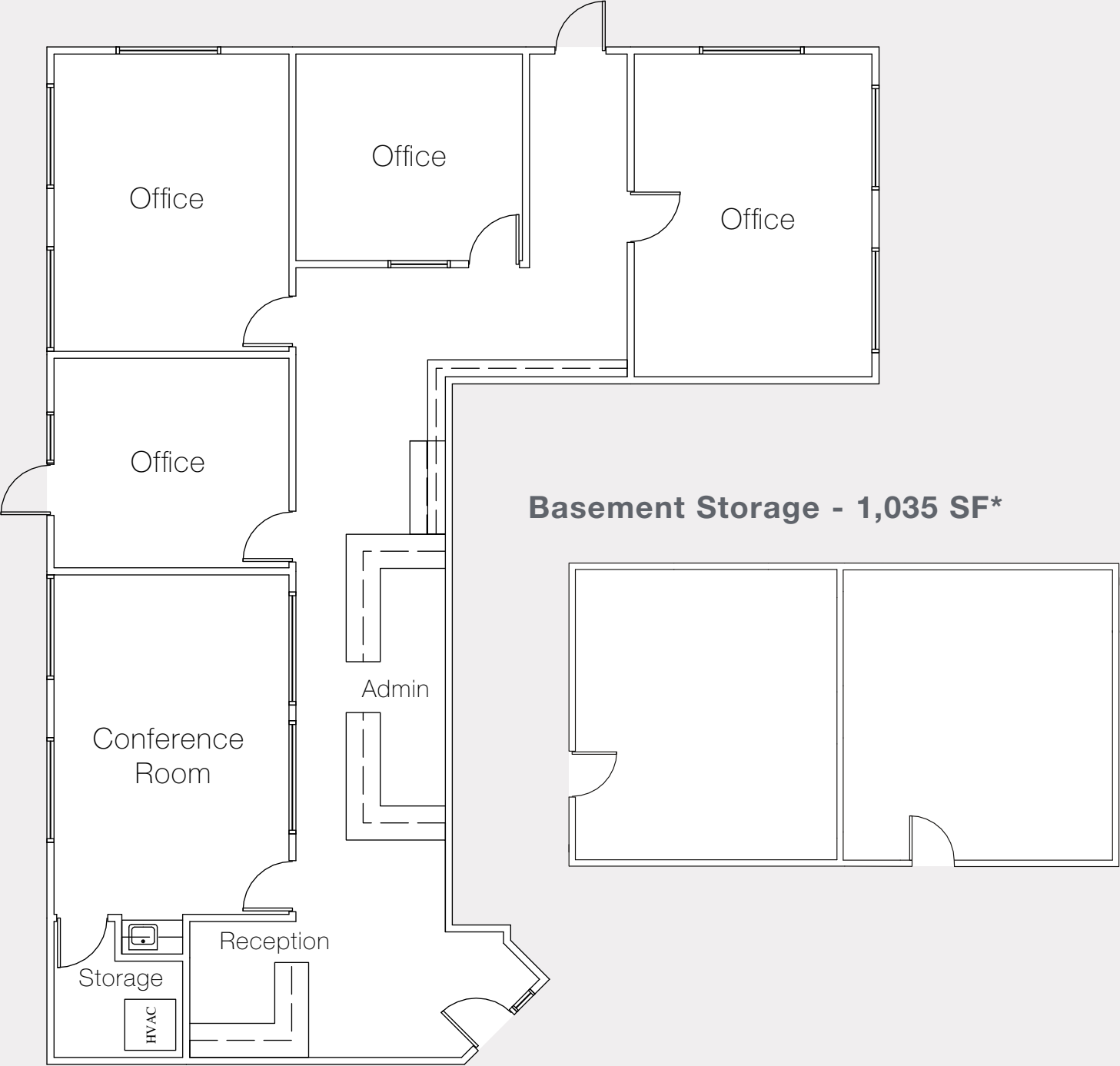

\*Note: The total square footage includes the common area of the building.