

FOR LEASE

PROPERTY OVERVIEW

Located in Mobile's CBD, One St. Louis Centre offers professional office space in a Class A, multi-tenant office building. Positioned at the intersection of Water Street and St. Louis Street, the building provides for great access and visibility. Amenities include: available on-site parking, modern finishes, and abundant options for restaurants, hotels, fitness facilities, and public parks within walking distance.

Current availability consists of two improved suites. Call for details.

BUILDING INFORMATION

- Office Class: A
- Gross Building Area: 97,723 RSF
- Ceiling Height: 9'
- Number of Stories: 5
- Exterior: Brick
- Interior: Lobby is finished with granite and marble. Custom finishes exist throughout.
- Air Conditioning: Engineered System

RENTAL RATE

- \$17.50/RSF - Full Service, Increasing 2% Per Year
- Parking: \$80.00/Month

AVAILABLE SUITES

- | | | | |
|-------------|------------|----------|---------------------------------------|
| • 2nd Floor | Suite 2000 | 4,980 SF | Available Now / Abundant Open Space |
| • 4th Floor | Suite 4010 | 5,055 SF | Water Views / Elevator Lobby exposure |



SUMMARY

LOCATION MAP

2ND FLOOR PLAN

4TH FLOOR PLAN

PHOTOS



ONE ST. LOUIS CENTRE
1 ST. LOUIS STREET, MOBILE, AL

SUMMARY

LOCATION MAP

2ND FLOOR PLAN

4TH FLOOR PLAN

PHOTOS

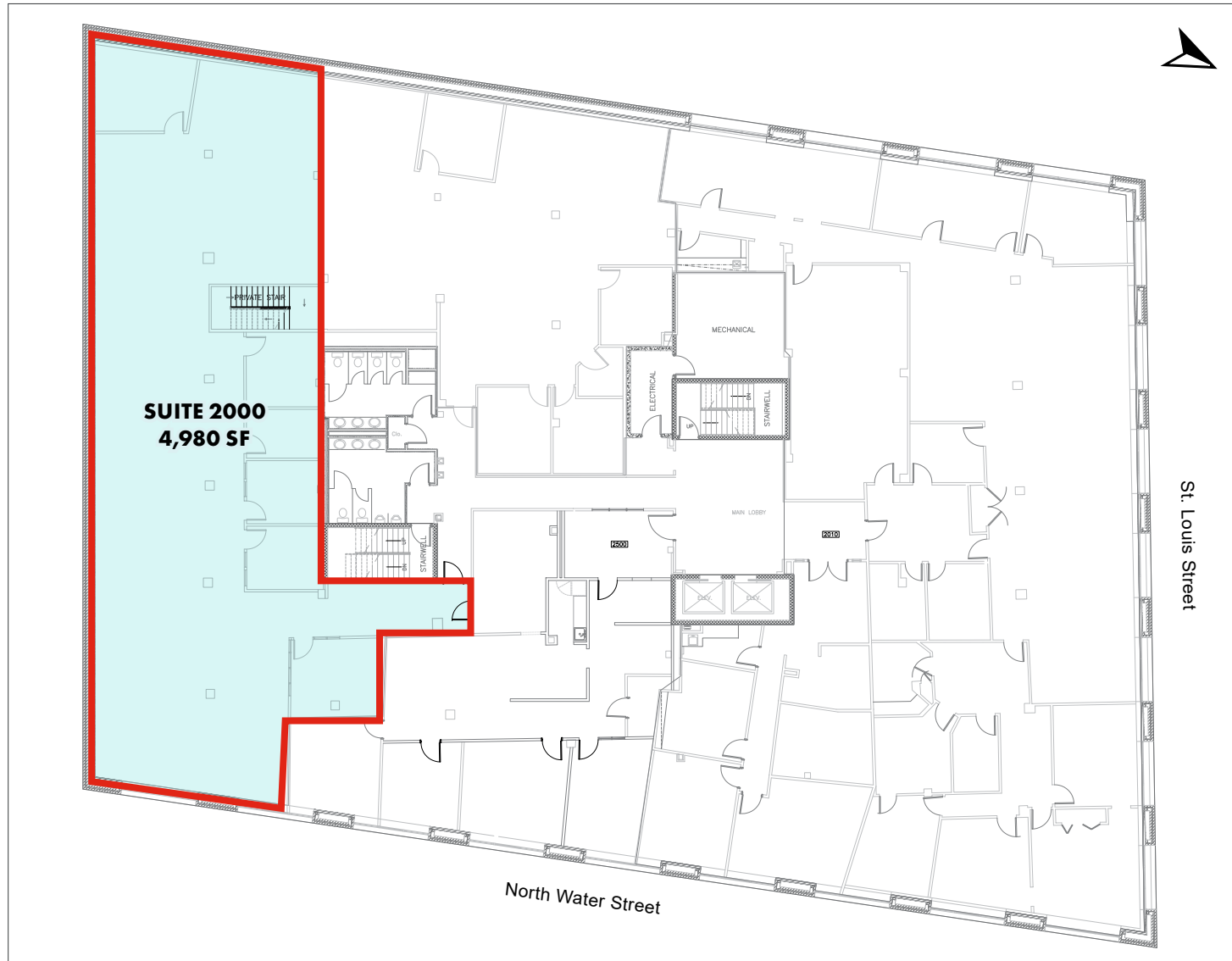

SUMMARY

LOCATION MAP

2ND FLOOR PLAN

4TH FLOOR PLAN

PHOTOS



SUMMARY

LOCATION MAP

2ND FLOOR PLAN

4TH FLOOR PLAN

PHOTOS



MAIN LOBBY



3RD FLOOR LOBBY



SUITE 4010 OFFICE



MAIN LOBBY