

FOR LEASE

INDUSTRIAL PROPERTY



PLYMOUTH INDUSTRIAL PARK OFFICE SPACE

71 ARMSTRONG ROAD, PLYMOUTH, MA 02360

For More Information

DAVE ELLIS

781.919.0800 x701
dave@ellisrealtyadvisors.com



PLYMOUTH INDUSTRIAL PARK OFFICE SPACE



PROPERTY DESCRIPTION

Efficient Professional Office space in Plymouth Industrial Park. Space to be updated with carpet and paint. Ample parking and views of Plymouth and Cape Cod Bay. Large private offices, conference room, reception and kitchenette. Private multi-stall bathrooms.

PROPERTY HIGHLIGHTS

- Plymouth Industrial Park Location
- Many Nearby Amenities on Commerce Way
- Close Proximity to MBTA
- Junction of Route 44 and Route 3
- Ample Parking
- Waterviews

OFFERING SUMMARY

Lease Rate:	\$16.00 SF/yr (MG)
Number of Units:	1
Available SF:	3,000 - 5,000 SF
Lot Size:	3 Acres
Building Size:	29,840 SF

DEMOGRAPHICS	1 MILE	5 MILES	10 MILES
Total Households	1,183	15,392	39,023
Total Population	2,917	40,282	106,139
Average HH Income	\$83,035	\$94,986	\$98,535

PLYMOUTH INDUSTRIAL PARK OFFICE SPACE

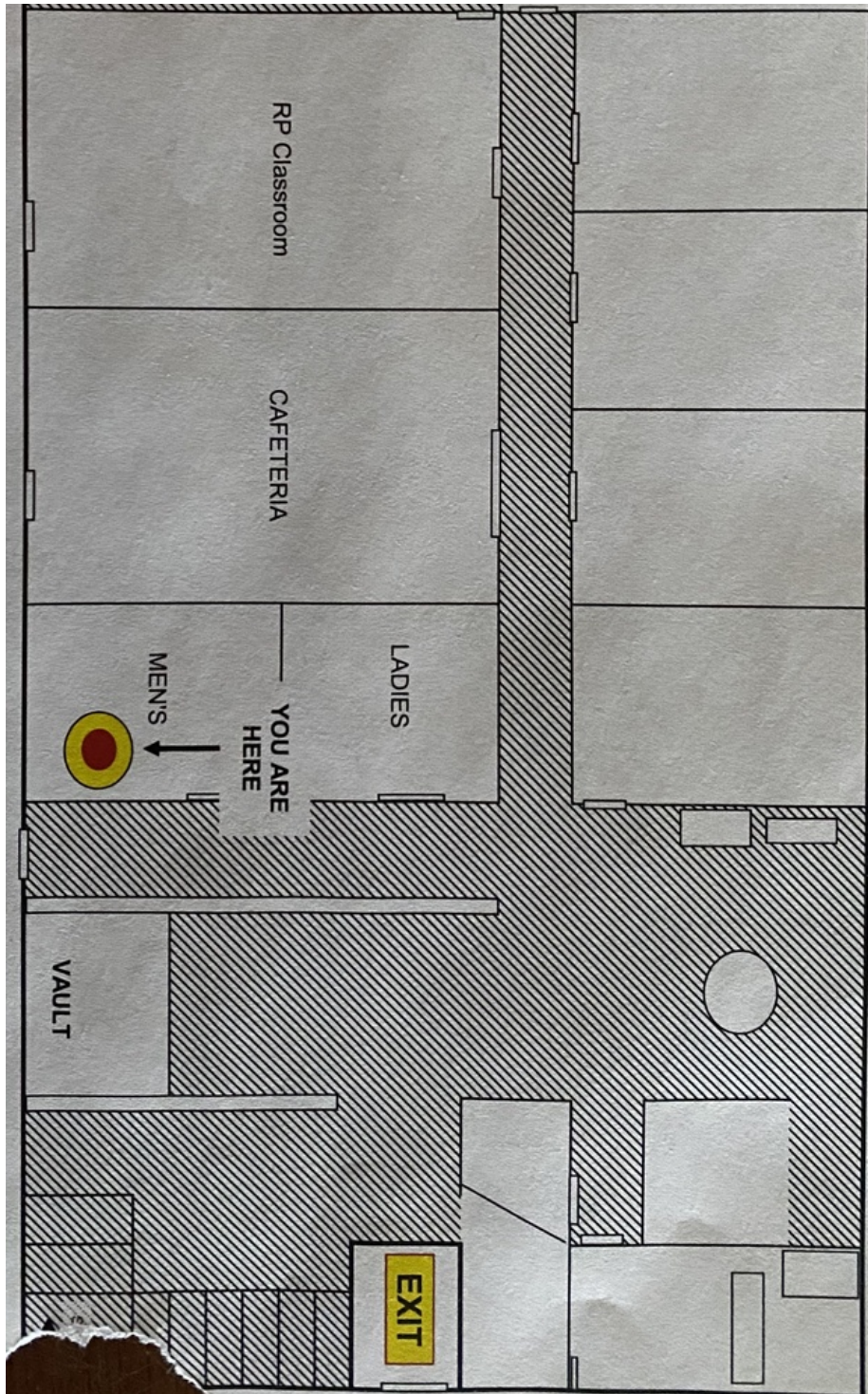

PLYMOUTH INDUSTRIAL PARK OFFICE SPACE



PLYMOUTH INDUSTRIAL PARK OFFICE SPACE

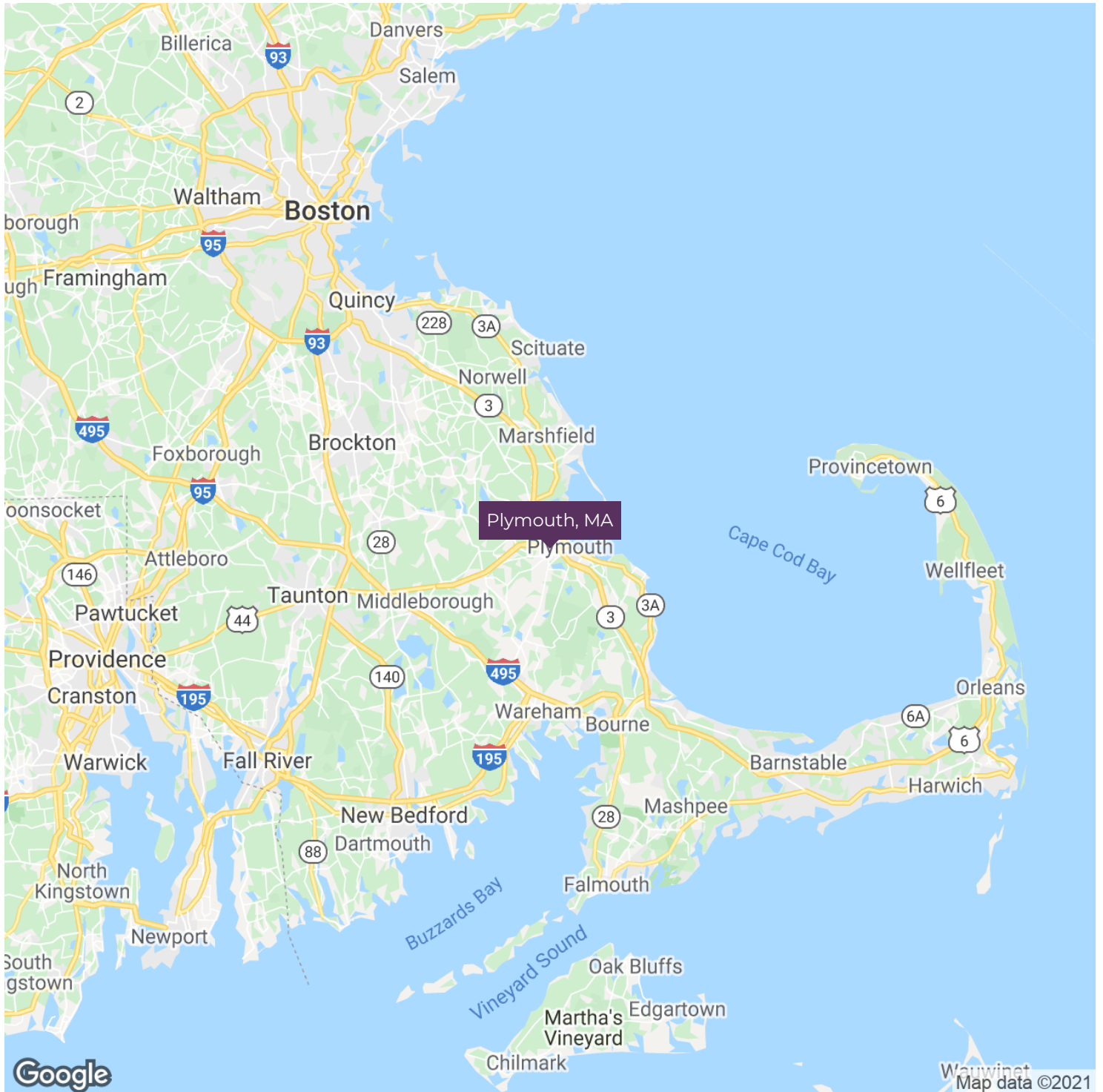

PLYMOUTH INDUSTRIAL PARK OFFICE SPACE

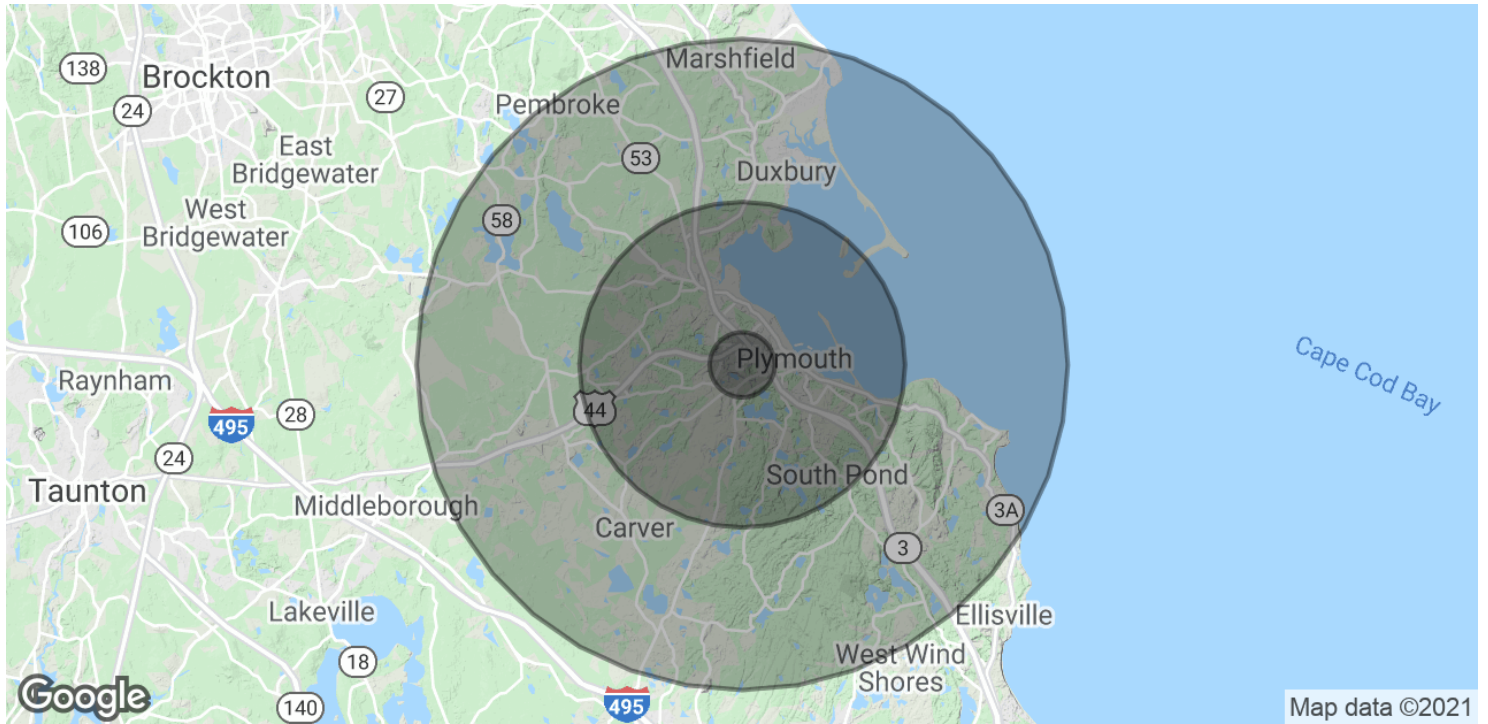

POPULATION	1 MILE	5 MILES	10 MILES
Total Population	2,917	40,282	106,139
Average age	42.5	42.0	41.9
Average age (Male)	40.6	41.0	40.8
Average age (Female)	43.7	42.9	42.7

HOUSEHOLDS & INCOME	1 MILE	5 MILES	10 MILES
Total households	1,183	15,392	39,023
# of persons per HH	2.5	2.6	2.7
Average HH income	\$83,035	\$94,986	\$98,535
Average house value	\$313,691	\$402,826	\$435,378

* Demographic data derived from 2010 US Census