



For Sale

Commercial Land Available

3928 E Hammer Lane | Stockton, CA 95212

 **NORTHGATE**
Investment Sales | Leasing | Asset Management



Contents

3 Property Information

4 Site Map

5 Demographics

Xavier Santana

CEO, Broker

925 226 2455

xavier@ngcip.com

Lic. # 01317296

Bill Johnson

Investments Partner

209 546 6051

bill.johnson@ngcip.com

Lic. # 01992175

© 2019 Northgate Commercial Real Estate. We obtained the information above from sources we believe to be reliable. However, we have not verified its accuracy and make guarantee, warranty or representation about it. It is submitted subject to the possibility of errors, omissions, change of price, rental or other conditions, prior sale, lease or financing, or withdrawal without notice. We include projections, opinions, assumptions or estimates for example only, and they may not represent current or future performance of the property. You and your tax and legal advisors should conduct your own investigation of the property and transaction.



Property Information

Sales Price: **\$535,000**

APN: 130-030-180

Parcel Size: ± 2.45 Acres

Traffic Counts: East Hammer Lane ± 30,000 ADT

- Located near Highway 99, a North-South state highway, extending throughout the Central Valley
- Highly trafficked area with daily traffic counts of ± 32,000 along East Hammer Lane
- Property is within the Sphere of Influence with the City of Stockton and is set for Annexation by the 2035 General Plan
- Site is located on Hammer Lane at the signalized intersection of Hammer Lane and Marantha Drive, which services the residential community of West Morada
- Area tenants include Walmart, Lowes, Kelly-Moore Paint Company, Home Depot, O'Reilly Auto Parts, McDonalds, Office Max, America's Tires, and many more

Site Map

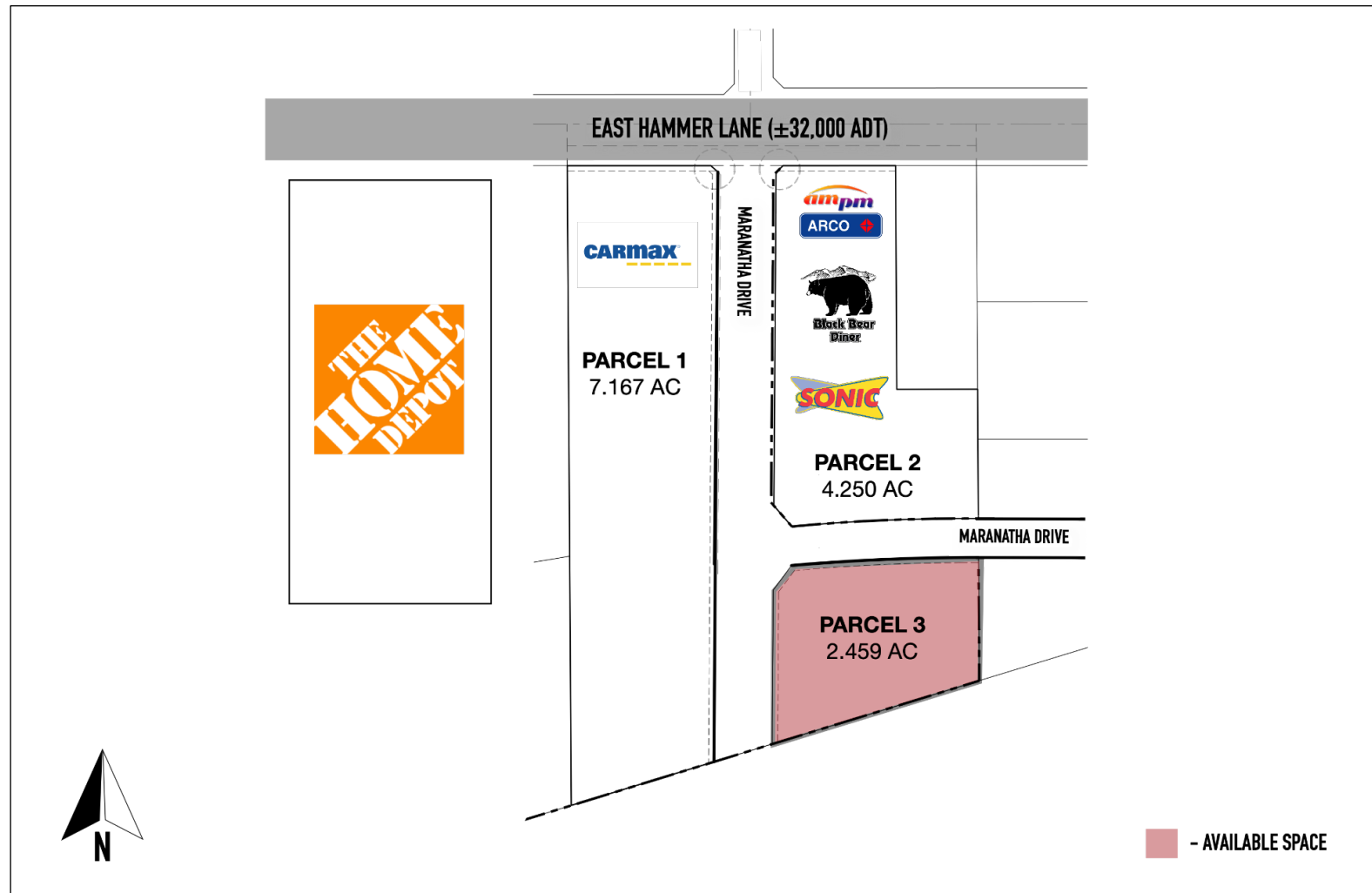

Market View

West View



Market View





Demographics

Population

	1 mi	3 mi	5 mi
2020 Estimated Population:	13,057	100,660	242,395
2025 Projected Population:	13,777	107,425	259,717
2010 Census Population:	12,236	94,061	227,060
2025 Projected Growth:	1.1%	1.3%	1.4%

Households

	1 mi	3 mi	5 mi
2020 Estimated Households:	3,370	29,829	77,628
2025 Projected Households:	3,490	31,308	81,910
2010 Census Households:	3,164	28,040	72,986
Projected Growth:	0.7%	1.0%	1.1%

Businesses

	1 mi	3 mi	5 mi
2020 Estimated Total Businesses:	307	2,140	6,814
2020 Estimated Total Employees:	3,016	21,107	73,216

Income

	1 mi	3 mi	5 mi
2020 Estimated Average Household Income:	\$106,628	\$81,762	\$78,876
2020 Estimated Median Household Income:	\$77,778	\$63,284	\$61,882
2020 Estimated Per Capita Income:	\$27,564	\$24,335	\$25,420

Race & Ethnicity

	1 mi	3 mi	5 mi
2020 Estimated White:	22.0%	28.9%	38.2%
2020 Estimated Black/African American:	8.6%	10.9%	10.4%
2020 Estimated Asian/Pacific Islander:	47.9%	34.5%	23.3%
2020 Estimated American Indian/Native Alaskan:	0.7%	0.9%	1.2%
2020 Estimated Hispanic:	27.6%	35.4%	41.0%
2020 Estimated Other Races:	20.9%	24.7%	26.7%



© 2019 Northgate Commercial Real Estate. We obtained the information above from sources we believe to be reliable. However, we have not verified its accuracy and make guarantee, warranty or representation about it. It is submitted subject to the possibility of errors, omissions, change of price, rental or other conditions, prior sale, lease or financing, or withdrawal without notice. We include projections, opinions, assumptions or estimates for example only, and they may not represent current or future performance of the property. You and your tax and legal advisors should conduct your own investigation of the property and transaction.

Xavier Santana

CEO, Broker

925 226 2455

xavier@ngcip.com

Lic. # 01317296

Bill Johnson

Investments Partner

209 546 6051

bill.johnson@ngcip.com

Lic. # 01992175



Investment Sales | Leasing | Asset Management