

Industrial Complex For Sale

1906 Clover Road
Mishawaka, Indiana 46545



2 Building Industrial Complex for Sale



Snapshot

Buildings:	Building 1 - 24,224 SF Building 2 - 9,600 SF
Land:	3.33 Acres
Zoning:	I-2 Heavy Industrial
OH Door:	12 grade level doors
Docks:	1 dock door
Ceilings:	14' ceilings
Cranes:	Building 1 - (4) five-ton Building 2 - (1) three-ton
Power:	480 V/400A/3-Ph
Parking:	7,000 SF paved parking
List Price:	\$925,000

Property Details

Two building industrial complex:

Building #1- 24,224 SF production building, including 4,224 SF office, with 480V/400A/3 phase power. There are 7 grade level doors and (4) five ton cranes.

Building #2- 9,600 SF warehouse/production with 480V/400A/3 phase power. There is a truck dock, 5 grade level doors and a (1) three ton crane.



4100 Edison Lakes Parkway, Suite 350
Mishawaka, Indiana
574.271.4060
574.271.4292 Fax
www.cressy.com

Global Brokerage Division of Cressy Commercial Real Estate

TONY DAVEY
Senior Broker
574.485.1536
tdavey@cressy.com

Information furnished regarding property for sale, rental or financing is from sources deemed reliable. But no warranty or representation is made as to the accuracy thereof and same is submitted subject to errors, omissions, change of price, rental or other conditions, prior sale, leased, financing or withdrawal without notice. No liability of any kind is to be imposed on the broker herein.

Industrial Complex For Sale

1906 Clover Road
Mishawaka, Indiana 46545



Property Photos



4100 Edison Lakes Parkway, Suite 350
Mishawaka, Indiana
574.271.4060
574.271.4292 Fax
www.cressy.com

Global Brokerage Division of Cressy Commercial Real Estate

TONY DAVEY
Senior Broker
574.485.1536
tdavey@cressy.com

Information furnished regarding property for sale, rental or financing is from sources deemed reliable. But no warranty or representation is made as to the accuracy thereof and same is submitted subject to errors, omissions, change of price, rental or other conditions, prior sale, leased, financing or withdrawal without notice. No liability of any kind is to be imposed on the broker herein.

Industrial Complex For Sale

1906 Clover Road
Mishawaka, Indiana 46545



Located Minutes From US 20/31 Bypass

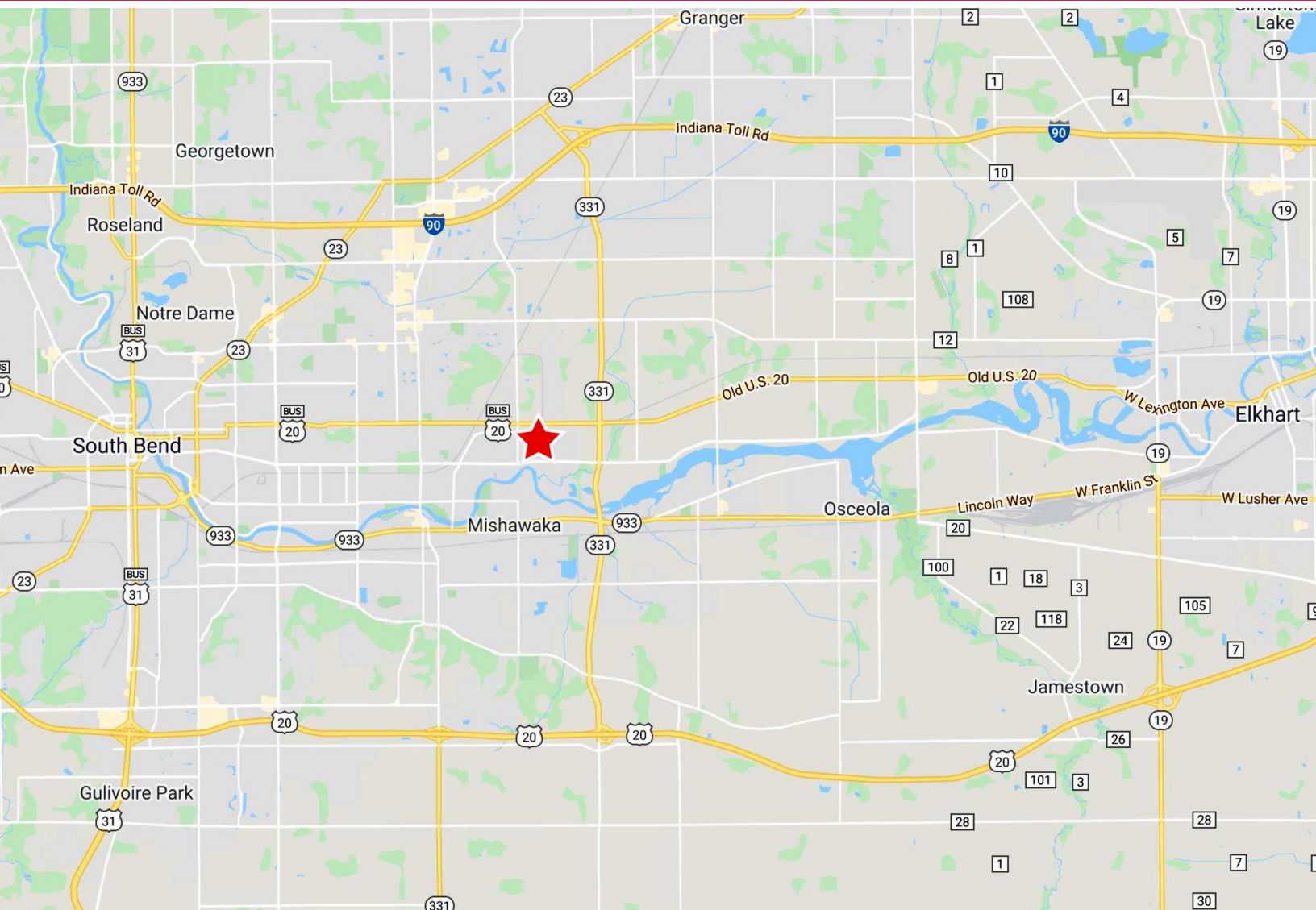

Location

Located on Clover Road in Mishawaka, just 1 mile from SR 331 and less than 5 miles from I-80/90 Indiana Toll Road. The property is surrounded by residential and commercial businesses and centrally located between the cities of South Bend and Elkhart.

4100 Edison Lakes Parkway, Suite 350
Mishawaka, Indiana
574.271.4060
574.271.4292 Fax
www.cressy.com

TONY DAVEY
Senior Broker
574.485.1536
tdavey@cressy.com

Global Brokerage Division of Cressy Commercial Real Estate

Information furnished regarding property for sale, rental or financing is from sources deemed reliable. But no warranty or representation is made as to the accuracy thereof and same is submitted subject to errors, omissions, change of price, rental or other conditions, prior sale, leased, financing or withdrawal without notice. No liability of any kind is to be imposed on the broker herein.